

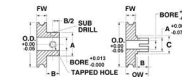

# MBA

## Pulleys - U Groove - Steel



303 Stainless Steel.

Groove has 1.57 mm Radius - 1.57mm Deep.

2 hub types - Pin Hub for use with Set Screws - Clamp Hub for use with Gear Clamps.

### Pulleys - U Groove - Steel

Part Number	For Belt Diameter mm	Outside Diameter (OD) mm	Bore mm	Face Width (FW) mm	Overall Width (OW) mm	Dia. to Base of Groove mm	Hub Diameter (A) mm	Material	Locking Method	Hub Length (B) mm
	<i>inches</i>	<i>inches</i>	<i>inches</i>	<i>inches</i>	<i>inches</i>	<i>inches</i>	<i>inches</i>			<i>inches</i>
# PU032-0127-032-3P	3.18	12.700	3.170	4.762	9.500	9.525	7.925	303 Stainless Steel	Set Screw / Pin	4.75
	<i>0.125</i>	<i>0.500</i>	<i>0.125</i>	<i>0.187</i>	<i>0.374</i>	<i>0.375</i>	<i>0.312</i>			<i>0.187</i>
# PU032-0127-032-3C	3.18	12.700	3.170	4.750	11.887	9.525	4.775	303 Stainless Steel	Clamp Type	6.35
	<i>0.125</i>	<i>0.500</i>	<i>0.125</i>	<i>0.187</i>	<i>0.468</i>	<i>0.375</i>	<i>0.188</i>			<i>0.250</i>
# PU032-0127-048-3C	3.18	12.700	4.757	5.537	11.887	9.525	6.350	303 Stainless Steel	Clamp Type	6.35
	<i>0.125</i>	<i>0.500</i>	<i>0.187</i>	<i>0.218</i>	<i>0.468</i>	<i>0.375</i>	<i>0.250</i>			<i>0.250</i>

# Indicates item not stocked at time of printing - Please enquire for lead time

E&OE Pricing and all details subject to change without notice - Copyright Miniature Bearings Australia Pty Ltd

MBA Size Listings are a guide to sizes only and must not be solely relied on for critical design information.

## Pulleys - U Groove - Steel

Part Number	For Belt Diameter mm	Outside Diameter (OD) mm	Bore mm	Face Width (FW) mm	Overall Width (OW) mm	Dia. to Base of Groove mm	Hub Diameter (A) mm	Material	Locking Method	Hub Length (B) mm
	<i>inches</i>	<i>inches</i>	<i>inches</i>	<i>inches</i>	<i>inches</i>	<i>inches</i>	<i>inches</i>			<i>inches</i>
# PU032-0127-048-3P	3.18	12.700	4.757	4.762	10.287	9.525	9.525	303 Stainless Steel	Set Screw / Pin	5.54
	<i>0.125</i>	<i>0.500</i>	<i>0.187</i>	<i>0.187</i>	<i>0.405</i>	<i>0.375</i>	<i>0.375</i>			<i>0.218</i>
# PU032-0127-063-3C	3.18	12.700	6.345	6.350	11.887	9.525	7.925	303 Stainless Steel	Clamp Type	6.35
	<i>0.125</i>	<i>0.500</i>	<i>0.250</i>	<i>0.250</i>	<i>0.468</i>	<i>0.375</i>	<i>0.312</i>			<i>0.250</i>
# PU032-0127-063-3P	3.18	12.700	6.345	4.762	11.100	9.525	12.700	303 Stainless Steel	Set Screw / Pin	6.35
	<i>0.125</i>	<i>0.500</i>	<i>0.250</i>	<i>0.187</i>	<i>0.437</i>	<i>0.375</i>	<i>0.500</i>			<i>0.250</i>
# PU032-0191-032-3C	3.18	19.050	3.170	4.750	11.887	15.875	4.775	303 Stainless Steel	Clamp Type	6.35
	<i>0.125</i>	<i>0.750</i>	<i>0.125</i>	<i>0.187</i>	<i>0.468</i>	<i>0.625</i>	<i>0.188</i>			<i>0.250</i>
# PU032-0191-032-3P	3.18	19.050	3.170	4.762	9.500	15.875	7.925	303 Stainless Steel	Set Screw / Pin	4.75
	<i>0.125</i>	<i>0.750</i>	<i>0.125</i>	<i>0.187</i>	<i>0.374</i>	<i>0.625</i>	<i>0.312</i>			<i>0.187</i>
# PU032-0191-048-3P	3.18	19.050	4.757	4.762	10.287	15.875	9.525	303 Stainless Steel	Set Screw / Pin	5.54
	<i>0.125</i>	<i>0.750</i>	<i>0.187</i>	<i>0.187</i>	<i>0.405</i>	<i>0.625</i>	<i>0.375</i>			<i>0.218</i>
# PU032-0191-048-3C	3.18	19.050	4.757	4.762	11.887	15.875	6.350	303 Stainless Steel	Clamp Type	6.35
	<i>0.125</i>	<i>0.750</i>	<i>0.187</i>	<i>0.187</i>	<i>0.468</i>	<i>0.625</i>	<i>0.250</i>			<i>0.250</i>
# PU032-0191-063-3C	3.18	19.050	6.345	4.762	11.887	15.875	7.925	303 Stainless Steel	Clamp Type	6.35
	<i>0.125</i>	<i>0.750</i>	<i>0.250</i>	<i>0.187</i>	<i>0.468</i>	<i>0.625</i>	<i>0.312</i>			<i>0.250</i>

# Indicates item not stocked at time of printing - Please enquire for lead time

E&OE Pricing and all details subject to change without notice - Copyright Miniature Bearings Australia Pty Ltd

MBA Size Listings are a guide to sizes only and must not be solely relied on for critical design information.

## Pulleys - U Groove - Steel

Part Number	For Belt Diameter mm	Outside Diameter (OD) mm	Bore mm	Face Width (FW) mm	Overall Width (OW) mm	Dia. to Base of Groove mm	Hub Diameter (A) mm	Material	Locking Method	Hub Length (B) mm
	<i>inches</i>	<i>inches</i>	<i>inches</i>	<i>inches</i>	<i>inches</i>	<i>inches</i>	<i>inches</i>			<i>inches</i>
# PU032-0191-063-3P	3.18	19.050	6.345	4.762	11.100	15.875	12.700	303 Stainless Steel	Set Screw / Pin	6.35
	<i>0.125</i>	<i>0.750</i>	<i>0.250</i>	<i>0.187</i>	<i>0.437</i>	<i>0.625</i>	<i>0.500</i>			<i>0.250</i>
# PU032-0254-032-3C	3.18	25.400	3.170	4.762	11.887	22.225	4.775	303 Stainless Steel	Clamp Type	6.35
	<i>0.125</i>	<i>1.000</i>	<i>0.125</i>	<i>0.187</i>	<i>0.468</i>	<i>0.875</i>	<i>0.188</i>			<i>0.250</i>
# PU032-0254-032-3P	3.18	25.400	3.170	4.762	9.500	22.225	7.925	303 Stainless Steel	Set Screw / Pin	4.75
	<i>0.125</i>	<i>1.000</i>	<i>0.125</i>	<i>0.187</i>	<i>0.374</i>	<i>0.875</i>	<i>0.312</i>			<i>0.187</i>
# PU032-0254-048-3C	3.18	25.400	4.757	4.762	11.887	22.225	6.350	303 Stainless Steel	Clamp Type	6.35
	<i>0.125</i>	<i>1.000</i>	<i>0.187</i>	<i>0.187</i>	<i>0.468</i>	<i>0.875</i>	<i>0.250</i>			<i>0.250</i>
PU032-0254-048-3P	3.18	25.400	4.757	4.762	10.287	22.225	9.525	303 Stainless Steel	Set Screw / Pin	5.54
	<i>0.125</i>	<i>1.000</i>	<i>0.187</i>	<i>0.187</i>	<i>0.405</i>	<i>0.875</i>	<i>0.375</i>			<i>0.218</i>
# PU032-0254-063-3C	3.18	25.400	6.345	4.762	11.887	22.225	7.925	303 Stainless Steel	Clamp Type	6.35
	<i>0.125</i>	<i>1.000</i>	<i>0.250</i>	<i>0.187</i>	<i>0.468</i>	<i>0.875</i>	<i>0.312</i>			<i>0.250</i>
# PU032-0254-063-3P	3.18	25.400	6.345	4.762	11.100	22.225	12.700	303 Stainless Steel	Set Screw / Pin	6.35
	<i>0.125</i>	<i>1.000</i>	<i>0.250</i>	<i>0.187</i>	<i>0.437</i>	<i>0.875</i>	<i>0.500</i>			<i>0.250</i>
# PU032-0381-032-3C	3.18	38.100	3.170	4.762	11.887	34.925	4.775	303 Stainless Steel	Clamp Type	6.35
	<i>0.125</i>	<i>1.500</i>	<i>0.125</i>	<i>0.187</i>	<i>0.468</i>	<i>1.375</i>	<i>0.188</i>			<i>0.250</i>

# Indicates item not stocked at time of printing - Please enquire for lead time

E&OE Pricing and all details subject to change without notice - Copyright Miniature Bearings Australia Pty Ltd

MBA Size Listings are a guide to sizes only and must not be solely relied on for critical design information.

## Pulleys - U Groove - Steel

Part Number	For Belt Diameter mm	Outside Diameter (OD) mm	Bore mm	Face Width (FW) mm	Overall Width (OW) mm	Dia. to Base of Groove mm	Hub Diameter (A) mm	Material	Locking Method	Hub Length (B) mm
	<i>inches</i>	<i>inches</i>	<i>inches</i>	<i>inches</i>	<i>inches</i>	<i>inches</i>	<i>inches</i>			<i>inches</i>
# PU032-0381-032-3P	3.18	38.100	3.170	4.762	9.500	34.925	7.925	303 Stainless Steel	Set Screw / Pin	4.75
	<i>0.125</i>	<i>1.500</i>	<i>0.125</i>	<i>0.187</i>	<i>0.374</i>	<i>1.375</i>	<i>0.312</i>			<i>0.187</i>
# PU032-0381-048-3P	3.18	38.100	4.757	4.762	10.287	34.925	9.525	303 Stainless Steel	Set Screw / Pin	5.54
	<i>0.125</i>	<i>1.500</i>	<i>0.187</i>	<i>0.187</i>	<i>0.405</i>	<i>1.375</i>	<i>0.375</i>			<i>0.218</i>
# PU032-0381-048-3C	3.18	38.100	4.757	4.762	11.887	34.925	6.350	303 Stainless Steel	Clamp Type	6.35
	<i>0.125</i>	<i>1.500</i>	<i>0.187</i>	<i>0.187</i>	<i>0.468</i>	<i>1.375</i>	<i>0.250</i>			<i>0.250</i>
# PU032-0381-063-3C	3.18	38.100	6.345	4.762	11.887	34.925	7.925	303 Stainless Steel	Clamp Type	6.35
	<i>0.125</i>	<i>1.500</i>	<i>0.250</i>	<i>0.187</i>	<i>0.468</i>	<i>1.375</i>	<i>0.312</i>			<i>0.250</i>
# PU032-0381-063-3P	3.18	38.100	6.345	4.762	11.100	34.925	12.700	303 Stainless Steel	Set Screw / Pin	6.35
	<i>0.125</i>	<i>1.500</i>	<i>0.250</i>	<i>0.187</i>	<i>0.437</i>	<i>1.375</i>	<i>0.500</i>			<i>0.250</i>
# PU032-0508-032-3C	3.18	50.800	3.170	4.762	11.887	47.625	4.775	303 Stainless Steel	Clamp Type	6.35
	<i>0.125</i>	<i>2.000</i>	<i>0.125</i>	<i>0.187</i>	<i>0.468</i>	<i>1.875</i>	<i>0.188</i>			<i>0.250</i>
# PU032-0508-032-3P	3.18	50.800	3.170	4.762	9.500	47.625	7.925	303 Stainless Steel	Set Screw / Pin	4.75
	<i>0.125</i>	<i>2.000</i>	<i>0.125</i>	<i>0.187</i>	<i>0.374</i>	<i>1.875</i>	<i>0.312</i>			<i>0.187</i>
# PU032-0508-048-3C	3.18	50.800	4.757	4.762	11.887	47.625	6.350	303 Stainless Steel	Clamp Type	6.35
	<i>0.125</i>	<i>2.000</i>	<i>0.187</i>	<i>0.187</i>	<i>0.468</i>	<i>1.875</i>	<i>0.250</i>			<i>0.250</i>

# Indicates item not stocked at time of printing - Please enquire for lead time

E&OE Pricing and all details subject to change without notice - Copyright Miniature Bearings Australia Pty Ltd

MBA Size Listings are a guide to sizes only and must not be solely relied on for critical design information.

## Pulleys - U Groove - Steel

Part Number	For Belt Diameter mm	Outside Diameter (OD) mm	Bore mm	Face Width (FW) mm	Overall Width (OW) mm	Dia. to Base of Groove mm	Hub Diameter (A) mm	Material	Locking Method	Hub Length (B) mm
	<i>inches</i>	<i>inches</i>	<i>inches</i>	<i>inches</i>	<i>inches</i>	<i>inches</i>	<i>inches</i>			<i>inches</i>
PU032-0508-048-3P	3.18	50.800	4.757	4.762	10.287	47.625	9.525	303 Stainless Steel	Set Screw / Pin	5.54
	<i>0.125</i>	<i>2.000</i>	<i>0.187</i>	<i>0.187</i>	<i>0.405</i>	<i>1.875</i>	<i>0.375</i>			<i>0.218</i>
# PU032-0508-063-3P	3.18	50.800	6.345	4.762	11.100	47.625	12.700	303 Stainless Steel	Set Screw / Pin	6.35
	<i>0.125</i>	<i>2.000</i>	<i>0.250</i>	<i>0.187</i>	<i>0.437</i>	<i>1.875</i>	<i>0.500</i>			<i>0.250</i>
# PU032-0508-063-3C	3.18	50.800	6.345	4.762	11.887	47.625	7.925	303 Stainless Steel	Clamp Type	6.35
	<i>0.125</i>	<i>2.000</i>	<i>0.250</i>	<i>0.187</i>	<i>0.468</i>	<i>1.875</i>	<i>0.312</i>			<i>0.250</i>
# PU032-0635-032-3C	3.18	63.500	3.170	4.762	11.887	60.325	4.775	303 Stainless Steel	Clamp Type	6.35
	<i>0.125</i>	<i>2.500</i>	<i>0.125</i>	<i>0.187</i>	<i>0.468</i>	<i>2.375</i>	<i>0.188</i>			<i>0.250</i>
# PU032-0635-032-3P	3.18	63.500	3.170	4.762	9.500	60.325	7.925	303 Stainless Steel	Set Screw / Pin	4.75
	<i>0.125</i>	<i>2.500</i>	<i>0.125</i>	<i>0.187</i>	<i>0.374</i>	<i>2.375</i>	<i>0.312</i>			<i>0.187</i>
# PU032-0635-048-3C	3.18	63.500	4.757	4.762	11.887	60.325	6.350	303 Stainless Steel	Clamp Type	6.35
	<i>0.125</i>	<i>2.500</i>	<i>0.187</i>	<i>0.187</i>	<i>0.468</i>	<i>2.375</i>	<i>0.250</i>			<i>0.250</i>
# PU032-0635-048-3P	3.18	63.500	4.757	4.762	10.287	60.325	9.525	303 Stainless Steel	Set Screw / Pin	5.54
	<i>0.125</i>	<i>2.500</i>	<i>0.187</i>	<i>0.187</i>	<i>0.405</i>	<i>2.375</i>	<i>0.375</i>			<i>0.218</i>
# PU032-0635-063-3C	3.18	63.500	6.345	4.762	11.887	60.325	7.925	303 Stainless Steel	Clamp Type	6.35
	<i>0.125</i>	<i>2.500</i>	<i>0.250</i>	<i>0.187</i>	<i>0.468</i>	<i>2.375</i>	<i>0.312</i>			<i>0.250</i>

# Indicates item not stocked at time of printing - Please enquire for lead time

E&OE Pricing and all details subject to change without notice - Copyright Miniature Bearings Australia Pty Ltd

MBA Size Listings are a guide to sizes only and must not be solely relied on for critical design information.

## Pulleys - U Groove - Steel

Part Number	For Belt Diameter mm	Outside Diameter (OD) mm	Bore mm	Face Width (FW) mm	Overall Width (OW) mm	Dia. to Base of Groove mm	Hub Diameter (A) mm	Material	Locking Method	Hub Length (B) mm
	<i>inches</i>	<i>inches</i>	<i>inches</i>	<i>inches</i>	<i>inches</i>	<i>inches</i>	<i>inches</i>			<i>inches</i>
# PU032-0635-063-3P	3.18	63.500	6.345	4.762	11.100	60.325	12.700	303 Stainless Steel	Set Screw / Pin	6.35
	<i>0.125</i>	<i>2.500</i>	<i>0.250</i>	<i>0.187</i>	<i>0.437</i>	<i>2.375</i>	<i>0.500</i>			<i>0.250</i>
# PU032-0762-063-3C	3.18	76.200	6.345	4.762	11.887	73.025	7.925	303 Stainless Steel	Clamp Type	6.35
	<i>0.125</i>	<i>3.000</i>	<i>0.250</i>	<i>0.187</i>	<i>0.468</i>	<i>2.875</i>	<i>0.312</i>			<i>0.250</i>
# PU032-0762-063-3P	3.18	76.200	6.345	4.762	11.100	73.025	12.700	303 Stainless Steel	Set Screw / Pin	6.35
	<i>0.125</i>	<i>3.000</i>	<i>0.250</i>	<i>0.187</i>	<i>0.437</i>	<i>2.875</i>	<i>0.500</i>			<i>0.250</i>
PU032-0889-063-3P	3.18	88.900	6.345	4.762	11.100	85.725	12.700	303 Stainless Steel	Set Screw / Pin	6.35
	<i>0.125</i>	<i>3.500</i>	<i>0.250</i>	<i>0.187</i>	<i>0.437</i>	<i>3.375</i>	<i>0.500</i>			<i>0.250</i>
# PU032-0889-063-3C	3.18	88.900	6.345	4.762	11.887	85.725	7.925	303 Stainless Steel	Clamp Type	6.35
	<i>0.125</i>	<i>3.500</i>	<i>0.250</i>	<i>0.187</i>	<i>0.468</i>	<i>3.375</i>	<i>0.312</i>			<i>0.250</i>

# Indicates item not stocked at time of printing - Please enquire for lead time

E&OE Pricing and all details subject to change without notice - Copyright Miniature Bearings Australia Pty Ltd

MBA Size Listings are a guide to sizes only and must not be solely relied on for critical design information.



DISTRIBUTED BY

Ask us to put your name and address here

<http://www.minibearings.com.au/product>

Ph +61 7 3245 7977

Fax +61 7 3245 1017

Catalogue requests to [catalogues@minibearings.com.au](mailto:catalogues@minibearings.com.au)
