

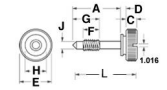

MBA

Screws - Thumb - Captive



Brass.

Slotted Knurled Head.

Screws - Thumb - Captive

Part Number	Thread Size (C)	Overall Length (L) mm	Material / Finish	Thread Length (F) mm	Shank Length (A) mm	Top of Thread to End (G) mm	Plain Shaft Dia (J) mm	Head Diameter (E / H) mm	Pitch in mm / Threads Per Inch mm / No.
		<i>inches</i>		<i>inches</i>	<i>inches</i>	<i>inches</i>	<i>inches</i>	<i>inches</i>	
# STC632C-00238-O	3.5mm (6-32 UNC)	23.8	Half-Hard Brass / Black Oxide	4.8	19.1	7.9	2.362	7.9 / 5.1	0.794 mm / 32 TPI
		<i>0.937</i>		<i>0.189</i>	<i>0.752</i>	<i>0.311</i>	<i>0.093</i>		
# STC632C-00238-N	3.5mm (6-32 UNC)	23.8	Half-Hard Brass / Nickel Plated	4.8	19.1	7.9	2.362	7.9 / 5.1	0.794 mm / 32 TPI
		<i>0.937</i>		<i>0.189</i>	<i>0.752</i>	<i>0.311</i>	<i>0.093</i>		
# STC832C-00254-O	4.166mm (8-32 UNC)	25.4	Half-Hard Brass / Black Oxide	9.5	19.1	9.5	3.175	15.9 / 12.7	0.794 mm / 32 TPI
		<i>1.000</i>		<i>0.374</i>	<i>0.752</i>	<i>0.374</i>	<i>0.125</i>		

Indicates item not stocked at time of printing - Please enquire for lead time

E&OE Pricing and all details subject to change without notice - Copyright Miniature Bearings Australia Pty Ltd

MBA Size Listings are a guide to sizes only and must not be solely relied on for critical design information.

Screws - Thumb - Captive

Part Number	Thread Size (C)	Overall Length (L) mm	Material / Finish	Thread Length (F) mm	Shank Length (A) mm	Top of Thread to End (G) mm	Plain Shaft Dia (J) mm	Head Diameter (E / H) mm	Pitch in mm / Threads Per Inch mm / No.
		<i>inches</i>		<i>inches</i>	<i>inches</i>	<i>inches</i>	<i>inches</i>	<i>inches</i>	
# STC832C-00254-N	4.166mm (8-32 UNC)	25.4 <i>1.000</i>	Half-Hard Brass / Nickel Plated	6.4 <i>0.252</i>	19.1 <i>0.752</i>	9.5 <i>0.374</i>	3.175 <i>0.125</i>	15.9 / 12.7	0.794 mm / 32 TPI
# STC832C-00286-N	4.166mm (8-32 UNC)	28.6 <i>1.126</i>	Half-Hard Brass / Nickel Plated	6.4 <i>0.252</i>	22.2 <i>0.874</i>	9.5 <i>0.374</i>	3.175 <i>0.125</i>	15.9 / 12.7	0.794 mm / 32 TPI
# STC1032F-00286-O	4.762mm (10-32 UNF)	28.6 <i>1.126</i>	Half-Hard Brass / Black Oxide	9.5 <i>0.374</i>	22.2 <i>0.874</i>	9.5 <i>0.374</i>	3.175 <i>0.125</i>	15.9 / 12.7	0.794 mm / 32 TPI
# STC1032F-00286-N	4.762mm (10-32 UNF)	28.6 <i>1.126</i>	Half-Hard Brass / Nickel Plated	6.4 <i>0.252</i>	22.2 <i>0.874</i>	9.5 <i>0.374</i>	3.175 <i>0.125</i>	15.9 / 12.7	0.794 mm / 32 TPI
# STC14C-00286-N	6.35mm (1/4-20 UNC)	28.6 <i>1.126</i>	Half-Hard Brass / Nickel Plated	6.4 <i>0.252</i>	22.2 <i>0.874</i>	9.5 <i>0.374</i>	4.762 <i>0.187</i>	15.9 / 12.7	1.270 mm / 20 TPI
# STC14C-00318-N	6.35mm (1/4-20 UNC)	31.8 <i>1.252</i>	Half-Hard Brass / Nickel Plated	6.4 <i>0.252</i>	25.4 <i>1.000</i>	9.5 <i>0.374</i>	4.762 <i>0.187</i>	15.9 / 12.7	1.270 mm / 20 TPI
# STC14C-00349-N	6.35mm (1/4-20 UNC)	34.9 <i>1.374</i>	Half-Hard Brass / Nickel Plated	9.5 <i>0.374</i>	25.4 <i>1.000</i>	15.9 <i>0.626</i>	4.762 <i>0.187</i>	19.1 / 12.7	1.270 mm / 20 TPI
# STC14C-00381-N	6.35mm (1/4-20 UNC)	38.1 <i>1.500</i>	Half-Hard Brass / Nickel Plated	9.5 <i>0.374</i>	28.6 <i>1.126</i>	15.9 <i>0.626</i>	4.762 <i>0.187</i>	19.1 / 12.7	1.270 mm / 20 TPI

Indicates item not stocked at time of printing - Please enquire for lead time

E&OE Pricing and all details subject to change without notice - Copyright Miniature Bearings Australia Pty Ltd

MBA Size Listings are a guide to sizes only and must not be solely relied on for critical design information.



DISTRIBUTED BY

Ask us to put your name and address here

<http://www.minibearings.com.au/product>

Ph +61 7 3245 7977

Fax +61 7 3245 1017

Catalogue requests to catalogues@minibearings.com.au

