

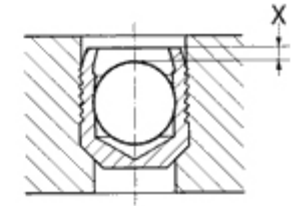

MBA

Sealing Plugs - Stainless

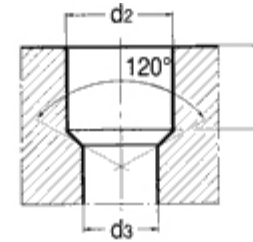
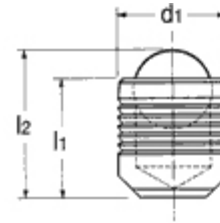

The sealing plug is a safe, quick, leakproof and low cost method for sealing cross-drilled holes. It ensures peak performance with a comfortable safety margin even in extreme applications.

Sleeve: Stainless Steel DIN 1.4305, AISI 303

Ball: Bearing Steel, Heat Treated

Hardness: HB = 220

Sealing Plugs - Stainless

Part Number	Outside Diameter (d1) mm	Sleeve Length (l1) mm	Overall Length incl Ball (l2) mm	Recommended Housing Dia. (d2) mm	d3 Max. mm	l3 Min. mm	X (+/- 0.2) mm	KP Punch (to suit) Sold Sep
	<i>inches</i>	<i>inches</i>	<i>inches</i>	<i>inches</i>	<i>inches</i>	<i>inches</i>	<i>inches</i>	
# MB700-030	3.0 <i>0.118</i>	3.6 <i>0.142</i>	4.6 <i>0.181</i>	3.0 - 3.1	2.2 <i>0.087</i>	3.4 <i>0.134</i>	0.4 <i>0.016</i>	KP-030
# MB700-040	4.0 <i>0.157</i>	4.0 <i>0.157</i>	5.2 <i>0.205</i>	4.0 - 4.1	2.2 <i>0.087</i>	3.8 <i>0.150</i>	0.2 <i>0.008</i>	KP-040
# MB700-050	5.0 <i>0.197</i>	5.5 <i>0.217</i>	7.0 <i>0.276</i>	5.0 - 5.1	4.3 <i>0.169</i>	5.3 <i>0.209</i>	0.4 <i>0.016</i>	KP-050

Indicates item not stocked at time of printing - Please enquire for lead time
 E&OE Pricing and all details subject to change without notice - Copyright Miniature Bearings Australia Pty Ltd
 MBA Size Listings are a guide to sizes only and must not be solely relied on for critical design information.

Sealing Plugs - Stainless

Part Number	Outside Diameter (d1) mm	Sleeve Length (l1) mm	Overall Length incl Ball (l2) mm	Recommended Housing Dia. (d2) mm	d3 Max. mm	l3 Min. mm	X (+/- 0.2) mm	KP Punch (to suit) Sold Sep
	<i>inches</i>	<i>inches</i>	<i>inches</i>	<i>inches</i>	<i>inches</i>	<i>inches</i>	<i>inches</i>	
# MB700-060	6.0 <i>0.236</i>	6.5 <i>0.256</i>	8.6 <i>0.339</i>	6.0 to 6.1	5.3 <i>0.209</i>	6.3 <i>0.248</i>	0.4 <i>0.016</i>	KP-060
# MB700-070	7.0 <i>0.276</i>	7.5 <i>0.295</i>	10.1 <i>0.398</i>	7.0 - 7.1	6.4 <i>0.252</i>	7.3 <i>0.287</i>	0.1 <i>0.004</i>	KP-070
# MB700-080	8.0 <i>0.315</i>	8.5 <i>0.335</i>	11.7 <i>0.461</i>	8.0 - 8.1	7.4 <i>0.291</i>	8.3 <i>0.327</i>	0.3 <i>0.012</i>	KP-080
# MB700-090	9.0 <i>0.354</i>	10.0 <i>0.394</i>	13.7 <i>0.539</i>	9.0 - 9.1	8.4 <i>0.331</i>	9.8 <i>0.386</i>	0.4 <i>0.016</i>	KP-090
# MB700-100	10.0 <i>0.394</i>	11.0 <i>0.433</i>	15.2 <i>0.598</i>	10.0 - 10.1	9.4 <i>0.370</i>	10.8 <i>0.425</i>	0.4 <i>0.016</i>	KP-100
# MB700-120	12.0 <i>0.472</i>	13.0 <i>0.512</i>	18.0 <i>0.709</i>	12.0 - 12.1	10.6 <i>0.417</i>	12.8 <i>0.504</i>	0.4 <i>0.016</i>	KP-120
# MB700-140	14.0 <i>0.551</i>	15.0 <i>0.591</i>	20.8 <i>0.819</i>	14.0 - 14.1	12.7 <i>0.500</i>	14.5 <i>0.571</i>	0.4 <i>0.016</i>	KP-140
# MB700-160	16.0 <i>0.630</i>	17.0 <i>0.669</i>	23.7 <i>0.933</i>	16.0 - 16.1	14.7 <i>0.579</i>	16.5 <i>0.650</i>	0.6 <i>0.024</i>	KP-160
# MB700-180	18.0 <i>0.709</i>	19.0 <i>0.748</i>	26.3 <i>1.035</i>	18.0 - 18.1	16.7 <i>0.657</i>	18.5 <i>0.728</i>	0.6 <i>0.024</i>	KP-180
# MB700-200	20.0 <i>0.787</i>	22.0 <i>0.866</i>	30.5 <i>1.201</i>	20.0 - 20.1	18.7 <i>0.736</i>	21.5 <i>0.846</i>	0.8 <i>0.031</i>	KP-200

Indicates item not stocked at time of printing - Please enquire for lead time

E&OE Pricing and all details subject to change without notice - Copyright Miniature Bearings Australia Pty Ltd

MBA Size Listings are a guide to sizes only and must not be solely relied on for critical design information.

Sealing Plugs - Stainless

Part Number	Outside Diameter (d1) mm	Sleeve Length (l1) mm	Overall Length incl Ball (l2) mm	Recommended Housing Dia. (d2) mm	d3 Max. mm	l3 Min. mm	X (+/- 0.2) mm	KP Punch (to suit) Sold Sep
	<i>inches</i>	<i>inches</i>	<i>inches</i>	<i>inches</i>	<i>inches</i>	<i>inches</i>	<i>inches</i>	
# MB700-220	22.0 <i>0.866</i>	25.0 <i>0.984</i>	34.2 <i>1.346</i>	22.0 - 22.1	20.7 <i>0.815</i>	24.5 <i>0.965</i>	0.8 <i>0.031</i>	KP-220

Indicates item not stocked at time of printing - Please enquire for lead time

E&OE Pricing and all details subject to change without notice - Copyright Miniature Bearings Australia Pty Ltd

MBA Size Listings are a guide to sizes only and must not be solely relied on for critical design information.



DISTRIBUTED BY

Ask us to put your name and address here

<http://www.minibearings.com.au/product>

Ph +61 7 3245 7977

Fax +61 7 3245 1017

Catalogue requests to catalogues@minibearings.com.au
