

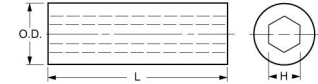

MBA

Sleeves - Hex Hole



Sleeves - Hex Hole

Part Number	Hex Size (H) mm <i>inches</i>	Outside Diameter (OD) mm <i>inches</i>	Length (L) mm <i>inches</i>	Material
# SLHX-03.25x06.35x19.05	3.251 <i>0.128</i>	6.350 <i>0.250</i>	19.050 <i>0.750</i>	1117 Carbon Steel
# SLHX-04.83x09.53x38.10	4.826 <i>0.190</i>	9.525 <i>0.375</i>	38.100 <i>1.500</i>	1117 Carbon Steel
# SLHX-06.43x12.70x50.80	6.426 <i>0.253</i>	12.700 <i>0.500</i>	50.800 <i>2.000</i>	1117 Carbon Steel
# SLHX-08.00x14.29x57.15	8.001 <i>0.315</i>	14.288 <i>0.563</i>	57.150 <i>2.250</i>	1117 Carbon Steel
# SLHX-09.60x15.88x63.50	9.601 <i>0.378</i>	15.875 <i>0.625</i>	63.500 <i>2.500</i>	1117 Carbon Steel

Indicates item not stocked at time of printing - Please enquire for lead time
E&OE Pricing and all details subject to change without notice - Copyright Miniature Bearings Australia Pty Ltd
MBA Size Listings are a guide to sizes only and must not be solely relied on for critical design information.

Sleeves - Hex Hole

Part Number	Hex Size (H) mm <i>inches</i>	Outside Diameter (OD) mm <i>inches</i>	Length (L) mm <i>inches</i>	Material
SLHX-11.18x19.05x66.68	11.176 <i>0.440</i>	19.050 <i>0.750</i>	66.675 <i>2.625</i>	1117 Carbon Steel
# SLHX-12.78x20.64x69.85	12.776 <i>0.503</i>	20.638 <i>0.813</i>	69.850 <i>2.750</i>	1117 Carbon Steel
# SLHX-15.95x25.40x82.55	15.951 <i>0.628</i>	25.400 <i>1.000</i>	82.550 <i>3.250</i>	1117 Carbon Steel

Indicates item not stocked at time of printing - Please enquire for lead time

E&OE Pricing and all details subject to change without notice - Copyright Miniature Bearings Australia Pty Ltd

MBA Size Listings are a guide to sizes only and must not be solely relied on for critical design information.



DISTRIBUTED BY

Ask us to put your name and address here

<http://www.minibearings.com.au/product>

Ph +61 7 3245 7977

Fax +61 7 3245 1017

Catalogue requests to catalogues@minibearings.com.au
