

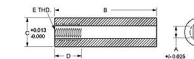

MBA

Sleeves - Square Hole - Threaded



Sleeves - Square Hole - Threaded

| Part Number | Square Size (A) mm <i>inches</i> | Outside Diameter (C) mm <i>inches</i> | Length (B) mm <i>inches</i> | Tool Bit Size mm <i>inches</i> | Thread Depth (D) mm <i>inches</i> | Thread Size | Material |
|-----------------------------|-------------------------------------|--|--------------------------------|-----------------------------------|--------------------------------------|-----------------------|-------------------|
| # SLSQ-03.25x05.56x19.05-TH | 3.251 <i>0.128</i> | 5.563 <i>0.219</i> | 19.050 <i>0.750</i> | 3.175 <i>0.125</i> | 6.350 <i>0.250</i> | 10-32 UNF (4.762mm) | 1117 Carbon Steel |
| # SLSQ-04.86x07.95x38.10-TH | 4.864 <i>0.191</i> | 7.950 <i>0.313</i> | 38.100 <i>1.500</i> | 4.775 <i>0.188</i> | 11.125 <i>0.438</i> | 1/4-28 UNF (6.350mm) | 1117 Carbon Steel |
| # SLSQ-06.48x11.13x50.80-TH | 6.477 <i>0.255</i> | 11.125 <i>0.438</i> | 50.800 <i>2.000</i> | 6.350 <i>0.250</i> | 12.700 <i>0.500</i> | 5/16-24 UNF (7.938mm) | 1117 Carbon Steel |
| # SLSQ-08.06x12.70x57.15-TH | 8.065 <i>0.318</i> | 12.700 <i>0.500</i> | 57.150 <i>2.250</i> | 7.950 <i>0.313</i> | 14.300 <i>0.563</i> | 3/8-24 UNF (9.525mm) | 1117 Carbon Steel |

Indicates item not stocked at time of printing - Please enquire for lead time

E&OE Pricing and all details subject to change without notice - Copyright Miniature Bearings Australia Pty Ltd

MBA Size Listings are a guide to sizes only and must not be solely relied on for critical design information.

Sleeves - Square Hole - Threaded

| Part Number | Square Size (A) mm <i>inches</i> | Outside Diameter (C) mm <i>inches</i> | Length (B) mm <i>inches</i> | Tool Bit Size mm <i>inches</i> | Thread Depth (D) mm <i>inches</i> | Thread Size | Material |
|------------------------------|-------------------------------------|---|--------------------------------|-----------------------------------|---|--------------------------|-------------------|
| # SLSQ-09.65x15.09x63.50-TH | 9.652 <i>0.380</i> | 15.088 <i>0.594</i> | 63.500 <i>2.500</i> | 9.525 <i>0.375</i> | 15.875 <i>0.625</i> | 1/2-20 UNF (12.700mm) | 1117 Carbon Steel |
| # SLSQ-11.24x17.48x66.68-TH | 11.240 <i>0.443</i> | 17.475 <i>0.688</i> | 66.675 <i>2.625</i> | 11.125 <i>0.438</i> | 15.875 <i>0.625</i> | 1/2-20 UNF (12.700mm) | 1117 Carbon Steel |
| # SLSQ-12.83x19.84x69.85-TH | 12.827 <i>0.505</i> | 19.837 <i>0.781</i> | 69.850 <i>2.750</i> | 12.700 <i>0.500</i> | 15.875 <i>0.625</i> | 5/8-18 UNF (15.875mm) | 1117 Carbon Steel |
| # SLSQ-16.00x23.83x82.55-TH | 16.002 <i>0.630</i> | 23.825 <i>0.938</i> | 82.550 <i>3.250</i> | 15.875 <i>0.625</i> | 25.400 <i>1.000</i> | 3/4-16 UNF (19.050mm) | 1117 Carbon Steel |
| # SLSQ-19.18x28.58x101.60-TH | 19.177 <i>0.755</i> | 28.575 <i>1.125</i> | 101.600 <i>4.000</i> | 19.050 <i>0.750</i> | 25.400 <i>1.000</i> | 1in UNS (25.400mm) | 1117 Carbon Steel |
| # SLSQ-22.35x33.35x101.60-TH | 22.352 <i>0.880</i> | 33.350 <i>1.313</i> | 101.600 <i>4.000</i> | 22.225 <i>0.875</i> | 25.400 <i>1.000</i> | 1in UNS (25.400mm) | 1117 Carbon Steel |
| # SLSQ-25.60x38.10x127.00-TH | 25.603 <i>1.008</i> | 38.100 <i>1.500</i> | 127.000 <i>5.000</i> | 25.400 <i>1.000</i> | 38.100 <i>1.500</i> | 1-1/8 UNF (28.575mm) | 1117 Carbon Steel |
| # SLSQ-32.00x50.80x127.00-TH | 32.004 <i>1.260</i> | 50.800 <i>2.000</i> | 127.000 <i>5.000</i> | 31.750 <i>1.250</i> | 38.100 <i>1.500</i> | 1-1/2 UNF (38.100mm) | 1117 Carbon Steel |

Indicates item not stocked at time of printing - Please enquire for lead time

E&OE Pricing and all details subject to change without notice - Copyright Miniature Bearings Australia Pty Ltd

MBA Size Listings are a guide to sizes only and must not be solely relied on for critical design information.



DISTRIBUTED BY

Ask us to put your name and address here

<http://www.minibearings.com.au/product>

Ph +61 7 3245 7977

Fax +61 7 3245 1017

Catalogue requests to catalogues@minibearings.com.au

