

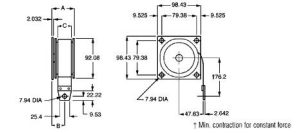

MBA

Spring Assemblies - Single - RINO



Spring: Stainless Steel 301 S21 Grade.

Other Parts: Pressed Mild Steel, Zinc Plate and clear passivated.

Temp Max 200 Deg C / Min -200 Deg C.

Constant force extension springs provide a huge range of application opportunities.

Springs can be extended in excess of 50 times the relaxed length of the spring.

This catalogue to be read in conjunction with information at <http://www.minibearings.com.au/ogue/tech/springs/srsabb.pdf>

Spring Assemblies - Single - RINO

Part Number	Spring Width (C) mm <i>inches</i>	Assembly Width (A) mm <i>inches</i>	Edge to Centre (B) mm <i>inches</i>	Load +/- 10% N	Load +/- 10% KG	Extension mm <i>inches</i>	Average Fatigue Life Cycles
# SA242	35.81 <i>1.410</i>	10.00 <i>0.394</i>	20.57 <i>0.810</i>	10.000	1.0	915 <i>36.024</i>	40000
# SA243	35.81 <i>1.410</i>	13.80 <i>0.543</i>	20.57 <i>0.810</i>	13.800	1.4	1118 <i>44.016</i>	40000
# SA244	35.81 <i>1.410</i>	16.00 <i>0.630</i>	20.57 <i>0.810</i>	16.000	1.6	1321 <i>52.008</i>	40000

Indicates item not stocked at time of printing - Please enquire for lead time

E&OE Pricing and all details subject to change without notice - Copyright Miniature Bearings Australia Pty Ltd

MBA Size Listings are a guide to sizes only and must not be solely relied on for critical design information.

Spring Assemblies - Single - RINO

Part Number	Spring Width (C) mm <i>inches</i>	Assembly Width (A) mm <i>inches</i>	Edge to Centre (B) mm <i>inches</i>	Load +/- 10% N	Load +/- 10% KG	Extension mm <i>inches</i>	Average Fatigue Life Cycles
# SA245	35.81 <i>1.410</i>	18.40 <i>0.724</i>	20.57 <i>0.810</i>	18.400	1.9	1524 <i>60.000</i>	40000
# SA247	35.81 <i>1.410</i>	24.00 <i>0.945</i>	20.57 <i>0.810</i>	24.000	2.5	1321 <i>52.008</i>	15000
# SA249	35.81 <i>1.410</i>	30.30 <i>1.193</i>	20.57 <i>0.810</i>	30.300	3.1	1524 <i>60.000</i>	15000
# SA246	48.51 <i>1.910</i>	20.70 <i>0.815</i>	26.92 <i>1.060</i>	20.700	2.1	1118 <i>44.016</i>	40000
# SA248	48.51 <i>1.910</i>	28.00 <i>1.102</i>	26.92 <i>1.060</i>	28.000	2.9	1524 <i>60.000</i>	40000
# SA251	48.51 <i>1.910</i>	45.40 <i>1.787</i>	26.92 <i>1.060</i>	45.400	4.6	1524 <i>60.000</i>	15000
# SA252	48.51 <i>1.910</i>	70.30 <i>2.768</i>	26.92 <i>1.060</i>	70.300	7.2	2235 <i>87.992</i>	15000
# SA255	48.51 <i>1.910</i>	103.30 <i>4.067</i>	26.92 <i>1.060</i>	103.300	10.5	2235 <i>87.992</i>	5000
# SA250	61.21 <i>2.410</i>	32.30 <i>1.272</i>	33.27 <i>1.310</i>	32.300	3.3	1321 <i>52.008</i>	40000
# SA253	61.21 <i>2.410</i>	80.10 <i>3.154</i>	33.27 <i>1.310</i>	80.100	8.2	1930 <i>75.984</i>	15000

Indicates item not stocked at time of printing - Please enquire for lead time

E&OE Pricing and all details subject to change without notice - Copyright Miniature Bearings Australia Pty Ltd

MBA Size Listings are a guide to sizes only and must not be solely relied on for critical design information.

Spring Assemblies - Single - RINO

Part Number	Spring Width (C) mm <i>inches</i>	Assembly Width (A) mm <i>inches</i>	Edge to Centre (B) mm <i>inches</i>	Load +/- 10% N	Load +/- 10% KG	Extension mm <i>inches</i>	Average Fatigue Life Cycles
# SA254	61.21 <i>2.410</i>	93.50 <i>3.681</i>	33.27 <i>1.310</i>	93.500	9.5	2235 <i>87.992</i>	15000
# SA256	61.21 <i>2.410</i>	138.00 <i>5.433</i>	33.27 <i>1.310</i>	138.000	14.1	2235 <i>87.992</i>	5000

Indicates item not stocked at time of printing - Please enquire for lead time

E&OE Pricing and all details subject to change without notice - Copyright Miniature Bearings Australia Pty Ltd

MBA Size Listings are a guide to sizes only and must not be solely relied on for critical design information.



DISTRIBUTED BY

Ask us to put your name and address here

<http://www.minibearings.com.au/product>

Ph +61 7 3245 7977

Fax +61 7 3245 1017

Catalogue requests to catalogues@minibearings.com.au

