

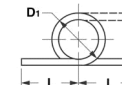

MBA

Springs - Torsion - Left Hand Wound



Left Hand Wound.

180 Deg. Deflection.

Right hand wound and special springs are available on special order.

Springs - Torsion - Left Hand Wound

Part Number	Wire Diameter mm <i>inches</i>	Mandrel Size mm <i>inches</i>	Spring Outside Diameter (D1) mm <i>inches</i>	Length of Leg (L) mm <i>inches</i>	Minimum Axial Space mm <i>inches</i>	Torque N.cm	Material
# TS0277-1270-030-2	0.30 <i>0.012</i>	2.77 <i>0.109</i>	4.24 <i>0.167</i>	12.70 <i>0.500</i>	1.50 <i>0.059</i>	0.50	302 Stainless Steel
# TS0277-1905-038-2	0.38 <i>0.015</i>	2.77 <i>0.109</i>	4.65 <i>0.183</i>	19.05 <i>0.750</i>	1.91 <i>0.075</i>	0.011	302 Stainless Steel
# TS0356-1905-046-2	0.46 <i>0.018</i>	3.56 <i>0.140</i>	5.49 <i>0.216</i>	19.05 <i>0.750</i>	2.77 <i>0.109</i>	0.016	302 Stainless Steel
# TS0396-2540-053-2	0.53 <i>0.021</i>	3.96 <i>0.156</i>	6.27 <i>0.247</i>	25.40 <i>1.000</i>	3.23 <i>0.127</i>	0.025	302 Stainless Steel

Indicates item not stocked at time of printing - Please enquire for lead time

E&OE Pricing and all details subject to change without notice - Copyright Miniature Bearings Australia Pty Ltd

MBA Size Listings are a guide to sizes only and must not be solely relied on for critical design information.

Springs - Torsion - Left Hand Wound

Part Number	Wire Diameter mm <i>inches</i>	Mandrel Size mm <i>inches</i>	Spring Outside Diameter (D1) mm <i>inches</i>	Length of Leg (L) mm <i>inches</i>	Minimum Axial Space mm <i>inches</i>	Torque N.cm	Material
# TS0516-2540-064-2	0.64 <i>0.025</i>	5.16 <i>0.203</i>	7.72 <i>0.304</i>	25.40 <i>1.000</i>	3.84 <i>0.151</i>	0.042	302 Stainless Steel
# TS0635-2540-076-2	0.76 <i>0.030</i>	6.35 <i>0.250</i>	10.01 <i>0.394</i>	25.40 <i>1.000</i>	4.59 <i>0.181</i>	0.071	302 Stainless Steel
TS0714-3175-089-2	0.89 <i>0.035</i>	7.14 <i>0.281</i>	11.43 <i>0.450</i>	31.75 <i>1.250</i>	5.39 <i>0.212</i>	0.113	302 Stainless Steel
TS0871-5080-102-2	1.02 <i>0.040</i>	8.71 <i>0.343</i>	13.16 <i>0.518</i>	50.80 <i>2.000</i>	6.15 <i>0.242</i>	0.155	302 Stainless Steel
TS1031-5080-122-2	1.22 <i>0.048</i>	10.31 <i>0.406</i>	15.70 <i>0.618</i>	50.80 <i>2.000</i>	7.42 <i>0.292</i>	0.282	302 Stainless Steel
# TS1069-5080-137-2	1.37 <i>0.054</i>	10.69 <i>0.421</i>	16.61 <i>0.654</i>	50.80 <i>2.000</i>	10.29 <i>0.405</i>	0.370	302 Stainless Steel
TS1270-5080-160-2	1.60 <i>0.063</i>	12.70 <i>0.500</i>	19.48 <i>0.767</i>	50.80 <i>2.000</i>	12.07 <i>0.475</i>	0.582	302 Stainless Steel

Indicates item not stocked at time of printing - Please enquire for lead time

E&OE Pricing and all details subject to change without notice - Copyright Miniature Bearings Australia Pty Ltd

MBA Size Listings are a guide to sizes only and must not be solely relied on for critical design information.



DISTRIBUTED BY

Ask us to put your name and address here

<http://www.minibearings.com.au/product>

Ph +61 7 3245 7977

Fax +61 7 3245 1017

Catalogue requests to catalogues@minibearings.com.au
