

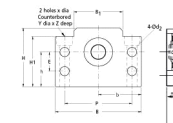

MBA

Supports - Ballscrew - Simple



Incorporates Radial Ball Bearings.

Material : Steel.

Comes complete with bearing and circlip.

This catalogue to be read in conjunction with information at <http://www.minibearings.com.au/ogue/tech/ballscrew/RPBBSB.pdf>

Supports - Ballscrew - Simple

Part Number	Bore Size mm	Thickness mm	Width (B / B1) mm	Height (H / H1) mm	Centre Dimentions (b / h) mm	Distance Between Bolts (E/P) mm	Bolt Holes (d2) mm	Bolt Holes (x / Y / Z) mm	Bearing To Suit
	<i>inches</i>	<i>inches</i>	<i>inches</i>	<i>inches</i>	<i>inches</i>	<i>inches</i>	<i>inches</i>	<i>inches</i>	
# BSB10	8.0 <i>0.315</i>	20.0 <i>0.787</i>	60 / 34	39 / 32.5	30 / 22	15 / 46	5.5 <i>0.217</i>	6.6 / 11 / 5	608ZZ
# BSB12	10.0 <i>0.394</i>	20.0 <i>0.787</i>	60 / 35	43 / 32.5	30 / 25	18 / 46	5.5 <i>0.217</i>	6.6 / 11 / 1.5	6000ZZ
# BSB15	15.0 <i>0.591</i>	20.0 <i>0.787</i>	70 / 40	48 / 38	35 / 28	18 / 54	5.5 <i>0.217</i>	6.6 / 11 / 6.5	6002ZZ
# BSB17	17.0 <i>0.669</i>	23.0 <i>0.906</i>	86 / 50	64 / 55	43 / 39	28 / 68	6.6 <i>0.260</i>	9 / 14 / 8.5	6203ZZ

Indicates item not stocked at time of printing - Please enquire for lead time

E&OE Pricing and all details subject to change without notice - Copyright Miniature Bearings Australia Pty Ltd

MBA Size Listings are a guide to sizes only and must not be solely relied on for critical design information.

Supports - Ballscrew - Simple

Part Number	Bore Size mm	Thickness mm	Width (B / B1) mm	Height (H / H1) mm	Centre Dimentions (b / h) mm	Distance Between Bolts (E/P) mm	Bolt Holes (d2) mm	Bolt Holes (x / Y / Z) mm	Bearing To Suit
	<i>inches</i>	<i>inches</i>	<i>inches</i>	<i>inches</i>	<i>inches</i>	<i>inches</i>	<i>inches</i>	<i>inches</i>	
# BSB20	20.0 <i>0.787</i>	26.0 <i>1.024</i>	88 / 52	60 / 50	44 / 34	22 / 70	6.6 <i>0.260</i>	9 / 14 / 8.5	6004ZZ
# BSB25	25.0 <i>0.984</i>	30.0 <i>1.181</i>	106 / 64	80 / 70	53 / 48	33 / 85	9 <i>0.354</i>	11 / 17.5 / 11	6205ZZ
# BSB30	30.0 <i>1.181</i>	32.0 <i>1.260</i>	128 / 76	89 / 78	64 / 51	33 / 102	11 <i>0.433</i>	14 / 20 / 13	6206ZZ
# BSB40	40.0 <i>1.575</i>	37.0 <i>1.457</i>	160 / 100	110 / 90	80 / 60	37 / 130	14 <i>0.551</i>	18 / 26 / 17.5	6208ZZ

Indicates item not stocked at time of printing - Please enquire for lead time

E&OE Pricing and all details subject to change without notice - Copyright Miniature Bearings Australia Pty Ltd

MBA Size Listings are a guide to sizes only and must not be solely relied on for critical design information.



DISTRIBUTED BY

Ask us to put your name and address here

<http://www.minibearings.com.au/product>

Ph +61 7 3245 7977

Fax +61 7 3245 1017

Catalogue requests to catalogues@minibearings.com.au

