



Mounts - Leveling - Socket Type - Acme Thread - Stainless Steel

9/4/2018

Indicates item not stocked at time of printing - Please enquire for lead time

E&OE Pricing and all details subject to change without notice - Copyright Miniature Bearings Australia Pty Ltd

MBA Size Listings are a guide to sizes only and must not be solely relied on for critical design information.

INFORMATION

Use your own acme thread to make a custom stud. 303 Stainless Steel. Adjusters.

Indicates item not stocked at time of printing - Please enquire for lead time

E&OE Pricing and all details subject to change without notice - Copyright Miniature Bearings Australia Pty Ltd

MBA Size Listings are a guide to sizes only and must not be solely relied on for critical design information.

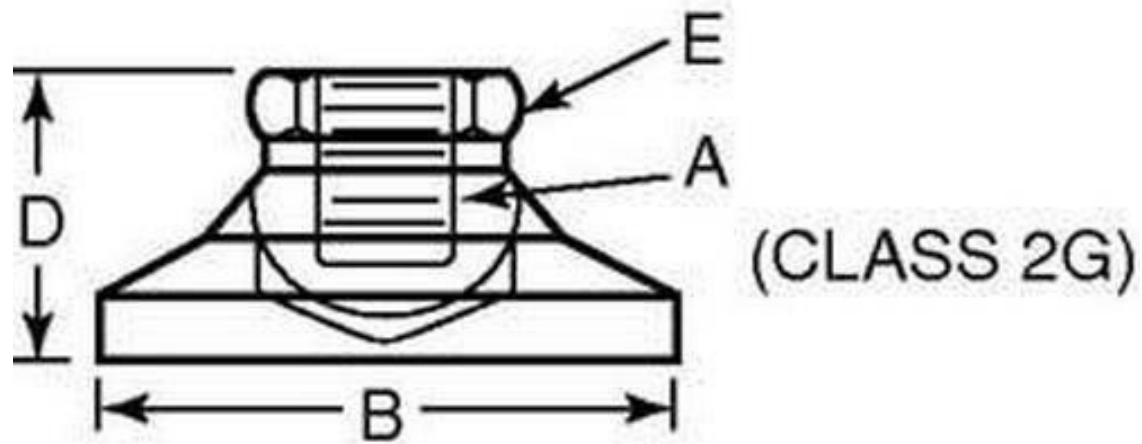

Indicates item not stocked at time of printing - Please enquire for lead time

E&OE Pricing and all details subject to change without notice - Copyright Miniature Bearings Australia Pty Ltd

MBA Size Listings are a guide to sizes only and must not be solely relied on for critical design information.

Mounts - Leveling - Socket Type - Acme Thread - Stainless Steel

Part Number	Load Kg	Thread	Base Diameter (B)	Height (D)	Hex Flats (E)	Material	Finish
# MLV-0680-0635A-S3	680	1/4-16 (6.350mm)	25.400	26.975	12.700	303 Stainless Steel	-
# MLV-1700-0793A-S3	1700	5/16-14 (7.938mm)	31.750	22.225	15.875	303 Stainless Steel	-
# MLV-2550-0953A-S3	2550	3/8-12 (9.525mm)	31.750	22.225	15.875	303 Stainless Steel	-
# MLV-3400-1270A-S3	3400	1/2-10 (12.700mm)	47.625	28.575	19.050	303 Stainless Steel	-
# MLV-4080-1588A-S3	4080	5/8-8 (15.875mm)	63.500	31.750	22.225	303 Stainless Steel	-
# MLV-5030-1905A-S3	5030	3/4-6 (19.050mm)	76.200	38.100	26.975	303 Stainless Steel	-
# MLV-13610-2540A-S3	13610	1-5 (25.400mm)	101.600	34.925	34.925	303 Stainless Steel	-

Indicates item not stocked at time of printing - Please enquire for lead time

E&OE Pricing and all details subject to change without notice - Copyright Miniature Bearings Australia Pty Ltd

MBA Size Listings are a guide to sizes only and must not be solely relied on for critical design information.

DISTRIBUTED BY

Distributed By:

