



Mounts - Leveling - Socket Type - Steel - Nickel Plated - With Pad

9/4/2018

Indicates item not stocked at time of printing - Please enquire for lead time

E&OE Pricing and all details subject to change without notice - Copyright Miniature Bearings Australia Pty Ltd

MBA Size Listings are a guide to sizes only and must not be solely relied on for critical design information.

INFORMATION

15⁰ swivel off centreline to adjust to uneven surfaces and level machine tools, electronic racks and benches. Adjusters.

Indicates item not stocked at time of printing - Please enquire for lead time

E&OE Pricing and all details subject to change without notice - Copyright Miniature Bearings Australia Pty Ltd

MBA Size Listings are a guide to sizes only and must not be solely relied on for critical design information.

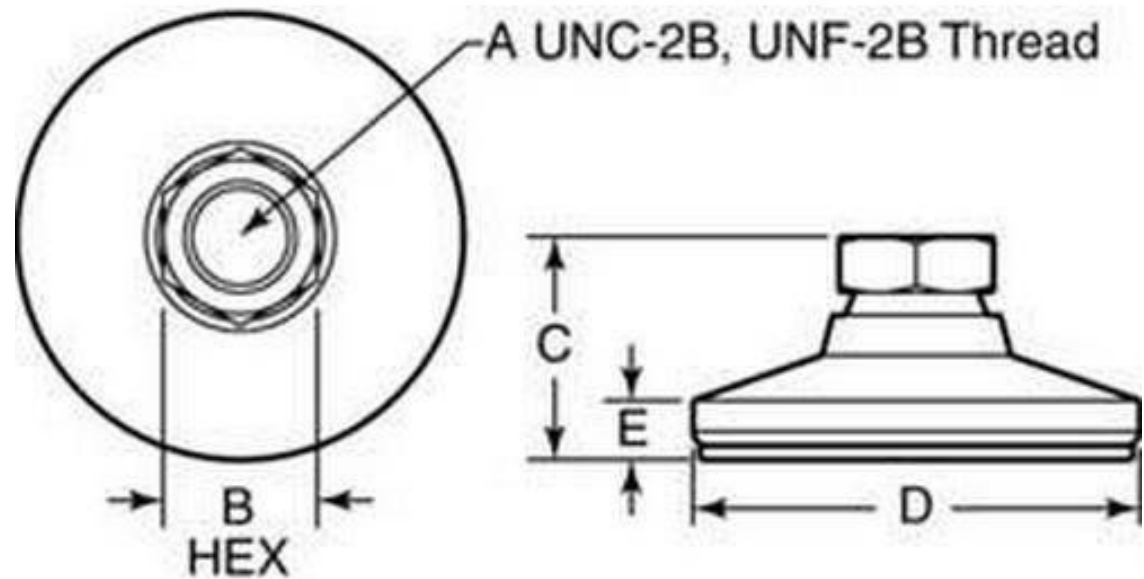

Indicates item not stocked at time of printing - Please enquire for lead time

E&OE Pricing and all details subject to change without notice - Copyright Miniature Bearings Australia Pty Ltd

MBA Size Listings are a guide to sizes only and must not be solely relied on for critical design information.

Mounts - Leveling - Socket Type - Steel - Nickel Plated - With Pad

Part Number	Load Kg	Thread Size	Min.Thread Depth mm	Hex Flats (B) mm	Foot Height (C) mm	Base Diameter (D) mm	Base Height (E) mm	Finish	Pad Material	Pad Thickness
			<i>inches</i>	<i>inches</i>	<i>inches</i>	<i>inches</i>	<i>inches</i>			
# MLV-0110-M06-NP1	110	M6.0x1.00 (6.0mm)	4.000 <i>0.157</i>	10.000 <i>0.394</i>	17.000 <i>0.669</i>	19.000 <i>0.748</i>	6.000 <i>0.236</i>	Nickel Plated	Elastomer	3.175
# MLV-0150-M08-NP1	150	M8.0x1.25 (8.0mm)	8.000 <i>0.315</i>	12.000 <i>0.472</i>	21.000 <i>0.827</i>	25.000 <i>0.984</i>	7.000 <i>0.276</i>	Nickel Plated	Elastomer	3.175
# MLV-0240-0476F-NP1	240	10-32 UNF (4.762mm)	4.318 <i>0.170</i>	9.525 <i>0.375</i>	13.462 <i>0.530</i>	19.050 <i>0.750</i>	2.794 <i>0.110</i>	Nickel Plated	Elastomer	3.175
# MLV-0340-0635C-NP1	340	1/4-20 UNC (6.35mm)	7.874 <i>0.310</i>	12.700 <i>0.500</i>	17.780 <i>0.700</i>	25.400 <i>1.000</i>	3.810 <i>0.150</i>	Nickel Plated	Elastomer	3.175
# MLV-0580-M10-NP1	580	M10.0x1.50 (10.0mm)	10.000 <i>0.394</i>	16.000 <i>0.630</i>	25.000 <i>0.984</i>	32.000 <i>1.260</i>	8.000 <i>0.315</i>	Nickel Plated	Elastomer	3.175
# MLV-0770-M12-NP1	770	M12.0x1.75 (12.0mm)	11.000 <i>0.433</i>	20.000 <i>0.787</i>	32.000 <i>1.260</i>	48.000 <i>1.890</i>	10.000 <i>0.394</i>	Nickel Plated	Elastomer	3.175
# MLV-0930-M16-NP1	930	M16.0x2.00 (16.0mm)	11.000 <i>0.433</i>	22.000 <i>0.866</i>	35.000 <i>1.378</i>	64.000 <i>2.520</i>	11.000 <i>0.433</i>	Nickel Plated	Elastomer	3.175
# MLV-1140-M20-NP1	1140	M20.0x2.50 (20.0mm)	16.000 <i>0.630</i>	27.000 <i>1.063</i>	41.000 <i>1.614</i>	76.000 <i>2.992</i>	16.000 <i>0.630</i>	Nickel Plated	Elastomer	3.175

Indicates item not stocked at time of printing - Please enquire for lead time

Page 4 of 5

E&OE Pricing and all details subject to change without notice - Copyright Miniature Bearings Australia Pty Ltd
MBA Size Listings are a guide to sizes only and must not be solely relied on for critical design information.

Mounts - Leveling - Socket Type - Steel - Nickel Plated - With Pad

Part Number	Load Kg	Thread Size	Min.Thread Depth mm	Hex Flats (B) mm	Foot Height (C) mm	Base Diameter (D) mm	Base Height (E) mm	Finish	Pad Material	Pad Thickness
			<i>inches</i>	<i>inches</i>	<i>inches</i>	<i>inches</i>	<i>inches</i>			
# MLV-1270-0953C-NP1	1270	3/8-16 UNC (9.525mm)	9.652 <i>0.380</i>	15.875 <i>0.625</i>	22.225 <i>0.875</i>	31.750 <i>1.250</i>	4.763 <i>0.188</i>	Nickel Plated	Elastomer	3.175
# MLV-1700-1270C-NP1	1700	1/2-13 UNC (12.7mm)	11.176 <i>0.440</i>	19.050 <i>0.750</i>	28.575 <i>1.125</i>	47.625 <i>1.875</i>	6.350 <i>0.250</i>	Nickel Plated	Elastomer	3.175
# MLV-2040-1590C-NP1	2040	5/8-11 UNC (15.875mm)	11.176 <i>0.440</i>	22.225 <i>0.875</i>	31.750 <i>1.250</i>	63.500 <i>2.500</i>	7.938 <i>0.313</i>	Nickel Plated	Elastomer	3.175
# MLV-2450-1905C-NP1	2450	3/4-10 UNC (19.05mm)	15.748 <i>0.620</i>	26.988 <i>1.063</i>	38.100 <i>1.500</i>	76.200 <i>3.000</i>	12.700 <i>0.500</i>	Nickel Plated	Elastomer	3.175
# MLV-3080-M24-NP1	3080	M24.0x3.00 (24.0mm)	20.000 <i>0.787</i>	35.000 <i>1.378</i>	51.000 <i>2.008</i>	102.000 <i>4.016</i>	14.000 <i>0.551</i>	Nickel Plated	Elastomer	3.175
# MLV-6800-2540C-NP1	6800	1-8 UNC (25.40mm)	20.574 <i>0.810</i>	34.925 <i>1.375</i>	47.625 <i>1.875</i>	101.600 <i>4.000</i>	13.494 <i>0.531</i>	Nickel Plated	Elastomer	3.175

Indicates item not stocked at time of printing - Please enquire for lead time

E&OE Pricing and all details subject to change without notice - Copyright Miniature Bearings Australia Pty Ltd
MBA Size Listings are a guide to sizes only and must not be solely relied on for critical design information.

DISTRIBUTED BY

Distributed By:

