



# Pins - Ball Lock - Shackle

10/4/2018

# Indicates item not stocked at time of printing - Please enquire for lead time

E&OE Pricing and all details subject to change without notice - Copyright Miniature Bearings Australia Pty Ltd

MBA Size Listings are a guide to sizes only and must not be solely relied on for critical design information.

## INFORMATION

Pins will not release until spindle is depressed. Four balls for high loads. Body and spindle are made from 4130 alloy steel. Also called detent pins.

# Indicates item not stocked at time of printing - Please enquire for lead time

E&OE Pricing and all details subject to change without notice - Copyright Miniature Bearings Australia Pty Ltd

MBA Size Listings are a guide to sizes only and must not be solely relied on for critical design information.

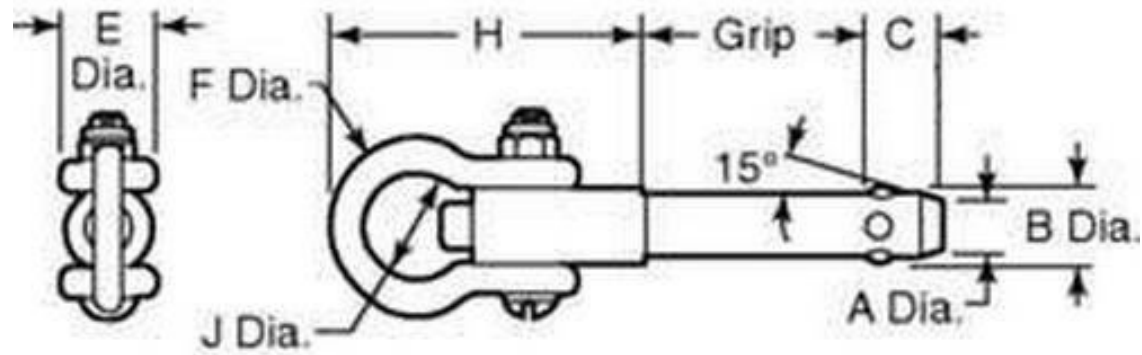

# Indicates item not stocked at time of printing - Please enquire for lead time

E&OE Pricing and all details subject to change without notice - Copyright Miniature Bearings Australia Pty Ltd

MBA Size Listings are a guide to sizes only and must not be solely relied on for critical design information.

## Pins - Ball Lock - Shackle

Part Number	Nominal Diameter mm	Grip Length mm	Locking Ball to End (C) mm	Open Ball Distance (B)	Handle Ring Diameter (E) mm	Ring Diameter (F) mm	Handle Height (H) mm	Ring Radius (J) mm	Ultimate Load at 90 Deg Kg
	<i>inches</i>	<i>inches</i>	<i>inches</i>	<i>inches</i>	<i>inches</i>	<i>inches</i>	<i>inches</i>	<i>inches</i>	
# BLP-095-0127-SHK-C	9.53 <i>0.375</i>	12.70 <i>0.500</i>	10.80 <i>0.425</i>	11.13 <i>0.438</i>	19.05 <i>0.750</i>	6.35 <i>0.250</i>	72.39 <i>2.850</i>	17.45 <i>0.687</i>	790
# BLP-095-0508-SHK-C	9.53 <i>0.375</i>	50.80 <i>2.000</i>	10.80 <i>0.425</i>	11.13 <i>0.438</i>	19.05 <i>0.750</i>	6.35 <i>0.250</i>	72.39 <i>2.850</i>	17.45 <i>0.687</i>	790
# BLP-127-0127-SHK-C	12.70 <i>0.500</i>	12.70 <i>0.500</i>	13.18 <i>0.519</i>	15.06 <i>0.593</i>	20.63 <i>0.812</i>	7.93 <i>0.312</i>	80.01 <i>3.150</i>	20.63 <i>0.812</i>	1745
# BLP-127-0381-SHK-C	12.70 <i>0.500</i>	38.10 <i>1.500</i>	13.18 <i>0.519</i>	15.06 <i>0.593</i>	20.63 <i>0.812</i>	7.93 <i>0.312</i>	80.01 <i>3.150</i>	20.63 <i>0.812</i>	1745
# BLP-191-0254-SHK-C	19.05 <i>0.750</i>	25.40 <i>1.000</i>	17.96 <i>0.707</i>	22.53 <i>0.887</i>	28.58 <i>1.125</i>	11.10 <i>0.437</i>	102.87 <i>4.050</i>	28.58 <i>1.125</i>	4490

# Indicates item not stocked at time of printing - Please enquire for lead time

Page 4 of 4

E&OE Pricing and all details subject to change without notice - Copyright Miniature Bearings Australia Pty Ltd  
MBA Size Listings are a guide to sizes only and must not be solely relied on for critical design information.

DISTRIBUTED BY

Distributed By:

