



Pins - Ball Lock - T-Handle - Commercial

10/4/2018

Indicates item not stocked at time of printing - Please enquire for lead time

E&OE Pricing and all details subject to change without notice - Copyright Miniature Bearings Australia Pty Ltd

MBA Size Listings are a guide to sizes only and must not be solely relied on for critical design information.

Page 1 of 7

INFORMATION

Quick release. Stainless steel commercial pins provide strong locking and are perfect for less demanding applications where fastening and locating are needed. Tee handle. Also called detent pins.

Economical.

Aluminium handles.

360 Brass Button.

300 Grade stainless pin.

Use industrial grade T handled pins when higher double shear strength is required

Indicates item not stocked at time of printing - Please enquire for lead time

E&OE Pricing and all details subject to change without notice - Copyright Miniature Bearings Australia Pty Ltd

MBA Size Listings are a guide to sizes only and must not be solely relied on for critical design information.

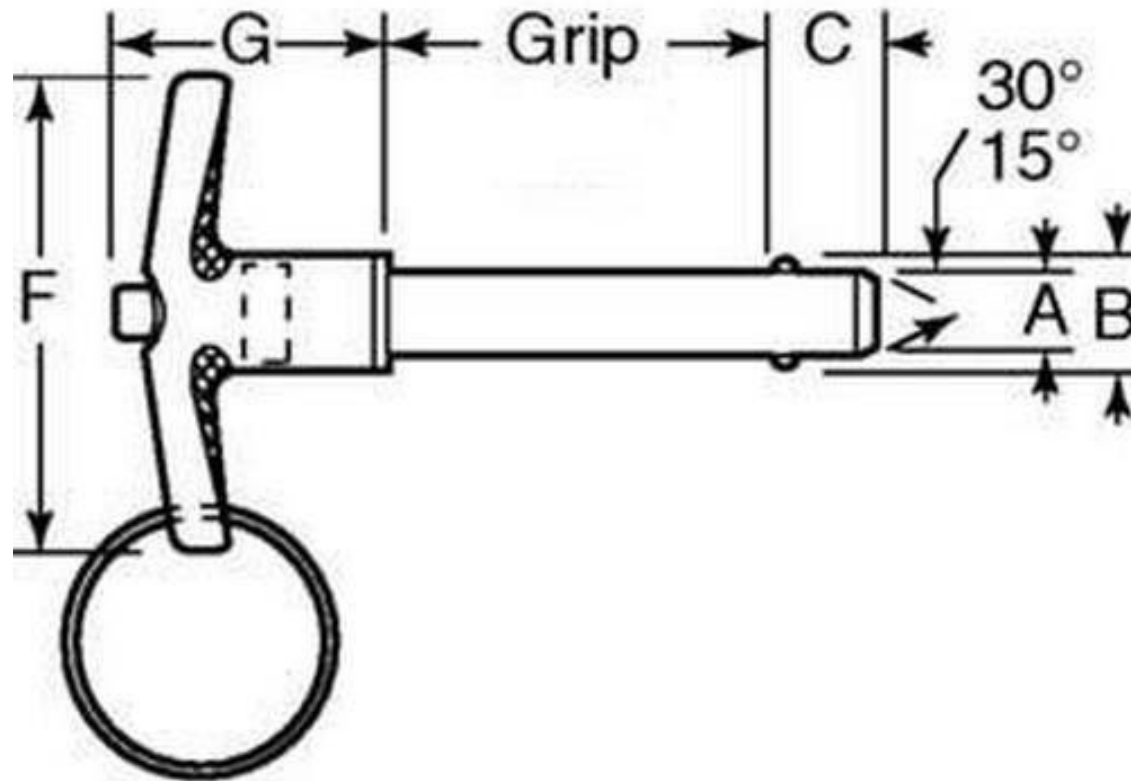

Indicates item not stocked at time of printing - Please enquire for lead time

E&OE Pricing and all details subject to change without notice - Copyright Miniature Bearings Australia Pty Ltd

MBA Size Listings are a guide to sizes only and must not be solely relied on for critical design information.

Pins - Ball Lock - T-Handle - Commercial

| Part Number | Nominal Diameter mm <i>inches</i> | Grip Length mm <i>inches</i> | Locking Ball to End (C) mm <i>inches</i> | Locking Ball Diameter (B) mm <i>inches</i> | Handle Diameter (F) mm <i>inches</i> | Handle Height (G) mm <i>inches</i> | Pull Out Strength Kg | Calc. Double Shear Strength Kg |
|---------------------|---|---------------------------------|--|--|--|--|-------------------------|-----------------------------------|
| # BLP-064-0127-TC-C | 6.35 <i>0.250</i> | 12.70 <i>0.500</i> | 7.37 <i>0.290</i> | 7.34 <i>0.289</i> | 46.10 <i>1.815</i> | 32.26 <i>1.270</i> | 80.00 | 980 |
| BLP-064-0254-TC-C | 6.35 <i>0.250</i> | 25.40 <i>1.000</i> | 7.37 <i>0.290</i> | 7.34 <i>0.289</i> | 46.10 <i>1.815</i> | 32.26 <i>1.270</i> | 80.00 | 980 |
| # BLP-064-0381-TC-C | 6.35 <i>0.250</i> | 38.10 <i>1.500</i> | 7.37 <i>0.290</i> | 7.34 <i>0.289</i> | 46.10 <i>1.815</i> | 32.26 <i>1.270</i> | 80.00 | 980 |
| BLP-064-0508-TC-C | 6.35 <i>0.250</i> | 50.80 <i>2.000</i> | 7.37 <i>0.290</i> | 7.34 <i>0.289</i> | 46.10 <i>1.815</i> | 32.26 <i>1.270</i> | 80.00 | 980 |
| # BLP-064-0635-TC-C | 6.35 <i>0.250</i> | 63.50 <i>2.500</i> | 7.37 <i>0.290</i> | 7.34 <i>0.289</i> | 46.10 <i>1.815</i> | 32.26 <i>1.270</i> | 80.00 | 980 |
| # BLP-064-0762-TC-C | 6.35 <i>0.250</i> | 76.20 <i>3.000</i> | 7.37 <i>0.290</i> | 7.34 <i>0.289</i> | 46.10 <i>1.815</i> | 32.26 <i>1.270</i> | 80.00 | 980 |
| # BLP-064-0889-TC-C | 6.35 <i>0.250</i> | 88.90 <i>3.500</i> | 7.37 <i>0.290</i> | 7.34 <i>0.289</i> | 46.10 <i>1.815</i> | 32.26 <i>1.270</i> | 80.00 | 980 |
| # BLP-064-1016-TC-C | 6.35 <i>0.250</i> | 101.60 <i>4.000</i> | 7.37 <i>0.290</i> | 7.34 <i>0.289</i> | 46.10 <i>1.815</i> | 32.26 <i>1.270</i> | 80.00 | 980 |
| BLP-079-0127-TC-C | 7.94 <i>0.313</i> | 12.70 <i>0.500</i> | 8.38 <i>0.330</i> | 9.53 <i>0.375</i> | 46.10 <i>1.815</i> | 32.26 <i>1.270</i> | 178.00 | 1560 |
| # BLP-079-0254-TC-C | 7.94 <i>0.313</i> | 25.40 <i>1.000</i> | 8.38 <i>0.330</i> | 9.53 <i>0.375</i> | 46.10 <i>1.815</i> | 32.26 <i>1.270</i> | 178.00 | 1560 |

Indicates item not stocked at time of printing - Please enquire for lead time

Page 4 of 7

E&OE Pricing and all details subject to change without notice - Copyright Miniature Bearings Australia Pty Ltd

MBA Size Listings are a guide to sizes only and must not be solely relied on for critical design information.

Pins - Ball Lock - T-Handle - Commercial

| Part Number | Nominal Diameter mm <i>inches</i> | Grip Length mm <i>inches</i> | Locking Ball to End (C) mm <i>inches</i> | Locking Ball Diameter (B) mm <i>inches</i> | Handle Diameter (F) mm <i>inches</i> | Handle Height (G) mm <i>inches</i> | Pull Out Strength Kg | Calc. Double Shear Strength Kg |
|---------------------|---|---------------------------------|--|--|--|--|-------------------------|-----------------------------------|
| # BLP-079-0381-TC-C | 7.94 <i>0.313</i> | 38.10 <i>1.500</i> | 8.38 <i>0.330</i> | 9.53 <i>0.375</i> | 46.10 <i>1.815</i> | 32.26 <i>1.270</i> | 178.00 | 1560 |
| BLP-079-0508-TC-C | 7.94 <i>0.313</i> | 50.80 <i>2.000</i> | 8.38 <i>0.330</i> | 9.53 <i>0.375</i> | 46.10 <i>1.815</i> | 32.26 <i>1.270</i> | 178.00 | 1560 |
| # BLP-079-0635-TC-C | 7.94 <i>0.313</i> | 63.50 <i>2.500</i> | 8.38 <i>0.330</i> | 9.53 <i>0.375</i> | 46.10 <i>1.815</i> | 32.26 <i>1.270</i> | 178.00 | 1560 |
| # BLP-079-0762-TC-C | 7.94 <i>0.313</i> | 76.20 <i>3.000</i> | 8.38 <i>0.330</i> | 9.53 <i>0.375</i> | 46.10 <i>1.815</i> | 32.26 <i>1.270</i> | 178.00 | 1560 |
| # BLP-079-0889-TC-C | 7.94 <i>0.313</i> | 88.90 <i>3.500</i> | 8.38 <i>0.330</i> | 9.53 <i>0.375</i> | 46.10 <i>1.815</i> | 32.26 <i>1.270</i> | 178.00 | 1560 |
| # BLP-079-1016-TC-C | 7.94 <i>0.313</i> | 101.60 <i>4.000</i> | 8.38 <i>0.330</i> | 9.53 <i>0.375</i> | 46.10 <i>1.815</i> | 32.26 <i>1.270</i> | 178.00 | 1560 |
| BLP-095-0127-TC-C | 9.53 <i>0.375</i> | 12.70 <i>0.500</i> | 9.27 <i>0.365</i> | 11.18 <i>0.440</i> | 52.45 <i>2.065</i> | 36.83 <i>1.450</i> | 200.00 | 2000 |
| # BLP-095-0254-TC-C | 9.53 <i>0.375</i> | 25.40 <i>1.000</i> | 9.27 <i>0.365</i> | 11.18 <i>0.440</i> | 52.45 <i>2.065</i> | 36.83 <i>1.450</i> | 200.00 | 2000 |
| # BLP-095-0381-TC-C | 9.53 <i>0.375</i> | 38.10 <i>1.500</i> | 9.27 <i>0.365</i> | 11.18 <i>0.440</i> | 52.45 <i>2.065</i> | 36.83 <i>1.450</i> | 200.00 | 2000 |
| BLP-095-0508-TC-C | 9.53 <i>0.375</i> | 50.80 <i>2.000</i> | 9.27 <i>0.365</i> | 11.18 <i>0.440</i> | 52.45 <i>2.065</i> | 36.83 <i>1.450</i> | 200.00 | 2000 |

Indicates item not stocked at time of printing - Please enquire for lead time

Page 5 of 7

E&OE Pricing and all details subject to change without notice - Copyright Miniature Bearings Australia Pty Ltd

MBA Size Listings are a guide to sizes only and must not be solely relied on for critical design information.

Pins - Ball Lock - T-Handle - Commercial

| Part Number | Nominal Diameter mm <i>inches</i> | Grip Length mm <i>inches</i> | Locking Ball to End (C) mm <i>inches</i> | Locking Ball Diameter (B) mm <i>inches</i> | Handle Diameter (F) mm <i>inches</i> | Handle Height (G) mm <i>inches</i> | Pull Out Strength Kg | Calc. Double Shear Strength Kg |
|---------------------|---|---------------------------------|--|--|--|--|-------------------------|-----------------------------------|
| # BLP-095-0635-TC-C | 9.53 <i>0.375</i> | 63.50 <i>2.500</i> | 9.27 <i>0.365</i> | 11.18 <i>0.440</i> | 52.45 <i>2.065</i> | 36.83 <i>1.450</i> | 200.00 | 2000 |
| # BLP-095-0762-TC-C | 9.53 <i>0.375</i> | 76.20 <i>3.000</i> | 9.27 <i>0.365</i> | 11.18 <i>0.440</i> | 52.45 <i>2.065</i> | 36.83 <i>1.450</i> | 200.00 | 2000 |
| # BLP-095-0889-TC-C | 9.53 <i>0.375</i> | 88.90 <i>3.500</i> | 9.27 <i>0.365</i> | 11.18 <i>0.440</i> | 52.45 <i>2.065</i> | 36.83 <i>1.450</i> | 200.00 | 2000 |
| # BLP-095-1016-TC-C | 9.53 <i>0.375</i> | 101.60 <i>4.000</i> | 9.27 <i>0.365</i> | 11.18 <i>0.440</i> | 52.45 <i>2.065</i> | 36.83 <i>1.450</i> | 200.00 | 2000 |
| # BLP-127-0127-TC-C | 12.70 <i>0.500</i> | 12.70 <i>0.500</i> | 11.68 <i>0.460</i> | 15.09 <i>0.594</i> | 59.56 <i>2.345</i> | 40.64 <i>1.600</i> | 400.00 | 5130 |
| # BLP-127-0254-TC-C | 12.70 <i>0.500</i> | 25.40 <i>1.000</i> | 11.68 <i>0.460</i> | 15.09 <i>0.594</i> | 59.56 <i>2.345</i> | 40.64 <i>1.600</i> | 400.00 | 5130 |
| # BLP-127-0381-TC-C | 12.70 <i>0.500</i> | 38.10 <i>1.500</i> | 11.68 <i>0.460</i> | 15.09 <i>0.594</i> | 59.56 <i>2.345</i> | 40.64 <i>1.600</i> | 400.00 | 5130 |
| # BLP-127-0508-TC-C | 12.70 <i>0.500</i> | 50.80 <i>2.000</i> | 11.68 <i>0.460</i> | 15.09 <i>0.594</i> | 59.56 <i>2.345</i> | 40.64 <i>1.600</i> | 400.00 | 5130 |
| BLP-127-0635-TC-C | 12.70 <i>0.500</i> | 63.50 <i>2.500</i> | 11.68 <i>0.460</i> | 15.09 <i>0.594</i> | 59.56 <i>2.345</i> | 40.64 <i>1.600</i> | 400.00 | 5130 |
| # BLP-127-0762-TC-C | 12.70 <i>0.500</i> | 76.20 <i>3.000</i> | 11.68 <i>0.460</i> | 15.09 <i>0.594</i> | 59.56 <i>2.345</i> | 40.64 <i>1.600</i> | 400.00 | 5130 |

Indicates item not stocked at time of printing - Please enquire for lead time

Page 6 of 7

E&OE Pricing and all details subject to change without notice - Copyright Miniature Bearings Australia Pty Ltd
MBA Size Listings are a guide to sizes only and must not be solely relied on for critical design information.

Pins - Ball Lock - T-Handle - Commercial

| Part Number | Nominal Diameter mm <i>inches</i> | Grip Length mm <i>inches</i> | Locking Ball to End (C) mm <i>inches</i> | Locking Ball Diameter (B) mm <i>inches</i> | Handle Diameter (F) mm <i>inches</i> | Handle Height (G) mm <i>inches</i> | Pull Out Strength Kg | Calc. Double Shear Strength Kg |
|---------------------|---|---------------------------------|--|--|--|--|-------------------------|-----------------------------------|
| # BLP-127-0889-TC-C | 12.70 <i>0.500</i> | 88.90 <i>3.500</i> | 11.68 <i>0.460</i> | 15.09 <i>0.594</i> | 59.56 <i>2.345</i> | 40.64 <i>1.600</i> | 400.00 | 5130 |
| BLP-127-1016-TC-C | 12.70 <i>0.500</i> | 101.60 <i>4.000</i> | 11.68 <i>0.460</i> | 15.09 <i>0.594</i> | 59.56 <i>2.345</i> | 40.64 <i>1.600</i> | 400.00 | 5130 |
| # BLP-159-0127-TC-C | 15.88 <i>0.625</i> | 12.70 <i>0.500</i> | 14.73 <i>0.580</i> | 19.05 <i>0.750</i> | 78.74 <i>3.100</i> | 43.18 <i>1.700</i> | 660.00 | 8480 |
| # BLP-159-0254-TC-C | 15.88 <i>0.625</i> | 25.40 <i>1.000</i> | 14.73 <i>0.580</i> | 19.05 <i>0.750</i> | 78.74 <i>3.100</i> | 43.18 <i>1.700</i> | 660.00 | 8480 |
| # BLP-159-0381-TC-C | 15.88 <i>0.625</i> | 38.10 <i>1.500</i> | 14.73 <i>0.580</i> | 19.05 <i>0.750</i> | 78.74 <i>3.100</i> | 43.18 <i>1.700</i> | 660.00 | 8480 |
| # BLP-159-0508-TC-C | 15.88 <i>0.625</i> | 50.80 <i>2.000</i> | 14.73 <i>0.580</i> | 19.05 <i>0.750</i> | 78.74 <i>3.100</i> | 43.18 <i>1.700</i> | 660.00 | 8480 |
| # BLP-159-0635-TC-C | 15.88 <i>0.625</i> | 63.50 <i>2.500</i> | 14.73 <i>0.580</i> | 19.05 <i>0.750</i> | 78.74 <i>3.100</i> | 43.18 <i>1.700</i> | 660.00 | 8480 |
| BLP-159-0762-TC-C | 15.88 <i>0.625</i> | 76.20 <i>3.000</i> | 14.73 <i>0.580</i> | 19.05 <i>0.750</i> | 78.74 <i>3.100</i> | 43.18 <i>1.700</i> | 660.00 | 8480 |
| # BLP-159-0889-TC-C | 15.88 <i>0.625</i> | 88.90 <i>3.500</i> | 14.73 <i>0.580</i> | 19.05 <i>0.750</i> | 78.74 <i>3.100</i> | 43.18 <i>1.700</i> | 660.00 | 8480 |
| # BLP-159-1016-TC-C | 15.88 <i>0.625</i> | 101.60 <i>4.000</i> | 14.73 <i>0.580</i> | 19.05 <i>0.750</i> | 78.74 <i>3.100</i> | 43.18 <i>1.700</i> | 660.00 | 8480 |

Indicates item not stocked at time of printing - Please enquire for lead time

Page 7 of 7

E&OE Pricing and all details subject to change without notice - Copyright Miniature Bearings Australia Pty Ltd
MBA Size Listings are a guide to sizes only and must not be solely relied on for critical design information.

DISTRIBUTED BY

Distributed By:

