



Pins - Ball Lock - T-Handle - Industrial - Stainless Steel

10/4/2018

Indicates item not stocked at time of printing - Please enquire for lead time

E&OE Pricing and all details subject to change without notice - Copyright Miniature Bearings Australia Pty Ltd

MBA Size Listings are a guide to sizes only and must not be solely relied on for critical design information.

Page 1 of 11

INFORMATION

Quick release. Body and spindle 17-4 PH stainless steel. Ring and spring 17-7 MO stainless steel. Handle and collar are 300 grade stainless. Tee handle. Also called detent pins.

Indicates item not stocked at time of printing - Please enquire for lead time

E&OE Pricing and all details subject to change without notice - Copyright Miniature Bearings Australia Pty Ltd

MBA Size Listings are a guide to sizes only and must not be solely relied on for critical design information.

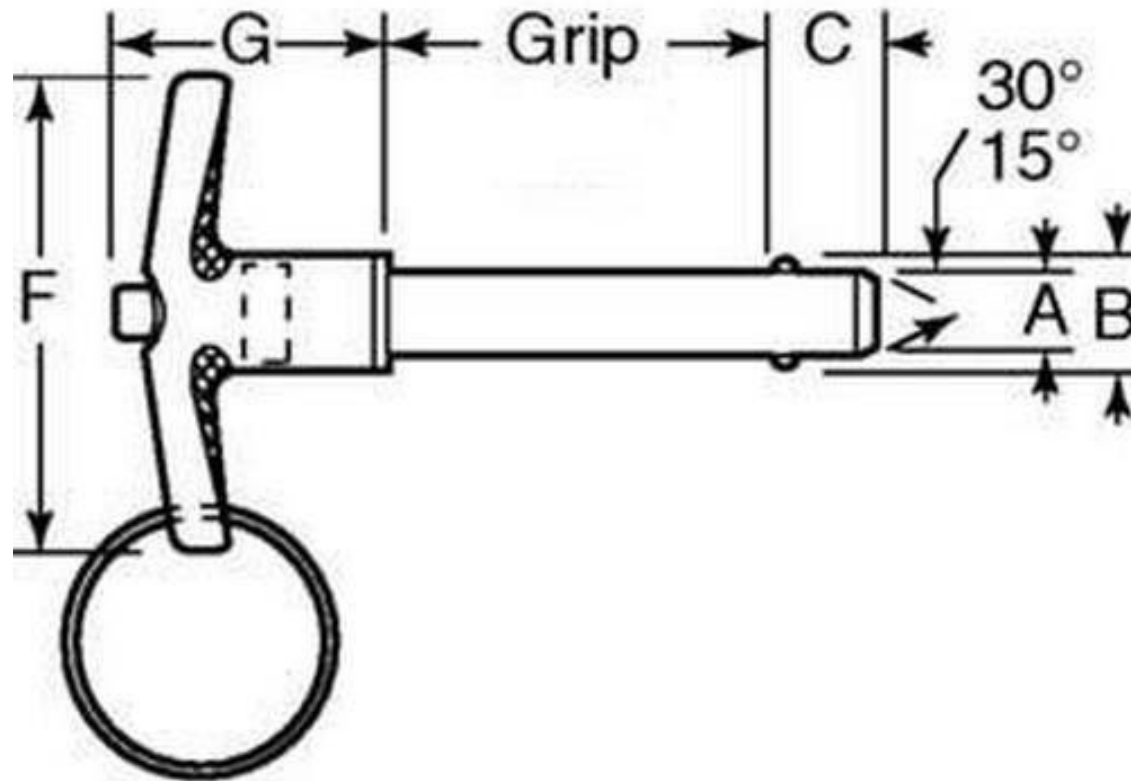

Indicates item not stocked at time of printing - Please enquire for lead time

E&OE Pricing and all details subject to change without notice - Copyright Miniature Bearings Australia Pty Ltd

MBA Size Listings are a guide to sizes only and must not be solely relied on for critical design information.

Pins - Ball Lock - T-Handle - Industrial - Stainless Steel

Part Number	Nominal Diameter mm <i>inches</i>	Grip Length mm <i>inches</i>	Locking Ball to End (C) mm <i>inches</i>	Extended Ball Distance (B) mm <i>inches</i>	Handle Width (F) mm <i>inches</i>	Handle Length (G) mm <i>inches</i>	Pull Out Strength Kg	Calc. Double Shear Strength Kg
# BLP-048-0127-TI-S17	4.76 <i>0.187</i>	12.70 <i>0.500</i>	6.60 <i>0.260</i>	5.58 <i>0.220</i>	46.10 <i>1.815</i>	32.25 <i>1.270</i>	89.00	2300
# BLP-048-0254-TI-S17	4.76 <i>0.187</i>	25.40 <i>1.000</i>	6.60 <i>0.260</i>	5.58 <i>0.220</i>	46.10 <i>1.815</i>	32.25 <i>1.270</i>	89.00	2300
# BLP-048-0381-TI-S17	4.76 <i>0.187</i>	38.10 <i>1.500</i>	6.60 <i>0.260</i>	5.58 <i>0.220</i>	46.10 <i>1.815</i>	32.25 <i>1.270</i>	89.00	2300
# BLP-048-0508-TI-S17	4.76 <i>0.187</i>	50.80 <i>2.000</i>	6.60 <i>0.260</i>	5.58 <i>0.220</i>	46.10 <i>1.815</i>	32.25 <i>1.270</i>	89.00	2300
# BLP-048-0635-TI-S17	4.76 <i>0.187</i>	63.50 <i>2.500</i>	6.60 <i>0.260</i>	5.58 <i>0.220</i>	46.10 <i>1.815</i>	32.25 <i>1.270</i>	89.00	2300
# BLP-048-0762-TI-S17	4.76 <i>0.187</i>	76.20 <i>3.000</i>	6.60 <i>0.260</i>	5.58 <i>0.220</i>	46.10 <i>1.815</i>	32.25 <i>1.270</i>	89.00	2300
# BLP-064-0127-TI-S17	6.35 <i>0.250</i>	12.70 <i>0.500</i>	7.36 <i>0.290</i>	7.34 <i>0.289</i>	46.10 <i>1.815</i>	32.25 <i>1.270</i>	102.00	4100
# BLP-064-0254-TI-S17	6.35 <i>0.250</i>	25.40 <i>1.000</i>	7.36 <i>0.290</i>	7.34 <i>0.289</i>	46.10 <i>1.815</i>	32.25 <i>1.270</i>	102.00	4100
# BLP-064-0381-TI-S17	6.35 <i>0.250</i>	38.10 <i>1.500</i>	7.36 <i>0.290</i>	7.34 <i>0.289</i>	46.10 <i>1.815</i>	32.25 <i>1.270</i>	102.00	4100
# BLP-064-0508-TI-S17	6.35 <i>0.250</i>	50.80 <i>2.000</i>	7.36 <i>0.290</i>	7.34 <i>0.289</i>	46.10 <i>1.815</i>	32.25 <i>1.270</i>	102.00	4100

Indicates item not stocked at time of printing - Please enquire for lead time

Page 4 of 11

E&OE Pricing and all details subject to change without notice - Copyright Miniature Bearings Australia Pty Ltd
MBA Size Listings are a guide to sizes only and must not be solely relied on for critical design information.

Pins - Ball Lock - T-Handle - Industrial - Stainless Steel

Part Number	Nominal Diameter mm <i>inches</i>	Grip Length mm <i>inches</i>	Locking Ball to End (C) mm <i>inches</i>	Extended Ball Distance (B) mm <i>inches</i>	Handle Width (F) mm <i>inches</i>	Handle Length (G) mm <i>inches</i>	Pull Out Strength Kg	Calc. Double Shear Strength Kg
# BLP-064-0635-TI-S17	6.35 <i>0.250</i>	63.50 <i>2.500</i>	7.36 <i>0.290</i>	7.34 <i>0.289</i>	46.10 <i>1.815</i>	32.25 <i>1.270</i>	102.00	4100
# BLP-064-0762-TI-S17	6.35 <i>0.250</i>	76.20 <i>3.000</i>	7.36 <i>0.290</i>	7.34 <i>0.289</i>	46.10 <i>1.815</i>	32.25 <i>1.270</i>	102.00	4100
# BLP-064-0889-TI-S17	6.35 <i>0.250</i>	88.90 <i>3.500</i>	7.36 <i>0.290</i>	7.34 <i>0.289</i>	46.10 <i>1.815</i>	32.25 <i>1.270</i>	102.00	4100
# BLP-064-1016-TI-S17	6.35 <i>0.250</i>	101.60 <i>4.000</i>	7.36 <i>0.290</i>	7.34 <i>0.289</i>	46.10 <i>1.815</i>	32.25 <i>1.270</i>	102.00	4100
# BLP-079-0254-TI-S17	7.94 <i>0.313</i>	25.40 <i>1.000</i>	8.38 <i>0.330</i>	9.52 <i>0.375</i>	46.10 <i>1.815</i>	32.25 <i>1.270</i>	225.00	6400
# BLP-079-0381-TI-S17	7.94 <i>0.313</i>	38.10 <i>1.500</i>	8.38 <i>0.330</i>	9.52 <i>0.375</i>	46.10 <i>1.815</i>	32.25 <i>1.270</i>	225.00	6400
# BLP-079-0508-TI-S17	7.94 <i>0.313</i>	50.80 <i>2.000</i>	8.38 <i>0.330</i>	9.52 <i>0.375</i>	46.10 <i>1.815</i>	32.25 <i>1.270</i>	225.00	6400
# BLP-079-0635-TI-S17	7.94 <i>0.313</i>	63.50 <i>2.500</i>	8.38 <i>0.330</i>	9.52 <i>0.375</i>	46.10 <i>1.815</i>	32.25 <i>1.270</i>	225.00	6400
# BLP-079-0762-TI-S17	7.94 <i>0.313</i>	76.20 <i>3.000</i>	8.38 <i>0.330</i>	9.52 <i>0.375</i>	46.10 <i>1.815</i>	32.25 <i>1.270</i>	225.00	6400
# BLP-079-0889-TI-S17	7.94 <i>0.313</i>	88.90 <i>3.500</i>	8.38 <i>0.330</i>	9.52 <i>0.375</i>	46.10 <i>1.815</i>	32.25 <i>1.270</i>	225.00	6400

Indicates item not stocked at time of printing - Please enquire for lead time

Page 5 of 11

E&OE Pricing and all details subject to change without notice - Copyright Miniature Bearings Australia Pty Ltd
MBA Size Listings are a guide to sizes only and must not be solely relied on for critical design information.

Pins - Ball Lock - T-Handle - Industrial - Stainless Steel

Part Number	Nominal Diameter mm <i>inches</i>	Grip Length mm <i>inches</i>	Locking Ball to End (C) mm <i>inches</i>	Extended Ball Distance (B) mm <i>inches</i>	Handle Width (F) mm <i>inches</i>	Handle Length (G) mm <i>inches</i>	Pull Out Strength Kg	Calc. Double Shear Strength Kg
# BLP-079-1016-TI-S17	7.94 <i>0.313</i>	101.60 <i>4.000</i>	8.38 <i>0.330</i>	9.52 <i>0.375</i>	46.10 <i>1.815</i>	32.25 <i>1.270</i>	225.00	6400
# BLP-079-1270-TI-S17	7.94 <i>0.313</i>	127.00 <i>5.000</i>	8.38 <i>0.330</i>	9.52 <i>0.375</i>	46.10 <i>1.815</i>	32.25 <i>1.270</i>	225.00	6400
# BLP-079-1524-TI-S17	7.94 <i>0.313</i>	152.40 <i>6.000</i>	8.38 <i>0.330</i>	9.52 <i>0.375</i>	46.10 <i>1.815</i>	32.25 <i>1.270</i>	225.00	6400
# BLP-095-0254-TI-S17	9.53 <i>0.375</i>	25.40 <i>1.000</i>	9.27 <i>0.365</i>	11.17 <i>0.440</i>	52.45 <i>2.065</i>	36.83 <i>1.450</i>	256.00	9100
BLP-095-0381-TI-S17	9.53 <i>0.375</i>	38.10 <i>1.500</i>	9.27 <i>0.365</i>	11.17 <i>0.440</i>	52.45 <i>2.065</i>	36.83 <i>1.450</i>	256.00	9100
# BLP-095-0508-TI-S17	9.53 <i>0.375</i>	50.80 <i>2.000</i>	9.27 <i>0.365</i>	11.17 <i>0.440</i>	52.45 <i>2.065</i>	36.83 <i>1.450</i>	256.00	9100
# BLP-095-0635-TI-S17	9.53 <i>0.375</i>	63.50 <i>2.500</i>	9.27 <i>0.365</i>	11.17 <i>0.440</i>	52.45 <i>2.065</i>	36.83 <i>1.450</i>	256.00	9100
# BLP-095-0762-TI-S17	9.53 <i>0.375</i>	76.20 <i>3.000</i>	9.27 <i>0.365</i>	11.17 <i>0.440</i>	52.45 <i>2.065</i>	36.83 <i>1.450</i>	256.00	9100
# BLP-095-0889-TI-S17	9.53 <i>0.375</i>	88.90 <i>3.500</i>	9.27 <i>0.365</i>	11.17 <i>0.440</i>	52.45 <i>2.065</i>	36.83 <i>1.450</i>	256.00	9100
# BLP-095-1016-TI-S17	9.53 <i>0.375</i>	101.60 <i>4.000</i>	9.27 <i>0.365</i>	11.17 <i>0.440</i>	52.45 <i>2.065</i>	36.83 <i>1.450</i>	256.00	9100

Indicates item not stocked at time of printing - Please enquire for lead time

Page 6 of 11

E&OE Pricing and all details subject to change without notice - Copyright Miniature Bearings Australia Pty Ltd
MBA Size Listings are a guide to sizes only and must not be solely relied on for critical design information.

Pins - Ball Lock - T-Handle - Industrial - Stainless Steel

Part Number	Nominal Diameter mm <i>inches</i>	Grip Length mm <i>inches</i>	Locking Ball to End (C) mm <i>inches</i>	Extended Ball Distance (B) mm <i>inches</i>	Handle Width (F) mm <i>inches</i>	Handle Length (G) mm <i>inches</i>	Pull Out Strength Kg	Calc. Double Shear Strength Kg
# BLP-095-1143-TI-S17	9.53 <i>0.375</i>	114.30 <i>4.500</i>	9.27 <i>0.365</i>	11.17 <i>0.440</i>	52.45 <i>2.065</i>	36.83 <i>1.450</i>	256.00	9100
# BLP-095-1270-TI-S17	9.53 <i>0.375</i>	127.00 <i>5.000</i>	9.27 <i>0.365</i>	11.17 <i>0.440</i>	52.45 <i>2.065</i>	36.83 <i>1.450</i>	256.00	9100
# BLP-095-1524-TI-S17	9.53 <i>0.375</i>	152.40 <i>6.000</i>	9.27 <i>0.365</i>	11.17 <i>0.440</i>	52.45 <i>2.065</i>	36.83 <i>1.450</i>	256.00	9100
# BLP-111-0254-TI-S17	11.11 <i>0.437</i>	25.40 <i>1.000</i>	9.65 <i>0.380</i>	12.92 <i>0.509</i>	52.45 <i>2.065</i>	36.83 <i>1.450</i>	316.00	12450
# BLP-111-0381-TI-S17	11.11 <i>0.437</i>	38.10 <i>1.500</i>	9.65 <i>0.380</i>	12.92 <i>0.509</i>	52.45 <i>2.065</i>	36.83 <i>1.450</i>	316.00	12450
# BLP-111-0508-TI-S17	11.11 <i>0.437</i>	50.80 <i>2.000</i>	9.65 <i>0.380</i>	12.92 <i>0.509</i>	52.45 <i>2.065</i>	36.83 <i>1.450</i>	316.00	12450
# BLP-111-0635-TI-S17	11.11 <i>0.437</i>	63.50 <i>2.500</i>	9.65 <i>0.380</i>	12.92 <i>0.509</i>	52.45 <i>2.065</i>	36.83 <i>1.450</i>	316.00	12450
# BLP-111-0762-TI-S17	11.11 <i>0.437</i>	76.20 <i>3.000</i>	9.65 <i>0.380</i>	12.92 <i>0.509</i>	50.80 <i>2.000</i>	36.50 <i>1.437</i>	316.00	12450
# BLP-127-0254-TI-S17	12.70 <i>0.500</i>	25.40 <i>1.000</i>	11.68 <i>0.460</i>	15.08 <i>0.594</i>	59.56 <i>2.345</i>	40.64 <i>1.600</i>	517.00	16360
# BLP-127-0381-TI-S17	12.70 <i>0.500</i>	38.10 <i>1.500</i>	11.68 <i>0.460</i>	15.08 <i>0.594</i>	59.56 <i>2.345</i>	40.64 <i>1.600</i>	517.00	16360

Indicates item not stocked at time of printing - Please enquire for lead time

Page 7 of 11

E&OE Pricing and all details subject to change without notice - Copyright Miniature Bearings Australia Pty Ltd

MBA Size Listings are a guide to sizes only and must not be solely relied on for critical design information.

Pins - Ball Lock - T-Handle - Industrial - Stainless Steel

Part Number	Nominal Diameter mm <i>inches</i>	Grip Length mm <i>inches</i>	Locking Ball to End (C) mm <i>inches</i>	Extended Ball Distance (B) mm <i>inches</i>	Handle Width (F) mm <i>inches</i>	Handle Length (G) mm <i>inches</i>	Pull Out Strength Kg	Calc. Double Shear Strength Kg
# BLP-127-0508-TI-S17	12.70 <i>0.500</i>	50.80 <i>2.000</i>	11.68 <i>0.460</i>	15.08 <i>0.594</i>	59.56 <i>2.345</i>	40.64 <i>1.600</i>	517.00	16360
# BLP-127-0635-TI-S17	12.70 <i>0.500</i>	63.50 <i>2.500</i>	11.68 <i>0.460</i>	15.08 <i>0.594</i>	59.56 <i>2.345</i>	40.64 <i>1.600</i>	517.00	16360
# BLP-127-0762-TI-S17	12.70 <i>0.500</i>	76.20 <i>3.000</i>	11.68 <i>0.460</i>	15.08 <i>0.594</i>	59.56 <i>2.345</i>	40.64 <i>1.600</i>	517.00	16360
# BLP-127-0889-TI-S17	12.70 <i>0.500</i>	88.90 <i>3.500</i>	11.68 <i>0.460</i>	15.08 <i>0.594</i>	59.56 <i>2.345</i>	40.64 <i>1.600</i>	517.00	16360
# BLP-127-1016-TI-S17	12.70 <i>0.500</i>	101.60 <i>4.000</i>	11.68 <i>0.460</i>	15.08 <i>0.594</i>	59.56 <i>2.345</i>	40.64 <i>1.600</i>	517.00	16360
# BLP-127-1143-TI-S17	12.70 <i>0.500</i>	114.30 <i>4.500</i>	11.68 <i>0.460</i>	15.08 <i>0.594</i>	59.56 <i>2.345</i>	40.64 <i>1.600</i>	517.00	16360
# BLP-127-1270-TI-S17	12.70 <i>0.500</i>	127.00 <i>5.000</i>	11.68 <i>0.460</i>	15.08 <i>0.594</i>	59.56 <i>2.345</i>	40.64 <i>1.600</i>	517.00	16360
# BLP-127-1397-TI-S17	12.70 <i>0.500</i>	139.70 <i>5.500</i>	11.68 <i>0.460</i>	15.08 <i>0.594</i>	59.56 <i>2.345</i>	40.64 <i>1.600</i>	517.00	16360
# BLP-127-1524-TI-S17	12.70 <i>0.500</i>	152.40 <i>6.000</i>	11.68 <i>0.460</i>	15.08 <i>0.594</i>	59.56 <i>2.345</i>	40.64 <i>1.600</i>	517.00	16360
# BLP-159-0058-TI-S17	15.88 <i>0.625</i>	5.80 <i>0.228</i>	14.73 <i>0.580</i>	19.05 <i>0.750</i>	78.74 <i>3.100</i>	43.18 <i>1.700</i>	924.00	25570

Indicates item not stocked at time of printing - Please enquire for lead time

Page 8 of 11

E&OE Pricing and all details subject to change without notice - Copyright Miniature Bearings Australia Pty Ltd
MBA Size Listings are a guide to sizes only and must not be solely relied on for critical design information.

Pins - Ball Lock - T-Handle - Industrial - Stainless Steel

Part Number	Nominal Diameter mm <i>inches</i>	Grip Length mm <i>inches</i>	Locking Ball to End (C) mm <i>inches</i>	Extended Ball Distance (B) mm <i>inches</i>	Handle Width (F) mm <i>inches</i>	Handle Length (G) mm <i>inches</i>	Pull Out Strength Kg	Calc. Double Shear Strength Kg
# BLP-159-0381-TI-S17	15.88 <i>0.625</i>	38.10 <i>1.500</i>	14.73 <i>0.580</i>	19.05 <i>0.750</i>	78.74 <i>3.100</i>	43.18 <i>1.700</i>	924.00	25570
# BLP-159-0635-TI-S17	15.88 <i>0.625</i>	63.50 <i>2.500</i>	14.73 <i>0.580</i>	19.05 <i>0.750</i>	78.74 <i>3.100</i>	43.18 <i>1.700</i>	924.00	25570
# BLP-159-0762-TI-S17	15.88 <i>0.625</i>	76.20 <i>3.000</i>	14.73 <i>0.580</i>	19.05 <i>0.750</i>	78.74 <i>3.100</i>	43.18 <i>1.700</i>	924.00	25570
# BLP-159-0889-TI-S17	15.88 <i>0.625</i>	88.90 <i>3.500</i>	14.73 <i>0.580</i>	19.05 <i>0.750</i>	78.74 <i>3.100</i>	43.18 <i>1.700</i>	924.00	25570
# BLP-159-1016-TI-S17	15.88 <i>0.625</i>	101.60 <i>4.000</i>	14.73 <i>0.580</i>	19.05 <i>0.750</i>	78.74 <i>3.100</i>	43.18 <i>1.700</i>	924.00	25570
# BLP-159-1143-TI-S17	15.88 <i>0.625</i>	114.30 <i>4.500</i>	14.73 <i>0.580</i>	19.05 <i>0.750</i>	78.74 <i>3.100</i>	43.18 <i>1.700</i>	924.00	25570
# BLP-159-1270-TI-S17	15.88 <i>0.625</i>	127.00 <i>5.000</i>	14.73 <i>0.580</i>	19.05 <i>0.750</i>	78.74 <i>3.100</i>	43.18 <i>1.700</i>	924.00	25570
# BLP-159-1397-TI-S17	15.88 <i>0.625</i>	139.70 <i>5.500</i>	14.73 <i>0.580</i>	19.05 <i>0.750</i>	78.74 <i>3.100</i>	43.18 <i>1.700</i>	924.00	25570
# BLP-159-1524-TI-S17	15.88 <i>0.625</i>	152.40 <i>6.000</i>	14.73 <i>0.580</i>	19.05 <i>0.750</i>	78.74 <i>3.100</i>	43.18 <i>1.700</i>	924.00	25570
# BLP-191-0381-TI-S17	19.05 <i>0.750</i>	38.10 <i>1.500</i>	17.01 <i>0.670</i>	22.52 <i>0.887</i>	78.74 <i>3.100</i>	43.68 <i>1.720</i>	1316.00	36690

Indicates item not stocked at time of printing - Please enquire for lead time

Page 9 of 11

E&OE Pricing and all details subject to change without notice - Copyright Miniature Bearings Australia Pty Ltd
MBA Size Listings are a guide to sizes only and must not be solely relied on for critical design information.

Pins - Ball Lock - T-Handle - Industrial - Stainless Steel

Part Number	Nominal Diameter mm <i>inches</i>	Grip Length mm <i>inches</i>	Locking Ball to End (C) mm <i>inches</i>	Extended Ball Distance (B) mm <i>inches</i>	Handle Width (F) mm <i>inches</i>	Handle Length (G) mm <i>inches</i>	Pull Out Strength Kg	Calc. Double Shear Strength Kg
# BLP-191-0508-TI-S17	19.05 <i>0.750</i>	50.80 <i>2.000</i>	17.01 <i>0.670</i>	22.52 <i>0.887</i>	78.74 <i>3.100</i>	43.68 <i>1.720</i>	1316.00	36690
# BLP-191-0635-TI-S17	19.05 <i>0.750</i>	63.50 <i>2.500</i>	17.01 <i>0.670</i>	22.52 <i>0.887</i>	78.74 <i>3.100</i>	43.68 <i>1.720</i>	1316.00	36690
# BLP-191-0762-TI-S17	19.05 <i>0.750</i>	76.20 <i>3.000</i>	17.01 <i>0.670</i>	22.52 <i>0.887</i>	78.74 <i>3.100</i>	43.68 <i>1.720</i>	1316.00	36690
# BLP-191-0889-TI-S17	19.05 <i>0.750</i>	88.90 <i>3.500</i>	17.01 <i>0.670</i>	22.52 <i>0.887</i>	78.74 <i>3.100</i>	43.68 <i>1.720</i>	1316.00	36690
# BLP-191-1016-TI-S17	19.05 <i>0.750</i>	101.60 <i>4.000</i>	17.01 <i>0.670</i>	22.52 <i>0.887</i>	78.74 <i>3.100</i>	43.68 <i>1.720</i>	1316.00	36690
# BLP-191-1270-TI-S17	19.05 <i>0.750</i>	127.00 <i>5.000</i>	17.01 <i>0.670</i>	22.52 <i>0.887</i>	78.74 <i>3.100</i>	43.68 <i>1.720</i>	1316.00	36690
# BLP-191-1397-TI-S17	19.05 <i>0.750</i>	139.70 <i>5.500</i>	17.01 <i>0.670</i>	22.52 <i>0.887</i>	78.74 <i>3.100</i>	43.68 <i>1.720</i>	1316.00	36690
# BLP-191-1524-TI-S17	19.05 <i>0.750</i>	152.40 <i>6.000</i>	17.01 <i>0.670</i>	22.52 <i>0.887</i>	78.74 <i>3.100</i>	43.68 <i>1.720</i>	1316.00	36690
# BLP-254-0508-TI-S17	25.40 <i>1.000</i>	50.80 <i>2.000</i>	22.60 <i>0.890</i>	30.96 <i>1.219</i>	89.40 <i>3.520</i>	55.11 <i>2.170</i>	2446.00	65380
# BLP-254-0635-TI-S17	25.40 <i>1.000</i>	63.50 <i>2.500</i>	22.60 <i>0.890</i>	30.96 <i>1.219</i>	89.40 <i>3.520</i>	55.11 <i>2.170</i>	2446.00	65380

Indicates item not stocked at time of printing - Please enquire for lead time

Page 10 of 11

E&OE Pricing and all details subject to change without notice - Copyright Miniature Bearings Australia Pty Ltd
MBA Size Listings are a guide to sizes only and must not be solely relied on for critical design information.

Pins - Ball Lock - T-Handle - Industrial - Stainless Steel

Part Number	Nominal Diameter mm <i>inches</i>	Grip Length mm <i>inches</i>	Locking Ball to End (C) mm <i>inches</i>	Extended Ball Distance (B) mm <i>inches</i>	Handle Width (F) mm <i>inches</i>	Handle Length (G) mm <i>inches</i>	Pull Out Strength Kg	Calc. Double Shear Strength Kg
# BLP-254-0762-TI-S17	25.40 <i>1.000</i>	76.20 <i>3.000</i>	22.60 <i>0.890</i>	30.96 <i>1.219</i>	89.40 <i>3.520</i>	55.11 <i>2.170</i>	2446.00	65380
# BLP-254-1016-TI-S17	25.40 <i>1.000</i>	101.60 <i>4.000</i>	22.60 <i>0.890</i>	30.96 <i>1.219</i>	89.40 <i>3.520</i>	55.11 <i>2.170</i>	2446.00	65380
# BLP-254-1270-TI-S17	25.40 <i>1.000</i>	127.00 <i>5.000</i>	22.60 <i>0.890</i>	30.96 <i>1.219</i>	89.40 <i>3.520</i>	55.11 <i>2.170</i>	2446.00	65380
# BLP-254-1397-TI-S17	25.40 <i>1.000</i>	139.70 <i>5.500</i>	22.60 <i>0.890</i>	30.96 <i>1.219</i>	89.40 <i>3.520</i>	55.11 <i>2.170</i>	2446.00	65380
# BLP-254-1524-TI-S17	25.40 <i>1.000</i>	152.40 <i>6.000</i>	22.60 <i>0.890</i>	30.96 <i>1.219</i>	89.40 <i>3.520</i>	55.11 <i>2.170</i>	2446.00	65380
# BLP-254-1778-TI-S17	25.40 <i>1.000</i>	177.80 <i>7.000</i>	22.60 <i>0.890</i>	30.96 <i>1.219</i>	89.40 <i>3.520</i>	55.11 <i>2.170</i>	2446.00	65380

Indicates item not stocked at time of printing - Please enquire for lead time

Page 11 of 11

E&OE Pricing and all details subject to change without notice - Copyright Miniature Bearings Australia Pty Ltd
MBA Size Listings are a guide to sizes only and must not be solely relied on for critical design information.

DISTRIBUTED BY

Distributed By:

