



Pins - Taper - Imperial - Extractable - External Thread - Stainless Steel

10/4/2018

Indicates item not stocked at time of printing - Please enquire for lead time

E&OE Pricing and all details subject to change without notice - Copyright Miniature Bearings Australia Pty Ltd

MBA Size Listings are a guide to sizes only and must not be solely relied on for critical design information.

Page 1 of 5

INFORMATION

Imperial Sizes 1:48 Taper (1/4 in. per foot). Standard sizes numbers 0 to 14.

This catalogue to be read in conjunction with information at <http://www.minibearings.com.au//partslist/pinstaperimperialminiature/fasteners/all/1/>

<http://www.minibearings.com.au//partslist/pinstapermetricmildsteel/fasteners/all/1/>

<http://www.minibearings.com.au//partslist/pinstapermetricstainlesssteel/fasteners/all/1/>

Indicates item not stocked at time of printing - Please enquire for lead time

E&OE Pricing and all details subject to change without notice - Copyright Miniature Bearings Australia Pty Ltd

MBA Size Listings are a guide to sizes only and must not be solely relied on for critical design information.

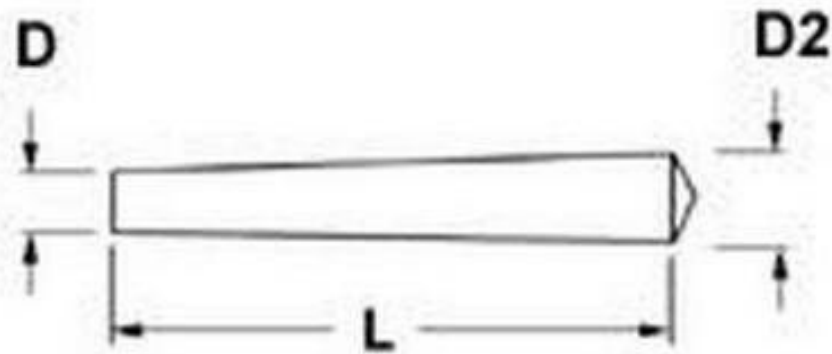

Taper Metric = 1:50
Imperial = 1:48

Indicates item not stocked at time of printing - Please enquire for lead time

E&OE Pricing and all details subject to change without notice - Copyright Miniature Bearings Australia Pty Ltd

MBA Size Listings are a guide to sizes only and must not be solely relied on for critical design information.

Pins - Taper - Imperial - Extractable - External Thread - Stainless Steel

Part Number	Nom. Large End Diameter (D2) mm	Length (L) mm	Nom. Small End Diameter (D) mm	Material	Pin Number	Thread Size
	<i>inches</i>	<i>inches</i>	<i>inches</i>			
# TP-064-0318-S4-EE	6.35 <i>0.250</i>	31.75 <i>1.250</i>	5.64 <i>0.222</i>	304 Stainless	4	1/4 UNF
# TP-075-0318-S4-EE	7.541 <i>0.297</i>	31.75 <i>1.250</i>	6.64 <i>0.261</i>	304 Stainless	5	1/4 UNF
# TP-087-0318-S4-EE	8.73 <i>0.344</i>	31.75 <i>1.250</i>	8.07 <i>0.318</i>	304 Stainless	6	5/16 UNF
# TP-087-1016-S4-EE	8.73 <i>0.344</i>	101.60 <i>4.000</i>	6.61 <i>0.260</i>	304 Stainless	6	5/16 UNF
# TP-103-0381-S4-EE	10.32 <i>0.406</i>	38.10 <i>1.500</i>	9.53 <i>0.375</i>	304 Stainless	7	3/8 UNF
# TP-127-0445-S4-EE	12.70 <i>0.500</i>	44.45 <i>1.750</i>	11.77 <i>0.463</i>	304 Stainless	8	7/16 UNF
# TP-127-0762-S4-EE	12.70 <i>0.500</i>	76.20 <i>3.000</i>	11.11 <i>0.437</i>	304 Stainless	8	7/16 UNF
# TP-127-1016-S4-EE	12.70 <i>0.500</i>	101.60 <i>4.000</i>	10.58 <i>0.417</i>	304 Stainless	8	7/16 UNF
# TP-127-1143-S4-EE	12.70 <i>0.500</i>	114.30 <i>4.500</i>	10.32 <i>0.406</i>	304 Stainless	8	7/16 UNF
# TP-151-1270-S4-EE	15.08 <i>0.594</i>	127.00 <i>5.000</i>	12.44 <i>0.490</i>	304 Stainless	9	1/2 UNF

Indicates item not stocked at time of printing - Please enquire for lead time

Page 4 of 5

E&OE Pricing and all details subject to change without notice - Copyright Miniature Bearings Australia Pty Ltd
MBA Size Listings are a guide to sizes only and must not be solely relied on for critical design information.

Pins - Taper - Imperial - Extractable - External Thread - Stainless Steel

Part Number	Nom. Large End Diameter (D2) mm	Length (L) mm	Nom. Small End Diameter (D) mm	Material	Pin Number	Thread Size
	<i>inches</i>	<i>inches</i>	<i>inches</i>			
# TP-151-1524-S4-EE	15.08 <i>0.594</i>	152.40 <i>6.000</i>	11.91 <i>0.469</i>	304 Stainless	9	1/2 UNF
# TP-183-1143-S4-EE	18.26 <i>0.719</i>	114.30 <i>4.500</i>	15.88 <i>0.625</i>	304 Stainless	10	5/8 UNF
# TP-183-1524-S4-EE	18.26 <i>0.719</i>	152.40 <i>6.000</i>	15.08 <i>0.594</i>	304 Stainless	10	5/8 UNF

Indicates item not stocked at time of printing - Please enquire for lead time

E&OE Pricing and all details subject to change without notice - Copyright Miniature Bearings Australia Pty Ltd
MBA Size Listings are a guide to sizes only and must not be solely relied on for critical design information.

DISTRIBUTED BY

Distributed By:

