



Plungers - Spring - Knurled Handle - Locking - Steel/Acetal

10/4/2018

Indicates item not stocked at time of printing - Please enquire for lead time

E&OE Pricing and all details subject to change without notice - Copyright Miniature Bearings Australia Pty Ltd

MBA Size Listings are a guide to sizes only and must not be solely relied on for critical design information.

Page 1 of 8

INFORMATION

Steel body with acetal nose

Items shown with Long-Lok have a dry threadlocking sealant applied to thread.

Indicates item not stocked at time of printing - Please enquire for lead time

E&OE Pricing and all details subject to change without notice - Copyright Miniature Bearings Australia Pty Ltd

MBA Size Listings are a guide to sizes only and must not be solely relied on for critical design information.

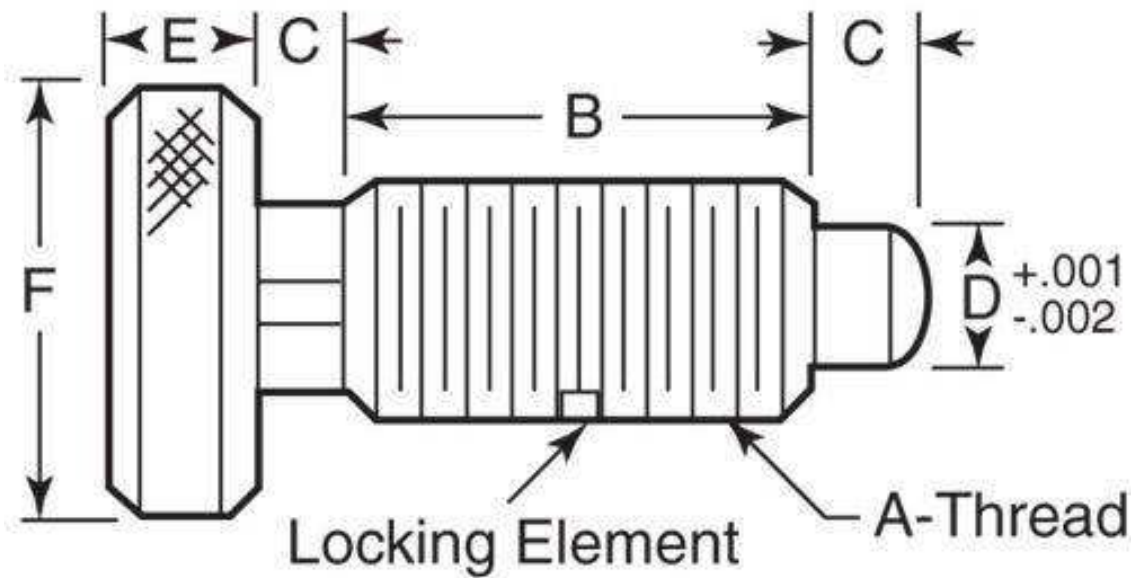

Indicates item not stocked at time of printing - Please enquire for lead time

E&OE Pricing and all details subject to change without notice - Copyright Miniature Bearings Australia Pty Ltd

MBA Size Listings are a guide to sizes only and must not be solely relied on for critical design information.

Plungers - Spring - Knurled Handle - Locking - Steel/Acetal

Part Number	Thread Size (A)	Initial Pressure (F1) N	Final Pressure (F2) N	Thread Length (B) mm	Tip Length (C) mm	Tip Diameter (D) mm	Head Height (E) mm	Head Diameter (F) mm	Additional
				<i>inches</i>	<i>inches</i>	<i>inches</i>	<i>inches</i>	<i>inches</i>	
# PLST-060-127-HKACLLK-011	M6x1 (6mm Standard)	2.00	11.00	12.70	3.17	3.65	6.30	12.70	With Locking Element
				<i>0.500</i>	<i>0.125</i>	<i>0.144</i>	<i>0.248</i>	<i>0.500</i>	
# PLST-060-127-HKACL-011	M6x1 (6mm Standard)	2.00	11.00	12.70	3.17	3.65	6.30	12.70	
				<i>0.500</i>	<i>0.125</i>	<i>0.144</i>	<i>0.248</i>	<i>0.500</i>	
# PLST-060-127-HKACL-022	M6x1 (6mm Standard)	4.50	22.00	12.70	3.17	3.65	6.30	12.70	
				<i>0.500</i>	<i>0.125</i>	<i>0.144</i>	<i>0.248</i>	<i>0.500</i>	
# PLST-060-127-HKACLLK-022	M6x1 (6mm Standard)	4.50	22.00	12.70	3.17	3.65	6.30	12.70	With Locking Element
				<i>0.500</i>	<i>0.125</i>	<i>0.144</i>	<i>0.248</i>	<i>0.500</i>	
PLST-064C-127-HKACL-011	1/4-20 UNC (6.35mm)	2.22	11.12	12.70	3.18	3.66	6.35	12.70	
				<i>0.500</i>	<i>0.125</i>	<i>0.144</i>	<i>0.250</i>	<i>0.500</i>	
# PLST-064C-127-HKACLLK-011	1/4-20 UNC (6.35mm)	2.22	11.12	12.70	3.18	3.66	6.35	12.70	With Locking Element
				<i>0.500</i>	<i>0.125</i>	<i>0.144</i>	<i>0.250</i>	<i>0.500</i>	
# PLST-064C-127-HKACL-022	1/4-20 UNC (6.35mm)	4.45	22.24	12.70	3.18	3.66	6.35	12.70	
				<i>0.500</i>	<i>0.125</i>	<i>0.144</i>	<i>0.250</i>	<i>0.500</i>	
# PLST-064C-127-HKACLLK-022	1/4-20 UNC (6.35mm)	4.45	22.24	12.70	3.18	3.66	6.35	12.70	With Locking Element
				<i>0.500</i>	<i>0.125</i>	<i>0.144</i>	<i>0.250</i>	<i>0.500</i>	

Indicates item not stocked at time of printing - Please enquire for lead time

Page 4 of 8

E&OE Pricing and all details subject to change without notice - Copyright Miniature Bearings Australia Pty Ltd

MBA Size Listings are a guide to sizes only and must not be solely relied on for critical design information.

Plungers - Spring - Knurled Handle - Locking - Steel/Acetal

Part Number	Thread Size (A)	Initial Pressure (F1) N	Final Pressure (F2) N	Thread Length (B) mm	Tip Length (C) mm	Tip Diameter (D) mm	Head Height (E) mm	Head Diameter (F) mm	Additional
				<i>inches</i>	<i>inches</i>	<i>inches</i>	<i>inches</i>	<i>inches</i>	
# PLST-079C-159-HKACLLK-013	5/16-18 UNC (7.938mm)	3.34	13.35	15.88	4.76	4.55	7.14	15.88	With Locking Element
				<i>0.625</i>	<i>0.187</i>	<i>0.179</i>	<i>0.281</i>	<i>0.625</i>	
# PLST-079C-159-HKACL-013	5/16-18 UNC (7.938mm)	3.34	13.35	15.88	4.76	4.55	7.14	15.88	
				<i>0.625</i>	<i>0.187</i>	<i>0.179</i>	<i>0.281</i>	<i>0.625</i>	
# PLST-079C-159-HKACL-027	5/16-18 UNC (7.938mm)	6.67	26.69	15.88	4.76	4.55	7.14	15.88	
				<i>0.625</i>	<i>0.187</i>	<i>0.179</i>	<i>0.281</i>	<i>0.625</i>	
# PLST-079C-159-HKACLLK-027	5/16-18 UNC (7.938mm)	6.67	26.69	15.88	4.76	4.55	7.14	15.88	With Locking Element
				<i>0.625</i>	<i>0.187</i>	<i>0.179</i>	<i>0.281</i>	<i>0.625</i>	
# PLST-080-158-HKACL-013	M8x1.25 (8mm Standard)	3.00	13.00	15.80	4.75	4.54	7.00	15.80	
				<i>0.622</i>	<i>0.187</i>	<i>0.179</i>	<i>0.276</i>	<i>0.622</i>	
# PLST-080-158-HKACLLK-013	M8x1.25 (8mm Standard)	3.00	13.00	15.80	4.75	4.54	7.00	15.80	With Locking Element
				<i>0.622</i>	<i>0.187</i>	<i>0.179</i>	<i>0.276</i>	<i>0.622</i>	
# PLST-080-158-HKACL-027	M8x1.25 (8mm Standard)	6.50	26.50	15.80	4.75	4.54	7.00	15.80	
				<i>0.622</i>	<i>0.187</i>	<i>0.179</i>	<i>0.276</i>	<i>0.622</i>	
# PLST-080-158-HKACLLK-027	M8x1.25 (8mm Standard)	6.50	26.50	15.80	4.75	4.54	7.00	15.80	With Locking Element
				<i>0.622</i>	<i>0.187</i>	<i>0.179</i>	<i>0.276</i>	<i>0.622</i>	

Indicates item not stocked at time of printing - Please enquire for lead time

Page 5 of 8

E&OE Pricing and all details subject to change without notice - Copyright Miniature Bearings Australia Pty Ltd

MBA Size Listings are a guide to sizes only and must not be solely relied on for critical design information.

Plungers - Spring - Knurled Handle - Locking - Steel/Acetal

Part Number	Thread Size (A)	Initial Pressure (F1) N	Final Pressure (F2) N	Thread Length (B) mm	Tip Length (C) mm	Tip Diameter (D) mm	Head Height (E) mm	Head Diameter (F) mm	Additional
				<i>inches</i>	<i>inches</i>	<i>inches</i>	<i>inches</i>	<i>inches</i>	
# PLST-095C-191-HKACL-018	3/8-16 UNC (9.525mm)	3.34	17.79	19.05	5.56	5.49	7.94	19.05	
				<i>0.750</i>	<i>0.219</i>	<i>0.216</i>	<i>0.313</i>	<i>0.750</i>	
# PLST-095C-191-HKACLLK-018	3/8-16 UNC (9.525mm)	3.34	17.79	19.05	5.56	5.49	7.94	19.05	With Locking Element
				<i>0.750</i>	<i>0.219</i>	<i>0.216</i>	<i>0.313</i>	<i>0.750</i>	
# PLST-095C-191-HKACLLK-036	3/8-16 UNC (9.525mm)	6.67	35.59	19.05	5.56	5.49	7.94	19.05	With Locking Element
				<i>0.750</i>	<i>0.219</i>	<i>0.216</i>	<i>0.313</i>	<i>0.750</i>	
# PLST-095C-191-HKACL-036	3/8-16 UNC (9.525mm)	6.67	35.59	19.05	5.56	5.49	7.94	19.05	
				<i>0.750</i>	<i>0.219</i>	<i>0.216</i>	<i>0.313</i>	<i>0.750</i>	
# PLST-100-190-HKACLLK-018	M10x1.5 (10mm Standard)	3.00	18.00	19.00	5.50	5.48	7.90	19.00	With Locking Element
				<i>0.748</i>	<i>0.217</i>	<i>0.216</i>	<i>0.311</i>	<i>0.748</i>	
# PLST-100-190-HKACL-018	M10x1.5 (10mm Standard)	3.00	18.00	19.00	5.50	5.48	7.90	19.00	
				<i>0.748</i>	<i>0.217</i>	<i>0.216</i>	<i>0.311</i>	<i>0.748</i>	
# PLST-100-190-HKACL-036	M10x1.5 (10mm Standard)	6.50	35.50	19.00	5.50	5.48	7.90	19.00	
				<i>0.748</i>	<i>0.217</i>	<i>0.216</i>	<i>0.311</i>	<i>0.748</i>	
# PLST-100-190-HKACLLK-036	M10x1.5 (10mm Standard)	6.50	35.50	19.00	5.50	5.48	7.90	19.00	With Locking Element
				<i>0.748</i>	<i>0.217</i>	<i>0.216</i>	<i>0.311</i>	<i>0.748</i>	

Indicates item not stocked at time of printing - Please enquire for lead time

Page 6 of 8

E&OE Pricing and all details subject to change without notice - Copyright Miniature Bearings Australia Pty Ltd

MBA Size Listings are a guide to sizes only and must not be solely relied on for critical design information.

Plungers - Spring - Knurled Handle - Locking - Steel/Acetal

Part Number	Thread Size (A)	Initial Pressure (F1) N	Final Pressure (F2) N	Thread Length (B) mm	Tip Length (C) mm	Tip Diameter (D) mm	Head Height (E) mm	Head Diameter (F) mm	Additional
				<i>inches</i>	<i>inches</i>	<i>inches</i>	<i>inches</i>	<i>inches</i>	
# PLST-120-222-HKACL-022	M12x1.75 (12mm Standard)	5.50	22.00	22.20	6.35	7.87	9.40	25.40	
				<i>0.874</i>	<i>0.250</i>	<i>0.310</i>	<i>0.370</i>	<i>1.000</i>	
# PLST-120-222-HKACLLK-022	M12x1.75 (12mm Standard)	5.50	22.00	22.20	6.35	7.87	9.40	25.40	With Locking Element
				<i>0.874</i>	<i>0.250</i>	<i>0.310</i>	<i>0.370</i>	<i>1.000</i>	
# PLST-120-222-HKACL-045	M12x1.75 (12mm Standard)	11.00	44.50	22.20	6.35	7.87	9.40	25.40	
				<i>0.874</i>	<i>0.250</i>	<i>0.310</i>	<i>0.370</i>	<i>1.000</i>	
# PLST-120-222-HKACLLK-045	M12x1.75 (12mm Standard)	11.00	44.50	22.20	6.35	7.87	9.40	25.40	With Locking Element
				<i>0.874</i>	<i>0.250</i>	<i>0.310</i>	<i>0.370</i>	<i>1.000</i>	
# PLST-127C-222-HKACLLK-022	1/2-13 UNC (12.7mm)	5.56	22.24	22.23	6.35	7.87	9.53	25.40	With Locking Element
				<i>0.875</i>	<i>0.250</i>	<i>0.310</i>	<i>0.375</i>	<i>1.000</i>	
# PLST-127C-222-HKACL-022	1/2-13 UNC (12.7mm)	5.56	22.24	22.23	6.35	7.87	9.53	25.40	
				<i>0.875</i>	<i>0.250</i>	<i>0.310</i>	<i>0.375</i>	<i>1.000</i>	
# PLST-127C-222-HKACL-044	1/2-13 UNC (12.7mm)	11.12	44.48	22.23	6.35	7.87	9.53	25.40	
				<i>0.875</i>	<i>0.250</i>	<i>0.310</i>	<i>0.375</i>	<i>1.000</i>	
# PLST-127C-222-HKACLLK-044	1/2-13 UNC (12.7mm)	11.12	44.48	22.23	6.35	7.87	9.53	25.40	With Locking Element
				<i>0.875</i>	<i>0.250</i>	<i>0.310</i>	<i>0.375</i>	<i>1.000</i>	

Indicates item not stocked at time of printing - Please enquire for lead time

Page 7 of 8

E&OE Pricing and all details subject to change without notice - Copyright Miniature Bearings Australia Pty Ltd

MBA Size Listings are a guide to sizes only and must not be solely relied on for critical design information.

Plungers - Spring - Knurled Handle - Locking - Steel/Acetal

Part Number	Thread Size (A)	Initial Pressure (F1) N	Final Pressure (F2) N	Thread Length (B) mm	Tip Length (C) mm	Tip Diameter (D) mm	Head Height (E) mm	Head Diameter (F) mm	Additional
				<i>inches</i>	<i>inches</i>	<i>inches</i>	<i>inches</i>	<i>inches</i>	
# PLST-159C-254-HKACL-027	5/8-11 UNC (15.875mm)	13.35	26.69	25.40	7.94	9.47	10.32	28.58	
				<i>1.000</i>	<i>0.313</i>	<i>0.373</i>	<i>0.406</i>	<i>1.125</i>	
# PLST-159C-254-HKACLLK-027	5/8-11 UNC (15.875mm)	13.35	26.69	25.40	7.94	9.47	10.32	28.58	With Locking Element
				<i>1.000</i>	<i>0.313</i>	<i>0.373</i>	<i>0.406</i>	<i>1.125</i>	
# PLST-159C-254-HKACL-044	5/8-11 UNC (15.875mm)	22.24	44.48	25.40	7.94	9.47	10.32	28.58	
				<i>1.000</i>	<i>0.313</i>	<i>0.373</i>	<i>0.406</i>	<i>1.125</i>	
# PLST-159C-254-HKACLLK-044	5/8-11 UNC (15.875mm)	22.24	44.48	25.40	7.94	9.47	10.32	28.58	With Locking Element
				<i>1.000</i>	<i>0.313</i>	<i>0.373</i>	<i>0.406</i>	<i>1.125</i>	
# PLST-160-254-HKACL-027	M16x2 (16mm Standard)	13.00	26.50	25.40	7.92	9.47	10.30	28.60	
				<i>1.000</i>	<i>0.312</i>	<i>0.373</i>	<i>0.406</i>	<i>1.126</i>	
# PLST-160-254-HKACLLK-027	M16x2 (16mm Standard)	13.00	26.50	25.40	7.92	9.47	10.30	28.60	With Locking Element
				<i>1.000</i>	<i>0.312</i>	<i>0.373</i>	<i>0.406</i>	<i>1.126</i>	
# PLST-160-254-HKACLLK-045	M16x2 (16mm Standard)	22.00	44.50	25.40	7.92	9.47	10.30	28.60	With Locking Element
				<i>1.000</i>	<i>0.312</i>	<i>0.373</i>	<i>0.406</i>	<i>1.126</i>	
# PLST-160-254-HKACL-045	M16x2 (16mm Standard)	22.00	44.50	25.40	7.92	9.47	10.30	28.60	
				<i>1.000</i>	<i>0.312</i>	<i>0.373</i>	<i>0.406</i>	<i>1.126</i>	

Indicates item not stocked at time of printing - Please enquire for lead time

Page 8 of 8

E&OE Pricing and all details subject to change without notice - Copyright Miniature Bearings Australia Pty Ltd

MBA Size Listings are a guide to sizes only and must not be solely relied on for critical design information.

DISTRIBUTED BY

Distributed By:

