



Plungers - Spring - Knurled Handle - Locking - Steel/Phenolic

10/4/2018

Indicates item not stocked at time of printing - Please enquire for lead time

E&OE Pricing and all details subject to change without notice - Copyright Miniature Bearings Australia Pty Ltd

MBA Size Listings are a guide to sizes only and must not be solely relied on for critical design information.

Page 1 of 4

INFORMATION

Steel body with phenolic nose

Items shown with Long-Lok have a dry threadlocking sealant applied to thread.

Indicates item not stocked at time of printing - Please enquire for lead time

E&OE Pricing and all details subject to change without notice - Copyright Miniature Bearings Australia Pty Ltd

MBA Size Listings are a guide to sizes only and must not be solely relied on for critical design information.

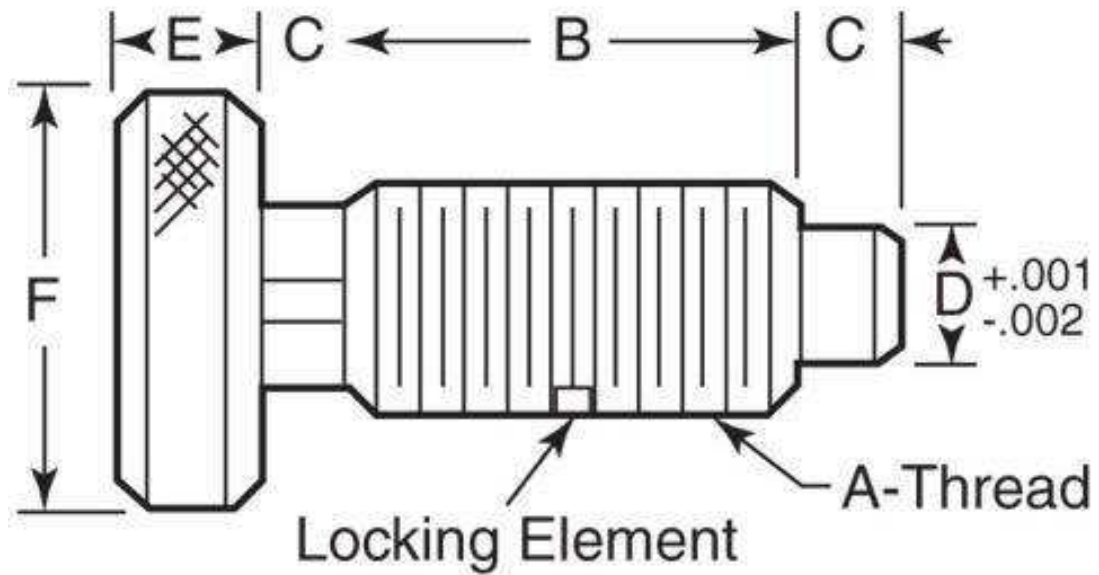

Indicates item not stocked at time of printing - Please enquire for lead time

E&OE Pricing and all details subject to change without notice - Copyright Miniature Bearings Australia Pty Ltd

MBA Size Listings are a guide to sizes only and must not be solely relied on for critical design information.

Plungers - Spring - Knurled Handle - Locking - Steel/Phenolic

Part Number	Thread Size (A)	Initial Pressure (F1) N	Final Pressure (F2) N	Thread Length (B) mm	Tip Length (C) mm	Tip Diameter (D) mm	Head Height (E) mm	Head Diameter (F) mm
				<i>inches</i>	<i>inches</i>	<i>inches</i>	<i>inches</i>	<i>inches</i>
# PLST-064C-127-HKPCL-011	1/4-20 UNC (6.35mm)	2.22	11.12	12.70	3.18	3.15	6.35	12.70
				<i>0.500</i>	<i>0.125</i>	<i>0.124</i>	<i>0.250</i>	<i>0.500</i>
# PLST-064C-127-HKPCL-022	1/4-20 UNC (6.35mm)	4.45	22.24	12.70	3.18	3.15	6.35	12.70
				<i>0.500</i>	<i>0.125</i>	<i>0.124</i>	<i>0.250</i>	<i>0.500</i>
# PLST-079C-159-HKPCL-013	5/16-18 UNC (7.938mm)	3.34	13.35	15.88	4.75	3.94	7.14	15.88
				<i>0.625</i>	<i>0.187</i>	<i>0.155</i>	<i>0.281</i>	<i>0.625</i>
# PLST-079C-159-HKPCL-027	5/16-18 UNC (7.938mm)	6.67	26.69	15.88	4.75	3.94	7.14	15.88
				<i>0.625</i>	<i>0.187</i>	<i>0.155</i>	<i>0.281</i>	<i>0.625</i>
# PLST-095C-191-HKPCL-018	3/8-16 UNC (9.525mm)	3.34	17.79	19.05	5.54	4.72	7.93	19.05
				<i>0.750</i>	<i>0.218</i>	<i>0.186</i>	<i>0.312</i>	<i>0.750</i>
# PLST-095C-191-HKPCL-036	3/8-16 UNC (9.525mm)	6.67	35.59	19.05	5.54	4.72	7.93	19.05
				<i>0.750</i>	<i>0.218</i>	<i>0.186</i>	<i>0.312</i>	<i>0.750</i>
# PLST-127C-222-HKPCL-022	1/2-13 UNC (12.7mm)	5.56	22.24	22.23	6.35	6.33	9.53	25.40
				<i>0.875</i>	<i>0.250</i>	<i>0.249</i>	<i>0.375</i>	<i>1.000</i>
# PLST-127C-222-HKPCL-044	1/2-13 UNC (12.7mm)	11.12	44.48	22.23	6.35	6.33	9.53	25.40
				<i>0.875</i>	<i>0.250</i>	<i>0.249</i>	<i>0.375</i>	<i>1.000</i>

Indicates item not stocked at time of printing - Please enquire for lead time

Page 4 of 4

E&OE Pricing and all details subject to change without notice - Copyright Miniature Bearings Australia Pty Ltd

MBA Size Listings are a guide to sizes only and must not be solely relied on for critical design information.

DISTRIBUTED BY

Distributed By:

