



Screws - Button - Socket - Zinc Plated

10/4/2018

Indicates item not stocked at time of printing - Please enquire for lead time

E&OE Pricing and all details subject to change without notice - Copyright Miniature Bearings Australia Pty Ltd

MBA Size Listings are a guide to sizes only and must not be solely relied on for critical design information.

Page 1 of 29

INFORMATION

UNC - UNF - METRIC.

Imperial Sizes to ANSI B18.3.

Metric Sizes to DIN7380.

This catalogue to be read in conjunction with information at <http://www.minibearings.com.au//partslist/toolssetsfoldup/tools/all/1/>

<http://www.minibearings.com.au//partslist/toolskeyshex/tools/all/1/>

<http://www.minibearings.com.au//partslist/toolsscrewdrivers/tools/all/1/>

Indicates item not stocked at time of printing - Please enquire for lead time

E&OE Pricing and all details subject to change without notice - Copyright Miniature Bearings Australia Pty Ltd

MBA Size Listings are a guide to sizes only and must not be solely relied on for critical design information.

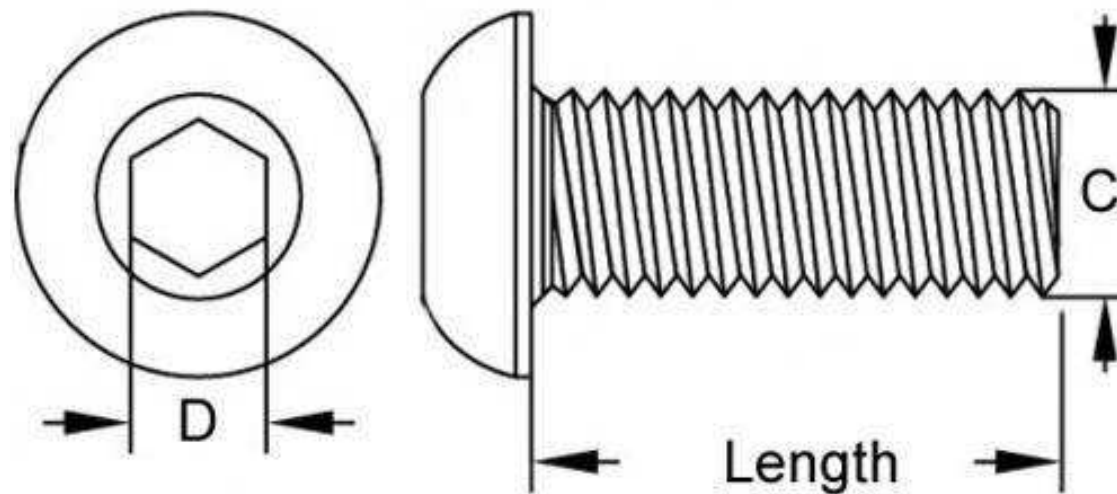

Indicates item not stocked at time of printing - Please enquire for lead time

E&OE Pricing and all details subject to change without notice - Copyright Miniature Bearings Australia Pty Ltd

MBA Size Listings are a guide to sizes only and must not be solely relied on for critical design information.

Screws - Button - Socket - Zinc Plated

Part Number	Thread Size (C)	Length (L) mm	Material	Max Head Diameter mm	Max Head Height mm	Hex Key (D) mm	Pitch mm
		<i>inches</i>		<i>inches</i>	<i>inches</i>	<i>inches</i>	<i>inches</i>
SC030M-005-B-SK-CZ	M3x0.5 (3mm Standard)	5 <i>0.197</i>	Zinc Plated Steel	5.7 <i>0.224</i>	1.7 <i>0.067</i>	2.00 <i>0.079</i>	0.500 <i>0.020</i>
SC030M-006-B-SK-CZ	M3x0.5 (3mm Standard)	6 <i>0.236</i>	Zinc Plated Steel	5.7 <i>0.224</i>	1.7 <i>0.067</i>	2.00 <i>0.079</i>	0.500 <i>0.020</i>
# SC030M-008-B-SK-CZ	M3x0.5 (3mm Standard)	8 <i>0.315</i>	Zinc Plated Steel	5.7 <i>0.224</i>	1.7 <i>0.067</i>	2.00 <i>0.079</i>	0.500 <i>0.020</i>
# SC030M-010-B-SK-CZ	M3x0.5 (3mm Standard)	10 <i>0.394</i>	Zinc Plated Steel	5.7 <i>0.224</i>	1.7 <i>0.067</i>	2.00 <i>0.079</i>	0.500 <i>0.020</i>
# SC030M-012-B-SK-CZ	M3x0.5 (3mm Standard)	12 <i>0.472</i>	Zinc Plated Steel	5.7 <i>0.224</i>	1.7 <i>0.067</i>	2.00 <i>0.079</i>	0.500 <i>0.020</i>
SC030M-016-B-SK-CZ	M3x0.5 (3mm Standard)	16 <i>0.630</i>	Zinc Plated Steel	5.7 <i>0.224</i>	1.7 <i>0.067</i>	2.00 <i>0.079</i>	0.500 <i>0.020</i>
# SC030M-020-B-SK-CZ	M3x0.5 (3mm Standard)	20 <i>0.787</i>	Zinc Plated Steel	5.7 <i>0.224</i>	1.7 <i>0.067</i>	2.00 <i>0.079</i>	0.500 <i>0.020</i>
SC030M-025-B-SK-CZ	M3x0.5 (3mm Standard)	25 <i>0.984</i>	Zinc Plated Steel	5.7 <i>0.224</i>	1.7 <i>0.067</i>	2.00 <i>0.079</i>	0.500 <i>0.020</i>

Indicates item not stocked at time of printing - Please enquire for lead time

Page 4 of 29

E&OE Pricing and all details subject to change without notice - Copyright Miniature Bearings Australia Pty Ltd
MBA Size Listings are a guide to sizes only and must not be solely relied on for critical design information.

Screws - Button - Socket - Zinc Plated

Part Number	Thread Size (C)	Length (L) mm	Material	Max Head Diameter mm	Max Head Height mm	Hex Key (D) mm	Pitch mm
		<i>inches</i>		<i>inches</i>	<i>inches</i>	<i>inches</i>	<i>inches</i>
# SC030M-030-B-SK-CZ	M3x0.5 (3mm Standard)	30 <i>1.181</i>	Zinc Plated Steel	5.7 <i>0.224</i>	1.7 <i>0.067</i>	2.00 <i>0.079</i>	0.500 <i>0.020</i>
# SC040M-006-B-SK-CZ	M4x0.7 (4mm Standard)	6 <i>0.236</i>	Zinc Plated Steel	7.6 <i>0.299</i>	2.2 <i>0.087</i>	2.50 <i>0.098</i>	0.700 <i>0.028</i>
SC040M-008-B-SK-CZ	M4x0.7 (4mm Standard)	8 <i>0.315</i>	Zinc Plated Steel	7.6 <i>0.299</i>	2.2 <i>0.087</i>	2.50 <i>0.098</i>	0.700 <i>0.028</i>
# SC040M-010-B-SK-CZ	M4x0.7 (4mm Standard)	10 <i>0.394</i>	Zinc Plated Steel	7.6 <i>0.299</i>	2.2 <i>0.087</i>	2.50 <i>0.098</i>	0.700 <i>0.028</i>
# SC040M-012-B-SK-CZ	M4x0.7 (4mm Standard)	12 <i>0.472</i>	Zinc Plated Steel	7.6 <i>0.299</i>	2.2 <i>0.087</i>	2.50 <i>0.098</i>	0.700 <i>0.028</i>
# SC040M-016-B-SK-CZ	M4x0.7 (4mm Standard)	16 <i>0.630</i>	Zinc Plated Steel	7.6 <i>0.299</i>	2.2 <i>0.087</i>	2.50 <i>0.098</i>	0.700 <i>0.028</i>
SC040M-020-B-SK-CZ	M4x0.7 (4mm Standard)	20 <i>0.787</i>	Zinc Plated Steel	7.6 <i>0.299</i>	2.2 <i>0.087</i>	2.50 <i>0.098</i>	0.700 <i>0.028</i>
# SC040M-025-B-SK-CZ	M4x0.7 (4mm Standard)	25 <i>0.984</i>	Zinc Plated Steel	7.6 <i>0.299</i>	2.2 <i>0.087</i>	2.50 <i>0.098</i>	0.700 <i>0.028</i>

Indicates item not stocked at time of printing - Please enquire for lead time

Page 5 of 29

E&OE Pricing and all details subject to change without notice - Copyright Miniature Bearings Australia Pty Ltd
MBA Size Listings are a guide to sizes only and must not be solely relied on for critical design information.

Screws - Button - Socket - Zinc Plated

Part Number	Thread Size (C)	Length (L) mm	Material	Max Head Diameter mm	Max Head Height mm	Hex Key (D) mm	Pitch mm
		<i>inches</i>		<i>inches</i>	<i>inches</i>	<i>inches</i>	<i>inches</i>
# SC040M-030-B-SK-CZ	M4x0.7 (4mm Standard)	30 <i>1.181</i>	Zinc Plated Steel	7.6 <i>0.299</i>	2.2 <i>0.087</i>	2.50 <i>0.098</i>	0.700 <i>0.028</i>
# SC040M-035-B-SK-CZ	M4x0.7 (4mm Standard)	35 <i>1.378</i>	Zinc Plated Steel	7.6 <i>0.299</i>	2.2 <i>0.087</i>	2.50 <i>0.098</i>	0.700 <i>0.028</i>
# SC040M-040-B-SK-CZ	M4x0.7 (4mm Standard)	40 <i>1.575</i>	Zinc Plated Steel	7.6 <i>0.299</i>	2.2 <i>0.087</i>	2.50 <i>0.098</i>	0.700 <i>0.028</i>
# SC040M-045-B-SK-CZ	M4x0.7 (4mm Standard)	45 <i>1.772</i>	Zinc Plated Steel	7.6 <i>0.299</i>	2.2 <i>0.087</i>	2.50 <i>0.098</i>	0.700 <i>0.028</i>
# SC040M-050-B-SK-CZ	M4x0.7 (4mm Standard)	50 <i>1.969</i>	Zinc Plated Steel	7.6 <i>0.299</i>	2.2 <i>0.087</i>	2.50 <i>0.098</i>	0.700 <i>0.028</i>
# SC048C-006-B-SK-CZ	10-24 UNC (4.762mm)	6.4 <i>0.252</i>	Zinc Plated Steel	9.2 <i>0.362</i>	2.5 <i>0.098</i>	3.18 (1/8)	1.058 <i>0.042</i>
# SC048C-007-B-SK-CZ	10-24 UNC (4.762mm)	7.9 <i>0.311</i>	Zinc Plated Steel	9.2 <i>0.362</i>	2.5 <i>0.098</i>	3.18 (1/8)	1.058 <i>0.042</i>
# SC048C-010-B-SK-CZ	10-24 UNC (4.762mm)	9.5 <i>0.374</i>	Zinc Plated Steel	9.2 <i>0.362</i>	2.5 <i>0.098</i>	3.18 (1/8)	1.058 <i>0.042</i>
# SC048C-013-B-SK-CZ	10-24 UNC (4.762mm)	12.7 <i>0.500</i>	Zinc Plated Steel	9.2 <i>0.362</i>	2.5 <i>0.098</i>	3.18 (1/8)	1.058 <i>0.042</i>

Indicates item not stocked at time of printing - Please enquire for lead time

Page 6 of 29

E&OE Pricing and all details subject to change without notice - Copyright Miniature Bearings Australia Pty Ltd
MBA Size Listings are a guide to sizes only and must not be solely relied on for critical design information.

Screws - Button - Socket - Zinc Plated

Part Number	Thread Size (C)	Length (L) mm	Material	Max Head Diameter mm	Max Head Height mm	Hex Key (D) mm	Pitch mm
		<i>inches</i>		<i>inches</i>	<i>inches</i>	<i>inches</i>	<i>inches</i>
# SC048C-016-B-SK-CZ	10-24 UNC (4.762mm)	15.9 <i>0.626</i>	Zinc Plated Steel	9.2 <i>0.362</i>	2.5 <i>0.098</i>	3.18 (1/8)	1.058 <i>0.042</i>
# SC048C-019-B-SK-CZ	10-24 UNC (4.762mm)	19.1 <i>0.752</i>	Zinc Plated Steel	9.2 <i>0.362</i>	2.5 <i>0.098</i>	3.18 (1/8)	1.058 <i>0.042</i>
# SC048C-025-B-SK-CZ	10-24 UNC (4.762mm)	25.4 <i>1.000</i>	Zinc Plated Steel	9.2 <i>0.362</i>	2.5 <i>0.098</i>	3.18 (1/8)	1.058 <i>0.042</i>
# SC048C-032-B-SK-CZ	10-24 UNC (4.762mm)	31.8 <i>1.252</i>	Zinc Plated Steel	9.2 <i>0.362</i>	2.5 <i>0.098</i>	3.18 (1/8)	1.058 <i>0.042</i>
# SC048C-038-B-SK-CZ	10-24 UNC (4.762mm)	38.1 <i>1.500</i>	Zinc Plated Steel	9.2 <i>0.362</i>	2.5 <i>0.098</i>	3.18 (1/8)	1.058 <i>0.042</i>
# SC048C-045-B-SK-CZ	10-24 UNC (4.762mm)	44.5 <i>1.752</i>	Zinc Plated Steel	9.2 <i>0.362</i>	2.5 <i>0.098</i>	3.18 (1/8)	1.058 <i>0.042</i>
# SC048C-051-B-SK-CZ	10-24 UNC (4.762mm)	50.8 <i>2.000</i>	Zinc Plated Steel	9.2 <i>0.362</i>	2.5 <i>0.098</i>	3.18 (1/8)	1.058 <i>0.042</i>
# SC048C-064-B-SK-CZ	10-24 UNC (4.762mm)	63.5 <i>2.500</i>	Zinc Plated Steel	9.2 <i>0.362</i>	2.5 <i>0.098</i>	3.18 (1/8)	1.058 <i>0.042</i>
# SC048W-010-B-SK-CZ	3/16-24 BSW (4.762mm)	9.5 <i>0.374</i>	Zinc Plated Steel	9.2 <i>0.362</i>	2.5 <i>0.098</i>	3.97 (5/32)	1.058 <i>0.042</i>
# SC048W-013-B-SK-CZ	3/16-24 BSW (4.762mm)	12.7 <i>0.500</i>	Zinc Plated Steel	9.2 <i>0.362</i>	2.5 <i>0.098</i>	3.97 (5/32)	1.058 <i>0.042</i>

Indicates item not stocked at time of printing - Please enquire for lead time

Page 7 of 29

E&OE Pricing and all details subject to change without notice - Copyright Miniature Bearings Australia Pty Ltd
MBA Size Listings are a guide to sizes only and must not be solely relied on for critical design information.

Screws - Button - Socket - Zinc Plated

Part Number	Thread Size (C)	Length (L) mm	Material	Max Head Diameter mm	Max Head Height mm	Hex Key (D) mm	Pitch mm
		<i>inches</i>		<i>inches</i>	<i>inches</i>	<i>inches</i>	<i>inches</i>
# SC048W-019-B-SK-CZ	3/16-24 BSW (4.762mm)	19.1 <i>0.752</i>	Zinc Plated Steel	9.2 <i>0.362</i>	2.5 <i>0.098</i>	3.97 (5/32)	1.058 <i>0.042</i>
# SC048W-025-B-SK-CZ	3/16-24 BSW (4.762mm)	25.40 <i>1.000</i>	Zinc Plated Steel	9.2 <i>0.362</i>	2.5 <i>0.098</i>	3.97 (5/32)	1.058 <i>0.042</i>
# SC048F-006-B-SK-CZ	10-32 UNF (4.762mm)	6.4 <i>0.252</i>	Zinc Plated Steel	9.2 <i>0.362</i>	2.5 <i>0.098</i>	3.18 (1/8)	0.794 <i>0.031</i>
# SC048F-010-B-SK-CZ	10-32 UNF (4.762mm)	9.5 <i>0.374</i>	Zinc Plated Steel	9.2 <i>0.362</i>	2.5 <i>0.098</i>	3.18 (1/8)	0.794 <i>0.031</i>
# SC048F-013-B-SK-CZ	10-32 UNF (4.762mm)	12.7 <i>0.500</i>	Zinc Plated Steel	9.2 <i>0.362</i>	2.5 <i>0.098</i>	3.18 (1/8)	0.794 <i>0.031</i>
SC048F-016-B-SK-CZ	10-32 UNF (4.762mm)	15.9 <i>0.626</i>	Zinc Plated Steel	9.2 <i>0.362</i>	2.5 <i>0.098</i>	3.18 (1/8)	0.794 <i>0.031</i>
# SC048F-019-B-SK-CZ	10-32 UNF (4.762mm)	19.1 <i>0.752</i>	Zinc Plated Steel	9.2 <i>0.362</i>	2.5 <i>0.098</i>	3.18 (1/8)	0.794 <i>0.031</i>
# SC048F-025-B-SK-CZ	10-32 UNF (4.762mm)	25.4 <i>1.000</i>	Zinc Plated Steel	9.2 <i>0.362</i>	2.5 <i>0.098</i>	3.18 (1/8)	0.794 <i>0.031</i>
# SC048F-032-B-SK-CZ	10-32 UNF (4.762mm)	31.8 <i>1.252</i>	Zinc Plated Steel	9.2 <i>0.362</i>	2.5 <i>0.098</i>	3.18 (1/8)	0.794 <i>0.031</i>
# SC048F-038-B-SK-CZ	10-32 UNF (4.762mm)	38.1 <i>1.500</i>	Zinc Plated Steel	9.2 <i>0.362</i>	2.5 <i>0.098</i>	3.18 (1/8)	0.794 <i>0.031</i>

Indicates item not stocked at time of printing - Please enquire for lead time

Page 8 of 29

E&OE Pricing and all details subject to change without notice - Copyright Miniature Bearings Australia Pty Ltd
MBA Size Listings are a guide to sizes only and must not be solely relied on for critical design information.

Screws - Button - Socket - Zinc Plated

Part Number	Thread Size (C)	Length (L) mm	Material	Max Head Diameter mm	Max Head Height mm	Hex Key (D) mm	Pitch mm
		<i>inches</i>		<i>inches</i>	<i>inches</i>	<i>inches</i>	<i>inches</i>
# SC048F-045-B-SK-CZ	10-32 UNF (4.762mm)	44.50 <i>1.752</i>	Zinc Plated Steel	9.2 <i>0.362</i>	2.5 <i>0.098</i>	3.18 (1/8)	0.794 <i>0.031</i>
# SC048F-051-B-SK-CZ	10-32 UNF (4.762mm)	50.8 <i>2.000</i>	Zinc Plated Steel	9.2 <i>0.362</i>	2.5 <i>0.098</i>	3.18 (1/8)	0.794 <i>0.031</i>
# SC050M-006-B-SK-CZ	M5x0.8 (5mm Standard)	6 <i>0.236</i>	Zinc Plated Steel	9.5 <i>0.374</i>	2.8 <i>0.110</i>	3.00 <i>0.118</i>	0.800 <i>0.031</i>
# SC050M-008-B-SK-CZ	M5x0.8 (5mm Standard)	8 <i>0.315</i>	Zinc Plated Steel	9.5 <i>0.374</i>	2.8 <i>0.110</i>	3.00 <i>0.118</i>	0.800 <i>0.031</i>
SC050M-010-B-SK-CZ	M5x0.8 (5mm Standard)	10 <i>0.394</i>	Zinc Plated Steel	9.5 <i>0.374</i>	2.8 <i>0.110</i>	3.00 <i>0.118</i>	0.800 <i>0.031</i>
# SC050M-012-B-SK-CZ	M5x0.8 (5mm Standard)	12 <i>0.472</i>	Zinc Plated Steel	9.5 <i>0.374</i>	2.8 <i>0.110</i>	3.00 <i>0.118</i>	0.800 <i>0.031</i>
# SC050M-016-B-SK-CZ	M5x0.8 (5mm Standard)	16 <i>0.630</i>	Zinc Plated Steel	9.5 <i>0.374</i>	2.8 <i>0.110</i>	3.00 <i>0.118</i>	0.800 <i>0.031</i>
# SC050M-020-B-SK-CZ	M5x0.8 (5mm Standard)	20 <i>0.787</i>	Zinc Plated Steel	9.5 <i>0.374</i>	2.8 <i>0.110</i>	3.00 <i>0.118</i>	0.800 <i>0.031</i>

Indicates item not stocked at time of printing - Please enquire for lead time

Page 9 of 29

E&OE Pricing and all details subject to change without notice - Copyright Miniature Bearings Australia Pty Ltd

MBA Size Listings are a guide to sizes only and must not be solely relied on for critical design information.

Screws - Button - Socket - Zinc Plated

Part Number	Thread Size (C)	Length (L) mm	Material	Max Head Diameter mm	Max Head Height mm	Hex Key (D) mm	Pitch mm
		<i>inches</i>		<i>inches</i>	<i>inches</i>	<i>inches</i>	<i>inches</i>
# SC050M-025-B-SK-CZ	M5x0.8 (5mm Standard)	25 <i>0.984</i>	Zinc Plated Steel	9.5 <i>0.374</i>	2.8 <i>0.110</i>	3.00 <i>0.118</i>	0.800 <i>0.031</i>
# SC050M-030-B-SK-CZ	M5x0.8 (5mm Standard)	30 <i>1.181</i>	Zinc Plated Steel	9.5 <i>0.374</i>	2.8 <i>0.110</i>	3.00 <i>0.118</i>	0.800 <i>0.031</i>
# SC050M-035-B-SK-CZ	M5x0.8 (5mm Standard)	35 <i>1.378</i>	Zinc Plated Steel	9.5 <i>0.374</i>	2.8 <i>0.110</i>	3.00 <i>0.118</i>	0.800 <i>0.031</i>
# SC050M-040-B-SK-CZ	M5x0.8 (5mm Standard)	40 <i>1.575</i>	Zinc Plated Steel	9.5 <i>0.374</i>	2.8 <i>0.110</i>	3.00 <i>0.118</i>	0.800 <i>0.031</i>
# SC050M-045-B-SK-CZ	M5x0.8 (5mm Standard)	45 <i>1.772</i>	Zinc Plated Steel	9.5 <i>0.374</i>	2.8 <i>0.110</i>	3.00 <i>0.118</i>	0.800 <i>0.031</i>
# SC050M-050-B-SK-CZ	M5x0.8 (5mm Standard)	50 <i>1.969</i>	Zinc Plated Steel	9.5 <i>0.374</i>	2.8 <i>0.110</i>	3.00 <i>0.118</i>	0.800 <i>0.031</i>
# SC050M-060-B-SK-CZ	M5x0.8 (5mm Standard)	60 <i>2.362</i>	Zinc Plated Steel	9.5 <i>0.374</i>	2.8 <i>0.110</i>	3.00 <i>0.118</i>	0.800 <i>0.031</i>
# SC060M-008-B-SK-CZ	M6x1 (6mm Standard)	8 <i>0.315</i>	Zinc Plated Steel	10.5 <i>0.413</i>	3.3 <i>0.130</i>	4.00 <i>0.157</i>	1.000 <i>0.039</i>

Indicates item not stocked at time of printing - Please enquire for lead time

Page 10 of 29

E&OE Pricing and all details subject to change without notice - Copyright Miniature Bearings Australia Pty Ltd
MBA Size Listings are a guide to sizes only and must not be solely relied on for critical design information.

Screws - Button - Socket - Zinc Plated

Part Number	Thread Size (C)	Length (L) mm	Material	Max Head Diameter mm	Max Head Height mm	Hex Key (D) mm	Pitch mm
		<i>inches</i>		<i>inches</i>	<i>inches</i>	<i>inches</i>	<i>inches</i>
# SC060M-010-B-SK-CZ	M6x1 (6mm Standard)	10 <i>0.394</i>	Zinc Plated Steel	10.5 <i>0.413</i>	3.3 <i>0.130</i>	4.00 <i>0.157</i>	1.000 <i>0.039</i>
# SC060M-012-B-SK-CZ	M6x1 (6mm Standard)	12 <i>0.472</i>	Zinc Plated Steel	10.5 <i>0.413</i>	3.3 <i>0.130</i>	4.00 <i>0.157</i>	1.000 <i>0.039</i>
# SC060M-016-B-SK-CZ	M6x1 (6mm Standard)	16 <i>0.630</i>	Zinc Plated Steel	10.5 <i>0.413</i>	3.3 <i>0.130</i>	4.00 <i>0.157</i>	1.000 <i>0.039</i>
# SC060M-020-B-SK-CZ	M6x1 (6mm Standard)	20 <i>0.787</i>	Zinc Plated Steel	10.5 <i>0.413</i>	3.3 <i>0.130</i>	4.00 <i>0.157</i>	1.000 <i>0.039</i>
# SC060M-025-B-SK-CZ	M6x1 (6mm Standard)	25 <i>0.984</i>	Zinc Plated Steel	10.5 <i>0.413</i>	3.3 <i>0.130</i>	4.00 <i>0.157</i>	1.000 <i>0.039</i>
SC060M-030-B-SK-CZ	M6x1 (6mm Standard)	30 <i>1.181</i>	Zinc Plated Steel	10.5 <i>0.413</i>	3.3 <i>0.130</i>	4.00 <i>0.157</i>	1.000 <i>0.039</i>
# SC060M-035-B-SK-CZ	M6x1 (6mm Standard)	35 <i>1.378</i>	Zinc Plated Steel	10.5 <i>0.413</i>	3.3 <i>0.130</i>	4.00 <i>0.157</i>	1.000 <i>0.039</i>
# SC060M-040-B-SK-CZ	M6x1 (6mm Standard)	40 <i>1.575</i>	Zinc Plated Steel	10.5 <i>0.413</i>	3.3 <i>0.130</i>	4.00 <i>0.157</i>	1.000 <i>0.039</i>
# SC060M-045-B-SK-CZ	M6x1 (6mm Standard)	45 <i>1.772</i>	Zinc Plated Steel	10.5 <i>0.413</i>	3.3 <i>0.130</i>	4.00 <i>0.157</i>	1.000 <i>0.039</i>
# SC060M-050-B-SK-CZ	M6x1 (6mm Standard)	50 <i>1.969</i>	Zinc Plated Steel	10.5 <i>0.413</i>	3.3 <i>0.130</i>	4.00 <i>0.157</i>	1.000 <i>0.039</i>

Indicates item not stocked at time of printing - Please enquire for lead time

Page 11 of 29

E&OE Pricing and all details subject to change without notice - Copyright Miniature Bearings Australia Pty Ltd
MBA Size Listings are a guide to sizes only and must not be solely relied on for critical design information.

Screws - Button - Socket - Zinc Plated

Part Number	Thread Size (C)	Length (L) mm	Material	Max Head Diameter mm	Max Head Height mm	Hex Key (D) mm	Pitch mm
		<i>inches</i>		<i>inches</i>	<i>inches</i>	<i>inches</i>	<i>inches</i>
# SC060M-055-B-SK-CZ	M6x1 (6mm Standard)	55 <i>2.165</i>	Zinc Plated Steel	10.5 <i>0.413</i>	3.3 <i>0.130</i>	4.00 <i>0.157</i>	1.000 <i>0.039</i>
# SC060M-060-B-SK-CZ	M6x1 (6mm Standard)	60 <i>2.362</i>	Zinc Plated Steel	10.5 <i>0.413</i>	3.3 <i>0.130</i>	4.00 <i>0.157</i>	1.000 <i>0.039</i>
# SC060M-065-B-SK-CZ	M6x1 (6mm Standard)	65 <i>2.559</i>	Zinc Plated Steel	10.5 <i>0.413</i>	3.3 <i>0.130</i>	4.00 <i>0.157</i>	1.000 <i>0.039</i>
# SC060M-070-B-SK-CZ	M6x1 (6mm Standard)	70 <i>2.756</i>	Zinc Plated Steel	10.5 <i>0.413</i>	3.3 <i>0.130</i>	4.00 <i>0.157</i>	1.000 <i>0.039</i>
# SC060M-075-B-SK-CZ	M6x1 (6mm Standard)	75 <i>2.953</i>	Zinc Plated Steel	10.5 <i>0.413</i>	3.3 <i>0.130</i>	4.00 <i>0.157</i>	1.000 <i>0.039</i>
# SC060M-080-B-SK-CZ	M6x1 (6mm Standard)	80 <i>3.150</i>	Zinc Plated Steel	10.5 <i>0.413</i>	3.3 <i>0.130</i>	4.00 <i>0.157</i>	1.000 <i>0.039</i>
SC064C-010-B-SK-CZ	1/4-20 UNC (6.35mm)	9.5 <i>0.374</i>	Zinc Plated Steel	11.1 <i>0.437</i>	3.4 <i>0.134</i>	3.97 (5/32)	1.270 <i>0.050</i>
SC064C-013-B-SK-CZ	1/4-20 UNC (6.35mm)	12.7 <i>0.500</i>	Zinc Plated Steel	11.1 <i>0.437</i>	3.4 <i>0.134</i>	3.97 (5/32)	1.270 <i>0.050</i>
# SC064C-016-B-SK-CZ	1/4-20 UNC (6.35mm)	15.9 <i>0.626</i>	Zinc Plated Steel	11.1 <i>0.437</i>	3.4 <i>0.134</i>	3.97 (5/32)	1.270 <i>0.050</i>
SC064C-019-B-SK-CZ	1/4-20 UNC (6.35mm)	19.1 <i>0.752</i>	Zinc Plated Steel	11.1 <i>0.437</i>	3.4 <i>0.134</i>	3.97 (5/32)	1.270 <i>0.050</i>

Indicates item not stocked at time of printing - Please enquire for lead time

Page 12 of 29

E&OE Pricing and all details subject to change without notice - Copyright Miniature Bearings Australia Pty Ltd
MBA Size Listings are a guide to sizes only and must not be solely relied on for critical design information.

Screws - Button - Socket - Zinc Plated

Part Number	Thread Size (C)	Length (L) mm	Material	Max Head Diameter mm	Max Head Height mm	Hex Key (D) mm	Pitch mm
		<i>inches</i>		<i>inches</i>	<i>inches</i>	<i>inches</i>	<i>inches</i>
# SC064C-025-B-SK-CZ	1/4-20 UNC (6.35mm)	25.4 <i>1.000</i>	Zinc Plated Steel	11.1 <i>0.437</i>	3.4 <i>0.134</i>	3.97 (5/32)	1.270 <i>0.050</i>
# SC064C-032-B-SK-CZ	1/4-20 UNC (6.35mm)	31.8 <i>1.252</i>	Zinc Plated Steel	11.1 <i>0.437</i>	3.4 <i>0.134</i>	3.97 (5/32)	1.270 <i>0.050</i>
# SC064C-038-B-SK-CZ	1/4-20 UNC (6.35mm)	38.1 <i>1.500</i>	Zinc Plated Steel	11.1 <i>0.437</i>	3.4 <i>0.134</i>	3.97 (5/32)	1.270 <i>0.050</i>
# SC064C-045-B-SK-CZ	1/4-20 UNC (6.35mm)	44.50 <i>1.752</i>	Zinc Plated Steel	11.1 <i>0.437</i>	3.4 <i>0.134</i>	3.97 (5/32)	1.270 <i>0.050</i>
# SC064C-051-B-SK-CZ	1/4-20 UNC (6.35mm)	50.8 <i>2.000</i>	Zinc Plated Steel	11.1 <i>0.437</i>	3.4 <i>0.134</i>	3.97 (5/32)	1.270 <i>0.050</i>
# SC064C-064-B-SK-CZ	1/4-20 UNC (6.35mm)	63.50 <i>2.500</i>	Zinc Plated Steel	11.1 <i>0.437</i>	3.4 <i>0.134</i>	3.97 (5/32)	1.270 <i>0.050</i>
# SC064W-010-B-SK-CZ	1/4-20 BSW (6.35mm)	9.5 <i>0.374</i>	Zinc Plated Steel	11.1 <i>0.437</i>	3.4 <i>0.134</i>	3.97 (5/32)	1.270 <i>0.050</i>
# SC064W-013-B-SK-CZ	1/4-20 BSW (6.35mm)	12.7 <i>0.500</i>	Zinc Plated Steel	11.1 <i>0.437</i>	3.4 <i>0.134</i>	3.97 (5/32)	1.270 <i>0.050</i>
# SC064W-016-B-SK-CZ	1/4-20 BSW (6.35mm)	15.9 <i>0.626</i>	Zinc Plated Steel	11.1 <i>0.437</i>	3.4 <i>0.134</i>	3.97 (5/32)	1.270 <i>0.050</i>
# SC064W-019-B-SK-CZ	1/4-20 BSW (6.35mm)	19.1 <i>0.752</i>	Zinc Plated Steel	11.1 <i>0.437</i>	3.4 <i>0.134</i>	3.97 (5/32)	1.270 <i>0.050</i>

Indicates item not stocked at time of printing - Please enquire for lead time

Page 13 of 29

E&OE Pricing and all details subject to change without notice - Copyright Miniature Bearings Australia Pty Ltd
MBA Size Listings are a guide to sizes only and must not be solely relied on for critical design information.

Screws - Button - Socket - Zinc Plated

Part Number	Thread Size (C)	Length (L) mm	Material	Max Head Diameter mm	Max Head Height mm	Hex Key (D) mm	Pitch mm
		<i>inches</i>		<i>inches</i>	<i>inches</i>	<i>inches</i>	<i>inches</i>
# SC064W-025-B-SK-CZ	1/4-20 BSW (6.35mm)	25.4 <i>1.000</i>	Zinc Plated Steel	11.1 <i>0.437</i>	3.4 <i>0.134</i>	3.97 (5/32)	1.270 <i>0.050</i>
# SC064W-032-B-SK-CZ	1/4-20 BSW (6.35mm)	31.8 <i>1.252</i>	Zinc Plated Steel	11.1 <i>0.437</i>	3.4 <i>0.134</i>	3.97 (5/32)	1.270 <i>0.050</i>
# SC064F-010-B-SK-CZ	1/4-28 UNF (6.35mm)	9.5 <i>0.374</i>	Zinc Plated Steel	11.1 <i>0.437</i>	3.4 <i>0.134</i>	3.97 (5/32)	0.907 <i>0.036</i>
# SC064F-013-B-SK-CZ	1/4-28 UNF (6.35mm)	12.70 <i>0.500</i>	Zinc Plated Steel	11.1 <i>0.437</i>	3.4 <i>0.134</i>	3.97 (5/32)	0.907 <i>0.036</i>
# SC064F-016-B-SK-CZ	1/4-28 UNF (6.35mm)	15.9 <i>0.626</i>	Zinc Plated Steel	11.1 <i>0.437</i>	3.4 <i>0.134</i>	3.97 (5/32)	0.907 <i>0.036</i>
# SC064F-019-B-SK-CZ	1/4-28 UNF (6.35mm)	19.1 <i>0.752</i>	Zinc Plated Steel	11.1 <i>0.437</i>	3.4 <i>0.134</i>	3.97 (5/32)	0.907 <i>0.036</i>
# SC064F-025-B-SK-CZ	1/4-28 UNF (6.35mm)	25.4 <i>1.000</i>	Zinc Plated Steel	11.1 <i>0.437</i>	3.4 <i>0.134</i>	3.97 (5/32)	0.907 <i>0.036</i>
# SC064F-032-B-SK-CZ	1/4-28 UNF (6.35mm)	31.8 <i>1.252</i>	Zinc Plated Steel	11.1 <i>0.437</i>	3.4 <i>0.134</i>	3.97 (5/32)	0.907 <i>0.036</i>
# SC079C-010-B-SK-CZ	5/16-18 UNC (7.938mm)	9.5 <i>0.374</i>	Zinc Plated Steel	13.9 <i>0.547</i>	4.2 <i>0.165</i>	4.76 (3/16)	1.411 <i>0.056</i>
# SC079C-013-B-SK-CZ	5/16-18 UNC (7.938mm)	12.7 <i>0.500</i>	Zinc Plated Steel	13.9 <i>0.547</i>	4.2 <i>0.165</i>	4.76 (3/16)	1.411 <i>0.056</i>

Indicates item not stocked at time of printing - Please enquire for lead time

Page 14 of 29

E&OE Pricing and all details subject to change without notice - Copyright Miniature Bearings Australia Pty Ltd
MBA Size Listings are a guide to sizes only and must not be solely relied on for critical design information.

Screws - Button - Socket - Zinc Plated

Part Number	Thread Size (C)	Length (L) mm	Material	Max Head Diameter mm	Max Head Height mm	Hex Key (D) mm	Pitch mm
		<i>inches</i>		<i>inches</i>	<i>inches</i>	<i>inches</i>	<i>inches</i>
SC079C-016-B-SK-CZ	5/16-18 UNC (7.938mm)	15.9 <i>0.626</i>	Zinc Plated Steel	13.9 <i>0.547</i>	4.2 <i>0.165</i>	4.76 (3/16)	1.411 <i>0.056</i>
# SC079C-019-B-SK-CZ	5/16-18 UNC (7.938mm)	19.1 <i>0.752</i>	Zinc Plated Steel	13.9 <i>0.547</i>	4.2 <i>0.165</i>	4.76 (3/16)	1.411 <i>0.056</i>
SC079C-025-B-SK-CZ	5/16-18 UNC (7.938mm)	25.4 <i>1.000</i>	Zinc Plated Steel	13.9 <i>0.547</i>	4.2 <i>0.165</i>	4.76 (3/16)	1.411 <i>0.056</i>
SC079C-032-B-SK-CZ	5/16-18 UNC (7.938mm)	31.8 <i>1.252</i>	Zinc Plated Steel	13.9 <i>0.547</i>	4.2 <i>0.165</i>	4.76 (3/16)	1.411 <i>0.056</i>
# SC079C-038-B-SK-CZ	5/16-18 UNC (7.938mm)	38.1 <i>1.500</i>	Zinc Plated Steel	13.9 <i>0.547</i>	4.2 <i>0.165</i>	4.76 (3/16)	1.411 <i>0.056</i>
# SC079C-045-B-SK-CZ	5/16-18 UNC (7.938mm)	44.50 <i>1.752</i>	Zinc Plated Steel	13.9 <i>0.547</i>	4.2 <i>0.165</i>	4.76 (3/16)	1.411 <i>0.056</i>
# SC079C-051-B-SK-CZ	5/16-18 UNC (7.938mm)	50.8 <i>2.000</i>	Zinc Plated Steel	13.9 <i>0.547</i>	4.2 <i>0.165</i>	4.76 (3/16)	1.411 <i>0.056</i>
# SC079C-064-B-SK-CZ	5/16-18 UNC (7.938mm)	63.50 <i>2.500</i>	Zinc Plated Steel	13.9 <i>0.547</i>	4.2 <i>0.165</i>	4.76 (3/16)	1.411 <i>0.056</i>

Indicates item not stocked at time of printing - Please enquire for lead time

Page 15 of 29

E&OE Pricing and all details subject to change without notice - Copyright Miniature Bearings Australia Pty Ltd
MBA Size Listings are a guide to sizes only and must not be solely relied on for critical design information.

Screws - Button - Socket - Zinc Plated

Part Number	Thread Size (C)	Length (L) mm	Material	Max Head Diameter mm	Max Head Height mm	Hex Key (D) mm	Pitch mm
		<i>inches</i>		<i>inches</i>	<i>inches</i>	<i>inches</i>	<i>inches</i>
# SC079C-076-B-SK-CZ	5/16-18 UNC (7.938mm)	76.20 <i>3.000</i>	Zinc Plated Steel	13.9 <i>0.547</i>	4.2 <i>0.165</i>	4.76 (3/16)	1.411 <i>0.056</i>
# SC079W-013-B-SK-CZ	5/16-18 BSW (7.938mm)	12.7 <i>0.500</i>	Zinc Plated Steel	13.9 <i>0.547</i>	4.2 <i>0.165</i>	4.76 (3/16)	1.411 <i>0.056</i>
# SC079W-016-B-SK-CZ	5/16-18 BSW (7.938mm)	15.9 <i>0.626</i>	Zinc Plated Steel	13.9 <i>0.547</i>	4.2 <i>0.165</i>	4.76 (3/16)	1.411 <i>0.056</i>
# SC079W-019-B-SK-CZ	5/16-18 BSW (7.938mm)	19.1 <i>0.752</i>	Zinc Plated Steel	13.9 <i>0.547</i>	4.2 <i>0.165</i>	4.76 (3/16)	1.411 <i>0.056</i>
# SC079W-025-B-SK-CZ	5/16-18 BSW (7.938mm)	25.4 <i>1.000</i>	Zinc Plated Steel	13.9 <i>0.547</i>	4.2 <i>0.165</i>	4.76 (3/16)	1.411 <i>0.056</i>
# SC079W-032-B-SK-CZ	5/16-18 BSW (7.938mm)	31.8 <i>1.252</i>	Zinc Plated Steel	13.9 <i>0.547</i>	4.2 <i>0.165</i>	4.76 (3/16)	1.411 <i>0.056</i>
# SC079F-013-B-SK-CZ	5/16-24 UNF (7.938mm)	12.7 <i>0.500</i>	Zinc Plated Steel	13.9 <i>0.547</i>	4.2 <i>0.165</i>	4.76 (3/16)	1.058 <i>0.042</i>
# SC079F-016-B-SK-CZ	5/16-24 UNF (7.938mm)	15.9 <i>0.626</i>	Zinc Plated Steel	13.9 <i>0.547</i>	4.2 <i>0.165</i>	4.76 (3/16)	1.058 <i>0.042</i>

Indicates item not stocked at time of printing - Please enquire for lead time

Page 16 of 29

E&OE Pricing and all details subject to change without notice - Copyright Miniature Bearings Australia Pty Ltd
MBA Size Listings are a guide to sizes only and must not be solely relied on for critical design information.

Screws - Button - Socket - Zinc Plated

Part Number	Thread Size (C)	Length (L) mm	Material	Max Head Diameter mm	Max Head Height mm	Hex Key (D) mm	Pitch mm
		<i>inches</i>		<i>inches</i>	<i>inches</i>	<i>inches</i>	<i>inches</i>
# SC079F-019-B-SK-CZ	5/16-24 UNF (7.938mm)	19.1 <i>0.752</i>	Zinc Plated Steel	13.9 <i>0.547</i>	4.2 <i>0.165</i>	4.76 (3/16)	1.058 <i>0.042</i>
# SC079F-025-B-SK-CZ	5/16-24 UNF (7.938mm)	25.4 <i>1.000</i>	Zinc Plated Steel	13.9 <i>0.547</i>	4.2 <i>0.165</i>	4.76 (3/16)	1.058 <i>0.042</i>
# SC079F-032-B-SK-CZ	5/16-24 UNF (7.938mm)	31.80 <i>1.252</i>	Zinc Plated Steel	13.9 <i>0.547</i>	4.2 <i>0.165</i>	4.76 (3/16)	1.058 <i>0.042</i>
# SC079F-038-B-SK-CZ	5/16-24 UNF (7.938mm)	38.1 <i>1.500</i>	Zinc Plated Steel	13.9 <i>0.547</i>	4.2 <i>0.165</i>	4.76 (3/16)	1.058 <i>0.042</i>
# SC080M-008-B-SK-CZ	M8x1.25 (8mm Standard)	8 <i>0.315</i>	Zinc Plated Steel	14.0 <i>0.551</i>	4.4 <i>0.173</i>	5.00 <i>0.197</i>	1.250 <i>0.049</i>
# SC080M-010-B-SK-CZ	M8x1.25 (8mm Standard)	10 <i>0.394</i>	Zinc Plated Steel	14.0 <i>0.551</i>	4.4 <i>0.173</i>	5.00 <i>0.197</i>	1.250 <i>0.049</i>
# SC080M-012-B-SK-CZ	M8x1.25 (8mm Standard)	12 <i>0.472</i>	Zinc Plated Steel	14.0 <i>0.551</i>	4.4 <i>0.173</i>	5.00 <i>0.197</i>	1.250 <i>0.049</i>
SC080M-016-B-SK-CZ	M8x1.25 (8mm Standard)	16 <i>0.630</i>	Zinc Plated Steel	14.0 <i>0.551</i>	4.4 <i>0.173</i>	5.00 <i>0.197</i>	1.250 <i>0.049</i>

Indicates item not stocked at time of printing - Please enquire for lead time

Page 17 of 29

E&OE Pricing and all details subject to change without notice - Copyright Miniature Bearings Australia Pty Ltd

MBA Size Listings are a guide to sizes only and must not be solely relied on for critical design information.

Screws - Button - Socket - Zinc Plated

Part Number	Thread Size (C)	Length (L) mm	Material	Max Head Diameter mm	Max Head Height mm	Hex Key (D) mm	Pitch mm
		<i>inches</i>		<i>inches</i>	<i>inches</i>	<i>inches</i>	<i>inches</i>
# SC080M-020-B-SK-CZ	M8x1.25 (8mm Standard)	20 <i>0.787</i>	Zinc Plated Steel	14.0 <i>0.551</i>	4.4 <i>0.173</i>	5.00 <i>0.197</i>	1.250 <i>0.049</i>
SC080M-025-B-SK-CZ	M8x1.25 (8mm Standard)	25 <i>0.984</i>	Zinc Plated Steel	14.0 <i>0.551</i>	4.4 <i>0.173</i>	5.00 <i>0.197</i>	1.250 <i>0.049</i>
# SC080M-030-B-SK-CZ	M8x1.25 (8mm Standard)	30 <i>1.181</i>	Zinc Plated Steel	14.0 <i>0.551</i>	4.4 <i>0.173</i>	5.00 <i>0.197</i>	1.250 <i>0.049</i>
# SC080M-035-B-SK-CZ	M8x1.25 (8mm Standard)	35 <i>1.378</i>	Zinc Plated Steel	14.0 <i>0.551</i>	4.4 <i>0.173</i>	5.00 <i>0.197</i>	1.250 <i>0.049</i>
# SC080M-040-B-SK-CZ	M8x1.25 (8mm Standard)	40 <i>1.575</i>	Zinc Plated Steel	14.0 <i>0.551</i>	4.4 <i>0.173</i>	5.00 <i>0.197</i>	1.250 <i>0.049</i>
# SC080M-045-B-SK-CZ	M8x1.25 (8mm Standard)	45 <i>1.772</i>	Zinc Plated Steel	14.0 <i>0.551</i>	4.4 <i>0.173</i>	5.00 <i>0.197</i>	1.250 <i>0.049</i>
# SC080M-050-B-SK-CZ	M8x1.25 (8mm Standard)	50 <i>1.969</i>	Zinc Plated Steel	14.0 <i>0.551</i>	4.4 <i>0.173</i>	5.00 <i>0.197</i>	1.250 <i>0.049</i>
# SC080M-055-B-SK-CZ	M8x1.25 (8mm Standard)	55 <i>2.165</i>	Zinc Plated Steel	14.0 <i>0.551</i>	4.4 <i>0.173</i>	5.00 <i>0.197</i>	1.250 <i>0.049</i>

Indicates item not stocked at time of printing - Please enquire for lead time

Page 18 of 29

E&OE Pricing and all details subject to change without notice - Copyright Miniature Bearings Australia Pty Ltd
MBA Size Listings are a guide to sizes only and must not be solely relied on for critical design information.

Screws - Button - Socket - Zinc Plated

Part Number	Thread Size (C)	Length (L) mm	Material	Max Head Diameter mm	Max Head Height mm	Hex Key (D) mm	Pitch mm
		<i>inches</i>		<i>inches</i>	<i>inches</i>	<i>inches</i>	<i>inches</i>
# SC080M-060-B-SK-CZ	M8x1.25 (8mm Standard)	60 <i>2.362</i>	Zinc Plated Steel	14.0 <i>0.551</i>	4.4 <i>0.173</i>	5.00 <i>0.197</i>	1.250 <i>0.049</i>
# SC080M-065-B-SK-CZ	M8x1.25 (8mm Standard)	65 <i>2.559</i>	Zinc Plated Steel	14.0 <i>0.551</i>	4.4 <i>0.173</i>	5.00 <i>0.197</i>	1.250 <i>0.049</i>
# SC080M-070-B-SK-CZ	M8x1.25 (8mm Standard)	70 <i>2.756</i>	Zinc Plated Steel	14.0 <i>0.551</i>	4.4 <i>0.173</i>	5.00 <i>0.197</i>	1.250 <i>0.049</i>
# SC080M-075-B-SK-CZ	M8x1.25 (8mm Standard)	75 <i>2.953</i>	Zinc Plated Steel	14.0 <i>0.551</i>	4.4 <i>0.173</i>	5.00 <i>0.197</i>	1.250 <i>0.049</i>
# SC080M-080-B-SK-CZ	M8x1.25 (8mm Standard)	80 <i>3.150</i>	Zinc Plated Steel	14.0 <i>0.551</i>	4.4 <i>0.173</i>	5.00 <i>0.197</i>	1.250 <i>0.049</i>
# SC080M-100-B-SK-CZ	M8x1.25 (8mm Standard)	100 <i>3.937</i>	Zinc Plated Steel	14.0 <i>0.551</i>	4.4 <i>0.173</i>	5.00 <i>0.197</i>	1.250 <i>0.049</i>
# SC095C-013-B-SK-CZ	3/8-16 UNC (9.525mm)	12.7 <i>0.500</i>	Zinc Plated Steel	16.7 <i>0.657</i>	5.0 <i>0.197</i>	5.56 (7/32)	1.588 <i>0.063</i>
# SC095C-016-B-SK-CZ	3/8-16 UNC (9.525mm)	15.9 <i>0.626</i>	Zinc Plated Steel	16.7 <i>0.657</i>	5.0 <i>0.197</i>	5.56 (7/32)	1.588 <i>0.063</i>

Indicates item not stocked at time of printing - Please enquire for lead time

Page 19 of 29

E&OE Pricing and all details subject to change without notice - Copyright Miniature Bearings Australia Pty Ltd
MBA Size Listings are a guide to sizes only and must not be solely relied on for critical design information.

Screws - Button - Socket - Zinc Plated

Part Number	Thread Size (C)	Length (L) mm	Material	Max Head Diameter mm	Max Head Height mm	Hex Key (D) mm	Pitch mm
		<i>inches</i>		<i>inches</i>	<i>inches</i>	<i>inches</i>	<i>inches</i>
# SC095C-019-B-SK-CZ	3/8-16 UNC (9.525mm)	19.1 <i>0.752</i>	Zinc Plated Steel	16.7 <i>0.657</i>	5.0 <i>0.197</i>	5.56 (7/32)	1.588 <i>0.063</i>
# SC095C-025-B-SK-CZ	3/8-16 UNC (9.525mm)	25.4 <i>1.000</i>	Zinc Plated Steel	16.7 <i>0.657</i>	5.0 <i>0.197</i>	5.56 (7/32)	1.588 <i>0.063</i>
# SC095C-032-B-SK-CZ	3/8-16 UNC (9.525mm)	31.8 <i>1.252</i>	Zinc Plated Steel	16.7 <i>0.657</i>	5.0 <i>0.197</i>	5.56 (7/32)	1.588 <i>0.063</i>
# SC095C-038-B-SK-CZ	3/8-16 UNC (9.525mm)	38.1 <i>1.500</i>	Zinc Plated Steel	16.7 <i>0.657</i>	5.0 <i>0.197</i>	5.56 (7/32)	1.588 <i>0.063</i>
# SC095C-045-B-SK-CZ	3/8-16 UNC (9.525mm)	44.50 <i>1.752</i>	Zinc Plated Steel	16.7 <i>0.657</i>	5.0 <i>0.197</i>	5.56 (7/32)	1.588 <i>0.063</i>
# SC095C-051-B-SK-CZ	3/8-16 UNC (9.525mm)	50.8 <i>2.000</i>	Zinc Plated Steel	16.7 <i>0.657</i>	5.0 <i>0.197</i>	5.56 (7/32)	1.588 <i>0.063</i>
# SC095C-057-B-SK-CZ	3/8-16 UNC (9.525mm)	57.20 <i>2.252</i>	Zinc Plated Steel	16.7 <i>0.657</i>	5.0 <i>0.197</i>	5.56 (7/32)	1.588 <i>0.063</i>
# SC095C-064-B-SK-CZ	3/8-16 UNC (9.525mm)	63.50 <i>2.500</i>	Zinc Plated Steel	16.7 <i>0.657</i>	5.0 <i>0.197</i>	5.56 (7/32)	1.588 <i>0.063</i>

Indicates item not stocked at time of printing - Please enquire for lead time

Page 20 of 29

E&OE Pricing and all details subject to change without notice - Copyright Miniature Bearings Australia Pty Ltd
MBA Size Listings are a guide to sizes only and must not be solely relied on for critical design information.

Screws - Button - Socket - Zinc Plated

Part Number	Thread Size (C)	Length (L) mm	Material	Max Head Diameter mm	Max Head Height mm	Hex Key (D) mm	Pitch mm
		<i>inches</i>		<i>inches</i>	<i>inches</i>	<i>inches</i>	<i>inches</i>
# SC095C-070-B-SK-CZ	3/8-16 UNC (9.525mm)	69.90 <i>2.752</i>	Zinc Plated Steel	16.7 <i>0.657</i>	5.0 <i>0.197</i>	5.56 (7/32)	1.588 <i>0.063</i>
# SC095C-076-B-SK-CZ	3/8-16 UNC (9.525mm)	76.20 <i>3.000</i>	Zinc Plated Steel	16.7 <i>0.657</i>	5.0 <i>0.197</i>	5.56 (7/32)	1.588 <i>0.063</i>
# SC095W-019-B-SK-CZ	3/8-16 BSW (9.525mm)	19.1 <i>0.752</i>	Zinc Plated Steel	16.7 <i>0.657</i>	5.0 <i>0.197</i>	5.56 (7/32)	1.588 <i>0.063</i>
# SC095W-025-B-SK-CZ	3/8-16 BSW (9.525mm)	25.4 <i>1.000</i>	Zinc Plated Steel	16.7 <i>0.657</i>	5.0 <i>0.197</i>	5.56 (7/32)	1.588 <i>0.063</i>
# SC095W-032-B-SK-CZ	3/8-16 BSW (9.525mm)	31.8 <i>1.252</i>	Zinc Plated Steel	16.7 <i>0.657</i>	5.0 <i>0.197</i>	5.56 (7/32)	1.588 <i>0.063</i>
# SC095W-038-B-SK-CZ	3/8-16 BSW (9.525mm)	38.1 <i>1.500</i>	Zinc Plated Steel	16.7 <i>0.657</i>	5.0 <i>0.197</i>	5.56 (7/32)	1.588 <i>0.063</i>
# SC095F-013-B-SK-CZ	3/8-24 UNF (9.525mm)	12.7 <i>0.500</i>	Zinc Plated Steel	16.7 <i>0.657</i>	5.0 <i>0.197</i>	5.56 (7/32)	1.058 <i>0.042</i>
# SC095F-016-B-SK-CZ	3/8-24 UNF (9.525mm)	15.9 <i>0.626</i>	Zinc Plated Steel	16.7 <i>0.657</i>	5.0 <i>0.197</i>	5.56 (7/32)	1.058 <i>0.042</i>

Indicates item not stocked at time of printing - Please enquire for lead time

Page 21 of 29

E&OE Pricing and all details subject to change without notice - Copyright Miniature Bearings Australia Pty Ltd
MBA Size Listings are a guide to sizes only and must not be solely relied on for critical design information.

Screws - Button - Socket - Zinc Plated

Part Number	Thread Size (C)	Length (L) mm	Material	Max Head Diameter mm	Max Head Height mm	Hex Key (D) mm	Pitch mm
		<i>inches</i>		<i>inches</i>	<i>inches</i>	<i>inches</i>	<i>inches</i>
# SC095F-019-B-SK-CZ	3/8-24 UNF (9.525mm)	19.1 <i>0.752</i>	Zinc Plated Steel	16.7 <i>0.657</i>	5.0 <i>0.197</i>	5.56 (7/32)	1.058 <i>0.042</i>
# SC095F-025-B-SK-CZ	3/8-24 UNF (9.525mm)	25.4 <i>1.000</i>	Zinc Plated Steel	16.7 <i>0.657</i>	5.0 <i>0.197</i>	5.56 (7/32)	1.058 <i>0.042</i>
# SC095F-032-B-SK-CZ	3/8-24 UNF (9.525mm)	31.8 <i>1.252</i>	Zinc Plated Steel	16.7 <i>0.657</i>	5.0 <i>0.197</i>	5.56 (7/32)	1.058 <i>0.042</i>
# SC095F-038-B-SK-CZ	3/8-24 UNF (9.525mm)	38.1 <i>1.500</i>	Zinc Plated Steel	16.7 <i>0.657</i>	5.0 <i>0.197</i>	5.56 (7/32)	1.058 <i>0.042</i>
# SC100M-012-B-SK-CZ	M10x1.5 (10mm Standard)	12 <i>0.472</i>	Zinc Plated Steel	18.0 <i>0.709</i>	5.5 <i>0.217</i>	6.00 <i>0.236</i>	1.500 <i>0.059</i>
# SC100M-016-B-SK-CZ	M10x1.5 (10mm Standard)	16 <i>0.630</i>	Zinc Plated Steel	18.0 <i>0.709</i>	5.5 <i>0.217</i>	6.00 <i>0.236</i>	1.500 <i>0.059</i>
# SC100M-020-B-SK-CZ	M10x1.5 (10mm Standard)	20 <i>0.787</i>	Zinc Plated Steel	18.0 <i>0.709</i>	5.5 <i>0.217</i>	6.00 <i>0.236</i>	1.500 <i>0.059</i>
# SC100M-025-B-SK-CZ	M10x1.5 (10mm Standard)	25 <i>0.984</i>	Zinc Plated Steel	18.0 <i>0.709</i>	5.5 <i>0.217</i>	6.00 <i>0.236</i>	1.500 <i>0.059</i>

Indicates item not stocked at time of printing - Please enquire for lead time

Page 22 of 29

E&OE Pricing and all details subject to change without notice - Copyright Miniature Bearings Australia Pty Ltd
MBA Size Listings are a guide to sizes only and must not be solely relied on for critical design information.

Screws - Button - Socket - Zinc Plated

Part Number	Thread Size (C)	Length (L) mm	Material	Max Head Diameter mm	Max Head Height mm	Hex Key (D) mm	Pitch mm
		<i>inches</i>		<i>inches</i>	<i>inches</i>	<i>inches</i>	<i>inches</i>
# SC100M-030-B-SK-CZ	M10x1.5 (10mm Standard)	30 <i>1.181</i>	Zinc Plated Steel	18.0 <i>0.709</i>	5.5 <i>0.217</i>	6.00 <i>0.236</i>	1.500 <i>0.059</i>
# SC100M-035-B-SK-CZ	M10x1.5 (10mm Standard)	35 <i>1.378</i>	Zinc Plated Steel	18.0 <i>0.709</i>	5.5 <i>0.217</i>	6.00 <i>0.236</i>	1.500 <i>0.059</i>
# SC100M-040-B-SK-CZ	M10x1.5 (10mm Standard)	40 <i>1.575</i>	Zinc Plated Steel	18.0 <i>0.709</i>	5.5 <i>0.217</i>	6.00 <i>0.236</i>	1.500 <i>0.059</i>
# SC100M-045-B-SK-CZ	M10x1.5 (10mm Standard)	45 <i>1.772</i>	Zinc Plated Steel	18.0 <i>0.709</i>	5.5 <i>0.217</i>	6.00 <i>0.236</i>	1.500 <i>0.059</i>
# SC100M-050-B-SK-CZ	M10x1.5 (10mm Standard)	50 <i>1.969</i>	Zinc Plated Steel	18.0 <i>0.709</i>	5.5 <i>0.217</i>	6.00 <i>0.236</i>	1.500 <i>0.059</i>
# SC100M-055-B-SK-CZ	M10x1.5 (10mm Standard)	55 <i>2.165</i>	Zinc Plated Steel	18.0 <i>0.709</i>	5.5 <i>0.217</i>	6.00 <i>0.236</i>	1.500 <i>0.059</i>
# SC100M-060-B-SK-CZ	M10x1.5 (10mm Standard)	60 <i>2.362</i>	Zinc Plated Steel	18.0 <i>0.709</i>	5.5 <i>0.217</i>	6.00 <i>0.236</i>	1.500 <i>0.059</i>
# SC100M-070-B-SK-CZ	M10x1.5 (10mm Standard)	70 <i>2.756</i>	Zinc Plated Steel	18.0 <i>0.709</i>	5.5 <i>0.217</i>	6.00 <i>0.236</i>	1.500 <i>0.059</i>

Indicates item not stocked at time of printing - Please enquire for lead time

Page 23 of 29

E&OE Pricing and all details subject to change without notice - Copyright Miniature Bearings Australia Pty Ltd

MBA Size Listings are a guide to sizes only and must not be solely relied on for critical design information.

Screws - Button - Socket - Zinc Plated

Part Number	Thread Size (C)	Length (L) mm	Material	Max Head Diameter mm	Max Head Height mm	Hex Key (D) mm	Pitch mm
		<i>inches</i>		<i>inches</i>	<i>inches</i>	<i>inches</i>	<i>inches</i>
# SC100M-080-B-SK-CZ	M10x1.5 (10mm Standard)	80 <i>3.150</i>	Zinc Plated Steel	18.0 <i>0.709</i>	5.5 <i>0.217</i>	6.00 <i>0.236</i>	1.500 <i>0.059</i>
# SC100M-090-B-SK-CZ	M10x1.5 (10mm Standard)	90 <i>3.543</i>	Zinc Plated Steel	18.0 <i>0.709</i>	5.5 <i>0.217</i>	6.00 <i>0.236</i>	1.500 <i>0.059</i>
# SC100M-100-B-SK-CZ	M10x1.5 (10mm Standard)	100 <i>3.937</i>	Zinc Plated Steel	18.0 <i>0.709</i>	5.5 <i>0.217</i>	6.00 <i>0.236</i>	1.500 <i>0.059</i>
# SC120M-016-B-SK-CZ	M12x1.75 (12mm Standard)	16 <i>0.630</i>	Zinc Plated Steel	21.0 <i>0.827</i>	6.6 <i>0.260</i>	8.00 <i>0.315</i>	1.750 <i>0.069</i>
# SC120M-020-B-SK-CZ	M12x1.75 (12mm Standard)	20 <i>0.787</i>	Zinc Plated Steel	21.0 <i>0.827</i>	6.6 <i>0.260</i>	8.00 <i>0.315</i>	1.750 <i>0.069</i>
SC120M-025-B-SK-CZ	M12x1.75 (12mm Standard)	25 <i>0.984</i>	Zinc Plated Steel	21.0 <i>0.827</i>	6.6 <i>0.260</i>	8.00 <i>0.315</i>	1.750 <i>0.069</i>
# SC120M-030-B-SK-CZ	M12x1.75 (12mm Standard)	30 <i>1.181</i>	Zinc Plated Steel	21.0 <i>0.827</i>	6.6 <i>0.260</i>	8.00 <i>0.315</i>	1.750 <i>0.069</i>
# SC120M-035-B-SK-CZ	M12x1.75 (12mm Standard)	35 <i>1.378</i>	Zinc Plated Steel	21.0 <i>0.827</i>	6.6 <i>0.260</i>	8.00 <i>0.315</i>	1.750 <i>0.069</i>

Indicates item not stocked at time of printing - Please enquire for lead time

Page 24 of 29

E&OE Pricing and all details subject to change without notice - Copyright Miniature Bearings Australia Pty Ltd
MBA Size Listings are a guide to sizes only and must not be solely relied on for critical design information.

Screws - Button - Socket - Zinc Plated

Part Number	Thread Size (C)	Length (L) mm	Material	Max Head Diameter mm	Max Head Height mm	Hex Key (D) mm	Pitch mm
		<i>inches</i>		<i>inches</i>	<i>inches</i>	<i>inches</i>	<i>inches</i>
# SC120M-040-B-SK-CZ	M12x1.75 (12mm Standard)	40 <i>1.575</i>	Zinc Plated Steel	21.0 <i>0.827</i>	6.6 <i>0.260</i>	8.00 <i>0.315</i>	1.750 <i>0.069</i>
# SC120M-045-B-SK-CZ	M12x1.75 (12mm Standard)	45 <i>1.772</i>	Zinc Plated Steel	21.0 <i>0.827</i>	6.6 <i>0.260</i>	8.00 <i>0.315</i>	1.750 <i>0.069</i>
# SC120M-050-B-SK-CZ	M12x1.75 (12mm Standard)	50 <i>1.969</i>	Zinc Plated Steel	21.0 <i>0.827</i>	6.6 <i>0.260</i>	8.00 <i>0.315</i>	1.750 <i>0.069</i>
# SC120M-060-B-SK-CZ	M12x1.75 (12mm Standard)	60 <i>2.362</i>	Zinc Plated Steel	21.0 <i>0.827</i>	6.6 <i>0.260</i>	8.00 <i>0.315</i>	1.750 <i>0.069</i>
# SC120M-070-B-SK-CZ	M12x1.75 (12mm Standard)	70 <i>2.756</i>	Zinc Plated Steel	21.0 <i>0.827</i>	6.6 <i>0.260</i>	8.00 <i>0.315</i>	1.750 <i>0.069</i>
SC120M-080-B-SK-CZ	M12x1.75 (12mm Standard)	80 <i>3.150</i>	Zinc Plated Steel	21.0 <i>0.827</i>	6.6 <i>0.260</i>	8.00 <i>0.315</i>	1.750 <i>0.069</i>
# SC120M-090-B-SK-CZ	M12x1.75 (12mm Standard)	90 <i>3.543</i>	Zinc Plated Steel	21.0 <i>0.827</i>	6.6 <i>0.260</i>	8.00 <i>0.315</i>	1.750 <i>0.069</i>
# SC120M-100-B-SK-CZ	M12x1.75 (12mm Standard)	100 <i>3.937</i>	Zinc Plated Steel	21.0 <i>0.827</i>	6.6 <i>0.260</i>	8.00 <i>0.315</i>	1.750 <i>0.069</i>

Indicates item not stocked at time of printing - Please enquire for lead time

Page 25 of 29

E&OE Pricing and all details subject to change without notice - Copyright Miniature Bearings Australia Pty Ltd

MBA Size Listings are a guide to sizes only and must not be solely relied on for critical design information.

Screws - Button - Socket - Zinc Plated

Part Number	Thread Size (C)	Length (L) mm	Material	Max Head Diameter mm	Max Head Height mm	Hex Key (D) mm	Pitch mm
		<i>inches</i>		<i>inches</i>	<i>inches</i>	<i>inches</i>	<i>inches</i>
# SC127C-019-B-SK-CZ	1/2-13 UNC (12.7mm)	19.1 <i>0.752</i>	Zinc Plated Steel	22.2 <i>0.874</i>	6.7 <i>0.264</i>	7.94 (5/16)	1.954 <i>0.077</i>
# SC127C-025-B-SK-CZ	1/2-13 UNC (12.7mm)	25.4 <i>1.000</i>	Zinc Plated Steel	22.2 <i>0.874</i>	6.7 <i>0.264</i>	7.94 (5/16)	1.954 <i>0.077</i>
# SC127C-032-B-SK-CZ	1/2-13 UNC (12.7mm)	31.8 <i>1.252</i>	Zinc Plated Steel	22.2 <i>0.874</i>	6.7 <i>0.264</i>	7.94 (5/16)	1.954 <i>0.077</i>
# SC127C-038-B-SK-CZ	1/2-13 UNC (12.7mm)	38.1 <i>1.500</i>	Zinc Plated Steel	22.2 <i>0.874</i>	6.7 <i>0.264</i>	7.94 (5/16)	1.954 <i>0.077</i>
# SC127C-045-B-SK-CZ	1/2-13 UNC (12.7mm)	44.5 <i>1.752</i>	Zinc Plated Steel	22.2 <i>0.874</i>	6.7 <i>0.264</i>	7.94 (5/16)	1.954 <i>0.077</i>
# SC127C-051-B-SK-CZ	1/2-13 UNC (12.7mm)	50.8 <i>2.000</i>	Zinc Plated Steel	22.2 <i>0.874</i>	6.7 <i>0.264</i>	7.94 (5/16)	1.954 <i>0.077</i>
# SC127C-064-B-SK-CZ	1/2-13 UNC (12.7mm)	63.5 <i>2.500</i>	Zinc Plated Steel	22.2 <i>0.874</i>	6.7 <i>0.264</i>	7.94 (5/16)	1.954 <i>0.077</i>
# SC127C-076-B-SK-CZ	1/2-13 UNC (12.7mm)	76.2 <i>3.000</i>	Zinc Plated Steel	22.2 <i>0.874</i>	6.7 <i>0.264</i>	7.94 (5/16)	1.954 <i>0.077</i>
# SC127C-089-B-SK-CZ	1/2-13 UNC (12.7mm)	88.90 <i>3.500</i>	Zinc Plated Steel	22.2 <i>0.874</i>	6.7 <i>0.264</i>	7.94 (5/16)	1.954 <i>0.077</i>
# SC127W-019-B-SK-CZ	1/2-12 BSW (12.7mm)	19.1 <i>0.752</i>	Zinc Plated Steel	22.2 <i>0.874</i>	6.7 <i>0.264</i>	7.94 (5/16)	2.117 <i>0.083</i>

Indicates item not stocked at time of printing - Please enquire for lead time

Page 26 of 29

E&OE Pricing and all details subject to change without notice - Copyright Miniature Bearings Australia Pty Ltd
MBA Size Listings are a guide to sizes only and must not be solely relied on for critical design information.

Screws - Button - Socket - Zinc Plated

Part Number	Thread Size (C)	Length (L) mm	Material	Max Head Diameter mm	Max Head Height mm	Hex Key (D) mm	Pitch mm
		<i>inches</i>		<i>inches</i>	<i>inches</i>	<i>inches</i>	<i>inches</i>
# SC127W-025-B-SK-CZ	1/2-12 BSW (12.7mm)	25.4 <i>1.000</i>	Zinc Plated Steel	22.2 <i>0.874</i>	6.7 <i>0.264</i>	7.94 (5/16)	2.117 <i>0.083</i>
# SC127W-032-B-SK-CZ	1/2-12 BSW (12.7mm)	31.8 <i>1.252</i>	Zinc Plated Steel	22.2 <i>0.874</i>	6.7 <i>0.264</i>	7.94 (5/16)	2.117 <i>0.083</i>
# SC127W-038-B-SK-CZ	1/2-12 BSW (12.7mm)	38.1 <i>1.500</i>	Zinc Plated Steel	22.2 <i>0.874</i>	6.7 <i>0.264</i>	7.94 (5/16)	2.117 <i>0.083</i>
# SC127W-045-B-SK-CZ	1/2-12 BSW (12.7mm)	44.5 <i>1.752</i>	Zinc Plated Steel	22.2 <i>0.874</i>	6.7 <i>0.264</i>	7.94 (5/16)	2.117 <i>0.083</i>
# SC127W-051-B-SK-CZ	1/2-12 BSW (12.7mm)	50.8 <i>2.000</i>	Zinc Plated Steel	22.2 <i>0.874</i>	6.7 <i>0.264</i>	7.94 (5/16)	2.117 <i>0.083</i>
# SC127W-064-B-SK-CZ	1/2-12 BSW (12.7mm)	63.5 <i>2.500</i>	Zinc Plated Steel	22.2 <i>0.874</i>	6.7 <i>0.264</i>	7.94 (5/16)	2.117 <i>0.083</i>
# SC127W-076-B-SK-CZ	1/2-12 BSW (12.7mm)	76.2 <i>3.000</i>	Zinc Plated Steel	22.2 <i>0.874</i>	6.7 <i>0.264</i>	7.94 (5/16)	2.117 <i>0.083</i>
# SC127F-032-B-SK-CZ	1/2-20 UNF (12.7mm)	31.8 <i>1.252</i>	Zinc Plated Steel	22.2 <i>0.874</i>	6.7 <i>0.264</i>	7.94 (5/16)	1.270 <i>0.050</i>
# SC127F-038-B-SK-CZ	1/2-20 UNF (12.7mm)	38.1 <i>1.500</i>	Zinc Plated Steel	22.2 <i>0.874</i>	6.7 <i>0.264</i>	7.94 (5/16)	1.270 <i>0.050</i>
# SC127F-051-B-SK-CZ	1/2-20 UNF (12.7mm)	50.8 <i>2.000</i>	Zinc Plated Steel	22.2 <i>0.874</i>	6.7 <i>0.264</i>	7.94 (5/16)	1.270 <i>0.050</i>

Indicates item not stocked at time of printing - Please enquire for lead time

Page 27 of 29

E&OE Pricing and all details subject to change without notice - Copyright Miniature Bearings Australia Pty Ltd
MBA Size Listings are a guide to sizes only and must not be solely relied on for critical design information.

Screws - Button - Socket - Zinc Plated

Part Number	Thread Size (C)	Length (L) mm	Material	Max Head Diameter mm	Max Head Height mm	Hex Key (D) mm	Pitch mm
		<i>inches</i>		<i>inches</i>	<i>inches</i>	<i>inches</i>	<i>inches</i>
# SC159C-032-B-SK-CZ	5/8-11 UNC (15.875mm)	31.8 <i>1.252</i>	Zinc Plated Steel	25.4 <i>1.000</i>	8.4 <i>0.331</i>	9.53 (3/8)	2.309 <i>0.091</i>
# SC159C-038-B-SK-CZ	5/8-11 UNC (15.875mm)	38.1 <i>1.500</i>	Zinc Plated Steel	25.4 <i>1.000</i>	8.4 <i>0.331</i>	9.53 (3/8)	2.309 <i>0.091</i>
# SC159C-045-B-SK-CZ	5/8-11 UNC (15.875mm)	44.5 <i>1.752</i>	Zinc Plated Steel	25.4 <i>1.000</i>	8.4 <i>0.331</i>	9.53 (3/8)	2.309 <i>0.091</i>
# SC159C-051-B-SK-CZ	5/8-11 UNC (15.875mm)	50.8 <i>2.000</i>	Zinc Plated Steel	25.4 <i>1.000</i>	8.4 <i>0.331</i>	9.53 (3/8)	2.309 <i>0.091</i>
# SC159C-064-B-SK-CZ	5/8-11 UNC (15.875mm)	63.5 <i>2.500</i>	Zinc Plated Steel	25.4 <i>1.000</i>	8.4 <i>0.331</i>	9.53 (3/8)	2.309 <i>0.091</i>
# SC159C-076-B-SK-CZ	5/8-11 UNC (15.875mm)	76.2 <i>3.000</i>	Zinc Plated Steel	25.4 <i>1.000</i>	8.4 <i>0.331</i>	9.53 (3/8)	2.309 <i>0.091</i>
# SC160M-030-B-SK-CZ	M16x2 (16mm Standard)	30 <i>1.181</i>	Zinc Plated Steel	28.0 <i>1.102</i>	8.6 <i>0.339</i>	10.00 <i>0.394</i>	2.000 <i>0.079</i>
# SC160M-040-B-SK-CZ	M16x2 (16mm Standard)	40 <i>1.575</i>	Zinc Plated Steel	28.0 <i>1.102</i>	8.6 <i>0.339</i>	10.00 <i>0.394</i>	2.000 <i>0.079</i>

Indicates item not stocked at time of printing - Please enquire for lead time

Page 28 of 29

E&OE Pricing and all details subject to change without notice - Copyright Miniature Bearings Australia Pty Ltd

MBA Size Listings are a guide to sizes only and must not be solely relied on for critical design information.

Screws - Button - Socket - Zinc Plated

Part Number	Thread Size (C)	Length (L) mm	Material	Max Head Diameter mm	Max Head Height mm	Hex Key (D) mm	Pitch mm
		<i>inches</i>		<i>inches</i>	<i>inches</i>	<i>inches</i>	<i>inches</i>
# SC160M-050-B-SK-CZ	M16x2 (16mm Standard)	50 <i>1.969</i>	Zinc Plated Steel	28.0 <i>1.102</i>	8.6 <i>0.339</i>	10.00 <i>0.394</i>	2.000 <i>0.079</i>
# SC160M-060-B-SK-CZ	M16x2 (16mm Standard)	60 <i>2.362</i>	Zinc Plated Steel	28.0 <i>1.102</i>	8.6 <i>0.339</i>	10.00 <i>0.394</i>	2.000 <i>0.079</i>
# SC160M-070-B-SK-CZ	M16x2 (16mm Standard)	70 <i>2.756</i>	Zinc Plated Steel	28.0 <i>1.102</i>	8.6 <i>0.339</i>	10.00 <i>0.394</i>	2.000 <i>0.079</i>
# SC160M-080-B-SK-CZ	M16x2 (16mm Standard)	80 <i>3.150</i>	Zinc Plated Steel	28.0 <i>1.102</i>	8.6 <i>0.339</i>	10.00 <i>0.394</i>	2.000 <i>0.079</i>
# SC160M-090-B-SK-CZ	M16x2 (16mm Standard)	90 <i>3.543</i>	Zinc Plated Steel	28.0 <i>1.102</i>	8.6 <i>0.339</i>	10.00 <i>0.394</i>	2.000 <i>0.079</i>
# SC160M-100-B-SK-CZ	M16x2 (16mm Standard)	100 <i>3.937</i>	Zinc Plated Steel	28.0 <i>1.102</i>	8.6 <i>0.339</i>	10.00 <i>0.394</i>	2.000 <i>0.079</i>

Indicates item not stocked at time of printing - Please enquire for lead time

Page 29 of 29

E&OE Pricing and all details subject to change without notice - Copyright Miniature Bearings Australia Pty Ltd
MBA Size Listings are a guide to sizes only and must not be solely relied on for critical design information.

DISTRIBUTED BY

Distributed By:

