



Screws - Cap - Socket - Alloy Steel - Brass Tipped

10/4/2018

Indicates item not stocked at time of printing - Please enquire for lead time

E&OE Pricing and all details subject to change without notice - Copyright Miniature Bearings Australia Pty Ltd

MBA Size Listings are a guide to sizes only and must not be solely relied on for critical design information.

Page 1 of 4

INFORMATION

Brass tipped socket cap screws in alloy steel

Indicates item not stocked at time of printing - Please enquire for lead time

E&OE Pricing and all details subject to change without notice - Copyright Miniature Bearings Australia Pty Ltd

MBA Size Listings are a guide to sizes only and must not be solely relied on for critical design information.

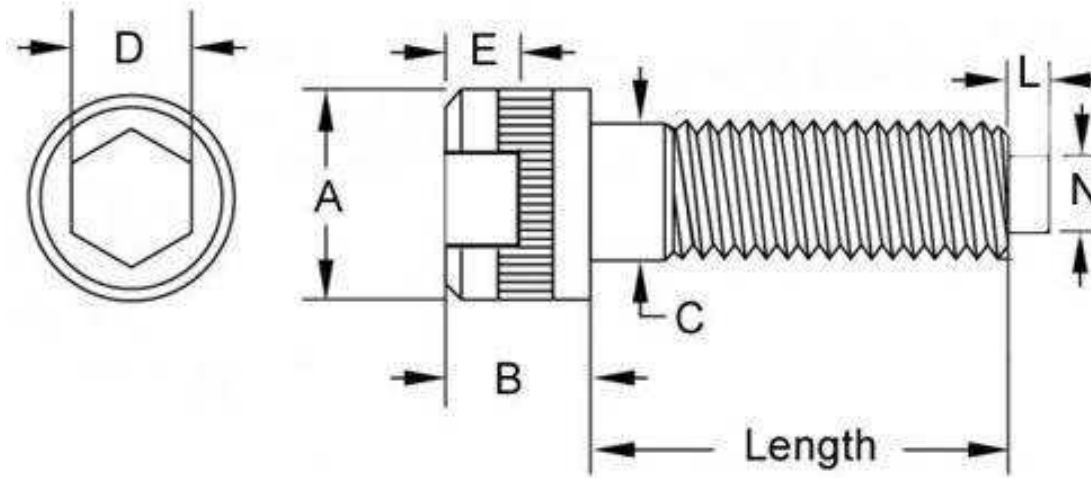

Indicates item not stocked at time of printing - Please enquire for lead time

E&OE Pricing and all details subject to change without notice - Copyright Miniature Bearings Australia Pty Ltd

MBA Size Listings are a guide to sizes only and must not be solely relied on for critical design information.

Screws - Cap - Socket - Alloy Steel - Brass Tipped

Part Number	Thread Size	Length (L) mm	Tip Diameter mm	Tip Length mm	Head Length (B Max.) mm	Head Diameter (A Max.) mm
		<i>inches</i>	<i>inches</i>	<i>inches</i>	<i>inches</i>	<i>inches</i>
# SC048F-025-C-SK-C-BT	10-32 UNF (4.762mm)	25.40 <i>1.000</i>	2.40 <i>0.094</i>	1.16 <i>0.046</i>	4.83 <i>0.190</i>	7.92 <i>0.312</i>
# SC064C-038-C-SK-C-BT	1/4-20 UNC (6.35mm)	38.10 <i>1.500</i>	3.20 <i>0.126</i>	1.57 <i>0.062</i>	6.35 <i>0.250</i>	9.53 <i>0.375</i>
# SC064C-025-C-SK-C-BT	1/4-20 UNC (6.35mm)	25.40 <i>1.000</i>	3.20 <i>0.126</i>	1.57 <i>0.062</i>	6.35 <i>0.250</i>	9.53 <i>0.375</i>
# SC064C-019-C-SK-C-BT	1/4-20 UNC (6.35mm)	19.05 <i>0.750</i>	3.20 <i>0.126</i>	1.57 <i>0.062</i>	6.35 <i>0.250</i>	9.53 <i>0.375</i>
# SC064C-013-C-SK-C-BT	1/4-20 UNC (6.35mm)	12.70 <i>0.500</i>	3.20 <i>0.126</i>	1.57 <i>0.062</i>	6.35 <i>0.250</i>	9.53 <i>0.375</i>
# SC079C-038-C-SK-C-BT	5/16-18 UNC (7.938mm)	38.10 <i>1.500</i>	4.80 <i>0.189</i>	2.36 <i>0.093</i>	7.93 <i>0.312</i>	11.89 <i>0.468</i>
# SC095C-038-C-SK-C-BT	3/8-16 UNC (9.525mm)	38.10 <i>1.500</i>	4.80 <i>0.189</i>	2.36 <i>0.093</i>	9.53 <i>0.375</i>	14.27 <i>0.562</i>

Indicates item not stocked at time of printing - Please enquire for lead time

E&OE Pricing and all details subject to change without notice - Copyright Miniature Bearings Australia Pty Ltd

MBA Size Listings are a guide to sizes only and must not be solely relied on for critical design information.

DISTRIBUTED BY

Distributed By:

