



Screws - Cap - Socket - Alloy Steel - Nylon Tipped

10/4/2018

Indicates item not stocked at time of printing - Please enquire for lead time

E&OE Pricing and all details subject to change without notice - Copyright Miniature Bearings Australia Pty Ltd

MBA Size Listings are a guide to sizes only and must not be solely relied on for critical design information.

INFORMATION

Nylon tipped socket cap screws in alloy steel

Indicates item not stocked at time of printing - Please enquire for lead time

E&OE Pricing and all details subject to change without notice - Copyright Miniature Bearings Australia Pty Ltd

MBA Size Listings are a guide to sizes only and must not be solely relied on for critical design information.

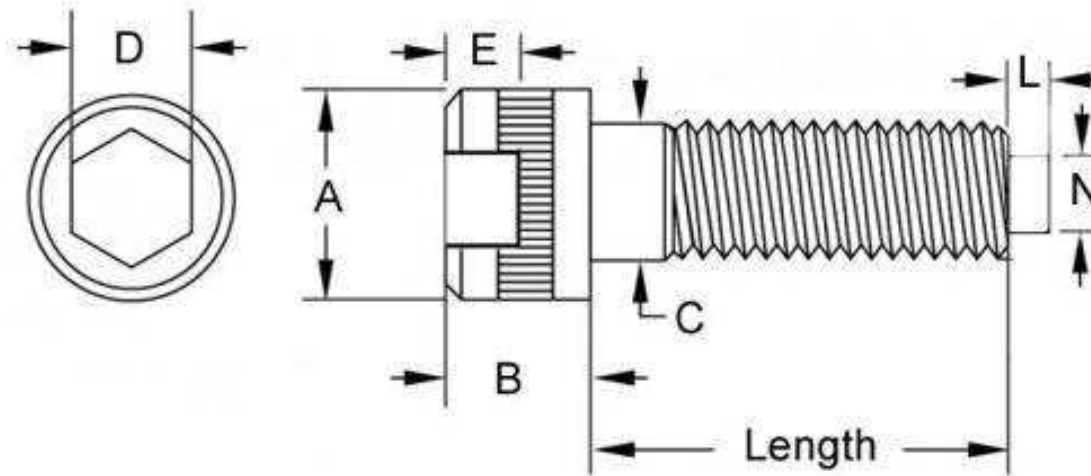

Indicates item not stocked at time of printing - Please enquire for lead time

E&OE Pricing and all details subject to change without notice - Copyright Miniature Bearings Australia Pty Ltd

MBA Size Listings are a guide to sizes only and must not be solely relied on for critical design information.

Screws - Cap - Socket - Alloy Steel - Nylon Tipped

Part Number	Thread Size	Length (L) mm	Tip Diameter mm	Tip Length mm	Head Length (B Max.) mm	Head Diameter (A Max.) mm
		<i>inches</i>	<i>inches</i>	<i>inches</i>	<i>inches</i>	<i>inches</i>
SC048C-025-C-SK-C-NT	10-24 UNC (4.762mm)	25.40 <i>1.000</i>	2.40 <i>0.094</i>	1.16 <i>0.046</i>	4.83 <i>0.190</i>	7.93 <i>0.312</i>
# SC048C-019-C-SK-C-NT	10-24 UNC (4.762mm)	19.05 <i>0.750</i>	2.40 <i>0.094</i>	1.16 <i>0.046</i>	4.83 <i>0.190</i>	7.93 <i>0.312</i>
# SC048C-013-C-SK-C-NT	10-24 UNC (4.762mm)	12.70 <i>0.500</i>	2.40 <i>0.094</i>	1.16 <i>0.046</i>	4.83 <i>0.190</i>	7.93 <i>0.312</i>
SC064C-038-C-SK-C-NT	1/4-20 UNC (6.35mm)	38.10 <i>1.500</i>	3.20 <i>0.126</i>	1.57 <i>0.062</i>	6.35 <i>0.250</i>	9.53 <i>0.375</i>
SC064C-025-C-SK-C-NT	1/4-20 UNC (6.35mm)	25.40 <i>1.000</i>	3.20 <i>0.126</i>	1.57 <i>0.062</i>	6.35 <i>0.250</i>	9.53 <i>0.375</i>
SC064C-013-C-SK-C-NT	1/4-20 UNC (6.35mm)	12.70 <i>0.500</i>	3.20 <i>0.126</i>	1.57 <i>0.062</i>	6.35 <i>0.250</i>	9.53 <i>0.375</i>
SC079C-038-C-SK-C-NT	5/16-18 UNC (7.938mm)	38.10 <i>1.500</i>	4.80 <i>0.189</i>	1.57 <i>0.062</i>	7.94 <i>0.313</i>	11.89 <i>0.468</i>
SC095C-025-C-SK-C-NT	3/8-16 UNC (9.525mm)	25.40 <i>1.000</i>	4.80 <i>0.189</i>	2.30 <i>0.091</i>	9.53 <i>0.375</i>	14.27 <i>0.562</i>
SC095C-038-C-SK-C-NT	3/8-16 UNC (9.525mm)	38.10 <i>1.500</i>	4.80 <i>0.189</i>	2.36 <i>0.093</i>	9.53 <i>0.375</i>	14.27 <i>0.562</i>

Indicates item not stocked at time of printing - Please enquire for lead time

E&OE Pricing and all details subject to change without notice - Copyright Miniature Bearings Australia Pty Ltd

MBA Size Listings are a guide to sizes only and must not be solely relied on for critical design information.

DISTRIBUTED BY

Distributed By:

