



Screws - Panel - Steel

10/4/2018

Indicates item not stocked at time of printing - Please enquire for lead time

E&OE Pricing and all details subject to change without notice - Copyright Miniature Bearings Australia Pty Ltd

MBA Size Listings are a guide to sizes only and must not be solely relied on for critical design information.

Page 1 of 4

INFORMATION

Extra large head. One piece construction. Carbon steel with black oxide finish.

Indicates item not stocked at time of printing - Please enquire for lead time

E&OE Pricing and all details subject to change without notice - Copyright Miniature Bearings Australia Pty Ltd

MBA Size Listings are a guide to sizes only and must not be solely relied on for critical design information.

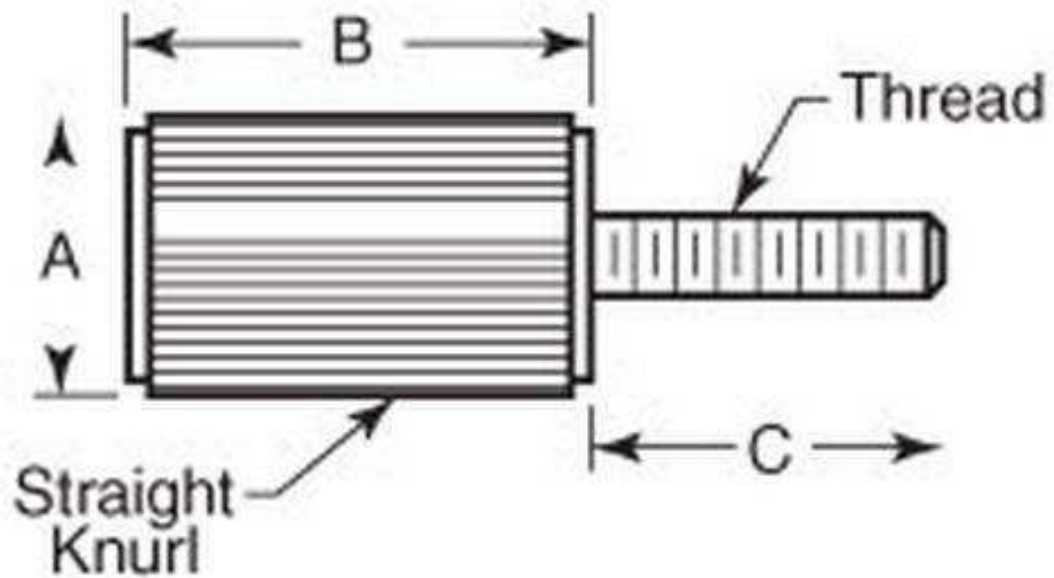

Indicates item not stocked at time of printing - Please enquire for lead time

E&OE Pricing and all details subject to change without notice - Copyright Miniature Bearings Australia Pty Ltd

MBA Size Listings are a guide to sizes only and must not be solely relied on for critical design information.

Screws - Panel - Steel

Part Number	Thread	A mm	B mm	C mm
		<i>inches</i>	<i>inches</i>	<i>inches</i>
# SCP064C-016-C	1/4-20 UNC (6.35mm)	15.870 <i>0.625</i>	12.700 <i>0.500</i>	19.050 <i>0.750</i>
# SCP079C-019-C	5/16-18 UNC (7.938mm)	19.050 <i>0.750</i>	14.270 <i>0.562</i>	19.050 <i>0.750</i>
# SCP095C-022-C	3/8-16 UNC (9.525mm)	22.220 <i>0.875</i>	26.970 <i>1.062</i>	19.050 <i>0.750</i>

Indicates item not stocked at time of printing - Please enquire for lead time

E&OE Pricing and all details subject to change without notice - Copyright Miniature Bearings Australia Pty Ltd

MBA Size Listings are a guide to sizes only and must not be solely relied on for critical design information.

DISTRIBUTED BY

Distributed By:

