



Screws - Shoulder - Socket Head - Carbon Steel

10/4/2018

Indicates item not stocked at time of printing - Please enquire for lead time

E&OE Pricing and all details subject to change without notice - Copyright Miniature Bearings Australia Pty Ltd

MBA Size Listings are a guide to sizes only and must not be solely relied on for critical design information.

Page 1 of 31

INFORMATION

Also known as stripper bolts

Indicates item not stocked at time of printing - Please enquire for lead time

E&OE Pricing and all details subject to change without notice - Copyright Miniature Bearings Australia Pty Ltd

MBA Size Listings are a guide to sizes only and must not be solely relied on for critical design information.

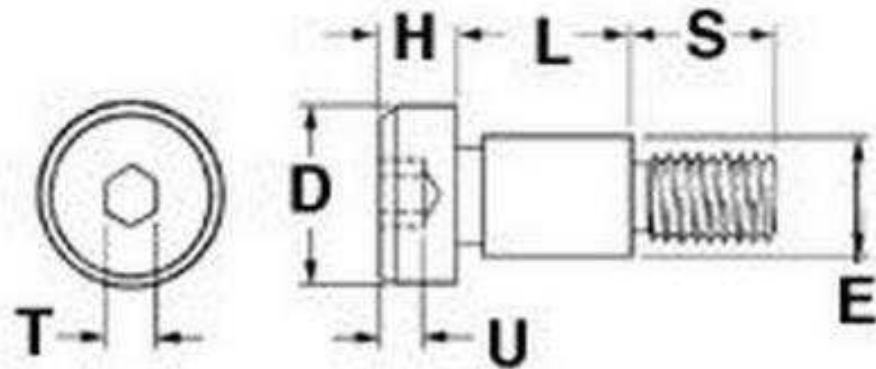

Indicates item not stocked at time of printing - Please enquire for lead time

E&OE Pricing and all details subject to change without notice - Copyright Miniature Bearings Australia Pty Ltd

MBA Size Listings are a guide to sizes only and must not be solely relied on for critical design information.

Screws - Shoulder - Socket Head - Carbon Steel

Part Number	Shoulder Diameter (E) mm	Shoulder Length (L) mm	Thread Size (t)	Max. Thread Length (S) mm	Head Diameter (D) mm	Thread Type	Head Height (H) mm	Material	Allen Key Size (T) mm
	<i>inches</i>	<i>inches</i>		<i>inches</i>	<i>inches</i>		<i>inches</i>		<i>inches</i>
# SHLD060-005-SKT-C	6.000	5.000	M5x0.8	6.00	12.00		4.00	Hardened Carbon Steel	3.0
	<i>0.236</i>	<i>0.197</i>		<i>0.236</i>	<i>0.472</i>		<i>0.157</i>		<i>0.118</i>
# SHLD060-006-SKT-C	6.000	6.000	M5x0.8	6.00	12.00		4.00	Hardened Carbon Steel	3.0
	<i>0.236</i>	<i>0.236</i>		<i>0.236</i>	<i>0.472</i>		<i>0.157</i>		<i>0.118</i>
SHLD060-010-SKT-C	6.000	10.000	M5x0.8	9.50	10.00		4.50	Hardened Carbon Steel	3.0
	<i>0.236</i>	<i>0.394</i>		<i>0.374</i>	<i>0.394</i>		<i>0.177</i>		<i>0.118</i>
SHLD060-012-SKT-C	6.000	12.000	M5x0.8	9.50	10.00		4.50	Hardened Carbon Steel	3.0
	<i>0.236</i>	<i>0.472</i>		<i>0.374</i>	<i>0.394</i>		<i>0.177</i>		<i>0.118</i>
SHLD060-016-SKT-C	6.000	16.000	M5x0.8	9.50	10.00		4.50	Hardened Carbon Steel	3.0
	<i>0.236</i>	<i>0.630</i>		<i>0.374</i>	<i>0.394</i>		<i>0.177</i>		<i>0.118</i>
SHLD060-020-SKT-C	6.000	20.000	M5x0.8	9.50	10.00		4.50	Hardened Carbon Steel	3.0
	<i>0.236</i>	<i>0.787</i>		<i>0.374</i>	<i>0.394</i>		<i>0.177</i>		<i>0.118</i>
# SHLD060-025-SKT-C	6.000	25.000	M5x0.8	9.50	10.00		4.50	Hardened Carbon Steel	3.0
	<i>0.236</i>	<i>0.984</i>		<i>0.374</i>	<i>0.394</i>		<i>0.177</i>		<i>0.118</i>
# SHLD060-030-SKT-C	6.000	30.000	M5x0.8	9.50	10.00		4.50	Hardened Carbon Steel	3.0
	<i>0.236</i>	<i>1.181</i>		<i>0.374</i>	<i>0.394</i>		<i>0.177</i>		<i>0.118</i>

Indicates item not stocked at time of printing - Please enquire for lead time

Page 4 of 31

E&OE Pricing and all details subject to change without notice - Copyright Miniature Bearings Australia Pty Ltd

MBA Size Listings are a guide to sizes only and must not be solely relied on for critical design information.

Screws - Shoulder - Socket Head - Carbon Steel

Part Number	Shoulder Diameter (E) mm	Shoulder Length (L) mm	Thread Size (t)	Max. Thread Length (S) mm	Head Diameter (D) mm	Thread Type	Head Height (H) mm	Material	Allen Key Size (T) mm
	<i>inches</i>	<i>inches</i>		<i>inches</i>	<i>inches</i>		<i>inches</i>		<i>inches</i>
SHLD060-040-SKT-C	6.000	40.000	M5x0.8	9.50	10.00		4.50	Hardened Carbon Steel	3.0
	<i>0.236</i>	<i>1.575</i>		<i>0.374</i>	<i>0.394</i>		<i>0.177</i>		<i>0.118</i>
# SHLD060-050-SKT-C	6.000	50.000	M5x0.8	9.50	10.00		4.50	Hardened Carbon Steel	3.0
	<i>0.236</i>	<i>1.969</i>		<i>0.374</i>	<i>0.394</i>		<i>0.177</i>		<i>0.118</i>
# SHLD060-060-SKT-C	6.000	60.000	M5x0.8	9.50	10.00		4.50	Hardened Carbon Steel	3.0
	<i>0.236</i>	<i>2.362</i>		<i>0.374</i>	<i>0.394</i>		<i>0.177</i>		<i>0.118</i>
# SHLD060-070-SKT-C	6.000	70.000	M5x0.8	9.50	10.00		4.50	Hardened Carbon Steel	3.0
	<i>0.236</i>	<i>2.756</i>		<i>0.374</i>	<i>0.394</i>		<i>0.177</i>		<i>0.118</i>
# SHLD060-080-SKT-C	6.000	80.000	M5x0.8	9.50	10.00		4.50	Hardened Carbon Steel	3.0
	<i>0.236</i>	<i>3.150</i>		<i>0.374</i>	<i>0.394</i>		<i>0.177</i>		<i>0.118</i>
# SHLD060-100-SKT-C	6.000	100.000	M5x0.8	9.50	10.00		4.50	Hardened Carbon Steel	3.0
	<i>0.236</i>	<i>3.937</i>		<i>0.374</i>	<i>0.394</i>		<i>0.177</i>		<i>0.118</i>
# SHLD064-006-SKT-C	6.350	6.350	10-32 UNF	6.35	9.53		4.76	Hardened Carbon Steel	3.18
	<i>0.250</i>	<i>0.250</i>		<i>0.250</i>	<i>0.375</i>		<i>0.187</i>		<i>0.125</i>
# SHLD064-008-SKT-C	6.350	7.940	10-32 UNF	6.35	9.53		4.76	Hardened Carbon Steel	3.18
	<i>0.250</i>	<i>0.313</i>		<i>0.250</i>	<i>0.375</i>		<i>0.187</i>		<i>0.125</i>

Indicates item not stocked at time of printing - Please enquire for lead time

Page 5 of 31

E&OE Pricing and all details subject to change without notice - Copyright Miniature Bearings Australia Pty Ltd
MBA Size Listings are a guide to sizes only and must not be solely relied on for critical design information.

Screws - Shoulder - Socket Head - Carbon Steel

Part Number	Shoulder Diameter (E) mm	Shoulder Length (L) mm	Thread Size (t)	Max. Thread Length (S) mm	Head Diameter (D) mm	Thread Type	Head Height (H) mm	Material	Allen Key Size (T) mm
	<i>inches</i>	<i>inches</i>		<i>inches</i>	<i>inches</i>		<i>inches</i>		<i>inches</i>
# SHLD064-010-SKT-C	6.350	9.530	10-32 UNF	6.35	9.53		4.76	Hardened Carbon Steel	3.18
	<i>0.250</i>	<i>0.375</i>		<i>0.250</i>	<i>0.375</i>		<i>0.187</i>		<i>0.125</i>
# SHLD064-013-SKT-C	6.350	12.700	10-24 UNC	9.525	9.525		4.740	Hardened Alloy Steel	3.18
	<i>0.250</i>	<i>0.500</i>		<i>0.375</i>	<i>0.375</i>		<i>0.187</i>		<i>0.125</i>
# SHLD064-013-SKT-C-F	6.350	12.700	10-32 UNF	6.35	9.53		4.76	Hardened Carbon Steel	3.18
	<i>0.250</i>	<i>0.500</i>		<i>0.250</i>	<i>0.375</i>		<i>0.187</i>		<i>0.125</i>
# SHLD064-016-SKT-C	6.350	15.880	10-32 UNF	6.35	9.53		4.76	Hardened Carbon Steel	3.18
	<i>0.250</i>	<i>0.625</i>		<i>0.250</i>	<i>0.375</i>		<i>0.187</i>		<i>0.125</i>
# SHLD064-019-SKT-C	6.350	19.050	10-32 UNF	6.35	9.53		4.76	Hardened Carbon Steel	3.18
	<i>0.250</i>	<i>0.750</i>		<i>0.250</i>	<i>0.375</i>		<i>0.187</i>		<i>0.125</i>
SHLD064-025-SKT-C	6.350	25.400	10-32 UNF	6.35	9.53		4.76	Hardened Carbon Steel	3.18
	<i>0.250</i>	<i>1.000</i>		<i>0.250</i>	<i>0.375</i>		<i>0.187</i>		<i>0.125</i>
# SHLD064-032-SKT-C	6.350	31.750	10-32 UNF	6.35	9.53		4.76	Hardened Carbon Steel	3.18
	<i>0.250</i>	<i>1.250</i>		<i>0.250</i>	<i>0.375</i>		<i>0.187</i>		<i>0.125</i>
# SHLD064-038-SKT-C	6.350	38.100	10-32 UNF	6.35	9.53		4.76	Hardened Carbon Steel	3.18
	<i>0.250</i>	<i>1.500</i>		<i>0.250</i>	<i>0.375</i>		<i>0.187</i>		<i>0.125</i>

Indicates item not stocked at time of printing - Please enquire for lead time

Page 6 of 31

E&OE Pricing and all details subject to change without notice - Copyright Miniature Bearings Australia Pty Ltd

MBA Size Listings are a guide to sizes only and must not be solely relied on for critical design information.

Screws - Shoulder - Socket Head - Carbon Steel

Part Number	Shoulder Diameter (E) mm	Shoulder Length (L) mm	Thread Size (t)	Max. Thread Length (S) mm	Head Diameter (D) mm	Thread Type	Head Height (H) mm	Material	Allen Key Size (T) mm
	<i>inches</i>	<i>inches</i>		<i>inches</i>	<i>inches</i>		<i>inches</i>		<i>inches</i>
# SHLD064-044-SKT-C	6.350	44.450	10-32 UNF	6.35	9.53		4.76	Hardened Carbon Steel	3.18
	<i>0.250</i>	<i>1.750</i>		<i>0.250</i>	<i>0.375</i>		<i>0.187</i>		<i>0.125</i>
# SHLD064-051-SKT-C	6.350	50.800	10-32 UNF	6.35	9.53		4.76	Hardened Carbon Steel	3.18
	<i>0.250</i>	<i>2.000</i>		<i>0.250</i>	<i>0.375</i>		<i>0.187</i>		<i>0.125</i>
# SHLD064-057-SKT-C	6.350	57.150	10-32 UNF	6.35	9.53		4.76	Hardened Carbon Steel	3.18
	<i>0.250</i>	<i>2.250</i>		<i>0.250</i>	<i>0.375</i>		<i>0.187</i>		<i>0.125</i>
# SHLD064-064-SKT-C	6.350	63.500	10-32 UNF	6.35	9.53		4.76	Hardened Carbon Steel	3.18
	<i>0.250</i>	<i>2.500</i>		<i>0.250</i>	<i>0.375</i>		<i>0.187</i>		<i>0.125</i>
# SHLD064-070-SKT-C	6.350	69.850	10-32 UNF	6.35	9.53		4.76	Hardened Carbon Steel	3.18
	<i>0.250</i>	<i>2.750</i>		<i>0.250</i>	<i>0.375</i>		<i>0.187</i>		<i>0.125</i>
# SHLD064-076-SKT-C	6.350	76.200	10-32 UNF	6.35	9.53		4.76	Hardened Carbon Steel	3.18
	<i>0.250</i>	<i>3.000</i>		<i>0.250</i>	<i>0.375</i>		<i>0.187</i>		<i>0.125</i>
# SHLD064-089-SKT-C	6.350	88.900	10-32 UNF	6.35	9.53		4.76	Hardened Carbon Steel	3.18
	<i>0.250</i>	<i>3.500</i>		<i>0.250</i>	<i>0.375</i>		<i>0.187</i>		<i>0.125</i>
# SHLD064-102-SKT-C	6.350	101.600	10-32 UNF	6.35	9.53		4.76	Hardened Carbon Steel	3.18
	<i>0.250</i>	<i>4.000</i>		<i>0.250</i>	<i>0.375</i>		<i>0.187</i>		<i>0.125</i>

Indicates item not stocked at time of printing - Please enquire for lead time

Page 7 of 31

E&OE Pricing and all details subject to change without notice - Copyright Miniature Bearings Australia Pty Ltd
MBA Size Listings are a guide to sizes only and must not be solely relied on for critical design information.

Screws - Shoulder - Socket Head - Carbon Steel

Part Number	Shoulder Diameter (E) mm	Shoulder Length (L) mm	Thread Size (t)	Max. Thread Length (S) mm	Head Diameter (D) mm	Thread Type	Head Height (H) mm	Material	Allen Key Size (T) mm
	<i>inches</i>	<i>inches</i>		<i>inches</i>	<i>inches</i>		<i>inches</i>		<i>inches</i>
# SHLD079-006-SKT-C	7.938	6.350	1/4-20 UNC	11.11	12.70		5.56	Hardened Carbon Steel	3.97
	<i>0.313</i>	<i>0.250</i>		<i>0.437</i>	<i>0.500</i>		<i>0.219</i>		<i>0.156</i>
# SHLD079-008-SKT-C	7.938	7.940	1/4-20 UNC	11.11	12.70		5.56	Hardened Carbon Steel	3.97
	<i>0.313</i>	<i>0.313</i>		<i>0.437</i>	<i>0.500</i>		<i>0.219</i>		<i>0.156</i>
# SHLD079-010-SKT-C	7.938	9.530	1/4-20 UNC	11.11	12.70		5.56	Hardened Carbon Steel	3.97
	<i>0.313</i>	<i>0.375</i>		<i>0.437</i>	<i>0.500</i>		<i>0.219</i>		<i>0.156</i>
# SHLD079-013-SKT-C	7.938	12.700	1/4-20 UNC	11.11	12.70		5.56	Hardened Carbon Steel	3.97
	<i>0.313</i>	<i>0.500</i>		<i>0.437</i>	<i>0.500</i>		<i>0.219</i>		<i>0.156</i>
# SHLD079-016-SKT-C	7.938	15.880	1/4-20 UNC	11.11	12.70		5.56	Hardened Carbon Steel	3.97
	<i>0.313</i>	<i>0.625</i>		<i>0.437</i>	<i>0.500</i>		<i>0.219</i>		<i>0.156</i>
# SHLD079-019-SKT-C	7.938	19.050	1/4-20 UNC	11.11	12.70		5.56	Hardened Carbon Steel	3.97
	<i>0.313</i>	<i>0.750</i>		<i>0.437</i>	<i>0.500</i>		<i>0.219</i>		<i>0.156</i>
# SHLD079-025-SKT-C	7.938	25.400	1/4-20 UNC	11.11	12.70		5.56	Hardened Carbon Steel	3.97
	<i>0.313</i>	<i>1.000</i>		<i>0.437</i>	<i>0.500</i>		<i>0.219</i>		<i>0.156</i>
# SHLD079-032-SKT-C	7.938	31.750	1/4-20 UNC	11.11	12.70		5.56	Hardened Carbon Steel	3.97
	<i>0.313</i>	<i>1.250</i>		<i>0.437</i>	<i>0.500</i>		<i>0.219</i>		<i>0.156</i>

Indicates item not stocked at time of printing - Please enquire for lead time

Page 8 of 31

E&OE Pricing and all details subject to change without notice - Copyright Miniature Bearings Australia Pty Ltd
MBA Size Listings are a guide to sizes only and must not be solely relied on for critical design information.

Screws - Shoulder - Socket Head - Carbon Steel

Part Number	Shoulder Diameter (E) mm	Shoulder Length (L) mm	Thread Size (t)	Max. Thread Length (S) mm	Head Diameter (D) mm	Thread Type	Head Height (H) mm	Material	Allen Key Size (T) mm
	<i>inches</i>	<i>inches</i>		<i>inches</i>	<i>inches</i>		<i>inches</i>		<i>inches</i>
# SHLD079-038-SKT-C	7.938	38.100	1/4-20 UNC	11.11	12.70		5.56	Hardened Carbon Steel	3.97
	<i>0.313</i>	<i>1.500</i>		<i>0.437</i>	<i>0.500</i>		<i>0.219</i>		<i>0.156</i>
# SHLD079-044-SKT-C	7.938	44.450	1/4-20 UNC	11.11	12.70		5.56	Hardened Carbon Steel	3.97
	<i>0.313</i>	<i>1.750</i>		<i>0.437</i>	<i>0.500</i>		<i>0.219</i>		<i>0.156</i>
# SHLD079-051-SKT-C	7.938	50.800	1/4-20 UNC	11.11	12.70		5.56	Hardened Carbon Steel	3.97
	<i>0.313</i>	<i>2.000</i>		<i>0.437</i>	<i>0.500</i>		<i>0.219</i>		<i>0.156</i>
# SHLD079-057-SKT-C	7.938	57.150	1/4-20 UNC	11.11	12.70		5.56	Hardened Carbon Steel	3.97
	<i>0.313</i>	<i>2.250</i>		<i>0.437</i>	<i>0.500</i>		<i>0.219</i>		<i>0.156</i>
# SHLD079-064-SKT-C	7.938	63.500	1/4-20 UNC	11.11	12.70		5.56	Hardened Carbon Steel	3.97
	<i>0.313</i>	<i>2.500</i>		<i>0.437</i>	<i>0.500</i>		<i>0.219</i>		<i>0.156</i>
# SHLD079-070-SKT-C	7.938	69.850	1/4-20 UNC	11.11	12.70		5.56	Hardened Carbon Steel	3.97
	<i>0.313</i>	<i>2.750</i>		<i>0.437</i>	<i>0.500</i>		<i>0.219</i>		<i>0.156</i>
# SHLD079-076-SKT-C	7.938	76.200	1/4-20 UNC	11.11	12.70		5.56	Hardened Carbon Steel	3.97
	<i>0.313</i>	<i>3.000</i>		<i>0.437</i>	<i>0.500</i>		<i>0.219</i>		<i>0.156</i>
# SHLD079-083-SKT-C	7.938	82.550	1/4-20 UNC	11.11	12.70		5.56	Hardened Carbon Steel	3.97
	<i>0.313</i>	<i>3.250</i>		<i>0.437</i>	<i>0.500</i>		<i>0.219</i>		<i>0.156</i>

Indicates item not stocked at time of printing - Please enquire for lead time

Page 9 of 31

E&OE Pricing and all details subject to change without notice - Copyright Miniature Bearings Australia Pty Ltd

MBA Size Listings are a guide to sizes only and must not be solely relied on for critical design information.

Screws - Shoulder - Socket Head - Carbon Steel

Part Number	Shoulder Diameter (E) mm	Shoulder Length (L) mm	Thread Size (t)	Max. Thread Length (S) mm	Head Diameter (D) mm	Thread Type	Head Height (H) mm	Material	Allen Key Size (T) mm
	<i>inches</i>	<i>inches</i>		<i>inches</i>	<i>inches</i>		<i>inches</i>		<i>inches</i>
# SHLD079-089-SKT-C	7.938	88.900	1/4-20 UNC	11.11	12.70		5.56	Hardened Carbon Steel	3.97
	<i>0.313</i>	<i>3.500</i>		<i>0.437</i>	<i>0.500</i>		<i>0.219</i>		<i>0.156</i>
# SHLD079-102-SKT-C	7.938	101.600	1/4-20 UNC	11.11	12.70		5.56	Hardened Carbon Steel	3.97
	<i>0.313</i>	<i>4.000</i>		<i>0.437</i>	<i>0.500</i>		<i>0.219</i>		<i>0.156</i>
# SHLD080-008-SKT-C	8.000	8.000	M6x1.0	8.00	14.00		4.00	Hardened Carbon Steel	4.0
	<i>0.315</i>	<i>0.315</i>		<i>0.315</i>	<i>0.551</i>		<i>0.157</i>		<i>0.157</i>
# SHLD080-010-SKT-C	8.000	10.000	M6x1.0	8.00	14.00		4.00	Hardened Carbon Steel	4.0
	<i>0.315</i>	<i>0.394</i>		<i>0.315</i>	<i>0.551</i>		<i>0.157</i>		<i>0.157</i>
SHLD080-012-SKT-C	8.000	12.000	M6x1.0	11.00	13.00		5.50	Hardened Carbon Steel	4.0
	<i>0.315</i>	<i>0.472</i>		<i>0.433</i>	<i>0.512</i>		<i>0.217</i>		<i>0.157</i>
SHLD080-016-SKT-C	8.000	16.000	M6x1.0	11.00	13.00		5.50	Hardened Carbon Steel	4.0
	<i>0.315</i>	<i>0.630</i>		<i>0.433</i>	<i>0.512</i>		<i>0.217</i>		<i>0.157</i>
SHLD080-020-SKT-C	8.000	20.000	M6x1.0	11.00	13.00		5.50	Hardened Carbon Steel	4.0
	<i>0.315</i>	<i>0.787</i>		<i>0.433</i>	<i>0.512</i>		<i>0.217</i>		<i>0.157</i>
SHLD080-025-SKT-C	8.000	25.000	M6x1.0	11.00	13.00		5.50	Hardened Carbon Steel	4.0
	<i>0.315</i>	<i>0.984</i>		<i>0.433</i>	<i>0.512</i>		<i>0.217</i>		<i>0.157</i>

Indicates item not stocked at time of printing - Please enquire for lead time

Page 10 of 31

E&OE Pricing and all details subject to change without notice - Copyright Miniature Bearings Australia Pty Ltd

MBA Size Listings are a guide to sizes only and must not be solely relied on for critical design information.

Screws - Shoulder - Socket Head - Carbon Steel

Part Number	Shoulder Diameter (E) mm	Shoulder Length (L) mm	Thread Size (t)	Max. Thread Length (S) mm	Head Diameter (D) mm	Thread Type	Head Height (H) mm	Material	Allen Key Size (T) mm
	<i>inches</i>	<i>inches</i>		<i>inches</i>	<i>inches</i>		<i>inches</i>		<i>inches</i>
SHLD080-030-SKT-C	8.000	30.000	M6x1.0	11.00	13.00		5.50	Hardened Carbon Steel	4.0
	<i>0.315</i>	<i>1.181</i>		<i>0.433</i>	<i>0.512</i>		<i>0.217</i>		<i>0.157</i>
SHLD080-035-SKT-C	8.000	35.000	M6x1.0	11.00	13.00		5.50	Hardened Carbon Steel	4.0
	<i>0.315</i>	<i>1.378</i>		<i>0.433</i>	<i>0.512</i>		<i>0.217</i>		<i>0.157</i>
SHLD080-040-SKT-C	8.000	40.000	M6x1.0	11.00	13.00		5.50	Hardened Carbon Steel	4.0
	<i>0.315</i>	<i>1.575</i>		<i>0.433</i>	<i>0.512</i>		<i>0.217</i>		<i>0.157</i>
SHLD080-050-SKT-C	8.000	50.000	M6x1.0	11.00	13.00		5.50	Hardened Carbon Steel	4.0
	<i>0.315</i>	<i>1.969</i>		<i>0.433</i>	<i>0.512</i>		<i>0.217</i>		<i>0.157</i>
# SHLD080-060-SKT-C	8.000	60.000	M6x1.0	11.00	13.00		5.50	Hardened Carbon Steel	4.0
	<i>0.315</i>	<i>2.362</i>		<i>0.433</i>	<i>0.512</i>		<i>0.217</i>		<i>0.157</i>
# SHLD080-070-SKT-C	8.000	70.000	M6x1.0	11.00	13.00		5.50	Hardened Carbon Steel	4.0
	<i>0.315</i>	<i>2.756</i>		<i>0.433</i>	<i>0.512</i>		<i>0.217</i>		<i>0.157</i>
# SHLD080-080-SKT-C	8.000	80.000	M6x1.0	11.00	13.00		5.50	Hardened Carbon Steel	4.0
	<i>0.315</i>	<i>3.150</i>		<i>0.433</i>	<i>0.512</i>		<i>0.217</i>		<i>0.157</i>
# SHLD080-090-SKT-C	8.000	90.000	M6x1.0	11.00	13.00		5.50	Hardened Carbon Steel	4.0
	<i>0.315</i>	<i>3.543</i>		<i>0.433</i>	<i>0.512</i>		<i>0.217</i>		<i>0.157</i>

Indicates item not stocked at time of printing - Please enquire for lead time

Page 11 of 31

E&OE Pricing and all details subject to change without notice - Copyright Miniature Bearings Australia Pty Ltd
MBA Size Listings are a guide to sizes only and must not be solely relied on for critical design information.

Screws - Shoulder - Socket Head - Carbon Steel

Part Number	Shoulder Diameter (E) mm	Shoulder Length (L) mm	Thread Size (t)	Max. Thread Length (S) mm	Head Diameter (D) mm	Thread Type	Head Height (H) mm	Material	Allen Key Size (T) mm
	<i>inches</i>	<i>inches</i>		<i>inches</i>	<i>inches</i>		<i>inches</i>		<i>inches</i>
# SHLD080-100-SKT-C	8.000	100.000	M6x1.0	11.00	13.00		5.50	Hardened Carbon Steel	4.0
	<i>0.315</i>	<i>3.937</i>		<i>0.433</i>	<i>0.512</i>		<i>0.217</i>		<i>0.157</i>
# SHLD095-008-SKT-C	9.525	7.940	5/16 UNC	11.11	12.70		5.56	Hardened Carbon Steel	4.76
	<i>0.375</i>	<i>0.313</i>		<i>0.437</i>	<i>0.500</i>		<i>0.219</i>		<i>0.187</i>
# SHLD095-010-SKT-C	9.525	9.530	5/16 UNC	11.11	12.70		5.56	Hardened Carbon Steel	4.76
	<i>0.375</i>	<i>0.375</i>		<i>0.437</i>	<i>0.500</i>		<i>0.219</i>		<i>0.187</i>
# SHLD095-013-SKT-C	9.525	12.700	5/16 UNC	11.11	12.70		5.56	Hardened Carbon Steel	4.76
	<i>0.375</i>	<i>0.500</i>		<i>0.437</i>	<i>0.500</i>		<i>0.219</i>		<i>0.187</i>
# SHLD095-016-SKT-C	9.525	15.880	5/16 UNC	11.11	12.70		5.56	Hardened Carbon Steel	4.76
	<i>0.375</i>	<i>0.625</i>		<i>0.437</i>	<i>0.500</i>		<i>0.219</i>		<i>0.187</i>
# SHLD095-019-SKT-C	9.525	19.050	5/16 UNC	11.11	12.70		5.56	Hardened Carbon Steel	4.76
	<i>0.375</i>	<i>0.750</i>		<i>0.437</i>	<i>0.500</i>		<i>0.219</i>		<i>0.187</i>
# SHLD095-025-SKT-C	9.525	25.400	5/16 UNC	11.11	12.70		5.56	Hardened Carbon Steel	4.76
	<i>0.375</i>	<i>1.000</i>		<i>0.437</i>	<i>0.500</i>		<i>0.219</i>		<i>0.187</i>
# SHLD095-032-SKT-C	9.525	31.750	5/16 UNC	11.11	12.70		5.56	Hardened Carbon Steel	4.76
	<i>0.375</i>	<i>1.250</i>		<i>0.437</i>	<i>0.500</i>		<i>0.219</i>		<i>0.187</i>

Indicates item not stocked at time of printing - Please enquire for lead time

Page 12 of 31

E&OE Pricing and all details subject to change without notice - Copyright Miniature Bearings Australia Pty Ltd
MBA Size Listings are a guide to sizes only and must not be solely relied on for critical design information.

Screws - Shoulder - Socket Head - Carbon Steel

Part Number	Shoulder Diameter (E) mm	Shoulder Length (L) mm	Thread Size (t)	Max. Thread Length (S) mm	Head Diameter (D) mm	Thread Type	Head Height (H) mm	Material	Allen Key Size (T) mm
	<i>inches</i>	<i>inches</i>		<i>inches</i>	<i>inches</i>		<i>inches</i>		<i>inches</i>
# SHLD095-038-SKT-C	9.525	38.100	5/16 UNC	11.11	12.70		5.56	Hardened Carbon Steel	4.76
	<i>0.375</i>	<i>1.500</i>		<i>0.437</i>	<i>0.500</i>		<i>0.219</i>		<i>0.187</i>
# SHLD095-044-SKT-C	9.525	44.450	5/16 UNC	11.11	12.70		5.56	Hardened Carbon Steel	4.76
	<i>0.375</i>	<i>1.750</i>		<i>0.437</i>	<i>0.500</i>		<i>0.219</i>		<i>0.187</i>
# SHLD095-051-SKT-C	9.525	50.800	5/16 UNC	11.11	12.70		5.56	Hardened Carbon Steel	4.76
	<i>0.375</i>	<i>2.000</i>		<i>0.437</i>	<i>0.500</i>		<i>0.219</i>		<i>0.187</i>
# SHLD095-057-SKT-C	9.525	57.150	5/16 UNC	11.11	12.70		5.56	Hardened Carbon Steel	4.76
	<i>0.375</i>	<i>2.250</i>		<i>0.437</i>	<i>0.500</i>		<i>0.219</i>		<i>0.187</i>
# SHLD095-064-SKT-C	9.525	63.500	5/16 UNC	11.11	12.70		5.56	Hardened Carbon Steel	4.76
	<i>0.375</i>	<i>2.500</i>		<i>0.437</i>	<i>0.500</i>		<i>0.219</i>		<i>0.187</i>
# SHLD095-070-SKT-C	9.525	69.850	5/16 UNC	11.11	12.70		5.56	Hardened Carbon Steel	4.76
	<i>0.375</i>	<i>2.750</i>		<i>0.437</i>	<i>0.500</i>		<i>0.219</i>		<i>0.187</i>
# SHLD095-076-SKT-C	9.525	76.200	5/16 UNC	11.11	12.70		5.56	Hardened Carbon Steel	4.76
	<i>0.375</i>	<i>3.000</i>		<i>0.437</i>	<i>0.500</i>		<i>0.219</i>		<i>0.187</i>
# SHLD095-083-SKT-C	9.525	82.550	5/16 UNC	11.11	12.70		5.56	Hardened Carbon Steel	4.76
	<i>0.375</i>	<i>3.250</i>		<i>0.437</i>	<i>0.500</i>		<i>0.219</i>		<i>0.187</i>

Indicates item not stocked at time of printing - Please enquire for lead time

Page 13 of 31

E&OE Pricing and all details subject to change without notice - Copyright Miniature Bearings Australia Pty Ltd

MBA Size Listings are a guide to sizes only and must not be solely relied on for critical design information.

Screws - Shoulder - Socket Head - Carbon Steel

Part Number	Shoulder Diameter (E) mm	Shoulder Length (L) mm	Thread Size (t)	Max. Thread Length (S) mm	Head Diameter (D) mm	Thread Type	Head Height (H) mm	Material	Allen Key Size (T) mm
	<i>inches</i>	<i>inches</i>		<i>inches</i>	<i>inches</i>		<i>inches</i>		<i>inches</i>
# SHLD095-089-SKT-C	9.525	88.900	5/16 UNC	11.11	12.70		5.56	Hardened Carbon Steel	4.76
	<i>0.375</i>	<i>3.500</i>		<i>0.437</i>	<i>0.500</i>		<i>0.219</i>		<i>0.187</i>
# SHLD095-102-SKT-C	9.525	101.600	5/16 UNC	11.11	12.70		5.56	Hardened Carbon Steel	4.76
	<i>0.375</i>	<i>4.000</i>		<i>0.437</i>	<i>0.500</i>		<i>0.219</i>		<i>0.187</i>
# SHLD095-114-SKT-C	9.525	114.300	5/16 UNC	11.11	12.70		5.56	Hardened Carbon Steel	4.76
	<i>0.375</i>	<i>4.500</i>		<i>0.437</i>	<i>0.500</i>		<i>0.219</i>		<i>0.187</i>
# SHLD095-127-SKT-C	9.525	127.000	5/16 UNC	11.11	12.70		5.56	Hardened Carbon Steel	4.76
	<i>0.375</i>	<i>5.000</i>		<i>0.437</i>	<i>0.500</i>		<i>0.219</i>		<i>0.187</i>
# SHLD100-010-SKT-C	10.000	10.000	M8x1.25	10.00	16.00		5.00	Hardened Carbon Steel	5.0
	<i>0.394</i>	<i>0.394</i>		<i>0.394</i>	<i>0.630</i>		<i>0.197</i>		<i>0.197</i>
# SHLD100-012-SKT-C	10.000	12.000	M8x1.25	10.00	16.00		5.00	Hardened Carbon Steel	5.0
	<i>0.394</i>	<i>0.472</i>		<i>0.394</i>	<i>0.630</i>		<i>0.197</i>		<i>0.197</i>
# SHLD100-016-SKT-C	10.000	16.000	M8x1.25	13.00	16.00		7.00	Hardened Carbon Steel	5.0
	<i>0.394</i>	<i>0.630</i>		<i>0.512</i>	<i>0.630</i>		<i>0.276</i>		<i>0.197</i>
SHLD100-020-SKT-C	10.000	20.000	M8x1.25	13.00	16.00		7.00	Hardened Carbon Steel	5.0
	<i>0.394</i>	<i>0.787</i>		<i>0.512</i>	<i>0.630</i>		<i>0.276</i>		<i>0.197</i>

Indicates item not stocked at time of printing - Please enquire for lead time

Page 14 of 31

E&OE Pricing and all details subject to change without notice - Copyright Miniature Bearings Australia Pty Ltd
MBA Size Listings are a guide to sizes only and must not be solely relied on for critical design information.

Screws - Shoulder - Socket Head - Carbon Steel

Part Number	Shoulder Diameter (E) mm	Shoulder Length (L) mm	Thread Size (t)	Max. Thread Length (S) mm	Head Diameter (D) mm	Thread Type	Head Height (H) mm	Material	Allen Key Size (T) mm
	<i>inches</i>	<i>inches</i>		<i>inches</i>	<i>inches</i>		<i>inches</i>		<i>inches</i>
SHLD100-025-SKT-C	10.000	25.000	M8x1.25	13.00	16.00		7.00	Hardened Carbon Steel	5.0
	<i>0.394</i>	<i>0.984</i>		<i>0.512</i>	<i>0.630</i>		<i>0.276</i>		<i>0.197</i>
# SHLD100-030-SKT-C	10.000	30.000	M8x1.25	13.00	16.00		7.00	Hardened Carbon Steel	5.0
	<i>0.394</i>	<i>1.181</i>		<i>0.512</i>	<i>0.630</i>		<i>0.276</i>		<i>0.197</i>
# SHLD100-040-SKT-C	10.000	40.000	M8x1.25	13.00	16.00		7.00	Hardened Carbon Steel	5.0
	<i>0.394</i>	<i>1.575</i>		<i>0.512</i>	<i>0.630</i>		<i>0.276</i>		<i>0.197</i>
# SHLD100-050-SKT-C	10.000	50.000	M8x1.25	13.00	16.00		7.00	Hardened Carbon Steel	5.0
	<i>0.394</i>	<i>1.969</i>		<i>0.512</i>	<i>0.630</i>		<i>0.276</i>		<i>0.197</i>
# SHLD100-060-SKT-C	10.000	60.000	M8x1.25	13.00	16.00		7.00	Hardened Carbon Steel	5.0
	<i>0.394</i>	<i>2.362</i>		<i>0.512</i>	<i>0.630</i>		<i>0.276</i>		<i>0.197</i>
# SHLD100-070-SKT-C	10.000	70.000	M8x1.25	13.00	16.00		7.00	Hardened Carbon Steel	5.0
	<i>0.394</i>	<i>2.756</i>		<i>0.512</i>	<i>0.630</i>		<i>0.276</i>		<i>0.197</i>
# SHLD100-080-SKT-C	10.000	80.000	M8x1.25	13.00	16.00		7.00	Hardened Carbon Steel	5.0
	<i>0.394</i>	<i>3.150</i>		<i>0.512</i>	<i>0.630</i>		<i>0.276</i>		<i>0.197</i>
# SHLD100-090-SKT-C	10.000	90.000	M8x1.25	13.00	16.00		7.00	Hardened Carbon Steel	5.0
	<i>0.394</i>	<i>3.543</i>		<i>0.512</i>	<i>0.630</i>		<i>0.276</i>		<i>0.197</i>

Indicates item not stocked at time of printing - Please enquire for lead time

Page 15 of 31

E&OE Pricing and all details subject to change without notice - Copyright Miniature Bearings Australia Pty Ltd
MBA Size Listings are a guide to sizes only and must not be solely relied on for critical design information.

Screws - Shoulder - Socket Head - Carbon Steel

Part Number	Shoulder Diameter (E) mm	Shoulder Length (L) mm	Thread Size (t)	Max. Thread Length (S) mm	Head Diameter (D) mm	Thread Type	Head Height (H) mm	Material	Allen Key Size (T) mm
	<i>inches</i>	<i>inches</i>		<i>inches</i>	<i>inches</i>		<i>inches</i>		<i>inches</i>
SHLD100-100-SKT-C	10.000	100.000	M8x1.25	13.00	16.00		7.00	Hardened Carbon Steel - Black Oxide	5.0
	<i>0.394</i>	<i>3.937</i>		<i>0.512</i>	<i>0.630</i>		<i>0.276</i>		<i>0.197</i>
# SHLD100-110-SKT-C	10.000	110.000	M8x1.25	13.00	16.00		7.00	Hardened Carbon Steel	5.0
	<i>0.394</i>	<i>4.331</i>		<i>0.512</i>	<i>0.630</i>		<i>0.276</i>		<i>0.197</i>
SHLD100-120-SKT-C	10.000	120.000	M8x1.25	13.00	16.00		7.00	Hardened Carbon Steel	5.0
	<i>0.394</i>	<i>4.724</i>		<i>0.512</i>	<i>0.630</i>		<i>0.276</i>		<i>0.197</i>
SHLD120-012-SKT-C	12.000	12.000	M10x1.5	12.00	20.00		6.00	Hardened Carbon Steel	6.0
	<i>0.472</i>	<i>0.472</i>		<i>0.472</i>	<i>0.787</i>		<i>0.236</i>		<i>0.236</i>
# SHLD120-016-SKT-C	12.000	16.000	M10x1.5	12.00	20.00		6.00	Hardened Carbon Steel	6.0
	<i>0.472</i>	<i>0.630</i>		<i>0.472</i>	<i>0.787</i>		<i>0.236</i>		<i>0.236</i>
SHLD120-020-SKT-C	12.000	20.000	M10x1.5	16.00	18.00		8.00	Hardened Carbon Steel	6.0
	<i>0.472</i>	<i>0.787</i>		<i>0.630</i>	<i>0.709</i>		<i>0.315</i>		<i>0.236</i>
# SHLD120-025-SKT-C	12.000	25.000	M10x1.5	16.00	18.00		8.00	Hardened Carbon Steel	6.0
	<i>0.472</i>	<i>0.984</i>		<i>0.630</i>	<i>0.709</i>		<i>0.315</i>		<i>0.236</i>
# SHLD120-030-SKT-C	12.000	30.000	M10x1.5	16.00	18.00		8.00	Hardened Carbon Steel	6.0
	<i>0.472</i>	<i>1.181</i>		<i>0.630</i>	<i>0.709</i>		<i>0.315</i>		<i>0.236</i>

Indicates item not stocked at time of printing - Please enquire for lead time

Page 16 of 31

E&OE Pricing and all details subject to change without notice - Copyright Miniature Bearings Australia Pty Ltd
MBA Size Listings are a guide to sizes only and must not be solely relied on for critical design information.

Screws - Shoulder - Socket Head - Carbon Steel

Part Number	Shoulder Diameter (E) mm	Shoulder Length (L) mm	Thread Size (t)	Max. Thread Length (S) mm	Head Diameter (D) mm	Thread Type	Head Height (H) mm	Material	Allen Key Size (T) mm
	<i>inches</i>	<i>inches</i>		<i>inches</i>	<i>inches</i>		<i>inches</i>		<i>inches</i>
# SHLD120-040-SKT-C	12.000	40.000	M10x1.5	16.00	18.00		8.00	Hardened Carbon Steel	6.0
	0.472	1.575		0.630	0.709		0.315		0.236
# SHLD120-050-SKT-C	12.000	50.000	M10x1.5	16.00	18.00		8.00	Hardened Carbon Steel	6.0
	0.472	1.969		0.630	0.709		0.315		0.236
SHLD120-060-SKT-C	12.000	60.000	M10x1.5	16.00	18.00		8.00	Hardened Carbon Steel	6.0
	0.472	2.362		0.630	0.709		0.315		0.236
# SHLD120-070-SKT-C	12.000	70.000	M10x1.5	16.00	18.00		8.00	Hardened Carbon Steel	6.0
	0.472	2.756		0.630	0.709		0.315		0.236
# SHLD120-080-SKT-C	12.000	80.000	M10x1.5	16.00	18.00		8.00	Hardened Carbon Steel	6.0
	0.472	3.150		0.630	0.709		0.315		0.236
# SHLD120-090-SKT-C	12.000	90.000	M10x1.5	16.00	18.00		8.00	Hardened Carbon Steel	6.0
	0.472	3.543		0.630	0.709		0.315		0.236
# SHLD120-100-SKT-C	12.000	100.000	M10x1.5	16.00	18.00		8.00	Hardened Carbon Steel	6.0
	0.472	3.937		0.630	0.709		0.315		0.236
# SHLD120-110-SKT-C	12.000	110.000	M10x1.5	16.00	18.00		8.00	Hardened Carbon Steel	6.0
	0.472	4.331		0.630	0.709		0.315		0.236

Indicates item not stocked at time of printing - Please enquire for lead time

Page 17 of 31

E&OE Pricing and all details subject to change without notice - Copyright Miniature Bearings Australia Pty Ltd
MBA Size Listings are a guide to sizes only and must not be solely relied on for critical design information.

Screws - Shoulder - Socket Head - Carbon Steel

Part Number	Shoulder Diameter (E) mm	Shoulder Length (L) mm	Thread Size (t)	Max. Thread Length (S) mm	Head Diameter (D) mm	Thread Type	Head Height (H) mm	Material	Allen Key Size (T) mm
	<i>inches</i>	<i>inches</i>		<i>inches</i>	<i>inches</i>		<i>inches</i>		<i>inches</i>
# SHLD120-120-SKT-C	12.000	120.000	M10x1.5	16.00	18.00		8.00	Hardened Carbon Steel	6.0
	<i>0.472</i>	<i>4.724</i>		<i>0.630</i>	<i>0.709</i>		<i>0.315</i>		<i>0.236</i>
# SHLD120-130-SKT-C	12.000	130.000	M10x1.5	16.00	18.00		8.00	Hardened Carbon Steel	6.0
	<i>0.472</i>	<i>5.118</i>		<i>0.630</i>	<i>0.709</i>		<i>0.315</i>		<i>0.236</i>
# SHLD120-140-SKT-C	12.000	140.000	M10x1.5	16.00	18.00		8.00	Hardened Carbon Steel	6.0
	<i>0.472</i>	<i>5.512</i>		<i>0.630</i>	<i>0.709</i>		<i>0.315</i>		<i>0.236</i>
# SHLD120-150-SKT-C	12.000	150.000	M10x1.5	16.00	18.00		8.00	Hardened Carbon Steel	6.0
	<i>0.472</i>	<i>5.906</i>		<i>0.630</i>	<i>0.709</i>		<i>0.315</i>		<i>0.236</i>
# SHLD127-006-SKT-C	12.700	6.350	3/8-16 UNC	15.875	19.050		7.938	Hardened Alloy Steel	6.35
	<i>0.500</i>	<i>0.250</i>		<i>0.625</i>	<i>0.750</i>		<i>0.313</i>		<i>0.250</i>
# SHLD127-010-SKT-C	12.700	9.530	3/8-16 UNC	15.88	19.05		7.94	Hardened Carbon Steel	6.35
	<i>0.500</i>	<i>0.375</i>		<i>0.625</i>	<i>0.750</i>		<i>0.313</i>		<i>0.250</i>
# SHLD127-013-SKT-C	12.700	12.700	3/8-16 UNC	15.88	19.05		7.94	Hardened Carbon Steel	6.35
	<i>0.500</i>	<i>0.500</i>		<i>0.625</i>	<i>0.750</i>		<i>0.313</i>		<i>0.250</i>
# SHLD127-016-SKT-C	12.700	15.880	3/8-16 UNC	15.88	19.05		7.94	Hardened Carbon Steel	6.35
	<i>0.500</i>	<i>0.625</i>		<i>0.625</i>	<i>0.750</i>		<i>0.313</i>		<i>0.250</i>

Indicates item not stocked at time of printing - Please enquire for lead time

Page 18 of 31

E&OE Pricing and all details subject to change without notice - Copyright Miniature Bearings Australia Pty Ltd
MBA Size Listings are a guide to sizes only and must not be solely relied on for critical design information.

Screws - Shoulder - Socket Head - Carbon Steel

Part Number	Shoulder Diameter (E) mm	Shoulder Length (L) mm	Thread Size (t)	Max. Thread Length (S) mm	Head Diameter (D) mm	Thread Type	Head Height (H) mm	Material	Allen Key Size (T) mm
	<i>inches</i>	<i>inches</i>		<i>inches</i>	<i>inches</i>		<i>inches</i>		<i>inches</i>
# SHLD127-019-SKT-C	12.700	19.050	3/8-16 UNC	15.88	19.05		7.94	Hardened Carbon Steel	6.35
	<i>0.500</i>	<i>0.750</i>		<i>0.625</i>	<i>0.750</i>		<i>0.313</i>		<i>0.250</i>
# SHLD127-022-SKT-C	12.700	22.230	3/8-16 UNC	15.88	19.05		7.94	Hardened Carbon Steel	6.35
	<i>0.500</i>	<i>0.875</i>		<i>0.625</i>	<i>0.750</i>		<i>0.313</i>		<i>0.250</i>
SHLD127-025-SKT-C	12.700	25.400	3/8-16 UNC	15.88	19.05		7.94	Hardened Carbon Steel	6.35
	<i>0.500</i>	<i>1.000</i>		<i>0.625</i>	<i>0.750</i>		<i>0.313</i>		<i>0.250</i>
# SHLD127-032-SKT-C	12.700	31.750	3/8-16 UNC	15.88	19.05		7.94	Hardened Carbon Steel	6.35
	<i>0.500</i>	<i>1.250</i>		<i>0.625</i>	<i>0.750</i>		<i>0.313</i>		<i>0.250</i>
# SHLD127-038-SKT-C	12.700	38.100	3/8-16 UNC	15.88	19.05		7.94	Hardened Carbon Steel	6.35
	<i>0.500</i>	<i>1.500</i>		<i>0.625</i>	<i>0.750</i>		<i>0.313</i>		<i>0.250</i>
# SHLD127-044-SKT-C	12.700	44.450	3/8-16 UNC	15.88	19.05		7.94	Hardened Carbon Steel	6.35
	<i>0.500</i>	<i>1.750</i>		<i>0.625</i>	<i>0.750</i>		<i>0.313</i>		<i>0.250</i>
# SHLD127-051-SKT-C	12.700	50.800	3/8-16 UNC	15.88	19.05		7.94	Hardened Carbon Steel	6.35
	<i>0.500</i>	<i>2.000</i>		<i>0.625</i>	<i>0.750</i>		<i>0.313</i>		<i>0.250</i>
# SHLD127-057-SKT-C	12.700	57.150	3/8-16 UNC	15.88	19.05		7.94	Hardened Carbon Steel	6.35
	<i>0.500</i>	<i>2.250</i>		<i>0.625</i>	<i>0.750</i>		<i>0.313</i>		<i>0.250</i>

Indicates item not stocked at time of printing - Please enquire for lead time

Page 19 of 31

E&OE Pricing and all details subject to change without notice - Copyright Miniature Bearings Australia Pty Ltd
MBA Size Listings are a guide to sizes only and must not be solely relied on for critical design information.

Screws - Shoulder - Socket Head - Carbon Steel

Part Number	Shoulder Diameter (E) mm	Shoulder Length (L) mm	Thread Size (t)	Max. Thread Length (S) mm	Head Diameter (D) mm	Thread Type	Head Height (H) mm	Material	Allen Key Size (T) mm
	<i>inches</i>	<i>inches</i>		<i>inches</i>	<i>inches</i>		<i>inches</i>		<i>inches</i>
# SHLD127-064-SKT-C	12.700	63.500	3/8-16 UNC	15.88	19.05		7.94	Hardened Carbon Steel	6.35
	<i>0.500</i>	<i>2.500</i>		<i>0.625</i>	<i>0.750</i>		<i>0.313</i>		<i>0.250</i>
# SHLD127-070-SKT-C	12.700	69.850	3/8-16 UNC	15.88	19.05		7.94	Hardened Carbon Steel	6.35
	<i>0.500</i>	<i>2.750</i>		<i>0.625</i>	<i>0.750</i>		<i>0.313</i>		<i>0.250</i>
# SHLD127-076-SKT-C	12.700	76.200	3/8-16 UNC	15.88	19.05		7.94	Hardened Carbon Steel	6.35
	<i>0.500</i>	<i>3.000</i>		<i>0.625</i>	<i>0.750</i>		<i>0.313</i>		<i>0.250</i>
# SHLD127-083-SKT-C	12.700	82.550	3/8-16 UNC	15.88	19.05		7.94	Hardened Carbon Steel	6.35
	<i>0.500</i>	<i>3.250</i>		<i>0.625</i>	<i>0.750</i>		<i>0.313</i>		<i>0.250</i>
# SHLD127-089-SKT-C	12.700	88.900	3/8-16 UNC	15.88	19.05		7.94	Hardened Carbon Steel	6.35
	<i>0.500</i>	<i>3.500</i>		<i>0.625</i>	<i>0.750</i>		<i>0.313</i>		<i>0.250</i>
# SHLD127-095-SKT-C	12.700	95.250	3/8-16 UNC	15.875	19.050		7.938	Hardened Alloy Steel	6.35
	<i>0.500</i>	<i>3.750</i>		<i>0.625</i>	<i>0.750</i>		<i>0.313</i>		<i>0.250</i>
# SHLD127-102-SKT-C	12.700	101.600	3/8-16 UNC	15.88	19.05		7.94	Hardened Carbon Steel	6.35
	<i>0.500</i>	<i>4.000</i>		<i>0.625</i>	<i>0.750</i>		<i>0.313</i>		<i>0.250</i>
# SHLD127-108-SKT-C	12.700	107.950	3/8-16 UNC	15.875	19.050		7.938	Hardened Alloy Steel	6.35
	<i>0.500</i>	<i>4.250</i>		<i>0.625</i>	<i>0.750</i>		<i>0.313</i>		<i>0.250</i>

Indicates item not stocked at time of printing - Please enquire for lead time

Page 20 of 31

E&OE Pricing and all details subject to change without notice - Copyright Miniature Bearings Australia Pty Ltd
MBA Size Listings are a guide to sizes only and must not be solely relied on for critical design information.

Screws - Shoulder - Socket Head - Carbon Steel

Part Number	Shoulder Diameter (E) mm	Shoulder Length (L) mm	Thread Size (t)	Max. Thread Length (S) mm	Head Diameter (D) mm	Thread Type	Head Height (H) mm	Material	Allen Key Size (T) mm
	<i>inches</i>	<i>inches</i>		<i>inches</i>	<i>inches</i>		<i>inches</i>		<i>inches</i>
# SHLD127-114-SKT-C	12.700	114.300	3/8-16 UNC	15.88	19.05		7.94	Hardened Carbon Steel	6.35
	<i>0.500</i>	<i>4.500</i>		<i>0.625</i>	<i>0.750</i>		<i>0.313</i>		<i>0.250</i>
# SHLD127-121-SKT-C	12.700	120.650	3/8-16 UNC	15.875	19.050		7.938	Hardened Alloy Steel	6.35
	<i>0.500</i>	<i>4.750</i>		<i>0.625</i>	<i>0.750</i>		<i>0.313</i>		<i>0.250</i>
# SHLD127-127-SKT-C	12.700	127.000	3/8-16 UNC	15.88	19.05		7.94	Hardened Carbon Steel	6.35
	<i>0.500</i>	<i>5.000</i>		<i>0.625</i>	<i>0.750</i>		<i>0.313</i>		<i>0.250</i>
# SHLD127-152-SKT-C	12.700	152.400	3/8-16 UNC	15.88	19.05		7.94	Hardened Carbon Steel	6.35
	<i>0.500</i>	<i>6.000</i>		<i>0.625</i>	<i>0.750</i>		<i>0.313</i>		<i>0.250</i>
# SHLD159-016-SKT-C	15.875	15.880	1/2-13 UNC					Hardened Carbon Steel	7.94
	<i>0.625</i>	<i>0.625</i>							<i>0.313</i>
# SHLD159-019-SKT-C	15.875	19.050	1/2-13 UNC					Hardened Carbon Steel	7.94
	<i>0.625</i>	<i>0.750</i>							<i>0.313</i>
# SHLD159-025-SKT-C	15.875	25.400	1/2-13 UNC					Hardened Carbon Steel	7.94
	<i>0.625</i>	<i>1.000</i>							<i>0.313</i>
# SHLD159-032-SKT-C	15.875	31.750	1/2-13 UNC					Hardened Carbon Steel	7.94
	<i>0.625</i>	<i>1.250</i>							<i>0.313</i>

Indicates item not stocked at time of printing - Please enquire for lead time

Page 21 of 31

E&OE Pricing and all details subject to change without notice - Copyright Miniature Bearings Australia Pty Ltd
MBA Size Listings are a guide to sizes only and must not be solely relied on for critical design information.

Screws - Shoulder - Socket Head - Carbon Steel

Part Number	Shoulder Diameter (E) mm	Shoulder Length (L) mm	Thread Size (t)	Max. Thread Length (S) mm	Head Diameter (D) mm	Thread Type	Head Height (H) mm	Material	Allen Key Size (T) mm
	<i>inches</i>	<i>inches</i>		<i>inches</i>	<i>inches</i>		<i>inches</i>		<i>inches</i>
# SHLD159-038-SKT-C	15.875	38.100	1/2-13 UNC					Hardened Carbon Steel	7.94
	<i>0.625</i>	<i>1.500</i>							<i>0.313</i>
# SHLD159-044-SKT-C	15.875	44.450	1/2-13 UNC					Hardened Carbon Steel	7.94
	<i>0.625</i>	<i>1.750</i>							<i>0.313</i>
# SHLD159-051-SKT-C	15.875	50.800	1/2-13 UNC					Hardened Carbon Steel	7.94
	<i>0.625</i>	<i>2.000</i>							<i>0.313</i>
# SHLD159-057-SKT-C	15.875	57.150	1/2-13 UNC					Hardened Carbon Steel	7.94
	<i>0.625</i>	<i>2.250</i>							<i>0.313</i>
# SHLD159-064-SKT-C	15.875	63.500	1/2-13 UNC					Hardened Carbon Steel	7.94
	<i>0.625</i>	<i>2.500</i>							<i>0.313</i>
# SHLD159-070-SKT-C	15.875	69.850	1/2-13 UNC					Hardened Carbon Steel	7.94
	<i>0.625</i>	<i>2.750</i>							<i>0.313</i>
# SHLD159-076-SKT-C	15.875	76.200	1/2-13 UNC					Hardened Carbon Steel	7.94
	<i>0.625</i>	<i>3.000</i>							<i>0.313</i>
# SHLD159-083-SKT-C	15.875	82.550	1/2-13 UNC					Hardened Carbon Steel	7.94
	<i>0.625</i>	<i>3.250</i>							<i>0.313</i>

Indicates item not stocked at time of printing - Please enquire for lead time

Page 22 of 31

E&OE Pricing and all details subject to change without notice - Copyright Miniature Bearings Australia Pty Ltd
MBA Size Listings are a guide to sizes only and must not be solely relied on for critical design information.

Screws - Shoulder - Socket Head - Carbon Steel

Part Number	Shoulder Diameter (E) mm	Shoulder Length (L) mm	Thread Size (t)	Max. Thread Length (S) mm	Head Diameter (D) mm	Thread Type	Head Height (H) mm	Material	Allen Key Size (T) mm
	<i>inches</i>	<i>inches</i>		<i>inches</i>	<i>inches</i>		<i>inches</i>		<i>inches</i>
# SHLD159-089-SKT-C	15.875	88.900	1/2-13 UNC					Hardened Carbon Steel	7.94
	<i>0.625</i>	<i>3.500</i>							<i>0.313</i>
# SHLD159-095-SKT-C	15.875	95.250	1/2-13 UNC	19.050	22.220		9.525	Hardened Alloy Steel	7.94
	<i>0.625</i>	<i>3.750</i>		<i>0.750</i>	<i>0.875</i>		<i>0.375</i>		<i>0.313</i>
# SHLD159-102-SKT-C	15.875	101.600	1/2-13 UNC					Hardened Carbon Steel	7.94
	<i>0.625</i>	<i>4.000</i>							<i>0.313</i>
# SHLD159-108-SKT-C	15.875	107.950	1/2-13 UNC	19.050	22.220		9.525	Hardened Alloy Steel	7.94
	<i>0.625</i>	<i>4.250</i>		<i>0.750</i>	<i>0.875</i>		<i>0.375</i>		<i>0.313</i>
# SHLD159-114-SKT-C	15.875	114.300	1/2-13 UNC					Hardened Carbon Steel	7.94
	<i>0.625</i>	<i>4.500</i>							<i>0.313</i>
# SHLD159-121-SKT-C	15.875	120.650	1/2-13 UNC	19.050	22.220		9.525	Hardened Alloy Steel	7.94
	<i>0.625</i>	<i>4.750</i>		<i>0.750</i>	<i>0.875</i>		<i>0.375</i>		<i>0.313</i>
# SHLD159-127-SKT-C	15.875	127.000	1/2-13 UNC					Hardened Carbon Steel	7.94
	<i>0.625</i>	<i>5.000</i>							<i>0.313</i>
# SHLD159-140-SKT-C	15.875	139.700	1/2-13 UNC	19.050	22.220		9.525	Hardened Alloy Steel	7.94
	<i>0.625</i>	<i>5.500</i>		<i>0.750</i>	<i>0.875</i>		<i>0.375</i>		<i>0.313</i>

Indicates item not stocked at time of printing - Please enquire for lead time

Page 23 of 31

E&OE Pricing and all details subject to change without notice - Copyright Miniature Bearings Australia Pty Ltd
MBA Size Listings are a guide to sizes only and must not be solely relied on for critical design information.

Screws - Shoulder - Socket Head - Carbon Steel

Part Number	Shoulder Diameter (E) mm	Shoulder Length (L) mm	Thread Size (t)	Max. Thread Length (S) mm	Head Diameter (D) mm	Thread Type	Head Height (H) mm	Material	Allen Key Size (T) mm
	<i>inches</i>	<i>inches</i>		<i>inches</i>	<i>inches</i>		<i>inches</i>		<i>inches</i>
# SHLD159-152-SKT-C	15.875	152.400	1/2-13 UNC					Hardened Carbon Steel	7.94
	<i>0.625</i>	<i>6.000</i>							<i>0.313</i>
# SHLD160-020-SKT-C	16.000	20.000	M12x1.75	18.40	24.33		10.00	Hardened Carbon Steel	8.0
	<i>0.630</i>	<i>0.787</i>		<i>0.724</i>	<i>0.958</i>		<i>0.394</i>		<i>0.315</i>
# SHLD160-025-SKT-C	16.000	25.000	M12x1.75	18.40	24.33		10.00	Hardened Carbon Steel	8.0
	<i>0.630</i>	<i>0.984</i>		<i>0.724</i>	<i>0.958</i>		<i>0.394</i>		<i>0.315</i>
# SHLD160-030-SKT-C	16.000	30.000	M12x1.75	18.40	24.33		10.00	Hardened Carbon Steel	8.0
	<i>0.630</i>	<i>1.181</i>		<i>0.724</i>	<i>0.958</i>		<i>0.394</i>		<i>0.315</i>
# SHLD160-035-SKT-C	16.000	35.000	M12x1.75	18.40	24.33		10.00	Hardened Carbon Steel	8.0
	<i>0.630</i>	<i>1.378</i>		<i>0.724</i>	<i>0.958</i>		<i>0.394</i>		<i>0.315</i>
# SHLD160-040-SKT-C	16.000	40.000	M12x1.75	18.40	24.33		10.00	Hardened Carbon Steel	8.0
	<i>0.630</i>	<i>1.575</i>		<i>0.724</i>	<i>0.958</i>		<i>0.394</i>		<i>0.315</i>
# SHLD160-045-SKT-C	16.000	45.000	M12x1.75	18.40	24.33		10.00	Hardened Carbon Steel	8.0
	<i>0.630</i>	<i>1.772</i>		<i>0.724</i>	<i>0.958</i>		<i>0.394</i>		<i>0.315</i>
# SHLD160-050-SKT-C	16.000	50.000	M12x1.75	18.40	24.33		10.00	Hardened Carbon Steel	8.0
	<i>0.630</i>	<i>1.969</i>		<i>0.724</i>	<i>0.958</i>		<i>0.394</i>		<i>0.315</i>

Indicates item not stocked at time of printing - Please enquire for lead time

Page 24 of 31

E&OE Pricing and all details subject to change without notice - Copyright Miniature Bearings Australia Pty Ltd
MBA Size Listings are a guide to sizes only and must not be solely relied on for critical design information.

Screws - Shoulder - Socket Head - Carbon Steel

Part Number	Shoulder Diameter (E) mm	Shoulder Length (L) mm	Thread Size (t)	Max. Thread Length (S) mm	Head Diameter (D) mm	Thread Type	Head Height (H) mm	Material	Allen Key Size (T) mm
	<i>inches</i>	<i>inches</i>		<i>inches</i>	<i>inches</i>		<i>inches</i>		<i>inches</i>
SHLD160-060-SKT-C	16.000	60.000	M12x1.75	18.40	24.33		10.00	Hardened Carbon Steel	8.0
	<i>0.630</i>	<i>2.362</i>		<i>0.724</i>	<i>0.958</i>		<i>0.394</i>		<i>0.315</i>
SHLD160-070-SKT-C	16.000	70.000	M12x1.75	18.40	24.33		10.00	Hardened Carbon Steel	8.0
	<i>0.630</i>	<i>2.756</i>		<i>0.724</i>	<i>0.958</i>		<i>0.394</i>		<i>0.315</i>
# SHLD160-080-SKT-C	16.000	80.000	M12x1.75	18.40	24.33		10.00	Hardened Carbon Steel	8.0
	<i>0.630</i>	<i>3.150</i>		<i>0.724</i>	<i>0.958</i>		<i>0.394</i>		<i>0.315</i>
# SHLD160-090-SKT-C	16.000	90.000	M12x1.75	18.40	24.33		10.00	Hardened Carbon Steel	8.0
	<i>0.630</i>	<i>3.543</i>		<i>0.724</i>	<i>0.958</i>		<i>0.394</i>		<i>0.315</i>
SHLD160-100-SKT-C	16.000	100.000	M12x1.75	18.40	24.33		10.00	Hardened Carbon Steel	8.0
	<i>0.630</i>	<i>3.937</i>		<i>0.724</i>	<i>0.958</i>		<i>0.394</i>		<i>0.315</i>
# SHLD160-110-SKT-C	16.000	110.000	M12x1.75	18.40	24.33		10.00	Hardened Carbon Steel	8.0
	<i>0.630</i>	<i>4.331</i>		<i>0.724</i>	<i>0.958</i>		<i>0.394</i>		<i>0.315</i>
# SHLD160-120-SKT-C	16.000	120.000	M12x1.75	18.40	24.33		10.00	Hardened Carbon Steel	8.0
	<i>0.630</i>	<i>4.724</i>		<i>0.724</i>	<i>0.958</i>		<i>0.394</i>		<i>0.315</i>
# SHLD160-150-SKT-C	16.000	150.000	M12x1.75	18.40	24.33		10.00	Hardened Carbon Steel	8.0
	<i>0.630</i>	<i>5.906</i>		<i>0.724</i>	<i>0.958</i>		<i>0.394</i>		<i>0.315</i>

Indicates item not stocked at time of printing - Please enquire for lead time

Page 25 of 31

E&OE Pricing and all details subject to change without notice - Copyright Miniature Bearings Australia Pty Ltd
MBA Size Listings are a guide to sizes only and must not be solely relied on for critical design information.

Screws - Shoulder - Socket Head - Carbon Steel

Part Number	Shoulder Diameter (E) mm	Shoulder Length (L) mm	Thread Size (t)	Max. Thread Length (S) mm	Head Diameter (D) mm	Thread Type	Head Height (H) mm	Material	Allen Key Size (T) mm
	<i>inches</i>	<i>inches</i>		<i>inches</i>	<i>inches</i>		<i>inches</i>		<i>inches</i>
# SHLD191-019-SKT-C	19.050	19.050	5/8 UNC					Hardened Carbon Steel	9.53
	<i>0.750</i>	<i>0.750</i>							<i>0.375</i>
# SHLD191-025-SKT-C	19.050	25.400	5/8 UNC					Hardened Carbon Steel	9.53
	<i>0.750</i>	<i>1.000</i>							<i>0.375</i>
# SHLD191-032-SKT-C	19.050	31.750	5/8 UNC					Hardened Carbon Steel	9.53
	<i>0.750</i>	<i>1.250</i>							<i>0.375</i>
# SHLD191-038-SKT-C	19.050	38.100	5/8 UNC					Hardened Carbon Steel	9.53
	<i>0.750</i>	<i>1.500</i>							<i>0.375</i>
# SHLD191-044-SKT-C	19.050	44.450	5/8 UNC					Hardened Carbon Steel	9.53
	<i>0.750</i>	<i>1.750</i>							<i>0.375</i>
# SHLD191-051-SKT-C	19.050	50.800	5/8 UNC					Hardened Carbon Steel	9.53
	<i>0.750</i>	<i>2.000</i>							<i>0.375</i>
# SHLD191-057-SKT-C	19.050	57.150	5/8 UNC					Hardened Carbon Steel	9.53
	<i>0.750</i>	<i>2.250</i>							<i>0.375</i>
# SHLD191-064-SKT-C	19.050	63.500	5/8 UNC					Hardened Carbon Steel	9.53
	<i>0.750</i>	<i>2.500</i>							<i>0.375</i>

Indicates item not stocked at time of printing - Please enquire for lead time

Page 26 of 31

E&OE Pricing and all details subject to change without notice - Copyright Miniature Bearings Australia Pty Ltd
MBA Size Listings are a guide to sizes only and must not be solely relied on for critical design information.

Screws - Shoulder - Socket Head - Carbon Steel

Part Number	Shoulder Diameter (E) mm	Shoulder Length (L) mm	Thread Size (t)	Max. Thread Length (S) mm	Head Diameter (D) mm	Thread Type	Head Height (H) mm	Material	Allen Key Size (T) mm
	<i>inches</i>	<i>inches</i>		<i>inches</i>	<i>inches</i>		<i>inches</i>		<i>inches</i>
# SHLD191-070-SKT-C	19.050	69.850	5/8 UNC					Hardened Carbon Steel	9.53
	<i>0.750</i>	<i>2.750</i>							<i>0.375</i>
# SHLD191-076-SKT-C	19.050	76.200	5/8 UNC					Hardened Carbon Steel	9.53
	<i>0.750</i>	<i>3.000</i>							<i>0.375</i>
# SHLD191-083-SKT-C	19.050	82.550	5/8 UNC					Hardened Carbon Steel	9.53
	<i>0.750</i>	<i>3.250</i>							<i>0.375</i>
# SHLD191-089-SKT-C	19.050	88.900	5/8 UNC					Hardened Carbon Steel	9.53
	<i>0.750</i>	<i>3.500</i>							<i>0.375</i>
# SHLD191-102-SKT-C	19.050	101.600	5/8 UNC					Hardened Carbon Steel	9.53
	<i>0.750</i>	<i>4.000</i>							<i>0.375</i>
# SHLD191-108-SKT-C	19.050	107.950	5/8-11 UNC	22.220	25.400		12.700	Hardened Alloy Steel	9.53
	<i>0.750</i>	<i>4.250</i>		<i>0.875</i>	<i>1.000</i>		<i>0.500</i>		<i>0.375</i>
# SHLD191-114-SKT-C	19.050	114.300	5/8 UNC					Hardened Carbon Steel	9.53
	<i>0.750</i>	<i>4.500</i>							<i>0.375</i>
# SHLD191-121-SKT-C	19.050	120.650	5/8-11 UNC	22.220	25.400		12.700	Hardened Alloy Steel	9.53
	<i>0.750</i>	<i>4.750</i>		<i>0.875</i>	<i>1.000</i>		<i>0.500</i>		<i>0.375</i>

Indicates item not stocked at time of printing - Please enquire for lead time

Page 27 of 31

E&OE Pricing and all details subject to change without notice - Copyright Miniature Bearings Australia Pty Ltd
MBA Size Listings are a guide to sizes only and must not be solely relied on for critical design information.

Screws - Shoulder - Socket Head - Carbon Steel

Part Number	Shoulder Diameter (E) mm	Shoulder Length (L) mm	Thread Size (t)	Max. Thread Length (S) mm	Head Diameter (D) mm	Thread Type	Head Height (H) mm	Material	Allen Key Size (T) mm
	<i>inches</i>	<i>inches</i>		<i>inches</i>	<i>inches</i>		<i>inches</i>		<i>inches</i>
# SHLD191-127-SKT-C	19.050	127.000	5/8 UNC					Hardened Carbon Steel	9.53
	<i>0.750</i>	<i>5.000</i>							<i>0.375</i>
# SHLD191-140-SKT-C	19.050	139.700	5/8-11 UNC	22.220	25.400		12.700	Hardened Alloy Steel	9.53
	<i>0.750</i>	<i>5.500</i>		<i>0.875</i>	<i>1.000</i>		<i>0.500</i>		<i>0.375</i>
# SHLD191-152-SKT-C	19.050	152.400	5/8 UNC					Hardened Carbon Steel	9.53
	<i>0.750</i>	<i>6.000</i>							<i>0.375</i>
# SHLD200-040-SKT-C	20.000	40.000	M16					Hardened Carbon Steel	10.0
	<i>0.787</i>	<i>1.575</i>							<i>0.394</i>
# SHLD200-050-SKT-C	20.000	50.000	M16					Hardened Carbon Steel	10.0
	<i>0.787</i>	<i>1.969</i>							<i>0.394</i>
# SHLD200-060-SKT-C	20.000	60.000	M16					Hardened Carbon Steel	10.0
	<i>0.787</i>	<i>2.362</i>							<i>0.394</i>
# SHLD200-070-SKT-C	20.000	70.000	M16					Hardened Carbon Steel	10.0
	<i>0.787</i>	<i>2.756</i>							<i>0.394</i>
# SHLD200-080-SKT-C	20.000	80.000	M16					Hardened Carbon Steel	10.0
	<i>0.787</i>	<i>3.150</i>							<i>0.394</i>

Indicates item not stocked at time of printing - Please enquire for lead time

Page 28 of 31

E&OE Pricing and all details subject to change without notice - Copyright Miniature Bearings Australia Pty Ltd

MBA Size Listings are a guide to sizes only and must not be solely relied on for critical design information.

Screws - Shoulder - Socket Head - Carbon Steel

Part Number	Shoulder Diameter (E) mm	Shoulder Length (L) mm	Thread Size (t)	Max. Thread Length (S) mm	Head Diameter (D) mm	Thread Type	Head Height (H) mm	Material	Allen Key Size (T) mm
	<i>inches</i>	<i>inches</i>		<i>inches</i>	<i>inches</i>		<i>inches</i>		<i>inches</i>
# SHLD200-090-SKT-C	20.000	90.000	M16					Hardened Carbon Steel	10.0
	<i>0.787</i>	<i>3.543</i>							<i>0.394</i>
# SHLD200-100-SKT-C	20.000	100.000	M16					Hardened Carbon Steel	10.0
	<i>0.787</i>	<i>3.937</i>							<i>0.394</i>
# SHLD200-120-SKT-C	20.000	120.000	M16					Hardened Carbon Steel	10.0
	<i>0.787</i>	<i>4.724</i>							<i>0.394</i>
# SHLD200-150-SKT-C	20.000	150.000	M16					Hardened Carbon Steel	10.0
	<i>0.787</i>	<i>5.906</i>							<i>0.394</i>
# SHLD240-050-SKT-C	24.000	50.000	M20					Hardened Carbon Steel	12.0
	<i>0.945</i>	<i>1.969</i>							<i>0.472</i>
# SHLD240-060-SKT-C	24.000	60.000	M20					Hardened Carbon Steel	12.0
	<i>0.945</i>	<i>2.362</i>							<i>0.472</i>
# SHLD240-070-SKT-C	24.000	70.000	M20					Hardened Carbon Steel	12.0
	<i>0.945</i>	<i>2.756</i>							<i>0.472</i>
# SHLD240-080-SKT-C	24.000	80.000	M20					Hardened Carbon Steel	12.0
	<i>0.945</i>	<i>3.150</i>							<i>0.472</i>

Indicates item not stocked at time of printing - Please enquire for lead time

Page 29 of 31

E&OE Pricing and all details subject to change without notice - Copyright Miniature Bearings Australia Pty Ltd

MBA Size Listings are a guide to sizes only and must not be solely relied on for critical design information.

Screws - Shoulder - Socket Head - Carbon Steel

Part Number	Shoulder Diameter (E) mm	Shoulder Length (L) mm	Thread Size (t)	Max. Thread Length (S) mm	Head Diameter (D) mm	Thread Type	Head Height (H) mm	Material	Allen Key Size (T) mm
	<i>inches</i>	<i>inches</i>		<i>inches</i>	<i>inches</i>		<i>inches</i>		<i>inches</i>
# SHLD240-090-SKT-C	24.000	90.000	M20					Hardened Carbon Steel	12.0
	<i>0.945</i>	<i>3.543</i>							<i>0.472</i>
# SHLD240-100-SKT-C	24.000	100.000	M20					Hardened Carbon Steel	12.0
	<i>0.945</i>	<i>3.937</i>							<i>0.472</i>
# SHLD240-120-SKT-C	24.000	120.000	M20					Hardened Carbon Steel	12.0
	<i>0.945</i>	<i>4.724</i>							<i>0.472</i>
# SHLD254-032-SKT-C	25.400	31.750	3/4 UNC					Hardened Carbon Steel	
	<i>1.000</i>	<i>1.250</i>							
# SHLD254-038-SKT-C	25.400	38.100	3/4 UNC					Hardened Carbon Steel	
	<i>1.000</i>	<i>1.500</i>							
# SHLD254-051-SKT-C	25.400	50.800	3/4 UNC					Hardened Carbon Steel	
	<i>1.000</i>	<i>2.000</i>							
# SHLD254-064-SKT-C	25.400	63.500	3/4 UNC					Hardened Carbon Steel	
	<i>1.000</i>	<i>2.500</i>							
# SHLD254-076-SKT-C	25.400	76.200	3/4 UNC					Hardened Carbon Steel	
	<i>1.000</i>	<i>3.000</i>							

Indicates item not stocked at time of printing - Please enquire for lead time

E&OE Pricing and all details subject to change without notice - Copyright Miniature Bearings Australia Pty Ltd

MBA Size Listings are a guide to sizes only and must not be solely relied on for critical design information.

Screws - Shoulder - Socket Head - Carbon Steel

Part Number	Shoulder Diameter (E) mm	Shoulder Length (L) mm	Thread Size (t)	Max. Thread Length (S) mm	Head Diameter (D) mm	Thread Type	Head Height (H) mm	Material	Allen Key Size (T) mm
	<i>inches</i>	<i>inches</i>		<i>inches</i>	<i>inches</i>		<i>inches</i>		<i>inches</i>
# SHLD254-102-SKT-C	25.400	101.600	3/4 UNC					Hardened Carbon Steel	
	<i>1.000</i>	<i>4.000</i>							
# SHLD254-127-SKT-C	25.400	127.000	3/4 UNC					Hardened Carbon Steel	
	<i>1.000</i>	<i>5.000</i>							
# SHLD254-152-SKT-C	25.400	152.400	3/4 UNC					Hardened Carbon Steel	
	<i>1.000</i>	<i>6.000</i>							

Indicates item not stocked at time of printing - Please enquire for lead time

E&OE Pricing and all details subject to change without notice - Copyright Miniature Bearings Australia Pty Ltd

MBA Size Listings are a guide to sizes only and must not be solely relied on for critical design information.

DISTRIBUTED BY

Distributed By:

