



Screws - Thumb - Wing - Washer Face - Steel

10/4/2018

Indicates item not stocked at time of printing - Please enquire for lead time

E&OE Pricing and all details subject to change without notice - Copyright Miniature Bearings Australia Pty Ltd

MBA Size Listings are a guide to sizes only and must not be solely relied on for critical design information.

INFORMATION

Wing head malleable iron screws with an integral washer

Indicates item not stocked at time of printing - Please enquire for lead time

E&OE Pricing and all details subject to change without notice - Copyright Miniature Bearings Australia Pty Ltd

MBA Size Listings are a guide to sizes only and must not be solely relied on for critical design information.

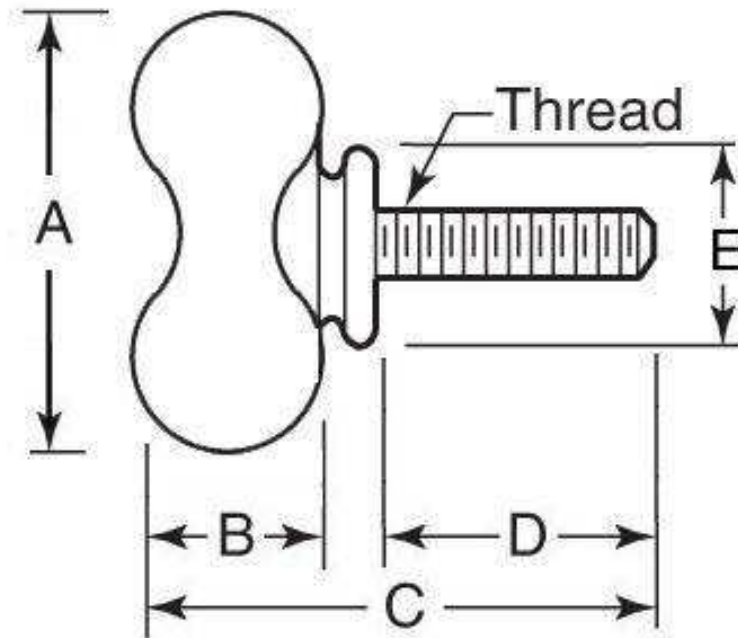

Indicates item not stocked at time of printing - Please enquire for lead time

E&OE Pricing and all details subject to change without notice - Copyright Miniature Bearings Australia Pty Ltd

MBA Size Listings are a guide to sizes only and must not be solely relied on for critical design information.

Screws - Thumb - Wing - Washer Face - Steel

Part Number	Thread Size	Thread Length (D) mm	Overall Length (C) mm	Head Diameter (A) mm	Shoulder Diameter (E) mm	Head Height (B) mm	Finish	Pitch mm
		<i>inches</i>	<i>inches</i>	<i>inches</i>	<i>inches</i>	<i>inches</i>		<i>inches</i>
# THS064C-013-W-CS-WF	1/4-20 UNC (6.35mm)	12.700	33.338	31.750	14.288	20.638	Tumbled	1.270
		<i>0.500</i>	<i>1.313</i>	<i>1.250</i>	<i>0.563</i>	<i>0.813</i>		<i>0.050</i>
# THS064C-019-W-CS-WF	1/4-20 UNC (6.35mm)	19.050	39.688	31.750	14.288	20.638	Tumbled	1.270
		<i>0.750</i>	<i>1.563</i>	<i>1.250</i>	<i>0.563</i>	<i>0.813</i>		<i>0.050</i>
# THS064C-025-W-CS-WF	1/4-20 UNC (6.35mm)	25.400	46.038	31.750	14.288	20.638	Tumbled	1.270
		<i>1.000</i>	<i>1.813</i>	<i>1.250</i>	<i>0.563</i>	<i>0.813</i>		<i>0.050</i>
# THS064C-038-W-CS-WF	1/4-20 UNC (6.35mm)	38.100	58.738	31.750	14.288	20.638	Tumbled	1.270
		<i>1.500</i>	<i>2.313</i>	<i>1.250</i>	<i>0.563</i>	<i>0.813</i>		<i>0.050</i>
# THS064C-051-W-CS-WF	1/4-20 UNC (6.35mm)	50.800	71.438	31.750	14.288	20.638	Tumbled	1.270
		<i>2.000</i>	<i>2.813</i>	<i>1.250</i>	<i>0.563</i>	<i>0.813</i>		<i>0.050</i>
# THS095C-025-W-CS-WF	3/8-16 UNC (9.525mm)	25.400	50.800	36.513	19.050	25.400	Tumbled	1.588
		<i>1.000</i>	<i>2.000</i>	<i>1.438</i>	<i>0.750</i>	<i>1.000</i>		<i>0.063</i>

Indicates item not stocked at time of printing - Please enquire for lead time

Page 4 of 4

E&OE Pricing and all details subject to change without notice - Copyright Miniature Bearings Australia Pty Ltd
MBA Size Listings are a guide to sizes only and must not be solely relied on for critical design information.

DISTRIBUTED BY

Distributed By:

