



Shafting - Pipe - Aluminium

10/4/2018

Indicates item not stocked at time of printing - Please enquire for lead time

E&OE Pricing and all details subject to change without notice - Copyright Miniature Bearings Australia Pty Ltd

MBA Size Listings are a guide to sizes only and must not be solely relied on for critical design information.

INFORMATION

Recommended for use with Igubal Drylin bearings only.

Material : AlMgSi 0.5 F22.

Tolerance: h9 - h11. Roundness: DIN 1798. Straightness: DIN 1798.

Hardness: 75HB. Surface: Hard anodised. Oxidisation (wear resistant Al. Oxide) Layer Thickness: Greater than 40um.

Surface Hardness: 450-550 HV. Roughness: Ra Less than 0.5. Special Electrical Resistance: 4×10^{11} Ohm mm²/m.

Chemical Resistance: Ph Greater than 2 and Less than 9

Indicates item not stocked at time of printing - Please enquire for lead time

E&OE Pricing and all details subject to change without notice - Copyright Miniature Bearings Australia Pty Ltd

MBA Size Listings are a guide to sizes only and must not be solely relied on for critical design information.

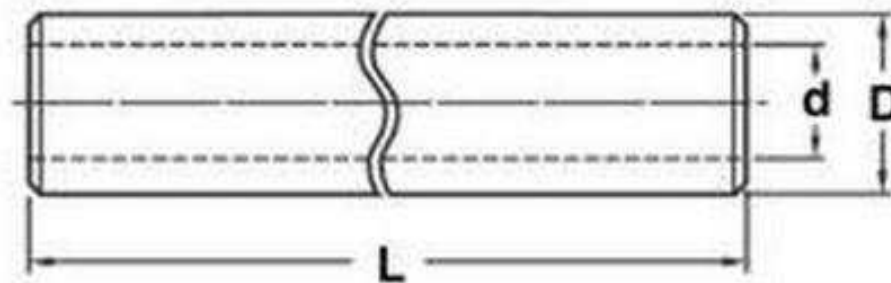

Indicates item not stocked at time of printing - Please enquire for lead time

E&OE Pricing and all details subject to change without notice - Copyright Miniature Bearings Australia Pty Ltd

MBA Size Listings are a guide to sizes only and must not be solely relied on for critical design information.

Shafting - Pipe - Aluminium

Part Number	OD (D) mm	Nominal ID (d) mm	Length (L) mm
	<i>inches</i>	<i>inches</i>	<i>inches</i>
# 0R-0300-0300-P-AL-T33	30.000 <i>1.181</i>	15.00 <i>0.591</i>	300 <i>11.811</i>
# 0R-0300-0600-P-AL-T33	30.000 <i>1.181</i>	15.00 <i>0.591</i>	600 <i>23.622</i>
# 0R-0300-1000-P-AL-T33	30.000 <i>1.181</i>	15.00 <i>0.591</i>	1000 <i>39.370</i>
# 0R-0300-2000-P-AL-T33	30.000 <i>1.181</i>	15.00 <i>0.591</i>	2000 <i>78.740</i>
# 0R-0400-0300-P-AL-T39	40.000 <i>1.575</i>	20.00 <i>0.787</i>	300 <i>11.811</i>
# 0R-0400-0600-P-AL-T39	40.000 <i>1.575</i>	20.00 <i>0.787</i>	600 <i>23.622</i>
# 0R-0400-1000-P-AL-T39	40.000 <i>1.575</i>	20.00 <i>0.787</i>	1000 <i>39.370</i>
# 0R-0400-2000-P-AL-T39	40.000 <i>1.575</i>	20.00 <i>0.787</i>	2000 <i>78.740</i>
# 0R-0500-0300-P-AL-T39	50.000 <i>1.969</i>	28.00 <i>1.102</i>	300 <i>11.811</i>
# 0R-0500-0600-P-AL-T39	50.000 <i>1.969</i>	28.00 <i>1.102</i>	600 <i>23.622</i>

Indicates item not stocked at time of printing - Please enquire for lead time

E&OE Pricing and all details subject to change without notice - Copyright Miniature Bearings Australia Pty Ltd
MBA Size Listings are a guide to sizes only and must not be solely relied on for critical design information.

Shafting - Pipe - Aluminium

Part Number	OD (D) mm	Nominal ID (d) mm	Length (L) mm
	<i>inches</i>	<i>inches</i>	<i>inches</i>
# 0R-0500-1000-P-AL-T39	50.000	28.00	1000
	<i>1.969</i>	<i>1.102</i>	<i>39.370</i>
# 0R-0500-2000-P-AL-T39	50.000	28.00	2000
	<i>1.969</i>	<i>1.102</i>	<i>78.740</i>

Indicates item not stocked at time of printing - Please enquire for lead time

E&OE Pricing and all details subject to change without notice - Copyright Miniature Bearings Australia Pty Ltd
 MBA Size Listings are a guide to sizes only and must not be solely relied on for critical design information.

DISTRIBUTED BY

Distributed By:

