



Shock Absorbers - Hydraulic with Speed-Feed Controller

10/4/2018

Indicates item not stocked at time of printing - Please enquire for lead time

E&OE Pricing and all details subject to change without notice - Copyright Miniature Bearings Australia Pty Ltd

MBA Size Listings are a guide to sizes only and must not be solely relied on for critical design information.

Page 1 of 4

INFORMATION

Indicates item not stocked at time of printing - Please enquire for lead time

E&OE Pricing and all details subject to change without notice - Copyright Miniature Bearings Australia Pty Ltd

MBA Size Listings are a guide to sizes only and must not be solely relied on for critical design information.

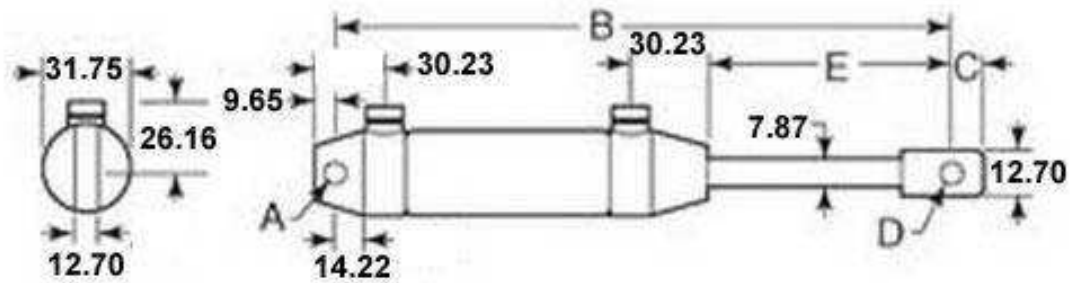

Indicates item not stocked at time of printing - Please enquire for lead time

E&OE Pricing and all details subject to change without notice - Copyright Miniature Bearings Australia Pty Ltd

MBA Size Listings are a guide to sizes only and must not be solely relied on for critical design information.

Shock Absorbers - Hydraulic with Speed-Feed Controller

Part Number	Stroke mm	Diameter mm	Length (B) mm	Hole Size (A/E) mm	Max Propelling Tension Force KG	Max Propelling Compress Force KG	More Information
	<i>inches</i>	<i>inches</i>	<i>inches</i>	<i>inches</i>			
# ACE3200RS	50.80	31.75	249.17	6.35 / 6.35	204.12	204.12	For more information please contact us.
	<i>2.000</i>	<i>1.250</i>	<i>9.810</i>				
# ACE3400RS	101.60	31.75	350.77	6.35 / 6.35	204.12	170.10	For more information please contact us.
	<i>4.000</i>	<i>1.250</i>	<i>13.810</i>				
# ACE3600RS	152.40	31.75	452.37	6.35 / 6.35	204.12	136.08	For more information please contact us.
	<i>6.000</i>	<i>1.250</i>	<i>17.810</i>				

Indicates item not stocked at time of printing - Please enquire for lead time

E&OE Pricing and all details subject to change without notice - Copyright Miniature Bearings Australia Pty Ltd

MBA Size Listings are a guide to sizes only and must not be solely relied on for critical design information.

DISTRIBUTED BY

Distributed By:

