



Sleeves - Hex Hole - Carbon Steel

10/4/2018

Indicates item not stocked at time of printing - Please enquire for lead time

E&OE Pricing and all details subject to change without notice - Copyright Miniature Bearings Australia Pty Ltd

MBA Size Listings are a guide to sizes only and must not be solely relied on for critical design information.

Page 1 of 5

INFORMATION

Carefully turned to provide 0.076mm (0.003in) concentricity ID to OD. Round OD with with a uniform hex hole broached from one end to the other.

Indicates item not stocked at time of printing - Please enquire for lead time

E&OE Pricing and all details subject to change without notice - Copyright Miniature Bearings Australia Pty Ltd

MBA Size Listings are a guide to sizes only and must not be solely relied on for critical design information.

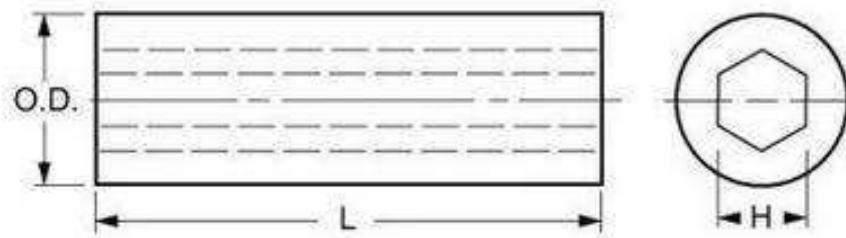

Indicates item not stocked at time of printing - Please enquire for lead time

E&OE Pricing and all details subject to change without notice - Copyright Miniature Bearings Australia Pty Ltd

MBA Size Listings are a guide to sizes only and must not be solely relied on for critical design information.

Sleeves - Hex Hole - Carbon Steel

Part Number	Nominal Hex Size mm <i>inches</i>	Outside Diameter (OD) mm <i>inches</i>	Length (L) mm <i>inches</i>	Actual Hex Size (H) mm <i>inches</i>	Material
# SLH-0318-0635-01905	3.175 <i>0.125</i>	6.350 <i>0.250</i>	19.050 <i>0.750</i>	3.251 <i>0.128</i>	11L17 Carbon Steel
# SLH-0476-0953-03810	4.763 <i>0.188</i>	9.525 <i>0.375</i>	38.100 <i>1.500</i>	4.826 <i>0.190</i>	11L17 Carbon Steel
# SLH-0635-1270-05080	6.35 <i>0.250</i>	12.700 <i>0.500</i>	50.800 <i>2.000</i>	6.426 <i>0.253</i>	11L17 Carbon Steel
# SLH-0794-1429-05715	7.938 <i>0.313</i>	14.288 <i>0.563</i>	57.150 <i>2.250</i>	8.00 <i>0.315</i>	11L17 Carbon Steel
# SLH-0953-1588-06350	9.525 <i>0.375</i>	15.875 <i>0.625</i>	63.500 <i>2.500</i>	9.601 <i>0.378</i>	11L17 Carbon Steel
SLH-1111-1905-06668	11.111 <i>0.437</i>	19.050 <i>0.750</i>	66.675 <i>2.625</i>	11.176 <i>0.440</i>	11L17 Carbon Steel
# SLH-1270-2064-06985	12.7 <i>0.500</i>	20.638 <i>0.813</i>	69.850 <i>2.750</i>	12.776 <i>0.503</i>	11L17 Carbon Steel
# SLH-1588-2540-08255	15.875 <i>0.625</i>	25.400 <i>1.000</i>	82.550 <i>3.250</i>	15.951 <i>0.628</i>	11L17 Carbon Steel
# SLH-1905-3016-10160	19.05 <i>0.750</i>	30.163 <i>1.188</i>	101.600 <i>4.000</i>	19.126 <i>0.753</i>	11L17 Carbon Steel
SLH-2223-3493-10160	22.225 <i>0.875</i>	34.925 <i>1.375</i>	101.600 <i>4.000</i>	22.301 <i>0.878</i>	11L17 Carbon Steel

Indicates item not stocked at time of printing - Please enquire for lead time

E&OE Pricing and all details subject to change without notice - Copyright Miniature Bearings Australia Pty Ltd

MBA Size Listings are a guide to sizes only and must not be solely relied on for critical design information.

Sleeves - Hex Hole - Carbon Steel

Part Number	Nominal Hex Size mm <i>inches</i>	Outside Diameter (OD) mm <i>inches</i>	Length (L) mm <i>inches</i>	Actual Hex Size (H) mm <i>inches</i>	Material
SLH-2540-3969-12700	25.4 <i>1.000</i>	39.688 <i>1.563</i>	127.000 <i>5.000</i>	25.502 <i>1.004</i>	11L17 Carbon Steel
SLH-3175-5239-12700	31.75 <i>1.250</i>	52.388 <i>2.063</i>	127.000 <i>5.000</i>	31.877 <i>1.255</i>	11L17 Carbon Steel

Indicates item not stocked at time of printing - Please enquire for lead time

E&OE Pricing and all details subject to change without notice - Copyright Miniature Bearings Australia Pty Ltd

MBA Size Listings are a guide to sizes only and must not be solely relied on for critical design information.

DISTRIBUTED BY

Distributed By:

