



# **Slides - Drawer - Stainless - No Disconnect - Medium Duty - 19mm Ext**

10/4/2018

# Indicates item not stocked at time of printing - Please enquire for lead time

E&OE Pricing and all details subject to change without notice - Copyright Miniature Bearings Australia Pty Ltd

MBA Size Listings are a guide to sizes only and must not be solely relied on for critical design information.

## INFORMATION

Made from 304 stainless with bearing balls. Used where corrosion resistance is required such as laboratories, humid and damp environments, marine applications and clean rooms. Bright finish, tight tolerance, quiet operation and smooth glide.

Side mounted two member slide.

Positive stop slide that will not disconnect once installed.

Requires 16 M4 or 8 Gauge Pan Head Screws (not included).

# Indicates item not stocked at time of printing - Please enquire for lead time

E&OE Pricing and all details subject to change without notice - Copyright Miniature Bearings Australia Pty Ltd

MBA Size Listings are a guide to sizes only and must not be solely relied on for critical design information.

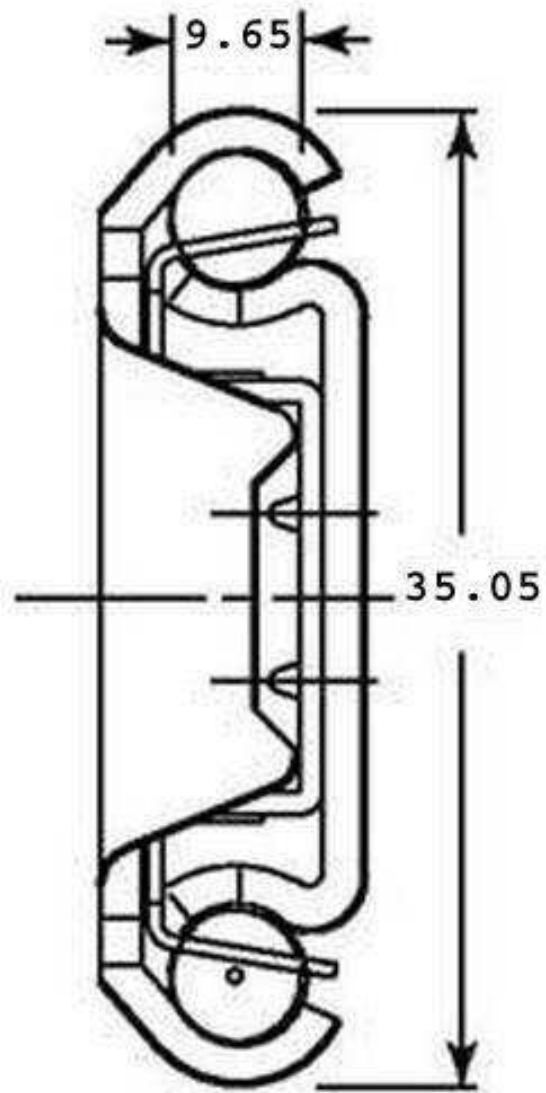

# Indicates item not stocked at time of printing - Please enquire for lead time

E&OE Pricing and all details subject to change without notice - Copyright Miniature Bearings Australia Pty Ltd

MBA Size Listings are a guide to sizes only and must not be solely relied on for critical design information.

## Slides - Drawer - Stainless - No Disconnect - Medium Duty - 19mm Ext

Part Number	Slide Length mm <i>inches</i>	Slide Travel mm <i>inches</i>	Load Rating kg	Slide Width mm <i>inches</i>
# SUG-328RS	304.80 <i>12.000</i>	228.60 <i>9.000</i>	48.534	35.05 <i>1.380</i>
# SUG-330RS	355.60 <i>14.000</i>	279.40 <i>11.000</i>	46.720	35.05 <i>1.380</i>
# SUG-332RS	406.40 <i>16.000</i>	304.80 <i>12.000</i>	42.638	35.05 <i>1.380</i>
# SUG-334RS	457.20 <i>18.000</i>	330.20 <i>13.000</i>	40.823	35.05 <i>1.380</i>
# SUG-336RS	508.00 <i>20.000</i>	381.00 <i>15.000</i>	36.741	35.05 <i>1.380</i>
# SUG-338RS	558.80 <i>22.000</i>	406.40 <i>16.000</i>	33.566	35.05 <i>1.380</i>
# SUG-340RS	609.60 <i>24.000</i>	431.80 <i>17.000</i>	29.937	35.05 <i>1.380</i>
# SUG-342RS	660.40 <i>26.000</i>	482.60 <i>19.000</i>	26.762	35.05 <i>1.380</i>
# SUG-344RS	711.20 <i>28.000</i>	508.00 <i>20.000</i>	24.948	35.05 <i>1.380</i>

# Indicates item not stocked at time of printing - Please enquire for lead time

E&OE Pricing and all details subject to change without notice - Copyright Miniature Bearings Australia Pty Ltd

MBA Size Listings are a guide to sizes only and must not be solely relied on for critical design information.

DISTRIBUTED BY

Distributed By:

