



Snap Buttons - Single End - Dog Leg

10/4/2018

Indicates item not stocked at time of printing - Please enquire for lead time

E&OE Pricing and all details subject to change without notice - Copyright Miniature Bearings Australia Pty Ltd

MBA Size Listings are a guide to sizes only and must not be solely relied on for critical design information.

INFORMATION

Fasteners for telescoping tubing help reduce assembly time whilst improving your product functionality. Also called button clips or spring buttons.

Eliminates the need for rivets and screws.

Simply snap into place in square or round tubing.

Made from 1050 heat treated spring steel with minimum 0.005mm (0.0002 inch) zinc plating

Indicates item not stocked at time of printing - Please enquire for lead time

E&OE Pricing and all details subject to change without notice - Copyright Miniature Bearings Australia Pty Ltd

MBA Size Listings are a guide to sizes only and must not be solely relied on for critical design information.

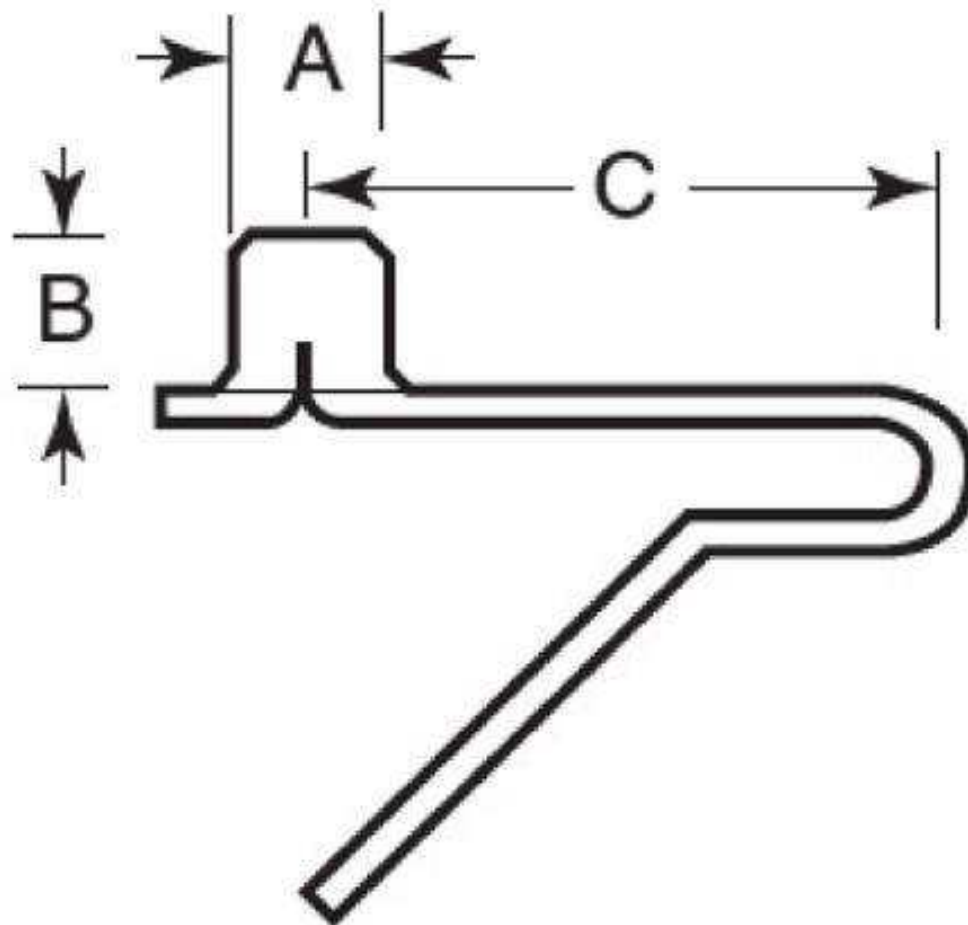

Indicates item not stocked at time of printing - Please enquire for lead time

E&OE Pricing and all details subject to change without notice - Copyright Miniature Bearings Australia Pty Ltd

MBA Size Listings are a guide to sizes only and must not be solely relied on for critical design information.

Snap Buttons - Single End - Dog Leg

Part Number	End Diameter (A) mm	End Height (B) mm	Material Thickness mm	Clip Width mm	Centre to Middle of End (C) mm	Use with Round Tubing	Use with Square Tubing
	<i>inches</i>	<i>inches</i>	<i>inches</i>	<i>inches</i>	<i>inches</i>		
SBTN-0927-DL	9.271	9.398	0.635	12.954	45.720	15.2 to 28.4	15.2 to 28.4
	<i>0.365</i>	<i>0.370</i>	<i>0.025</i>	<i>0.510</i>	<i>1.800</i>		

Indicates item not stocked at time of printing - Please enquire for lead time

E&OE Pricing and all details subject to change without notice - Copyright Miniature Bearings Australia Pty Ltd

MBA Size Listings are a guide to sizes only and must not be solely relied on for critical design information.

DISTRIBUTED BY

Distributed By:

