



Socket Set Screws - Rolling Ball Tip - Carbon Steel

10/4/2018

Indicates item not stocked at time of printing - Please enquire for lead time

E&OE Pricing and all details subject to change without notice - Copyright Miniature Bearings Australia Pty Ltd

MBA Size Listings are a guide to sizes only and must not be solely relied on for critical design information.

Page 1 of 7

INFORMATION

Rolling ball tip for locating into a hole

Rolling ball set screws are not designed to bear heavy loads.

Used to lightly fasten fragile work pieces.

We would recommend testing if you plan to use them in a load bearing application

This catalogue to be read in conjunction with information at <http://www.minibearings.com.au//partslist/toolssetsfoldup/tools/all/1/>

Indicates item not stocked at time of printing - Please enquire for lead time

E&OE Pricing and all details subject to change without notice - Copyright Miniature Bearings Australia Pty Ltd

MBA Size Listings are a guide to sizes only and must not be solely relied on for critical design information.

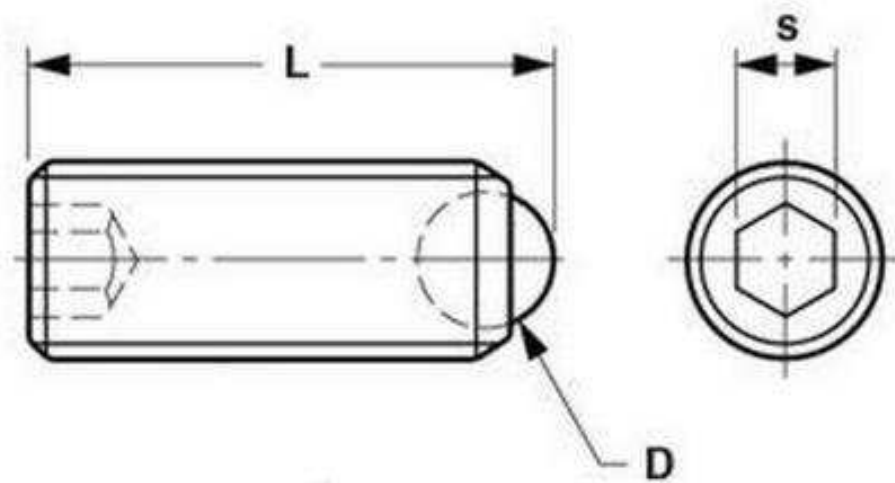

Indicates item not stocked at time of printing - Please enquire for lead time

E&OE Pricing and all details subject to change without notice - Copyright Miniature Bearings Australia Pty Ltd

MBA Size Listings are a guide to sizes only and must not be solely relied on for critical design information.

Socket Set Screws - Rolling Ball Tip - Carbon Steel

Part Number	Thread Size	Overall Length (L) mm <i>inches</i>	Ball Diameter (D)	Hex Key Size (s) mm <i>inches</i>	Body material	Ball material	Finish	Pitch mm <i>inches</i>
SS030M-0052-CS-RB	M3x0.5 (3mm Standard)	5.2 <i>0.205</i>	1.500	1.50 <i>0.059</i>	Carbon Steel	Carbon Steel, HRC 55...60	Black Oxide	0.500 <i>0.020</i>
# SS030M-0102-CS-RB	M3x0.5 (3mm Standard)	10.2 <i>0.402</i>	1.500	1.50 <i>0.059</i>	Carbon Steel	Carbon Steel, HRC 55...60	Black Oxide	0.500 <i>0.020</i>
# SS040M-0065-CS-RB	M4x0.7 (4mm Standard)	6.5 <i>0.256</i>	2.500	2.00 <i>0.079</i>	Carbon Steel	Carbon Steel, HRC 55...60	Black Oxide	0.700 <i>0.028</i>
# SS040M-0105-CS-RB	M4x0.7 (4mm Standard)	10.5 <i>0.413</i>	2.500	2.00 <i>0.079</i>	Carbon Steel	Carbon Steel, HRC 55...60	Black Oxide	0.700 <i>0.028</i>
SS040M-0165-CS-RB	M4x0.7 (4mm Standard)	16.5 <i>0.650</i>	2.500	2.00 <i>0.079</i>	Carbon Steel	Carbon Steel, HRC 55...60	Black Oxide	0.700 <i>0.028</i>
SS050M-0086-CS-RB	M5x0.8 (5mm Standard)	8.6 <i>0.339</i>	3.000	2.50 <i>0.098</i>	Carbon Steel	Carbon Steel, HRC 55...60	Black Oxide	0.800 <i>0.031</i>
# SS050M-0126-CS-RB	M5x0.8 (5mm Standard)	12.6 <i>0.496</i>	3.000	2.50 <i>0.098</i>	Carbon Steel	Carbon Steel, HRC 55...60	Black Oxide	0.800 <i>0.031</i>
# SS050M-0206-CS-RB	M5x0.8 (5mm Standard)	20.6 <i>0.811</i>	3.000	2.50 <i>0.098</i>	Carbon Steel	Carbon Steel, HRC 55...60	Black Oxide	0.800 <i>0.031</i>

Indicates item not stocked at time of printing - Please enquire for lead time

Page 4 of 7

E&OE Pricing and all details subject to change without notice - Copyright Miniature Bearings Australia Pty Ltd

MBA Size Listings are a guide to sizes only and must not be solely relied on for critical design information.

Socket Set Screws - Rolling Ball Tip - Carbon Steel

Part Number	Thread Size	Overall Length (L) mm <i>inches</i>	Ball Diameter (D)	Hex Key Size (s) mm <i>inches</i>	Body material	Ball material	Finish	Pitch mm <i>inches</i>
SS060M-0108-CS-RB	M6x1 (6mm Standard)	10.8 <i>0.425</i>	4.000	3.00 <i>0.118</i>	Carbon Steel	Carbon Steel, HRC 55...60	Black Oxide	1.000 <i>0.039</i>
SS060M-0168-CS-RB	M6x1 (6mm Standard)	16.8 <i>0.661</i>	4.000	3.00 <i>0.118</i>	Carbon Steel	Carbon Steel, HRC 55...60	Black Oxide	1.000 <i>0.039</i>
SS060M-0208-CS-RB	M6x1 (6mm Standard)	20.8 <i>0.819</i>	4.000	3.00 <i>0.118</i>	Carbon Steel	Carbon Steel, HRC 55...60	Black Oxide	1.000 <i>0.039</i>
# SS060M-0258-CS-RB	M6x1 (6mm Standard)	25.8 <i>1.016</i>	4.000	3.00 <i>0.118</i>	Carbon Steel	Carbon Steel, HRC 55...60	Black Oxide	1.000 <i>0.039</i>
# SS080M-0112-CS-RB	M8x1.25 (8mm Standard)	11.2 <i>0.441</i>	5.500	4.00 <i>0.157</i>	Carbon Steel	Carbon Steel, HRC 55...60	Black Oxide	1.250 <i>0.049</i>
# SS080M-0132-CS-RB	M8x1.25 (8mm Standard)	13.2 <i>0.520</i>	5.500	4.00 <i>0.157</i>	Carbon Steel	Carbon Steel, HRC 55...60	Black Oxide	1.250 <i>0.049</i>
SS080M-0212-CS-RB	M8x1.25 (8mm Standard)	21.2 <i>0.835</i>	5.500	4.00 <i>0.157</i>	Carbon Steel	Carbon Steel, HRC 55...60	Black Oxide	1.250 <i>0.049</i>
# SS080M-0262-CS-RB	M8x1.25 (8mm Standard)	26.2 <i>1.031</i>	5.500	4.00 <i>0.157</i>	Carbon Steel	Carbon Steel, HRC 55...60	Black Oxide	1.250 <i>0.049</i>

Indicates item not stocked at time of printing - Please enquire for lead time

Page 5 of 7

E&OE Pricing and all details subject to change without notice - Copyright Miniature Bearings Australia Pty Ltd

MBA Size Listings are a guide to sizes only and must not be solely relied on for critical design information.

Socket Set Screws - Rolling Ball Tip - Carbon Steel

Part Number	Thread Size	Overall Length (L) mm <i>inches</i>	Ball Diameter (D)	Hex Key Size (s) mm <i>inches</i>	Body material	Ball material	Finish	Pitch mm <i>inches</i>
# SS080M-0312-CS-RB	M8x1.25 (8mm Standard)	31.2 <i>1.228</i>	5.500	4.00 <i>0.157</i>	Carbon Steel	Carbon Steel, HRC 55...60	Black Oxide	1.250 <i>0.049</i>
# SS100M-0137-CS-RB	M10x1.5 (10mm Standard)	13.7 <i>0.539</i>	7.000	5.00 <i>0.197</i>	Carbon Steel	Carbon Steel, HRC 55...60	Black Oxide	1.500 <i>0.059</i>
# SS100M-0177-CS-RB	M10x1.5 (10mm Standard)	17.7 <i>0.697</i>	7.000	5.00 <i>0.197</i>	Carbon Steel	Carbon Steel, HRC 55...60	Black Oxide	1.500 <i>0.059</i>
SS100M-0217-CS-RB	M10x1.5 (10mm Standard)	21.7 <i>0.854</i>	7.000	5.00 <i>0.197</i>	Carbon Steel	Carbon Steel, HRC 55...60	Black Oxide	1.500 <i>0.059</i>
SS100M-0267-CS-RB	M10x1.5 (10mm Standard)	26.7 <i>1.051</i>	7.000	5.00 <i>0.197</i>	Carbon Steel	Carbon Steel, HRC 55...60	Black Oxide	1.500 <i>0.059</i>
# SS100M-0367-CS-RB	M10x1.5 (10mm Standard)	36.7 <i>1.445</i>	7.000	5.00 <i>0.197</i>	Carbon Steel	Carbon Steel, HRC 55...60	Black Oxide	1.500 <i>0.059</i>
# SS120M-0180-CS-RB	M12x1.75 (12mm Standard)	18.0 <i>0.709</i>	8.500	6.00 <i>0.236</i>	Carbon Steel	Carbon Steel, HRC 55...60	Black Oxide	1.750 <i>0.069</i>
# SS120M-0220-CS-RB	M12x1.75 (12mm Standard)	22.0 <i>0.866</i>	8.500	6.00 <i>0.236</i>	Carbon Steel	Carbon Steel, HRC 55...60	Black Oxide	1.750 <i>0.069</i>

Indicates item not stocked at time of printing - Please enquire for lead time

Page 6 of 7

E&OE Pricing and all details subject to change without notice - Copyright Miniature Bearings Australia Pty Ltd

MBA Size Listings are a guide to sizes only and must not be solely relied on for critical design information.

Socket Set Screws - Rolling Ball Tip - Carbon Steel

Part Number	Thread Size	Overall Length (L) mm <i>inches</i>	Ball Diameter (D)	Hex Key Size (s) mm <i>inches</i>	Body material	Ball material	Finish	Pitch mm <i>inches</i>
# SS120M-0320-CS-RB	M12x1.75 (12mm Standard)	32.0 <i>1.260</i>	8.500	6.00 <i>0.236</i>	Carbon Steel	Carbon Steel, HRC 55...60	Black Oxide	1.750 <i>0.069</i>
# SS120M-0420-CS-RB	M12x1.75 (12mm Standard)	42.0 <i>1.654</i>	8.500	6.00 <i>0.236</i>	Carbon Steel	Carbon Steel, HRC 55...60	Black Oxide	1.750 <i>0.069</i>
# SS160M-0233-CS-RB	M16x2 (16mm Standard)	23.3 <i>0.917</i>	12.000	8.00 <i>0.315</i>	Carbon Steel	Carbon Steel, HRC 55...60	Black Oxide	2.000 <i>0.079</i>
# SS160M-0283-CS-RB	M16x2 (16mm Standard)	28.3 <i>1.114</i>	12.000	8.00 <i>0.315</i>	Carbon Steel	Carbon Steel, HRC 55...60	Black Oxide	2.000 <i>0.079</i>
SS160M-0383-CS-RB	M16x2 (16mm Standard)	38.3 <i>1.508</i>	12.000	8.00 <i>0.315</i>	Carbon Steel	Carbon Steel, HRC 55...60	Black Oxide	2.000 <i>0.079</i>
# SS160M-0533-CS-RB	M16x2 (16mm Standard)	53.3 <i>2.098</i>	12.000	8.00 <i>0.315</i>	Carbon Steel	Carbon Steel, HRC 55...60	Black Oxide	2.000 <i>0.079</i>

Indicates item not stocked at time of printing - Please enquire for lead time

Page 7 of 7

E&OE Pricing and all details subject to change without notice - Copyright Miniature Bearings Australia Pty Ltd

MBA Size Listings are a guide to sizes only and must not be solely relied on for critical design information.

DISTRIBUTED BY

Distributed By:

