



# Stops - Spring - Flat Face - With Tang

10/4/2018

# Indicates item not stocked at time of printing - Please enquire for lead time

E&OE Pricing and all details subject to change without notice - Copyright Miniature Bearings Australia Pty Ltd

MBA Size Listings are a guide to sizes only and must not be solely relied on for critical design information.

## INFORMATION

Spring stops are used extensively in the locating of parts in jigs and fixtures, particularly where fixture walls are not available. Plunger is case hardened low carbon steel. Properly radiused nose for perfect fit with no wobble. Aluminium body.

Tang prevents thin gauge material from sliding under plunger.

# Indicates item not stocked at time of printing - Please enquire for lead time

E&OE Pricing and all details subject to change without notice - Copyright Miniature Bearings Australia Pty Ltd

MBA Size Listings are a guide to sizes only and must not be solely relied on for critical design information.

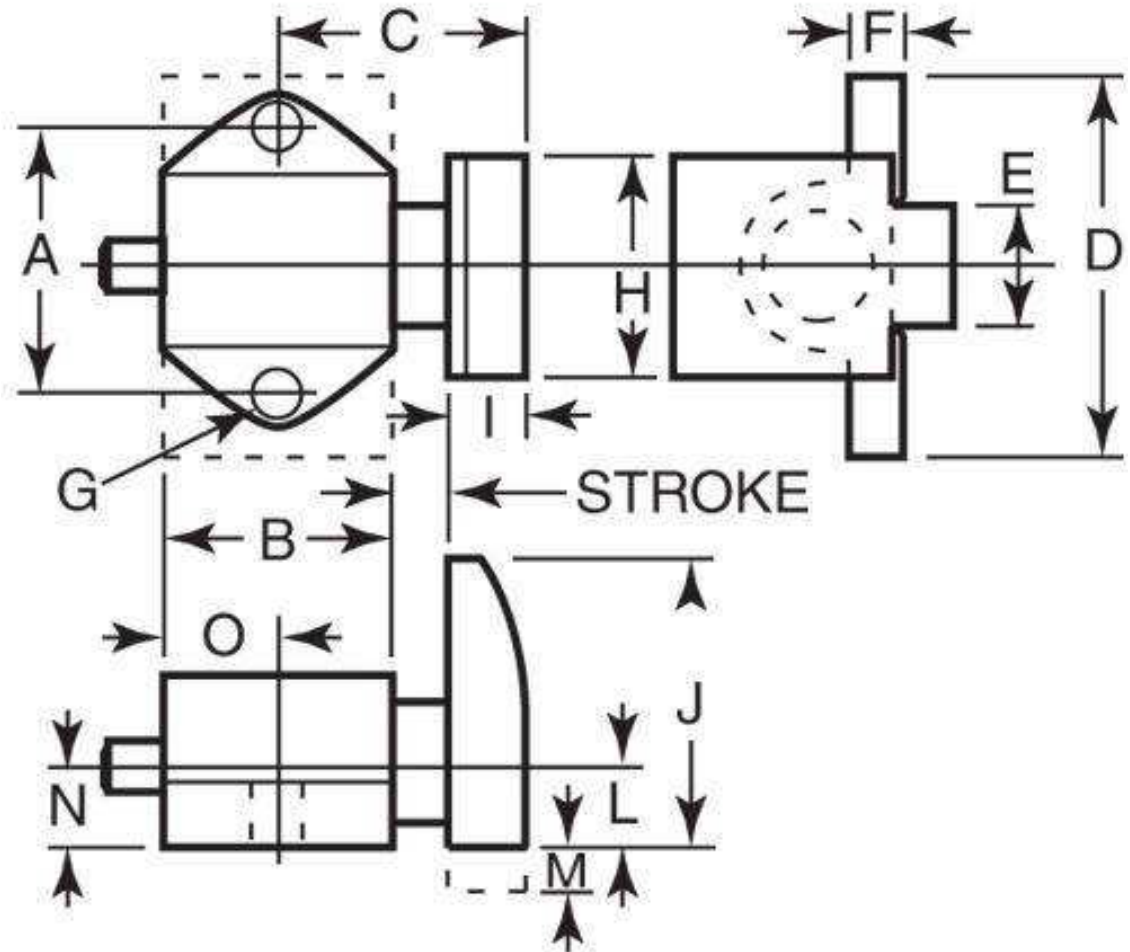

# Indicates item not stocked at time of printing - Please enquire for lead time

E&OE Pricing and all details subject to change without notice - Copyright Miniature Bearings Australia Pty Ltd

MBA Size Listings are a guide to sizes only and must not be solely relied on for critical design information.

## Stops - Spring - Flat Face - With Tang

Part Number	Initial End Force Kg	Final End Force Kg	Stroke mm	A mm	B mm	C mm	D mm	E mm	F mm	G mm
			<i>inches</i>	<i>inches</i>	<i>inches</i>	<i>inches</i>	<i>inches</i>	<i>inches</i>	<i>inches</i>	<i>inches</i>
# DS-6RS	1.02	11.68	4.76 <i>0.187</i>	28.58 <i>1.125</i>	25.40 <i>1.000</i>	23.81 <i>0.937</i>	38.10 <i>1.500</i>	9.53 <i>0.375</i>	6.35 <i>0.250</i>	5.16 <i>0.203</i>
# DS-4RS	2.33	6.61	3.18 <i>0.125</i>	16.67 <i>0.656</i>	17.46 <i>0.687</i>	16.67 <i>0.656</i>	22.23 <i>0.875</i>	6.35 <i>0.250</i>	4.76 <i>0.187</i>	#29
# DS-8RS	7.48	21.55	6.35 <i>0.250</i>	38.10 <i>1.500</i>	34.93 <i>1.375</i>	33.34 <i>1.313</i>	50.80 <i>2.000</i>	12.70 <i>0.500</i>	6.35 <i>0.250</i>	6.75 <i>0.266</i>

# Indicates item not stocked at time of printing - Please enquire for lead time

E&OE Pricing and all details subject to change without notice - Copyright Miniature Bearings Australia Pty Ltd  
MBA Size Listings are a guide to sizes only and must not be solely relied on for critical design information.

DISTRIBUTED BY

Distributed By:

