



Studs - Threaded - Standard

10/4/2018

Indicates item not stocked at time of printing - Please enquire for lead time

E&OE Pricing and all details subject to change without notice - Copyright Miniature Bearings Australia Pty Ltd

MBA Size Listings are a guide to sizes only and must not be solely relied on for critical design information.

INFORMATION

Metric and imperial sizes. Steel and 303 stainless steel.

Yield strength 100,000 PSI

Tensile strength 125,000 PSI

Indicates item not stocked at time of printing - Please enquire for lead time

E&OE Pricing and all details subject to change without notice - Copyright Miniature Bearings Australia Pty Ltd

MBA Size Listings are a guide to sizes only and must not be solely relied on for critical design information.

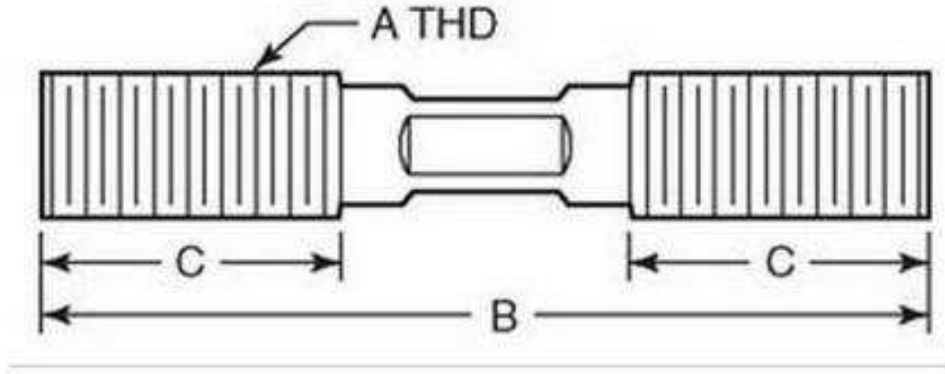

Indicates item not stocked at time of printing - Please enquire for lead time

E&OE Pricing and all details subject to change without notice - Copyright Miniature Bearings Australia Pty Ltd

MBA Size Listings are a guide to sizes only and must not be solely relied on for critical design information.

Studs - Threaded - Standard

Part Number	Thread	Length (L) mm <i>inches</i>	Material	Thread Length (A) mm <i>inches</i>	Thread Length (B) mm <i>inches</i>	Hardness
# SUS300RS	M6x1 (6mm Standard)	32.00 <i>1.260</i>	Steel with Rolled Threads	9 <i>0.354</i>	16 <i>0.630</i>	Class 10.9
# SUS305RS	M6x1 (6mm Standard)	40.00 <i>1.575</i>	Steel with Rolled Threads	9 <i>0.354</i>	20 <i>0.787</i>	Class 10.9
# SUS310RS	M6x1 (6mm Standard)	50.00 <i>1.969</i>	Steel with Rolled Threads	9 <i>0.354</i>	30 <i>1.181</i>	Class 10.9
# SUS103RS	M6x1 (6mm Standard)	63.00 <i>2.480</i>	Steel with Rolled Threads	9 <i>0.354</i>	40 <i>1.575</i>	Class 10.9
# SUS104RS	M6x1 (6mm Standard)	80.00 <i>3.150</i>	Steel with Rolled Threads	9 <i>0.354</i>	50 <i>1.969</i>	Class 10.9
# SUS70RS	1/4-20 UNC (6.35mm)	76.20 <i>3.000</i>	Stress Proof Steel to ASTMA311 Class B	25.40 <i>1.000</i>	25.40 <i>1.000</i>	
# SUS270RS	1/4-20 UNC (6.35mm)	76.20 <i>3.000</i>	303 Stainless Steel	25.40 <i>1.000</i>	25.40 <i>1.000</i>	
# SUS71RS	1/4-20 UNC (6.35mm)	101.60 <i>4.000</i>	Stress Proof Steel to ASTMA311 Class B	25.40 <i>1.000</i>	25.40 <i>1.000</i>	
# SUS72RS	1/4-20 UNC (6.35mm)	127.00 <i>5.000</i>	Stress Proof Steel to ASTMA311 Class B	31.75 <i>1.250</i>	31.75 <i>1.250</i>	

Indicates item not stocked at time of printing - Please enquire for lead time

Page 4 of 17

E&OE Pricing and all details subject to change without notice - Copyright Miniature Bearings Australia Pty Ltd
MBA Size Listings are a guide to sizes only and must not be solely relied on for critical design information.

Studs - Threaded - Standard

Part Number	Thread	Length (L) mm <i>inches</i>	Material	Thread Length (A) mm <i>inches</i>	Thread Length (B) mm <i>inches</i>	Hardness
# SUS1RS	5/16-18 UNC (7.938mm)	76.20 <i>3.000</i>	Stress Proof Steel to ASTMA311 Class B	28.58 <i>1.125</i>	28.58 <i>1.125</i>	
# SUS201RS	5/16-18 UNC (7.938mm)	76.20 <i>3.000</i>	303 Stainless Steel	28.58 <i>1.125</i>	28.58 <i>1.125</i>	
# SUS2RS	5/16-18 UNC (7.938mm)	101.60 <i>4.000</i>	Stress Proof Steel to ASTMA311 Class B	28.58 <i>1.125</i>	28.58 <i>1.125</i>	
# SUS202RS	5/16-18 UNC (7.938mm)	101.60 <i>4.000</i>	303 Stainless Steel	28.58 <i>1.125</i>	28.58 <i>1.125</i>	
# SUS3RS	5/16-18 UNC (7.938mm)	127.00 <i>5.000</i>	Stress Proof Steel to ASTMA311 Class B	28.58 <i>1.125</i>	28.58 <i>1.125</i>	
# SUS4RS	5/16-18 UNC (7.938mm)	152.40 <i>6.000</i>	Stress Proof Steel to ASTMA311 Class B	28.58 <i>1.125</i>	28.58 <i>1.125</i>	
# SUS5RS	5/16-18 UNC (7.938mm)	177.80 <i>7.000</i>	Stress Proof Steel to ASTMA311 Class B	28.58 <i>1.125</i>	28.58 <i>1.125</i>	
# SUS6RS	5/16-18 UNC (7.938mm)	203.20 <i>8.000</i>	Stress Proof Steel to ASTMA311 Class B	28.58 <i>1.125</i>	28.58 <i>1.125</i>	
# SUS315RS	M8x1.25 (8mm Standard)	40.00 <i>1.575</i>	Steel with Rolled Threads	11 <i>0.433</i>	20 <i>0.787</i>	Class 10.9

Indicates item not stocked at time of printing - Please enquire for lead time

Page 5 of 17

E&OE Pricing and all details subject to change without notice - Copyright Miniature Bearings Australia Pty Ltd

MBA Size Listings are a guide to sizes only and must not be solely relied on for critical design information.

Studs - Threaded - Standard

Part Number	Thread	Length (L) mm <i>inches</i>	Material	Thread Length (A) mm <i>inches</i>	Thread Length (B) mm <i>inches</i>	Hardness
# SUS106RS	M8x1.25 (8mm Standard)	63.00 <i>2.480</i>	Steel with Rolled Threads	11 <i>0.433</i>	40 <i>1.575</i>	Class 10.9
# SUS320RS	M8x1.25 (8mm Standard)	80.00 <i>3.150</i>	Steel with Rolled Threads	11 <i>0.433</i>	50 <i>1.969</i>	Class 10.9
# SUS108RS	M8x1.25 (8mm Standard)	100.00 <i>3.937</i>	Steel with Rolled Threads	11 <i>0.433</i>	63 <i>2.480</i>	Class 10.9
# SUS325RS	M8x1.25 (8mm Standard)	125.00 <i>4.921</i>	Steel with Rolled Threads	11 <i>0.433</i>	75 <i>2.953</i>	Class 10.9
# SUS109RS	M8x1.25 (8mm Standard)	160.00 <i>6.299</i>	Steel with Rolled Threads	11 <i>0.433</i>	100 <i>3.937</i>	Class 10.9
# SUS7RS	3/8-16 UNC (9.525mm)	76.20 <i>3.000</i>	Stress Proof Steel to ASTMA311 Class B	31.75 <i>1.250</i>	31.75 <i>1.250</i>	
# SUS207RS	3/8-16 UNC (9.525mm)	76.20 <i>3.000</i>	303 Stainless Steel	31.75 <i>1.250</i>	31.75 <i>1.250</i>	
# SUS8RS	3/8-16 UNC (9.525mm)	101.60 <i>4.000</i>	Stress Proof Steel to ASTMA311 Class B	31.75 <i>1.250</i>	31.75 <i>1.250</i>	
# SUS208RS	3/8-16 UNC (9.525mm)	101.60 <i>4.000</i>	303 Stainless Steel	31.75 <i>1.250</i>	31.75 <i>1.250</i>	

Indicates item not stocked at time of printing - Please enquire for lead time

Page 6 of 17

E&OE Pricing and all details subject to change without notice - Copyright Miniature Bearings Australia Pty Ltd
MBA Size Listings are a guide to sizes only and must not be solely relied on for critical design information.

Studs - Threaded - Standard

Part Number	Thread	Length (L) mm <i>inches</i>	Material	Thread Length (A) mm <i>inches</i>	Thread Length (B) mm <i>inches</i>	Hardness
# SUS9RS	3/8-16 UNC (9.525mm)	127.00 <i>5.000</i>	Stress Proof Steel to ASTMA311 Class B	31.75 <i>1.250</i>	31.75 <i>1.250</i>	
# SUS209RS	3/8-16 UNC (9.525mm)	127.00 <i>5.000</i>	303 Stainless Steel	31.75 <i>1.250</i>	31.75 <i>1.250</i>	
# SUS10RS	3/8-16 UNC (9.525mm)	152.40 <i>6.000</i>	Stress Proof Steel to ASTMA311 Class B	31.75 <i>1.250</i>	31.75 <i>1.250</i>	
# SUS11RS	3/8-16 UNC (9.525mm)	177.80 <i>7.000</i>	Stress Proof Steel to ASTMA311 Class B	31.75 <i>1.250</i>	31.75 <i>1.250</i>	
# SUS12RS	3/8-16 UNC (9.525mm)	203.20 <i>8.000</i>	Stress Proof Steel to ASTMA311 Class B	31.75 <i>1.250</i>	31.75 <i>1.250</i>	
# SUS212RS	3/8-16 UNC (9.525mm)	203.20 <i>8.000</i>	303 Stainless Steel	31.75 <i>1.250</i>	31.75 <i>1.250</i>	
# SUS330RS	M10x1.5 (10mm Standard)	50.00 <i>1.969</i>	Steel with Rolled Threads	13 <i>0.512</i>	25 <i>0.984</i>	Class 10.9
# SUS111RS	M10x1.5 (10mm Standard)	80.00 <i>3.150</i>	Steel with Rolled Threads	13 <i>0.512</i>	50 <i>1.969</i>	Class 10.9
# SUS112RS	M10x1.5 (10mm Standard)	100.00 <i>3.937</i>	Steel with Rolled Threads	13 <i>0.512</i>	75 <i>2.953</i>	Class 10.9

Indicates item not stocked at time of printing - Please enquire for lead time

Page 7 of 17

E&OE Pricing and all details subject to change without notice - Copyright Miniature Bearings Australia Pty Ltd
MBA Size Listings are a guide to sizes only and must not be solely relied on for critical design information.

Studs - Threaded - Standard

Part Number	Thread	Length (L) mm <i>inches</i>	Material	Thread Length (A) mm <i>inches</i>	Thread Length (B) mm <i>inches</i>	Hardness
# SUS114RS	M10x1.5 (10mm Standard)	160.00 <i>6.299</i>	Steel with Rolled Threads	13 <i>0.512</i>	100 <i>3.937</i>	Class 10.9
# SUS340RS	M12x1.75 (12mm Standard)	50.00 <i>1.969</i>	Steel with Rolled Threads	15 <i>0.591</i>	25 <i>0.984</i>	Class 10.9
# SUS345RS	M12x1.75 (12mm Standard)	63.00 <i>2.480</i>	Steel with Rolled Threads	15 <i>0.591</i>	32 <i>1.260</i>	Class 10.9
# SUS118RS	M12x1.75 (12mm Standard)	80.00 <i>3.150</i>	Steel with Rolled Threads	15 <i>0.591</i>	50 <i>1.969</i>	Class 10.9
# SUS119RS	M12x1.75 (12mm Standard)	100.00 <i>3.937</i>	Steel with Rolled Threads	15 <i>0.591</i>	63 <i>2.480</i>	Class 10.9
# SUS120RS	M12x1.75 (12mm Standard)	125.00 <i>4.921</i>	Steel with Rolled Threads	15 <i>0.591</i>	75 <i>2.953</i>	Class 10.9
# SUS121RS	M12x1.75 (12mm Standard)	160.00 <i>6.299</i>	Steel with Rolled Threads	15 <i>0.591</i>	100 <i>3.937</i>	Class 10.9
# SUS350RS	M12x1.75 (12mm Standard)	200.00 <i>7.874</i>	Steel with Rolled Threads	15 <i>0.591</i>	125 <i>4.921</i>	Class 10.9

Indicates item not stocked at time of printing - Please enquire for lead time

Page 8 of 17

E&OE Pricing and all details subject to change without notice - Copyright Miniature Bearings Australia Pty Ltd
MBA Size Listings are a guide to sizes only and must not be solely relied on for critical design information.

Studs - Threaded - Standard

Part Number	Thread	Length (L) mm <i>inches</i>	Material	Thread Length (A) mm <i>inches</i>	Thread Length (B) mm <i>inches</i>	Hardness
# SUS13RS	1/2-13 UNC (12.7mm)	76.20 <i>3.000</i>	Stress Proof Steel to ASTMA311 Class B	38.10 <i>1.500</i>	38.10 <i>1.500</i>	
# SUS14RS	1/2-13 UNC (12.7mm)	101.60 <i>4.000</i>	Stress Proof Steel to ASTMA311 Class B	38.10 <i>1.500</i>	38.10 <i>1.500</i>	
# SUS214RS	1/2-13 UNC (12.7mm)	101.60 <i>4.000</i>	303 Stainless Steel	38.10 <i>1.500</i>	38.10 <i>1.500</i>	
# SUS15RS	1/2-13 UNC (12.7mm)	127.00 <i>5.000</i>	Stress Proof Steel to ASTMA311 Class B	38.10 <i>1.500</i>	38.10 <i>1.500</i>	
# SUS215RS	1/2-13 UNC (12.7mm)	127.00 <i>5.000</i>	303 Stainless Steel	38.10 <i>1.500</i>	38.10 <i>1.500</i>	
# SUS16RS	1/2-13 UNC (12.7mm)	152.40 <i>6.000</i>	Stress Proof Steel to ASTMA311 Class B	38.10 <i>1.500</i>	38.10 <i>1.500</i>	
# SUS216RS	1/2-13 UNC (12.7mm)	152.40 <i>6.000</i>	303 Stainless Steel	38.10 <i>1.500</i>	38.10 <i>1.500</i>	
# SUS17RS	1/2-13 UNC (12.7mm)	177.80 <i>7.000</i>	Stress Proof Steel to ASTMA311 Class B	38.10 <i>1.500</i>	38.10 <i>1.500</i>	
SUS18RS	1/2-13 UNC (12.7mm)	203.20 <i>8.000</i>	Stress Proof Steel to ASTMA311 Class B	38.10 <i>1.500</i>	38.10 <i>1.500</i>	

Indicates item not stocked at time of printing - Please enquire for lead time

Page 9 of 17

E&OE Pricing and all details subject to change without notice - Copyright Miniature Bearings Australia Pty Ltd
MBA Size Listings are a guide to sizes only and must not be solely relied on for critical design information.

Studs - Threaded - Standard

Part Number	Thread	Length (L) mm <i>inches</i>	Material	Thread Length (A) mm <i>inches</i>	Thread Length (B) mm <i>inches</i>	Hardness
# SUS218RS	1/2-13 UNC (12.7mm)	203.20 <i>8.000</i>	303 Stainless Steel	38.10 <i>1.500</i>	38.10 <i>1.500</i>	
# SUS19RS	1/2-13 UNC (12.7mm)	228.60 <i>9.000</i>	Stress Proof Steel to ASTMA311 Class B	38.10 <i>1.500</i>	38.10 <i>1.500</i>	
# SUS20RS	1/2-13 UNC (12.7mm)	254.00 <i>10.000</i>	Stress Proof Steel to ASTMA311 Class B	50.80 <i>2.000</i>	50.80 <i>2.000</i>	
# SUS21RS	1/2-13 UNC (12.7mm)	304.80 <i>12.000</i>	Stress Proof Steel to ASTMA311 Class B	50.80 <i>2.000</i>	50.80 <i>2.000</i>	
# SUS22RS	1/2-13 UNC (12.7mm)	355.60 <i>14.000</i>	Stress Proof Steel to ASTMA311 Class B	50.80 <i>2.000</i>	50.80 <i>2.000</i>	
# SUS23RS	5/8-11 UNC (15.875mm)	76.20 <i>3.000</i>	Stress Proof Steel to ASTMA311 Class B	50.80 <i>2.000</i>	50.80 <i>2.000</i>	
# SUS24RS	5/8-11 UNC (15.875mm)	101.60 <i>4.000</i>	Stress Proof Steel to ASTMA311 Class B	44.45 <i>1.750</i>	44.45 <i>1.750</i>	
# SUS224RS	5/8-11 UNC (15.875mm)	101.60 <i>4.000</i>	303 Stainless Steel	44.45 <i>1.750</i>	44.45 <i>1.750</i>	

Indicates item not stocked at time of printing - Please enquire for lead time

Page 10 of 17

E&OE Pricing and all details subject to change without notice - Copyright Miniature Bearings Australia Pty Ltd
MBA Size Listings are a guide to sizes only and must not be solely relied on for critical design information.

Studs - Threaded - Standard

Part Number	Thread	Length (L) mm <i>inches</i>	Material	Thread Length (A) mm <i>inches</i>	Thread Length (B) mm <i>inches</i>	Hardness
# SUS25RS	5/8-11 UNC (15.875mm)	127.00 <i>5.000</i>	Stress Proof Steel to ASTMA311 Class B	44.45 <i>1.750</i>	44.45 <i>1.750</i>	
# SUS225RS	5/8-11 UNC (15.875mm)	127.00 <i>5.000</i>	303 Stainless Steel	44.45 <i>1.750</i>	44.45 <i>1.750</i>	
# SUS26RS	5/8-11 UNC (15.875mm)	152.40 <i>6.000</i>	Stress Proof Steel to ASTMA311 Class B	44.45 <i>1.750</i>	44.45 <i>1.750</i>	
# SUS226RS	5/8-11 UNC (15.875mm)	152.40 <i>6.000</i>	303 Stainless Steel	44.45 <i>1.750</i>	44.45 <i>1.750</i>	
# SUS27RS	5/8-11 UNC (15.875mm)	177.80 <i>7.000</i>	Stress Proof Steel to ASTMA311 Class B	44.45 <i>1.750</i>	44.45 <i>1.750</i>	
# SUS28RS	5/8-11 UNC (15.875mm)	203.20 <i>8.000</i>	Stress Proof Steel to ASTMA311 Class B	44.45 <i>1.750</i>	44.45 <i>1.750</i>	
# SUS29RS	5/8-11 UNC (15.875mm)	228.60 <i>9.000</i>	Stress Proof Steel to ASTMA311 Class B	50.80 <i>2.000</i>	50.80 <i>2.000</i>	
# SUS30RS	5/8-11 UNC (15.875mm)	254.00 <i>10.000</i>	Stress Proof Steel to ASTMA311 Class B	50.80 <i>2.000</i>	50.80 <i>2.000</i>	

Indicates item not stocked at time of printing - Please enquire for lead time

Page 11 of 17

E&OE Pricing and all details subject to change without notice - Copyright Miniature Bearings Australia Pty Ltd
MBA Size Listings are a guide to sizes only and must not be solely relied on for critical design information.

Studs - Threaded - Standard

Part Number	Thread	Length (L) mm <i>inches</i>	Material	Thread Length (A) mm <i>inches</i>	Thread Length (B) mm <i>inches</i>	Hardness
# SUS31RS	5/8-11 UNC (15.875mm)	304.80 <i>12.000</i>	Stress Proof Steel to ASTMA311 Class B	50.80 <i>2.000</i>	50.80 <i>2.000</i>	
# SUS32RS	5/8-11 UNC (15.875mm)	355.60 <i>14.000</i>	Stress Proof Steel to ASTMA311 Class B	50.80 <i>2.000</i>	50.80 <i>2.000</i>	
# SUS355RS	M16x2 (16mm Standard)	63.00 <i>2.480</i>	Steel with Rolled Threads	19 <i>0.748</i>	32 <i>1.260</i>	Class 8.8
# SUS365RS	M16x2 (16mm Standard)	100.00 <i>3.937</i>	Steel with Rolled Threads	19 <i>0.748</i>	63 <i>2.480</i>	Class 8.8
# SUS131RS	M16x2 (16mm Standard)	125.00 <i>4.921</i>	Steel with Rolled Threads	19 <i>0.748</i>	75 <i>2.953</i>	Class 8.8
# SUS132RS	M16x2 (16mm Standard)	160.00 <i>6.299</i>	Steel with Rolled Threads	19 <i>0.748</i>	100 <i>3.937</i>	Class 8.8
# SUS133RS	M16x2 (16mm Standard)	200.00 <i>7.874</i>	Steel with Rolled Threads	19 <i>0.748</i>	125 <i>4.921</i>	Class 8.8
# SUS370RS	M16x2 (16mm Standard)	250.00 <i>9.843</i>	Steel with Rolled Threads	19 <i>0.748</i>	160 <i>6.299</i>	Class 8.8
# SUS375RS	M16x2 (16mm Standard)	315.00 <i>12.402</i>	Steel with Rolled Threads	19 <i>0.748</i>	180 <i>7.087</i>	Class 8.8

Indicates item not stocked at time of printing - Please enquire for lead time

Page 12 of 17

E&OE Pricing and all details subject to change without notice - Copyright Miniature Bearings Australia Pty Ltd
MBA Size Listings are a guide to sizes only and must not be solely relied on for critical design information.

Studs - Threaded - Standard

Part Number	Thread	Length (L) mm <i>inches</i>	Material	Thread Length (A) mm <i>inches</i>	Thread Length (B) mm <i>inches</i>	Hardness
# SUS34RS	3/4-10 UNC (19.05mm)	76.20 <i>3.000</i>	Stress Proof Steel to ASTMA311 Class B	50.80 <i>2.000</i>	50.80 <i>2.000</i>	
# SUS35RS	3/4-10 UNC (19.05mm)	101.60 <i>4.000</i>	Stress Proof Steel to ASTMA311 Class B	50.80 <i>2.000</i>	50.80 <i>2.000</i>	
# SUS36RS	3/4-10 UNC (19.05mm)	127.00 <i>5.000</i>	Stress Proof Steel to ASTMA311 Class B	50.80 <i>2.000</i>	50.80 <i>2.000</i>	
# SUS37RS	3/4-10 UNC (19.05mm)	152.40 <i>6.000</i>	Stress Proof Steel to ASTMA311 Class B	50.80 <i>2.000</i>	50.80 <i>2.000</i>	
# SUS38RS	3/4-10 UNC (19.05mm)	177.80 <i>7.000</i>	Stress Proof Steel to ASTMA311 Class B	50.80 <i>2.000</i>	50.80 <i>2.000</i>	
# SUS39RS	3/4-10 UNC (19.05mm)	203.20 <i>8.000</i>	Stress Proof Steel to ASTMA311 Class B	50.80 <i>2.000</i>	50.80 <i>2.000</i>	
# SUS40RS	3/4-10 UNC (19.05mm)	228.60 <i>9.000</i>	Stress Proof Steel to ASTMA311 Class B	50.80 <i>2.000</i>	50.80 <i>2.000</i>	
# SUS41RS	3/4-10 UNC (19.05mm)	254.00 <i>10.000</i>	Stress Proof Steel to ASTMA311 Class B	50.80 <i>2.000</i>	50.80 <i>2.000</i>	

Indicates item not stocked at time of printing - Please enquire for lead time

Page 13 of 17

E&OE Pricing and all details subject to change without notice - Copyright Miniature Bearings Australia Pty Ltd
MBA Size Listings are a guide to sizes only and must not be solely relied on for critical design information.

Studs - Threaded - Standard

Part Number	Thread	Length (L) mm <i>inches</i>	Material	Thread Length (A) mm <i>inches</i>	Thread Length (B) mm <i>inches</i>	Hardness
# SUS42RS	3/4-10 UNC (19.05mm)	304.80 <i>12.000</i>	Stress Proof Steel to ASTMA311 Class B	50.80 <i>2.000</i>	50.80 <i>2.000</i>	
# SUS43RS	3/4-10 UNC (19.05mm)	355.60 <i>14.000</i>	Stress Proof Steel to ASTMA311 Class B	50.80 <i>2.000</i>	50.80 <i>2.000</i>	
# SUS44RS	3/4-10 UNC (19.05mm)	406.40 <i>16.000</i>	Stress Proof Steel to ASTMA311 Class B	50.80 <i>2.000</i>	50.80 <i>2.000</i>	
# SUS380RS	M20x2.5 (20mm Standard)	80.00 <i>3.150</i>	Steel with Rolled Threads	27 <i>1.063</i>	32 <i>1.260</i>	Class 8.8
# SUS400RS	M20x2.5 (20mm Standard)	500.00 <i>19.685</i>	Steel with Rolled Threads	27 <i>1.063</i>	315 <i>12.402</i>	Class 8.8
# SUS45RS	7/8-9 UNC (22.225mm)	76.20 <i>3.000</i>	Stress Proof Steel to ASTMA311 Class B	57.15 <i>2.250</i>	57.15 <i>2.250</i>	
# SUS46RS	7/8-9 UNC (22.225mm)	101.60 <i>4.000</i>	Stress Proof Steel to ASTMA311 Class B	57.15 <i>2.250</i>	57.15 <i>2.250</i>	
# SUS47RS	7/8-9 UNC (22.225mm)	127.00 <i>5.000</i>	Stress Proof Steel to ASTMA311 Class B	57.15 <i>2.250</i>	57.15 <i>2.250</i>	

Indicates item not stocked at time of printing - Please enquire for lead time

Page 14 of 17

E&OE Pricing and all details subject to change without notice - Copyright Miniature Bearings Australia Pty Ltd
MBA Size Listings are a guide to sizes only and must not be solely relied on for critical design information.

Studs - Threaded - Standard

Part Number	Thread	Length (L) mm <i>inches</i>	Material	Thread Length (A) mm <i>inches</i>	Thread Length (B) mm <i>inches</i>	Hardness
# SUS48RS	7/8-9 UNC (22.225mm)	152.40 <i>6.000</i>	Stress Proof Steel to ASTMA311 Class B	57.15 <i>2.250</i>	57.15 <i>2.250</i>	
# SUS49RS	7/8-9 UNC (22.225mm)	177.80 <i>7.000</i>	Stress Proof Steel to ASTMA311 Class B	57.15 <i>2.250</i>	57.15 <i>2.250</i>	
# SUS50RS	7/8-9 UNC (22.225mm)	203.20 <i>8.000</i>	Stress Proof Steel to ASTMA311 Class B	57.15 <i>2.250</i>	57.15 <i>2.250</i>	
# SUS51RS	7/8-9 UNC (22.225mm)	228.60 <i>9.000</i>	Stress Proof Steel to ASTMA311 Class B	57.15 <i>2.250</i>	57.15 <i>2.250</i>	
# SUS52RS	7/8-9 UNC (22.225mm)	254.00 <i>10.000</i>	Stress Proof Steel to ASTMA311 Class B	57.15 <i>2.250</i>	57.15 <i>2.250</i>	
# SUS53RS	7/8-9 UNC (22.225mm)	304.80 <i>12.000</i>	Stress Proof Steel to ASTMA311 Class B	57.15 <i>2.250</i>	57.15 <i>2.250</i>	
# SUS54RS	7/8-9 UNC (22.225mm)	355.60 <i>14.000</i>	Stress Proof Steel to ASTMA311 Class B	57.15 <i>2.250</i>	57.15 <i>2.250</i>	
# SUS55RS	7/8-9 UNC (22.225mm)	406.40 <i>16.000</i>	Stress Proof Steel to ASTMA311 Class B	57.15 <i>2.250</i>	57.15 <i>2.250</i>	

Indicates item not stocked at time of printing - Please enquire for lead time

Page 15 of 17

E&OE Pricing and all details subject to change without notice - Copyright Miniature Bearings Australia Pty Ltd
MBA Size Listings are a guide to sizes only and must not be solely relied on for critical design information.

Studs - Threaded - Standard

Part Number	Thread	Length (L) mm <i>inches</i>	Material	Thread Length (A) mm <i>inches</i>	Thread Length (B) mm <i>inches</i>	Hardness
# SUS410RS	M24x3 (24mm Standard)	125.00 <i>4.921</i>	Steel with Rolled Threads	35 <i>1.378</i>	70 <i>2.756</i>	Class 8.8
# SUS57RS	1-8 UNC (25.4mm)	101.60 <i>4.000</i>	Stress Proof Steel to ASTMA311 Class B	63.50 <i>2.500</i>	63.50 <i>2.500</i>	
# SUS58RS	1-8 UNC (25.4mm)	127.00 <i>5.000</i>	Stress Proof Steel to ASTMA311 Class B	63.50 <i>2.500</i>	63.50 <i>2.500</i>	
# SUS59RS	1-8 UNC (25.4mm)	152.40 <i>6.000</i>	Stress Proof Steel to ASTMA311 Class B	63.50 <i>2.500</i>	63.50 <i>2.500</i>	
# SUS60RS	1-8 UNC (25.4mm)	177.80 <i>7.000</i>	Stress Proof Steel to ASTMA311 Class B	63.50 <i>2.500</i>	63.50 <i>2.500</i>	
# SUS61RS	1-8 UNC (25.4mm)	203.20 <i>8.000</i>	Stress Proof Steel to ASTMA311 Class B	63.50 <i>2.500</i>	63.50 <i>2.500</i>	
# SUS62RS	1-8 UNC (25.4mm)	228.60 <i>9.000</i>	Stress Proof Steel to ASTMA311 Class B	63.50 <i>2.500</i>	63.50 <i>2.500</i>	
# SUS63RS	1-8 UNC (25.4mm)	254.00 <i>10.000</i>	Stress Proof Steel to ASTMA311 Class B	63.50 <i>2.500</i>	63.50 <i>2.500</i>	

Indicates item not stocked at time of printing - Please enquire for lead time

Page 16 of 17

E&OE Pricing and all details subject to change without notice - Copyright Miniature Bearings Australia Pty Ltd

MBA Size Listings are a guide to sizes only and must not be solely relied on for critical design information.

Studs - Threaded - Standard

Part Number	Thread	Length (L) mm	Material	Thread Length (A) mm	Thread Length (B) mm	Hardness
		<i>inches</i>		<i>inches</i>	<i>inches</i>	
# SUS64RS	1-8 UNC (25.4mm)	304.80	Stress Proof Steel to ASTMA311 Class B	63.50	63.50	
		<i>12.000</i>		<i>2.500</i>	<i>2.500</i>	
# SUS65RS	1-8 UNC (25.4mm)	355.60	Stress Proof Steel to ASTMA311 Class B	63.50	63.50	
		<i>14.000</i>		<i>2.500</i>	<i>2.500</i>	

Indicates item not stocked at time of printing - Please enquire for lead time

E&OE Pricing and all details subject to change without notice - Copyright Miniature Bearings Australia Pty Ltd

MBA Size Listings are a guide to sizes only and must not be solely relied on for critical design information.

DISTRIBUTED BY

Distributed By:

