



Washers - Spring - Curved - Stainless Steel

10/4/2018

Indicates item not stocked at time of printing - Please enquire for lead time

E&OE Pricing and all details subject to change without notice - Copyright Miniature Bearings Australia Pty Ltd

MBA Size Listings are a guide to sizes only and must not be solely relied on for critical design information.

Page 1 of 9

INFORMATION

Wave Washers - All Materials.

ID and OD are long axis dimensions

Indicates item not stocked at time of printing - Please enquire for lead time

E&OE Pricing and all details subject to change without notice - Copyright Miniature Bearings Australia Pty Ltd

MBA Size Listings are a guide to sizes only and must not be solely relied on for critical design information.

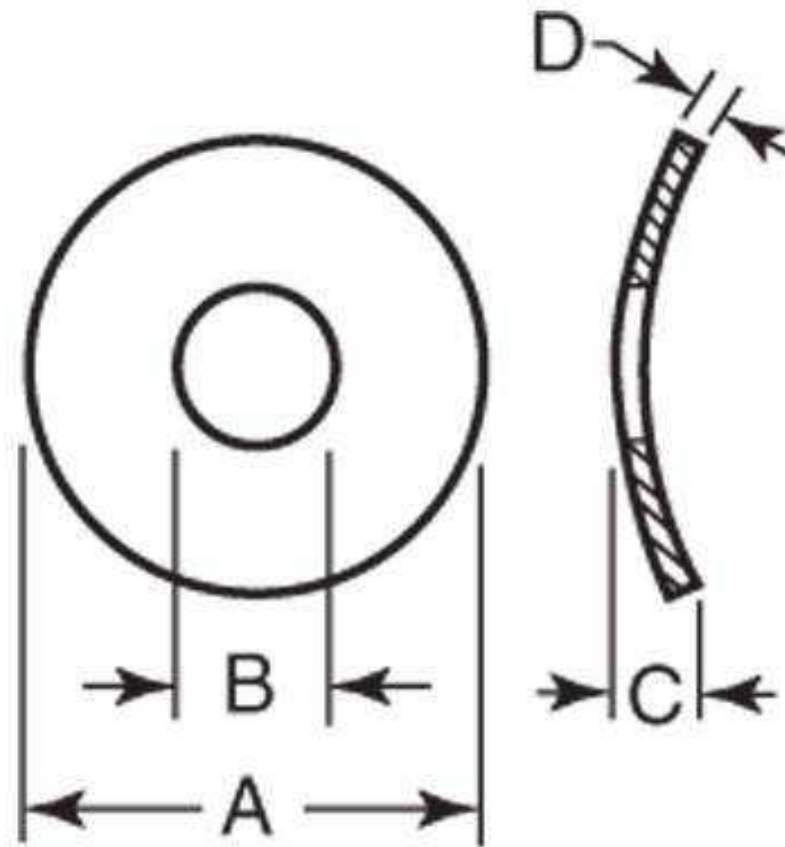

Indicates item not stocked at time of printing - Please enquire for lead time

E&OE Pricing and all details subject to change without notice - Copyright Miniature Bearings Australia Pty Ltd

MBA Size Listings are a guide to sizes only and must not be solely relied on for critical design information.

Washers - Spring - Curved - Stainless Steel

Part Number	Nom. ID (B) mm <i>inches</i>	Nom. OD (A) mm <i>inches</i>	Nom. Height (C) mm <i>inches</i>	Thickness (D) mm <i>inches</i>	Info	Material	Type	Nominal Screw Size mm <i>inches</i>
W0022-T-005-006-WC-S2	2.184 <i>0.086</i>	5.46 <i>0.215</i>	0.64 <i>0.025</i>	0.14 <i>0.006</i>		302 Stainless	Curved	-
# W0022-T-005-007-WC-S2	2.184 <i>0.086</i>	5.46 <i>0.215</i>	0.71 <i>0.028</i>	0.11 <i>0.004</i>		302 Stainless	Curved	-
# W0032-T-006-009-WC-S2	3.175 <i>0.125</i>	6.22 <i>0.245</i>	0.86 <i>0.034</i>	0.15 <i>0.006</i>		301 Stainless	Curved DIN 137 Type A	No5
# W0032-T-006-012-WC-S2	3.175 <i>0.125</i>	6.22 <i>0.245</i>	1.24 <i>0.049</i>	0.10 <i>0.004</i>		302 Stainless	Curved	-
# W0032-T-007-007-WC-S2	3.175 <i>0.125</i>	6.86 <i>0.270</i>	0.74 <i>0.029</i>	0.19 <i>0.007</i>		302 Stainless	Curved	-
# W0032-T-007-010-WC-S2	3.175 <i>0.125</i>	6.86 <i>0.270</i>	0.97 <i>0.038</i>	0.13 <i>0.005</i>		302 Stainless	Curved	-
# W0032-T-008-0086-WC-S2	3.175 <i>0.125</i>	7.8 <i>0.307</i>	0.86 <i>0.034</i>	0.22 <i>0.009</i>		302 Stainless	Curved	-
# W0032-T-008-0094-WC-S2	3.175 <i>0.125</i>	7.8 <i>0.307</i>	0.94 <i>0.037</i>	0.18 <i>0.007</i>		302 Stainless	Curved	-
W0032-T-006-007-WC-S2	3.2 <i>0.126</i>	6.4 <i>0.252</i>	0.71 <i>0.028</i>	0.10 <i>0.004</i>		301 Stainless	Curved DIN 137 Type A	-

Indicates item not stocked at time of printing - Please enquire for lead time

Page 4 of 9

E&OE Pricing and all details subject to change without notice - Copyright Miniature Bearings Australia Pty Ltd

MBA Size Listings are a guide to sizes only and must not be solely relied on for critical design information.

Washers - Spring - Curved - Stainless Steel

Part Number	Nom. ID (B) mm	Nom. OD (A) mm	Nom. Height (C) mm	Thickness (D) mm	Info	Material	Type	Nominal Screw Size mm
	<i>inches</i>	<i>inches</i>	<i>inches</i>	<i>inches</i>				<i>inches</i>
# W0035-T-007-009-WC-S2	3.5 <i>0.138</i>	6.86 <i>0.270</i>	0.89 <i>0.035</i>	0.18 <i>0.007</i>		301 Stainless	Curved DIN 137 Type A	No6
# W0035-T-007-013-WC-S2	3.5 <i>0.138</i>	6.86 <i>0.270</i>	1.32 <i>0.052</i>	0.11 <i>0.004</i>		301 Stainless	Curved DIN 137 Type A	No6
# W0035-T-008-0086-WC-S2	3.5 <i>0.138</i>	8.18 <i>0.322</i>	0.86 <i>0.034</i>	0.25 <i>0.010</i>		302 Stainless	Curved	-
# W0035-T-008-0094-WC-S2	3.5 <i>0.138</i>	8.18 <i>0.322</i>	0.94 <i>0.037</i>	0.21 <i>0.008</i>		302 Stainless	Curved	-
# W0042-T-008-011-WC-S2	4.166 <i>0.164</i>	8.18 <i>0.322</i>	1.07 <i>0.042</i>	0.19 <i>0.007</i>		301 Stainless	Curved DIN 137 Type A	No8
# W0042-T-008-016-WC-S2	4.166 <i>0.164</i>	8.18 <i>0.322</i>	1.63 <i>0.064</i>	0.13 <i>0.005</i>		301 Stainless	Curved DIN 137 Type A	No8
# W0042-T-009-010-WC-S2	4.166 <i>0.164</i>	9.4 <i>0.370</i>	0.99 <i>0.039</i>	0.29 <i>0.011</i>		302 Stainless	Curved	-
# W0042-T-009-011-WC-S2	4.166 <i>0.164</i>	9.4 <i>0.370</i>	1.12 <i>0.044</i>	0.23 <i>0.009</i>		302 Stainless	Curved	-
# W0048-T-008-011-WC-S2	4.762 <i>0.187</i>	8.18 <i>0.322</i>	1.09 <i>0.043</i>	0.17 <i>0.007</i>		302 Stainless	Curved	-

Indicates item not stocked at time of printing - Please enquire for lead time

Page 5 of 9

E&OE Pricing and all details subject to change without notice - Copyright Miniature Bearings Australia Pty Ltd

MBA Size Listings are a guide to sizes only and must not be solely relied on for critical design information.

Washers - Spring - Curved - Stainless Steel

Part Number	Nom. ID (B) mm	Nom. OD (A) mm	Nom. Height (C) mm	Thickness (D) mm	Info	Material	Type	Nominal Screw Size mm
	<i>inches</i>	<i>inches</i>	<i>inches</i>	<i>inches</i>				<i>inches</i>
# W0048-T-008-014-WC-S2	4.762 <i>0.187</i>	8.18 <i>0.322</i>	1.35 <i>0.053</i>	0.13 <i>0.005</i>		302 Stainless	Curved	-
W0048-T-009-018-WC-S2	4.762 <i>0.187</i>	9.4 <i>0.370</i>	1.75 <i>0.069</i>	0.15 <i>0.006</i>		301 Stainless	Curved DIN 137 Type A	No10
W0048-T-009-012-WC-S2	4.8 <i>0.189</i>	9.5 <i>0.374</i>	1.19 <i>0.047</i>	0.23 <i>0.009</i>		301 Stainless	Curved DIN 137 Type A	
# W0048-T-011-012-WC-S2	4.8 <i>0.189</i>	11.1 <i>0.437</i>	1.19 <i>0.047</i>	0.30 <i>0.012</i>		301 Stainless	Curved DIN 137 Type A	
# W0050-T-011-014-WC-S2	5 <i>0.197</i>	10.74 <i>0.423</i>	1.35 <i>0.053</i>	0.25 <i>0.010</i>		301 Stainless	Curved DIN 137 Type A	No12
# W0050-T-011-021-WC-S2	5 <i>0.197</i>	10.74 <i>0.423</i>	2.06 <i>0.081</i>	0.17 <i>0.007</i>		302 Stainless	Curved	-
W0056-T-011-013-WC-S2	5.6 <i>0.220</i>	11.1 <i>0.437</i>	1.35 <i>0.053</i>	0.25 <i>0.010</i>		301 Stainless	Curved DIN 137 Type A	
# W0064-T-011-014-WC-S2	6.35 <i>0.250</i>	10.74 <i>0.423</i>	1.40 <i>0.055</i>	0.21 <i>0.008</i>		302 Stainless	Curved	-
# W0064-T-011-018-WC-S2	6.35 <i>0.250</i>	10.74 <i>0.423</i>	1.78 <i>0.070</i>	0.17 <i>0.007</i>		302 Stainless	Curved	-

Indicates item not stocked at time of printing - Please enquire for lead time

Page 6 of 9

E&OE Pricing and all details subject to change without notice - Copyright Miniature Bearings Australia Pty Ltd

MBA Size Listings are a guide to sizes only and must not be solely relied on for critical design information.

Washers - Spring - Curved - Stainless Steel

Part Number	Nom. ID (B) mm	Nom. OD (A) mm	Nom. Height (C) mm	Thickness (D) mm	Info	Material	Type	Nominal Screw Size mm
	<i>inches</i>	<i>inches</i>	<i>inches</i>	<i>inches</i>				<i>inches</i>
# W0064-T-012-023-WC-S2	6.35	12.45	2.31	0.19		301 Stainless	Curved DIN 137 Type A	1/4
	<i>0.250</i>	<i>0.490</i>	<i>0.091</i>	<i>0.007</i>				
# W0064-T-014-026-WC-S2	6.35	14	2.57	0.22		302 Stainless	Curved	-
	<i>0.250</i>	<i>0.551</i>	<i>0.101</i>	<i>0.009</i>				
W0064-T-013-016-WC-S2	6.4	12.7	1.60	0.30		301 Stainless	Curved DIN 137 Type A	
	<i>0.252</i>	<i>0.500</i>	<i>0.063</i>	<i>0.012</i>				
# W0064-T-013-023-WC-S2	6.4	12.7	2.31	0.18		301 Stainless	Curved DIN 137 Type A	
	<i>0.252</i>	<i>0.500</i>	<i>0.091</i>	<i>0.007</i>				
# W0064-T-014-013-WC-S2	6.4	14.3	1.32	0.46		301 Stainless	Curved DIN 137 Type A	
	<i>0.252</i>	<i>0.563</i>	<i>0.052</i>	<i>0.018</i>				
W0079-T-013-016-WC-S2	7.9	12.7	1.57	0.30		301 Stainless	Curved DIN 137 Type A	
	<i>0.311</i>	<i>0.500</i>	<i>0.062</i>	<i>0.012</i>				
W0079-T-013-020-WC-S2	7.9	12.7	1.96	0.18		301 Stainless	Curved DIN 137 Type A	
	<i>0.311</i>	<i>0.500</i>	<i>0.077</i>	<i>0.007</i>				
W0079-T-016-020-WC-S2	7.9	15.9	1.96	0.33		301 Stainless	Curved DIN 137 Type A	
	<i>0.311</i>	<i>0.626</i>	<i>0.077</i>	<i>0.013</i>				

Indicates item not stocked at time of printing - Please enquire for lead time

Page 7 of 9

E&OE Pricing and all details subject to change without notice - Copyright Miniature Bearings Australia Pty Ltd

MBA Size Listings are a guide to sizes only and must not be solely relied on for critical design information.

Washers - Spring - Curved - Stainless Steel

Part Number	Nom. ID (B) mm <i>inches</i>	Nom. OD (A) mm <i>inches</i>	Nom. Height (C) mm <i>inches</i>	Thickness (D) mm <i>inches</i>	Info	Material	Type	Nominal Screw Size mm <i>inches</i>
# W0079-T-012-020-WC-S2	7.938 <i>0.313</i>	12.45 <i>0.490</i>	1.96 <i>0.077</i>	0.19 <i>0.007</i>		302 Stainless	Curved	-
W0079-T-016-020-WC-S1	7.938 <i>0.313</i>	15.55 <i>0.612</i>	1.96 <i>0.077</i>	0.33 <i>0.013</i>		301 Stainless	Curved DIN 137 Type A	5/16
# W0079-T-016-029-WC-S1	7.938 <i>0.313</i>	15.55 <i>0.612</i>	2.87 <i>0.113</i>	0.23 <i>0.009</i>		301 Stainless	Curved DIN 137 Type A	5/16
# W0080-T-017-031-WC-S2	8 <i>0.315</i>	17.07 <i>0.672</i>	3.05 <i>0.120</i>	0.25 <i>0.010</i>		302 Stainless	Curved	-
# W0095-T-015-025-WC-S2	9.525 <i>0.375</i>	15.45 <i>0.608</i>	2.49 <i>0.098</i>	0.23 <i>0.009</i>		302 Stainless	Curved	-
# W0095-T-017-029-WC-S2	9.525 <i>0.375</i>	17.07 <i>0.672</i>	2.92 <i>0.115</i>	0.25 <i>0.010</i>		302 Stainless	Curved	-
# W0095-T-019-022-WC-S2	9.525 <i>0.375</i>	18.67 <i>0.735</i>	2.18 <i>0.086</i>	0.41 <i>0.016</i>		301 Stainless	Curved DIN 137 Type A	3/8
W0095-T-019-033-WC-S2	9.525 <i>0.375</i>	18.67 <i>0.735</i>	3.28 <i>0.129</i>	0.28 <i>0.011</i>		301 Stainless	Curved DIN 137 Type A	3/8
# W0111-T-017-021-WC-S2	11.11 <i>0.437</i>	17.07 <i>0.672</i>	2.13 <i>0.084</i>	0.38 <i>0.015</i>		302 Stainless	Curved	-

Indicates item not stocked at time of printing - Please enquire for lead time

Page 8 of 9

E&OE Pricing and all details subject to change without notice - Copyright Miniature Bearings Australia Pty Ltd

MBA Size Listings are a guide to sizes only and must not be solely relied on for critical design information.

Washers - Spring - Curved - Stainless Steel

Part Number	Nom. ID (B) mm	Nom. OD (A) mm	Nom. Height (C) mm	Thickness (D) mm	Info	Material	Type	Nominal Screw Size mm
	<i>inches</i>	<i>inches</i>	<i>inches</i>	<i>inches</i>				<i>inches</i>
# W0111-T-017-029-WC-S2	11.11 <i>0.437</i>	17.07 <i>0.672</i>	2.92 <i>0.115</i>	0.25 <i>0.010</i>		302 Stainless	Curved	-
# W0111-T-017-022-WC-S2	11.1 <i>0.437</i>	17.4 <i>0.685</i>	2.18 <i>0.086</i>	0.38 <i>0.015</i>		301 Stainless	Curved DIN 137 Type A	
# W0111-T-022-025-WC-S2	11.11 <i>0.437</i>	21.77 <i>0.857</i>	2.54 <i>0.100</i>	0.46 <i>0.018</i>		301 Stainless	Curved DIN 137 Type A	7/16
# W0127-T-025-028-WC-S2	12.7 <i>0.500</i>	24.89 <i>0.980</i>	2.79 <i>0.110</i>	0.53 <i>0.021</i>		301 Stainless	Curved DIN 137 Type A	1/2

Indicates item not stocked at time of printing - Please enquire for lead time

Page 9 of 9

E&OE Pricing and all details subject to change without notice - Copyright Miniature Bearings Australia Pty Ltd
MBA Size Listings are a guide to sizes only and must not be solely relied on for critical design information.

DISTRIBUTED BY

Distributed By:

