



Washers - Square - Heavy Duty - Steel

10/4/2018

Indicates item not stocked at time of printing - Please enquire for lead time

E&OE Pricing and all details subject to change without notice - Copyright Miniature Bearings Australia Pty Ltd

MBA Size Listings are a guide to sizes only and must not be solely relied on for critical design information.

INFORMATION

Indicates item not stocked at time of printing - Please enquire for lead time

E&OE Pricing and all details subject to change without notice - Copyright Miniature Bearings Australia Pty Ltd

MBA Size Listings are a guide to sizes only and must not be solely relied on for critical design information.

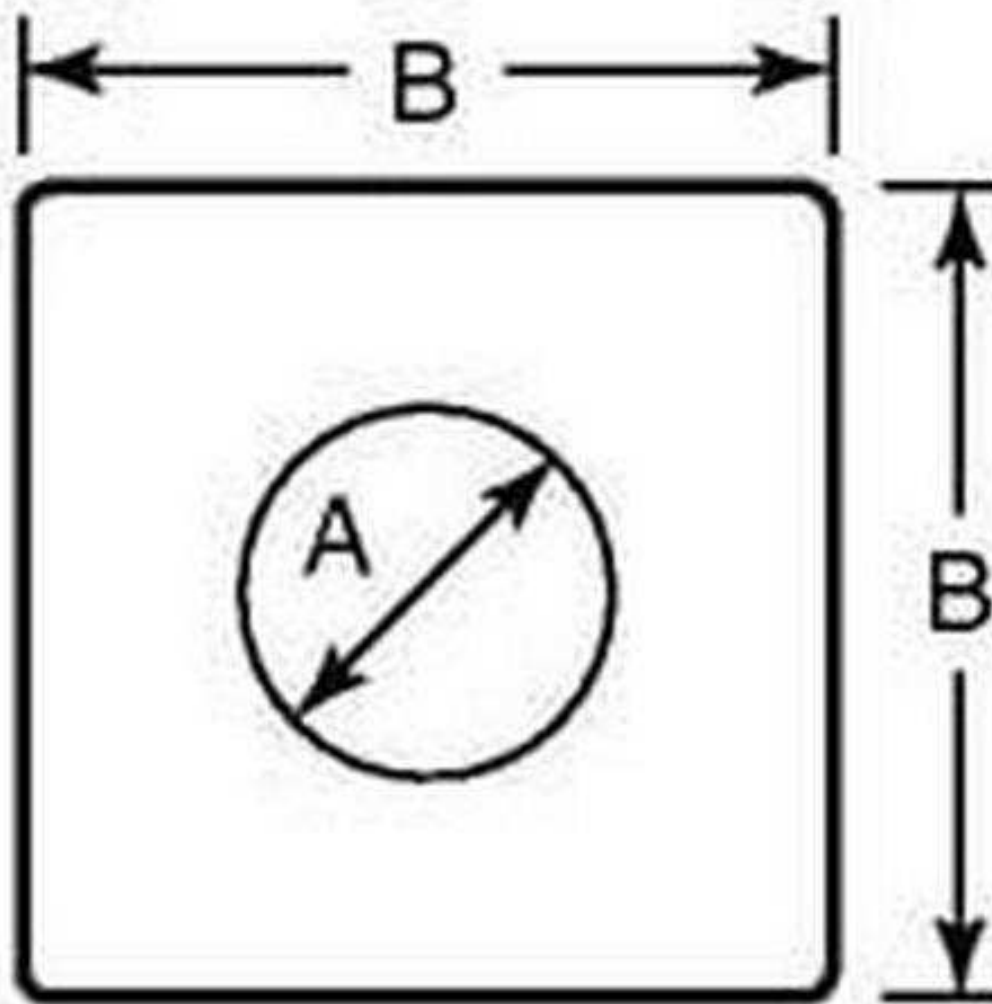

Indicates item not stocked at time of printing - Please enquire for lead time

E&OE Pricing and all details subject to change without notice - Copyright Miniature Bearings Australia Pty Ltd

MBA Size Listings are a guide to sizes only and must not be solely relied on for critical design information.

Washers - Square - Heavy Duty - Steel

Part Number	Nom. ID (A) mm	Outside Length (B) mm	Thickness mm
	<i>inches</i>	<i>inches</i>	<i>inches</i>
# W0127-SQ-035-064-C	12.7 <i>0.500</i>	34.925 <i>1.375</i>	6.35 <i>0.250</i>
# W0127-SQ-051-064-C	12.7 <i>0.500</i>	50.8 <i>2.000</i>	6.35 <i>0.250</i>
# W0159-SQ-051-064-C	15.875 <i>0.625</i>	50.8 <i>2.000</i>	6.35 <i>0.250</i>
# W0191-SQ-051-064-C	19.05 <i>0.750</i>	50.8 <i>2.000</i>	6.35 <i>0.250</i>
# W0191-SQ-064-064-C	19.05 <i>0.750</i>	63.5 <i>2.500</i>	6.35 <i>0.250</i>
# W0254-SQ-064-064-C	25.4 <i>1.000</i>	63.5 <i>2.500</i>	6.35 <i>0.250</i>

Indicates item not stocked at time of printing - Please enquire for lead time

E&OE Pricing and all details subject to change without notice - Copyright Miniature Bearings Australia Pty Ltd

MBA Size Listings are a guide to sizes only and must not be solely relied on for critical design information.

DISTRIBUTED BY

Distributed By:

