

MBA

2022.1

Thrust Ball Bearing Sizes

2mm to 200mm Bore - Your Search Ends Here

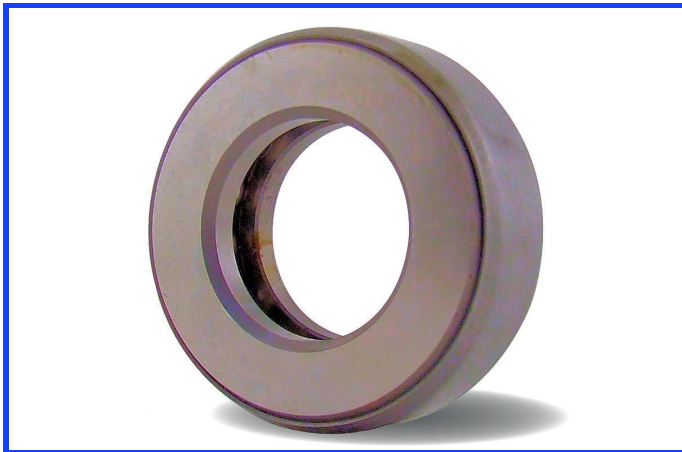

- Flat Washer Type
- Grooved Washer Type
- Banded Type
- Chrome Steel
- 400 Grade Stainless Steel

For convenience, ISO 50000 series thrust bearings have been included in this catalogue with the ISO number forming the end of our part number.



To find and order parts online, simply type the part number from this catalogue into the search box on any web page.

Prefixes and Suffixes

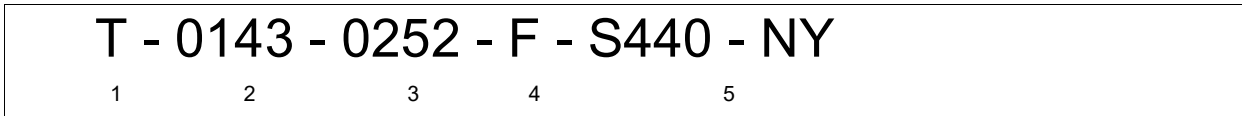

1 Thrust Bearing:
T indicates that this is a thrust bearing

2 Bore Size:
Shifted 1 decimal place. 0143 is 14.3mm bore.

3 OD:
Shifted 1 decimal place. 0252 is 25.2mm OD.

4 Type:
BND: Banded
F: Flat Washer
G: Grooved Race
N: Narrow
SB: Spherical Back Seat

5 Bearing/Retainer Material:
Blank: Chrome Steel / Chrome Steel
BR: Chrome Steel / Brass
NY: Chrome Steel / Nylon

S440: Stainless Steel / Stainless Steel
S440-BR: Stainless Steel / Brass
S440-NY: Stainless Steel / Nylon

These are just some of the most commonly used suffixes. Please refer to MBA for information on suffixes not listed.

Diagram

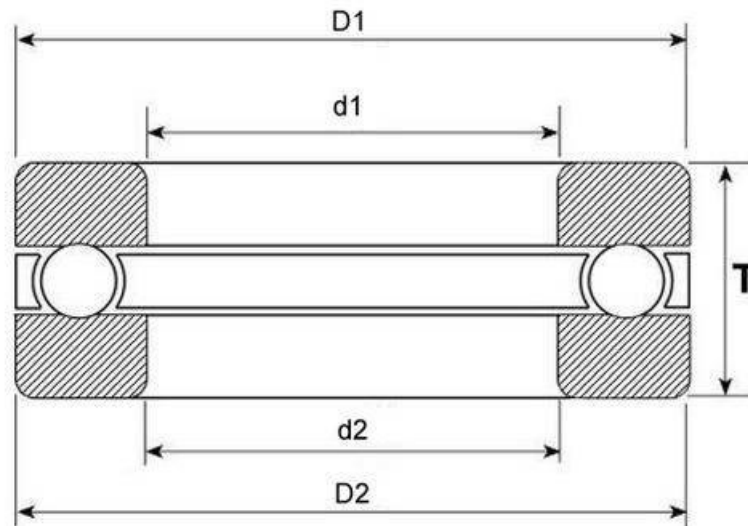

Three piece grooved thrust shown. Other types are also listed in this catalogue.

d1	D1	T	d2	D2	Bearing/Cage	Part Number	Type
2.000 mm ID (0.079 in.)							
2.000	6.000	3.000	2.000	6.000	Chrome/Brass	T-0020-0060-F-BR	Bearings - Thrust - Ball - Flat - Chrome Steel
2.500 mm ID (0.098 in.)							
2.500	7.000	3.500	2.500	7.000	Chrome/Brass	* T-0025-0070-F-BR	Bearings - Thrust - Ball - Flat - Chrome Steel
3.000 mm ID (0.118 in.)							
3.000	8.000	2.780	3.000	8.000	Chrome/Steel	* T-0030-0080-F	Bearings - Thrust - Ball - Flat - Chrome Steel
3.000	8.000	3.500	3.200	7.800	Chrome/Brass	** T-0030-0080-G-BR	Bearings - Thrust - Ball - Grooved - Chrome Steel
3.000	8.000	3.500	3.200	7.800	Chrome/Steel	T-0030-0080-G-ST	Bearings - Thrust - Ball - Grooved - Chrome Steel
3.175 mm ID (0.125 in.)							
3.175	11.113	4.763	3.175	11.113	Stainless/Nylon	T-0032-0109-F-S440-NY	Bearings - Thrust - Ball - Flat - Stainless Steel
3.175	11.113	4.763	3.175	11.113	Chrome/Nylon	T-0032-0109-F-NY	Bearings - Thrust - Ball - Flat - Chrome Steel
3.175	12.000	6.000	3.175	12.000	Chrome/Brass	** T-0032-0120-F-BR	Bearings - Thrust - Ball - Flat - Chrome Steel
3.200 mm ID (0.126 in.)							
3.200	8.000	2.780	3.200	8.000	Stainless/Brass	* T-0032-0080-F-S440-BR	Bearings - Thrust - Ball - Flat - Stainless Steel
4.000 mm ID (0.157 in.)							
4.000	6.300	5.000	4.100			* T-0040-0063-BND	Bearings - Thrust - Ball - Banded
4.000	9.000	2.780	4.000	9.000	Chrome/Steel	* T-0040-0090-NF	Bearings - Thrust - Ball - Flat - Chrome Steel
4.000	9.000	4.000	4.000	9.000	Chrome/Steel	T-0040-0090-F	Bearings - Thrust - Ball - Flat - Chrome Steel
4.000	9.000	4.000	4.200	8.800	Chrome/Brass	T-0040-0090-G-BR	Bearings - Thrust - Ball - Grooved - Chrome Steel
4.000	9.000	4.000	4.200	8.800	Chrome/Ceramic	CZR-T-0040-0090-G-ZR	Bearings - Thrust - Ball - Grooved - ZRO2 Ceramic
4.000	9.000	4.000	4.200	8.800	Chrome/Chrome	T-0040-0090-G	Bearings - Thrust - Ball - Grooved - Chrome Steel
4.000	9.000	4.000	4.200	8.800	Stainless/Stainless	T-0040-0090-G-S440	Bearings - Thrust - Ball - Grooved - Stainless Steel
4.000	10.000	4.000	4.200	9.800	Chrome/Brass	T-0040-0100-G-BR	Bearings - Thrust - Ball - Grooved - Chrome Steel
4.000	10.000	4.000	4.200	9.800	Chrome/Ceramic	CZR-T-0040-0100-G-ZR	Bearings - Thrust - Ball - Grooved - ZRO2 Ceramic
4.763 mm ID (0.188 in.)							
4.763	12.700	4.763	4.763	12.700	Chrome/Nylon	T-0048-0125-F-NY	Bearings - Thrust - Ball - Flat - Chrome Steel
4.763	12.700	4.763	4.763	12.700	Stainless/Nylon	T-0048-0125-F-S440-NY	Bearings - Thrust - Ball - Flat - Stainless Steel
5.000 mm ID (0.197 in.)							
5.000	10.000	4.000	5.200	9.800	Chrome/Chrome	T-0050-0100-G	Bearings - Thrust - Ball - Grooved - Chrome Steel
5.000	10.000	4.200	5.100			* T-0050-0100-BND	Bearings - Thrust - Ball - Banded
5.000	11.000	4.500	5.000	11.000	Chrome/Brass	T-0050-0110-F-BR	Bearings - Thrust - Ball - Flat - Chrome Steel
5.000	12.000	4.000	5.200	11.800	Chrome/Brass	T-0050-0120-G-BR	Bearings - Thrust - Ball - Grooved - Chrome Steel
5.000	12.000	4.000	5.200	11.800	Chrome/Chrome	T-0050-0120-G	Bearings - Thrust - Ball - Grooved - Chrome Steel
5.000	12.000	5.000	5.000	12.000	Chrome/Nylon	* T-0050-0120-F-NY	Bearings - Thrust - Ball - Flat - Chrome Steel
5.000	12.000	5.000	5.000	12.000	Stainless/Nylon	* T-0050-0120-F-S440-NY	Bearings - Thrust - Ball - Flat - Stainless Steel
6.000 mm ID (0.236 in.)							
6.000	12.000	4.500	6.000	12.000	Chrome/Brass	* T-0060-0120-F-BR	Bearings - Thrust - Ball - Flat - Chrome Steel
6.000	12.000	4.500	6.200	11.800	Chrome/Chrome	T-0060-0120-G	Bearings - Thrust - Ball - Grooved - Chrome Steel
6.000	12.000	4.700	6.200			* T-0060-0120-BND	Bearings - Thrust - Ball - Banded
6.000	14.000	5.000	6.000	14.000	Chrome/Nylon	* T-0060-0140-F-NY	Bearings - Thrust - Ball - Flat - Chrome Steel
6.000	14.000	5.000	6.000	14.000	Stainless/Nylon	* T-0060-0140-F-S440-NY	Bearings - Thrust - Ball - Flat - Stainless Steel
6.000	14.000	5.000	6.200	13.800	Chrome/Brass	T-0060-0140-G-BR	Bearings - Thrust - Ball - Grooved - Chrome Steel
6.000	14.000	5.000	6.200	13.800	Chrome/Chrome	T-0060-0140-G-ST	Bearings - Thrust - Ball - Grooved - Chrome Steel
6.350 mm ID (0.250 in.)							
6.350	11.000	3.200	6.350	11.000	Stainless/Brass	T-0064-0110-F-S440-BR	Bearings - Thrust - Ball - Flat - Stainless Steel
6.350	14.288	4.763	6.350	14.288	Chrome/Nylon	T-0064-0141-F-NY	Bearings - Thrust - Ball - Flat - Chrome Steel
6.350	14.288	4.763	6.350	14.288	Stainless/Nylon	T-0064-0141-F-S440-NY	Bearings - Thrust - Ball - Flat - Stainless Steel
6.350	21.438	8.458	6.985			T-0064-0214-BND	Bearings - Thrust - Ball - Banded
7.000 mm ID (0.276 in.)							
7.000	13.000	4.500	7.200	12.800	Chrome/Brass	T-0070-0130-G-BR	Bearings - Thrust - Ball - Grooved - Chrome Steel



Stocked or Short Delivery



Usually Available



Long delivery or not in current production

* Large Minimum Quantities

** Available only while stock lasts

d1	D1	T	d2	D2	Bearing/Cage	Part Number	Type
7.000 mm ID (0.276 in.)							
7.000	13.000	4.500	7.200	12.800	Chrome/Chrome	T-0070-0130-G	Bearings - Thrust - Ball - Grooved - Chrome Steel
7.000	14.000	4.500	7.200	13.800	Chrome/Steel	* T-0070-0140-G	Bearings - Thrust - Ball - Grooved - Chrome Steel
7.000	14.000	4.700	7.200			* T-0070-0140-BND	Bearings - Thrust - Ball - Banded
7.000	15.000	5.000	7.000	15.000	Chrome/Brass	T-0070-0150-F-BR	Bearings - Thrust - Ball - Flat - Chrome Steel
7.000	15.000	5.000	7.000	15.000	Chrome/Steel	T-0070-0150-F-ST	Bearings - Thrust - Ball - Flat - Chrome Steel
7.000	15.000	5.000	7.200	14.800	Chrome/Brass	T-0070-0150-G-BR	Bearings - Thrust - Ball - Grooved - Chrome Steel
7.000	15.000	5.000	7.200	14.800	Chrome/Steel	T-0070-0150-G-ST	Bearings - Thrust - Ball - Grooved - Chrome Steel
7.000	17.000	5.000	7.000	17.000	Chrome/Nylon	* T-0070-0170-F-NY	Bearings - Thrust - Ball - Flat - Chrome Steel
7.000	17.000	5.000	7.000	17.000	Stainless/Nylon	* T-0070-0170-F-S440-NY	Bearings - Thrust - Ball - Flat - Stainless Steel
7.000	17.000	6.000	7.200	16.800	Chrome/Chrome	** T-0070-0170-G	Bearings - Thrust - Ball - Grooved - Chrome Steel
8.000 mm ID (0.315 in.)							
8.000	14.000	4.000	8.200	13.800	Chrome/Steel	T-0080-0140-G-ST-ECO	Bearings - Thrust - Ball - Grooved - Chrome Steel
8.000	15.875	4.763	8.000	15.875	Chrome/Nylon	* T-0080-0157-F-NY	Bearings - Thrust - Ball - Flat - Chrome Steel
8.000	15.875	4.763	8.000	15.875	Stainless/Nylon	* T-0080-0157-F-S440-NY	Bearings - Thrust - Ball - Flat - Stainless Steel
8.000	16.000	5.000	8.000	16.000	Chrome/Nylon	T-0080-0160-F-NY	Bearings - Thrust - Ball - Flat - Chrome Steel
8.000	16.000	5.000	8.000	16.000	Stainless/Nylon	T-0080-0160-F-S440-NY	Bearings - Thrust - Ball - Flat - Stainless Steel
8.000	16.000	5.000	8.000	16.000	Chrome/Brass	T-0080-0160-F-BR	Bearings - Thrust - Ball - Flat - Chrome Steel
8.000	16.000	5.000	8.200	15.800	Chrome/Brass	** T-0080-0160-G-BR	Bearings - Thrust - Ball - Grooved - Chrome Steel
8.000	16.000	5.000	8.200	15.800	Chrome/Steel	T-0080-0160-G-ST	Bearings - Thrust - Ball - Grooved - Chrome Steel
8.000	16.000	5.000	8.200	15.800	Stainless/Stainless	T-0080-0160-G-S440-ECO	Bearings - Thrust - Ball - Grooved - Stainless Steel
8.000	16.000	5.000	8.200	15.800	Stainless/Stainless	T-0080-0160-G-S440	Bearings - Thrust - Ball - Grooved - Stainless Steel
8.000	16.000	5.200	8.200			* T-0080-0160-BND	Bearings - Thrust - Ball - Banded
8.000	19.000	7.000	8.200	18.800	Chrome/Chrome	T-0080-0190-G	Bearings - Thrust - Ball - Grooved - Chrome Steel
9.000 mm ID (0.354 in.)							
9.000	13.800	5.000	9.100			* T-0090-0138-N-BND	Bearings - Thrust - Ball - Banded
9.000	13.800	6.500	9.100			* T-0090-0138-BND	Bearings - Thrust - Ball - Banded
9.000	17.000	5.000	9.000	17.000	Chrome/Brass	T-0090-0170-F-BR	Bearings - Thrust - Ball - Flat - Chrome Steel
9.000	17.000	5.000	9.200	16.800	Chrome/Chrome	* T-0090-0170-G	Bearings - Thrust - Ball - Grooved - Chrome Steel
9.000	19.000	6.500	9.200	18.800	Chrome/Chrome	* T-0090-0190-G	Bearings - Thrust - Ball - Grooved - Chrome Steel
9.000	20.000	7.000	9.200	19.800	Chrome/Brass	T-0090-0200-G-BR	Bearings - Thrust - Ball - Grooved - Chrome Steel
9.525 mm ID (0.375 in.)							
9.525	20.638	6.350	9.525	20.638	Chrome/Nylon	T-0095-0204-F-NY	Bearings - Thrust - Ball - Flat - Chrome Steel
9.525	20.638	6.350	9.525	20.638	Stainless/Nylon	T-0095-0204-F-S440-NY	Bearings - Thrust - Ball - Flat - Stainless Steel
9.525	25.400	13.494	9.925	24.606	Chrome/Steel	* T-0095-0254-G	Bearings - Thrust - Ball - Grooved - Chrome Steel
9.525	26.594	9.119	10.160			T-0095-0266-BND	Bearings - Thrust - Ball - Banded
10.000 mm ID (0.394 in.)							
10.000	15.300	6.500	10.100			* T-0100-0153-BND	Bearings - Thrust - Ball - Banded
10.000	18.000	4.780	10.000	18.000	Chrome/Steel	* T-0100-0180-F	Bearings - Thrust - Ball - Flat - Chrome Steel
10.000	18.000	5.500	10.200	17.800	Chrome/Brass	T-0100-0180-G-BR	Bearings - Thrust - Ball - Grooved - Chrome Steel
10.000	18.000	5.500	10.200	17.800	Stainless/Stainless	T-0100-0180-G-S440	Bearings - Thrust - Ball - Grooved - Stainless Steel
10.000	18.000	5.500	10.200	17.800	Chrome/Steel	T-0100-0180-G-ST	Bearings - Thrust - Ball - Grooved - Chrome Steel
10.000	20.000	6.500	10.200	19.800	Chrome/Chrome	* T-0100-0200-G	Bearings - Thrust - Ball - Grooved - Chrome Steel
10.000	21.000	6.350	10.000	21.000	Chrome/Nylon	* T-0100-0210-F-NY	Bearings - Thrust - Ball - Flat - Chrome Steel
10.000	21.000	6.350	10.000	21.000	Stainless/Nylon	* T-0100-0210-F-S440-NY	Bearings - Thrust - Ball - Flat - Stainless Steel
10.000	24.000	9.000	11.000	24.000	Chrome/Steel	T-0100-0240-G-51100	Bearings - Thrust - Ball - Grooved - Chrome Steel
10.000	26.000	11.000	12.000	26.000	Chrome/Steel	T-0100-0260-G-51200	Bearings - Thrust - Ball - Grooved - Chrome Steel
10.000	26.000	11.000	12.000	26.000	Stainless/Stainless	T-0100-0260-G-51200-S420-ECO	Bearings - Thrust - Ball - Grooved - Stainless Steel
10.000	26.000	11.600	12.000	26.000	Hardened Steel/Steel	T-0100-0260-SB	Bearings - Thrust - Ball - Spherical Back Face
10.000	26.000	12.000	10.200	26.000	Chrome/Steel	T-0100-0260-G	Bearings - Thrust - Ball - Grooved - Chrome Steel

Stocked or Short Delivery

Usually Available

Long delivery or not in current production

* Large Minimum Quantities

** Available only while stock lasts

d1	D1	T	d2	D2	Bearing/Cage	Part Number	Type
11.112 mm ID (0.437 in.)							
11.112	22.225	6.350	11.113	22.225	Chrome/Nylon	T-0111-0220-F-NY	Bearings - Thrust - Ball - Flat - Chrome Steel
11.112	22.225	6.350	11.113	22.225	Stainless/Nylon	T-0111-0220-F-S440-NY	Bearings - Thrust - Ball - Flat - Stainless Steel
11.112	31.750	15.875	11.906	32.544	Chrome/Steel	* T-0111-0317-G	Bearings - Thrust - Ball - Grooved - Chrome Steel
11.506 mm ID (0.453 in.)							
11.506	21.819	7.138	12.141			T-0115-0218-BND	Bearings - Thrust - Ball - Banded
12.000 mm ID (0.472 in.)							
12.000	21.000	5.000	12.200	20.800	Chrome/Steel	T-0120-0210-G-ST-ECO	Bearings - Thrust - Ball - Grooved - Chrome Steel
12.000	23.000	7.500	12.200	22.800	Chrome/Chrome	T-0120-0230-G	Bearings - Thrust - Ball - Grooved - Chrome Steel
12.000	24.000	5.600	12.000	24.000	Chrome/Steel	* T-0120-0240N-F-ST	Bearings - Thrust - Ball - Flat - Chrome Steel
12.000	24.000	6.350	12.000	24.000	Chrome/Nylon	* T-0120-0240-F-NY	Bearings - Thrust - Ball - Flat - Chrome Steel
12.000	24.000	6.350	12.000	24.000	Stainless/Nylon	* T-0120-0240-F-S440-NY	Bearings - Thrust - Ball - Flat - Stainless Steel
12.000	26.000	9.000	13.000	26.000	Chrome/Chrome	T-0120-0260-G-51101	Bearings - Thrust - Ball - Grooved - Chrome Steel
12.000	26.000	9.000	13.000	26.000	Stainless/Stainless	T-0120-0260-G-51101-S420-ECO	Bearings - Thrust - Ball - Grooved - Stainless Steel
12.000	28.000	11.000	14.000	28.000	Chrome/Steel	T-0120-0280-G-51201	Bearings - Thrust - Ball - Grooved - Chrome Steel
12.000	28.000	11.400	14.000	28.000	Hardened Steel/Steel	T-0120-0280-SB	Bearings - Thrust - Ball - Spherical Back Face
12.000	28.000	12.000	12.200	28.000	Chrome/Steel	T-0120-0280-G	Bearings - Thrust - Ball - Grooved - Chrome Steel
12.700 mm ID (0.500 in.)							
12.700	23.813	6.350	12.700	23.813	Chrome/Nylon	T-0127-0236-F-NY	Bearings - Thrust - Ball - Flat - Chrome Steel
12.700	23.813	6.350	12.700	23.813	Stainless/Nylon	T-0127-0236-F-S440-NY	Bearings - Thrust - Ball - Flat - Stainless Steel
12.700	25.400	8.738	13.335			T-0127-0254-BND	Bearings - Thrust - Ball - Banded
12.700	30.963	14.300	13.490			* T-0127-0310-BND	Bearings - Thrust - Ball - Banded
12.700	32.156	11.100	13.335			T-0127-0322-BND	Bearings - Thrust - Ball - Banded
12.700	32.544	15.875	13.097	31.750	Chrome/Steel	T-0127-0325-G	Bearings - Thrust - Ball - Grooved - Chrome Steel
13.000 mm ID (0.512 in.)							
13.000	19.300	7.000	13.100			* T-0130-0193-BND	Bearings - Thrust - Ball - Banded
14.287 mm ID (0.562 in.)							
14.287	34.925	15.875	15.081	35.719	Chrome/Steel	* T-0142-0349-G	Bearings - Thrust - Ball - Grooved - Chrome Steel
14.288 mm ID (0.563 in.)							
14.288	25.400	6.350	14.288	25.400	Stainless/Nylon	T-0143-0252-F-S440-NY	Bearings - Thrust - Ball - Flat - Stainless Steel
14.288	25.400	6.350	14.288	25.400	Chrome/Nylon	T-0143-0252-F-NY	Bearings - Thrust - Ball - Flat - Chrome Steel
14.300 mm ID (0.563 in.)							
14.300	30.963	14.300	15.090			* T-0143-0310-BND	Bearings - Thrust - Ball - Banded
15.000 mm ID (0.591 in.)							
15.000	23.300	7.500	15.100			* T-0150-0233-BND	Bearings - Thrust - Ball - Banded
15.000	28.000	9.000	16.000	28.000	Chrome/Steel	T-0150-0280-G-51102	Bearings - Thrust - Ball - Grooved - Chrome Steel
15.000	31.000	12.000	15.200	31.000	Chrome/Steel	T-0150-0310-G	Bearings - Thrust - Ball - Grooved - Chrome Steel
15.000	32.000	12.000	17.000	32.000	Stainless/Stainless	T-0150-0320-G-51202-440C-ECO	Bearings - Thrust - Ball - Grooved - Stainless Steel
15.000	32.000	12.000	17.000	32.000	Chrome/Steel	T-0150-0320-G-51202	Bearings - Thrust - Ball - Grooved - Chrome Steel
15.000	32.000	13.300	17.000	32.000	Hardened Steel/Steel	T-0150-0320-SB	Bearings - Thrust - Ball - Spherical Back Face
15.875 mm ID (0.625 in.)							
15.875	28.575	8.731	15.875	28.575	Chrome/Nylon	T-0159-0283-F-NY	Bearings - Thrust - Ball - Flat - Chrome Steel
15.875	28.575	8.731	15.875	28.575	Stainless/Nylon	T-0159-0283-F-S440-NY	Bearings - Thrust - Ball - Flat - Stainless Steel
15.875	28.575	8.738	16.662			T-0159-0286-BND	Bearings - Thrust - Ball - Banded
15.875	34.138	14.300	16.660			* T-0159-0341-BND	Bearings - Thrust - Ball - Banded
15.875	35.719	15.875	16.272	34.925	Chrome/Steel	T-0159-0357-G	Bearings - Thrust - Ball - Grooved - Chrome Steel
15.875	36.119	11.506	16.662			T-0159-0361-BND	Bearings - Thrust - Ball - Banded
16.000 mm ID (0.630 in.)							
16.000	28.000	8.731	16.000	28.000	Chrome/Nylon	* T-0160-0280-F-NY	Bearings - Thrust - Ball - Flat - Chrome Steel



Stocked or Short Delivery



Usually Available



Long delivery or not in current production

* Large Minimum Quantities

** Available only while stock lasts

d1	D1	T	d2	D2	Bearing/Cage	Part Number	Type
16.000 mm ID (0.630 in.)							
16.000	28.000	8.731	16.000	28.000	Stainless/Nylon	* T-0160-0280-F-S440-NY	Bearings - Thrust - Ball - Flat - Stainless Steel
17.000 mm ID (0.669 in.)							
17.000	30.000	9.000	18.000	30.000	Chrome/Chrome	T-0170-0300-G-51103	Bearings - Thrust - Ball - Grooved - Chrome Steel
17.000	35.000	12.000	19.000	35.000	Chrome/Steel	T-0170-0350-G-51203	Bearings - Thrust - Ball - Grooved - Chrome Steel
17.000	35.000	13.200	19.000	35.000	Hardened Steel/Steel	T-0170-0350-SB	Bearings - Thrust - Ball - Spherical Back Face
17.463 mm ID (0.688 in.)							
17.463	30.175	8.731	17.463	30.163	Stainless/Nylon	T-0175-0299-F-S440-NY	Bearings - Thrust - Ball - Flat - Stainless Steel
17.463	30.175	8.731	17.463	30.163	Chrome/Nylon	T-0175-0299-F-NY	Bearings - Thrust - Ball - Flat - Chrome Steel
17.475 mm ID (0.688 in.)							
17.475	34.138	14.300	18.260			* T-0175-0341-BND	Bearings - Thrust - Ball - Banded
18.000 mm ID (0.709 in.)							
18.000	35.000	12.000	18.200	35.000	Chrome/Steel	T-0180-0350-G	Bearings - Thrust - Ball - Grooved - Chrome Steel
19.000 mm ID (0.748 in.)							
19.000	32.000	8.731	19.000	32.000	Chrome/Nylon	* T-0190-0320-F-NY	Bearings - Thrust - Ball - Flat - Chrome Steel
19.000	32.000	8.731	19.000	32.000	Stainless/Nylon	* T-0190-0320-F-S440-NY	Bearings - Thrust - Ball - Flat - Stainless Steel
19.050 mm ID (0.750 in.)							
19.050	31.750	8.731	19.050	31.750	Chrome/Nylon	T-0191-0315-F-NY	Bearings - Thrust - Ball - Flat - Chrome Steel
19.050	31.750	8.731	19.050	31.750	Stainless/Nylon	T-0191-0315-F-S440-NY	Bearings - Thrust - Ball - Flat - Stainless Steel
19.050	37.313	14.300	19.840			* T-0191-0373-BND	Bearings - Thrust - Ball - Banded
19.050	38.894	15.875	19.447	38.100	Chrome/Steel	T-0191-0389-G	Bearings - Thrust - Ball - Grooved - Chrome Steel
19.050	42.062	13.843	19.685			T-0191-0421-BND	Bearings - Thrust - Ball - Banded
20.000 mm ID (0.787 in.)							
20.000	35.000	10.000	21.000	35.000	Ceramic/Ceramic	CZRT-0200-0350-G-ZR-51104	Bearings - Thrust - Ball - Grooved - ZR02 Ceramic
20.000	35.000	10.000	21.000	35.000	Chrome/Steel	T-0200-0350-G-51104	Bearings - Thrust - Ball - Grooved - Chrome Steel
20.000	37.000	12.000	20.200	37.000	Chrome/Steel	T-0200-0370-G	Bearings - Thrust - Ball - Grooved - Chrome Steel
20.000	40.000	14.000	22.000	40.000	Chrome/Steel	T-0200-0400-G-51204	Bearings - Thrust - Ball - Grooved - Chrome Steel
20.000	40.000	14.000	22.000	40.000	Chrome/Steel	T-0200-0400-G-51204-ECO	Bearings - Thrust - Ball - Grooved - Chrome Steel
20.000	40.000	14.700	22.000	40.000	Hardened Steel/Steel	T-0200-0400-SB	Bearings - Thrust - Ball - Spherical Back Face
20.638 mm ID (0.813 in.)							
20.638	33.338	8.731	20.638	33.338	Chrome/Nylon	T-0206-0331-F-NY	Bearings - Thrust - Ball - Flat - Chrome Steel
20.638	33.338	8.731	20.638	33.338	Stainless/Nylon	T-0206-0331-F-S440-NY	Bearings - Thrust - Ball - Flat - Stainless Steel
20.650 mm ID (0.813 in.)							
20.650	37.313	14.300	21.440			* T-0207-0373-BND	Bearings - Thrust - Ball - Banded
22.000 mm ID (0.866 in.)							
22.000	42.000	14.000	22.200	42.000	Chrome/Steel	* T-0220-0420-G	Bearings - Thrust - Ball - Grooved - Chrome Steel
22.225 mm ID (0.875 in.)							
22.225	34.925	8.731	22.225	34.925	Chrome/Nylon	T-0222-0347-F-NY	Bearings - Thrust - Ball - Flat - Chrome Steel
22.225	34.925	8.731	22.225	34.925	Stainless/Nylon	T-0222-0347-F-S440-NY	Bearings - Thrust - Ball - Flat - Stainless Steel
22.225	42.069	15.875	22.622	41.275	Chrome/Steel	T-0222-0421-G	Bearings - Thrust - Ball - Grooved - Chrome Steel
22.225	46.838	15.875	23.010			* T-0222-0468-BND	Bearings - Thrust - Ball - Banded
22.225	48.031	15.088	22.860			T-0222-0480-BND	Bearings - Thrust - Ball - Banded
23.813 mm ID (0.938 in.)							
23.813	36.688	11.113	23.813	39.688	Chrome/Nylon	T-0238-0394-F-NY	Bearings - Thrust - Ball - Flat - Chrome Steel
23.813	36.688	11.113	23.813	39.688	Stainless/Nylon	T-0238-0394-F-S440-NY	Bearings - Thrust - Ball - Flat - Stainless Steel
23.825 mm ID (0.938 in.)							
23.825	46.838	15.875	24.610			* T-0238-0468-BND	Bearings - Thrust - Ball - Banded
25.000 mm ID (0.984 in.)							
25.000	41.000	11.000	25.000	41.000	Chrome/Nylon	* T-0250-0410-F-NY	Bearings - Thrust - Ball - Flat - Chrome Steel



Stocked or Short Delivery



Usually Available



Long delivery or not in current production

* Large Minimum Quantities

** Available only while stock lasts

d1	D1	T	d2	D2	Bearing/Cage	Part Number	Type
25.000 mm ID (0.984 in.)							
25.000	41.000	11.000	25.000	41.000	Stainless/Nylon	* T-0250-0410-F-S440-NY	Bearings - Thrust - Ball - Flat - Stainless Steel
25.000	42.000	11.000	26.000	42.000	Chrome/Steel	T-0250-0420-G-51105	Bearings - Thrust - Ball - Grooved - Chrome Steel
25.000	44.450	15.875	26.187			T-0250-0445-BND	Bearings - Thrust - Ball - Banded
25.000	45.000	14.000	25.200	45.000	Chrome/Steel	T-0250-0450-G	Bearings - Thrust - Ball - Grooved - Chrome Steel
25.000	47.000	15.000	27.000	47.000		CSN-T-0250-0470-G-FC-51205	Bearings - Thrust - Ball - Grooved - Si3N4 Ceramic
25.000	47.000	15.000	27.000	47.000	Chrome/Steel	T-0250-0470-G-51205	Bearings - Thrust - Ball - Grooved - Chrome Steel
25.000	47.000	16.700	27.000	47.000	Hardened Steel/Steel	T-0250-0470-SB	Bearings - Thrust - Ball - Spherical Back Face
25.000	52.000	18.000	27.000	52.000	Chrome/Steel	T-0250-0520-G-51305	Bearings - Thrust - Ball - Grooved - Chrome Steel
25.000	52.000	19.800	27.000	52.000	Hardened Steel/Steel	T-0250-0520-SB	Bearings - Thrust - Ball - Spherical Back Face
25.000	60.000	24.000	27.000	60.000	Chrome/Steel	T-0250-0600-G-51405	Bearings - Thrust - Ball - Grooved - Chrome Steel
25.000	60.000	26.400	27.000	60.000	Hardened Steel/Steel	T-0250-0600-SB	Bearings - Thrust - Ball - Spherical Back Face
25.400 mm ID (1.000 in.)							
25.400	41.275	11.113	25.400	41.275	Chrome/Nylon	T-0254-0410-F-NY	Bearings - Thrust - Ball - Flat - Chrome Steel
25.400	41.275	11.113	25.400	41.275	Stainless/Nylon	T-0254-0410-F-S440-NY	Bearings - Thrust - Ball - Flat - Stainless Steel
25.400	45.244	15.875	25.797	44.450	Chrome/Steel	T-0254-0452-G	Bearings - Thrust - Ball - Grooved - Chrome Steel
25.400	50.013	15.875	26.190			T-0254-0500-BND	Bearings - Thrust - Ball - Banded
25.400	50.800	16.002	27.305			T-0254-0508-BND	Bearings - Thrust - Ball - Banded
25.806 mm ID (1.016 in.)							
25.806	44.450	15.875	27.305			T-0258-0445-BND	Bearings - Thrust - Ball - Banded
27.000 mm ID (1.063 in.)							
27.000	50.013	15.875	27.790			T-0270-0500-BND	Bearings - Thrust - Ball - Banded
28.000 mm ID (1.102 in.)							
28.000	41.000	11.000	28.000	41.000	Chrome/Nylon	* T-0280-0440-F-NY	Bearings - Thrust - Ball - Flat - Chrome Steel
28.000	41.000	11.000	28.000	41.000	Stainless/Nylon	* T-0280-0440-F-S440-NY	Bearings - Thrust - Ball - Flat - Stainless Steel
28.575 mm ID (1.125 in.)							
28.575	44.450	11.113	28.575	44.450	Chrome/Nylon	T-0286-0441-F-NY	Bearings - Thrust - Ball - Flat - Chrome Steel
28.575	44.450	11.113	28.575	44.450	Stainless/Nylon	T-0286-0441-F-S440-NY	Bearings - Thrust - Ball - Flat - Stainless Steel
28.575	47.625	11.113	28.575	47.625	Chrome/Nylon	T-0318-0473-F-NY	Bearings - Thrust - Ball - Flat - Chrome Steel
28.575	47.625	11.113	28.575	47.625	Stainless/Nylon	T-0318-0473-F-S440-NY	Bearings - Thrust - Ball - Flat - Stainless Steel
28.575	48.419	15.875	28.972	47.625	Chrome/Steel	T-0286-0484-G	Bearings - Thrust - Ball - Grooved - Chrome Steel
28.575	53.188	15.875	29.360			T-0286-0532-BND	Bearings - Thrust - Ball - Banded
30.000 mm ID (1.181 in.)							
30.000	47.000	11.000	32.000	47.000	Ceramic/Ceramic	CZRT-0300-0470-G-ZR-51106	Bearings - Thrust - Ball - Grooved - ZRO2 Ceramic
30.000	47.000	11.000	32.000	47.000	Chrome/Steel	T-0300-0470-G-51106	Bearings - Thrust - Ball - Grooved - Chrome Steel
30.000	50.000	14.000	30.200	50.000	Chrome/Steel	T-0300-0500-G	Bearings - Thrust - Ball - Grooved - Chrome Steel
30.000	52.000	16.000	32.000	52.000	Chrome/Steel	T-0300-0520-G-51206	Bearings - Thrust - Ball - Grooved - Chrome Steel
30.000	52.000	17.800	32.000	52.000	Hardened Steel/Steel	T-0300-0520-SB	Bearings - Thrust - Ball - Spherical Back Face
30.000	60.000	21.000	32.000	60.000	Chrome/Steel	T-0300-0600-G-51306	Bearings - Thrust - Ball - Grooved - Chrome Steel
30.000	60.000	22.600	32.000	60.000	Hardened Steel/Steel	T-0300-0600-SB	Bearings - Thrust - Ball - Spherical Back Face
30.000	70.000	28.000	32.000	70.000	Chrome/Steel	T-0300-0700-G-51406	Bearings - Thrust - Ball - Grooved - Chrome Steel
30.000	70.000	30.100	32.000	70.000	Hardened Steel/Steel	T-0300-0700-SB	Bearings - Thrust - Ball - Spherical Back Face
30.175 mm ID (1.188 in.)							
30.175	53.188	15.875	30.960			* T-0302-0532-BND	Bearings - Thrust - Ball - Banded
31.750 mm ID (1.250 in.)							
31.750	53.181	18.256	32.147	52.388	Chrome/Steel	T-0318-0532-G	Bearings - Thrust - Ball - Grooved - Chrome Steel
31.750	59.538	15.875	32.540			T-0318-0595-BND	Bearings - Thrust - Ball - Banded
33.350 mm ID (1.313 in.)							
33.350	59.538	15.875	34.140			* T-0334-0595-BND	Bearings - Thrust - Ball - Banded
34.925 mm ID (1.375 in.)							



Stocked or Short Delivery



Usually Available



Long delivery or not in current production

* Large Minimum Quantities

** Available only while stock lasts

d1	D1	T	d2	D2	Bearing/Cage	Part Number	Type
34.925 mm ID (1.375 in.)							
34.925	56.356	18.256	35.322	55.562	Chrome/Steel	T-0349-0564-G	Bearings - Thrust - Ball - Grooved - Chrome Steel
34.925	62.713	15.875	35.710			* T-0349-0627-BND	Bearings - Thrust - Ball - Banded
35.000 mm ID (1.378 in.)							
35.000	52.000	12.000	37.000	52.000	Chrome/Steel	T-0350-0520-G-51107	Bearings - Thrust - Ball - Grooved - Chrome Steel
35.000	55.000	16.000	35.200	55.000	Chrome/Steel	T-0350-0550-G	Bearings - Thrust - Ball - Grooved - Chrome Steel
35.000	62.000	18.000	37.000	62.000	Chrome/Chrome	T-0350-0620-G-51207	Bearings - Thrust - Ball - Grooved - Chrome Steel
35.000	62.000	19.900	37.000	62.000	Hardened Steel/Steel	T-0350-0620-SB	Bearings - Thrust - Ball - Spherical Back Face
35.000	68.000	24.000	37.000	68.000	Chrome/Steel	T-0350-0680-G-51307	Bearings - Thrust - Ball - Grooved - Chrome Steel
35.000	68.000	25.600	37.000	68.000	Hardened Steel/Steel	T-0350-0680-SB	Bearings - Thrust - Ball - Spherical Back Face
35.000	80.000	32.000	37.000	80.000	Chrome/Steel	T-0350-0800-G-51407	Bearings - Thrust - Ball - Grooved - Chrome Steel
35.000	80.000	34.000	37.000	80.000	Hardened Steel/Steel	T-0350-0800-SB	Bearings - Thrust - Ball - Spherical Back Face
36.525 mm ID (1.438 in.)							
36.525	62.713	15.875	37.310			T-0365-0627-BND	Bearings - Thrust - Ball - Banded
38.100 mm ID (1.500 in.)							
38.100	53.975	11.113	38.100	53.975	Chrome/Nylon	T-0381-0540-F-NY	Bearings - Thrust - Ball - Flat - Chrome Steel
38.100	53.975	11.113	38.100	53.975	Stainless/Nylon	T-0381-0540-F-S440-NY	Bearings - Thrust - Ball - Flat - Stainless Steel
38.100	59.531	18.256	38.497	58.738	Chrome/Steel	T-0381-0595-G	Bearings - Thrust - Ball - Grooved - Chrome Steel
38.100	65.888	15.875	38.890			T-0381-0659-BND	Bearings - Thrust - Ball - Banded
40.000 mm ID (1.575 in.)							
40.000	60.000	13.000	42.000	60.000	Chrome/Steel	T-0400-0600-G-51108	Bearings - Thrust - Ball - Grooved - Chrome Steel
40.000	60.000	16.000	40.200	60.000	Chrome/Steel	T-0400-0600-G	Bearings - Thrust - Ball - Grooved - Chrome Steel
40.000	68.000	19.000	42.000	68.000	Chrome/Steel	T-0400-0680-G-51208	Bearings - Thrust - Ball - Grooved - Chrome Steel
40.000	68.000	20.300	42.000	68.000	Hardened Steel/Steel	T-0400-0680-SB	Bearings - Thrust - Ball - Spherical Back Face
40.000	78.000	26.000	42.000	78.000	Chrome/Steel	T-0400-0780-G-51308	Bearings - Thrust - Ball - Grooved - Chrome Steel
40.000	78.000	28.500	42.000	78.000	Hardened Steel/Steel	T-0400-0780-SB	Bearings - Thrust - Ball - Spherical Back Face
40.000	90.000	36.000	42.000	90.000	Chrome/Steel	T-0400-0900-G-51408	Bearings - Thrust - Ball - Grooved - Chrome Steel
40.000	90.000	38.200	42.000	90.000	Hardened Steel/Steel	T-0400-0900-SB	Bearings - Thrust - Ball - Spherical Back Face
41.275 mm ID (1.625 in.)							
41.275	62.706	18.256	41.672	61.912	Chrome/Steel	T-0413-0627-G	Bearings - Thrust - Ball - Grooved - Chrome Steel
41.275	75.413	20.650	41.986			* T-0413-0754-BND	Bearings - Thrust - Ball - Banded
44.450 mm ID (1.750 in.)							
44.450	68.262	19.050	44.847	67.469	Chrome/Steel	T-0445-0683-G	Bearings - Thrust - Ball - Grooved - Chrome Steel
44.526 mm ID (1.753 in.)							
44.526	78.588	20.650	45.237			* T-0445-0786-BND	Bearings - Thrust - Ball - Banded
45.000 mm ID (1.772 in.)							
45.000	65.000	14.000	47.000	65.000	Chrome/Steel	T-0450-0650-G-51109	Bearings - Thrust - Ball - Grooved - Chrome Steel
45.000	68.000	16.000	45.200	68.000	Chrome/Steel	T-0450-0680-G	Bearings - Thrust - Ball - Grooved - Chrome Steel
45.000	73.000	20.000	47.000	73.000	Chrome/Steel	T-0450-0730-G-51209	Bearings - Thrust - Ball - Grooved - Chrome Steel
45.000	73.000	21.300	47.000	73.000	Hardened Steel/Steel	T-0450-0730-SB	Bearings - Thrust - Ball - Spherical Back Face
45.000	85.000	28.000	47.000	85.000	Chrome/Steel	T-0450-0850-G-51309	Bearings - Thrust - Ball - Grooved - Chrome Steel
45.000	85.000	30.100	47.000	85.000	Hardened Steel/Steel	T-0450-0850-SB	Bearings - Thrust - Ball - Spherical Back Face
45.000	100.000	39.000	47.000	100.000	Chrome/Steel	* T-0450-1000-G-51409	Bearings - Thrust - Ball - Grooved - Chrome Steel
45.000	100.000	42.400	47.000	100.000	Hardened Steel/Steel	T-0450-1000-SB	Bearings - Thrust - Ball - Spherical Back Face
47.625 mm ID (1.875 in.)							
47.625	71.438	19.050	48.021	70.644	Chrome/Steel	T-0476-0714-G	Bearings - Thrust - Ball - Grooved - Chrome Steel
50.000 mm ID (1.969 in.)							
50.000	70.000	14.000	52.000	70.000	Chrome/Steel	T-0500-0700-G-51110	Bearings - Thrust - Ball - Grooved - Chrome Steel
50.000	74.000	18.000	50.200	74.000	Chrome/Steel	T-0500-0740-G	Bearings - Thrust - Ball - Grooved - Chrome Steel
50.000	78.000	22.000	52.000	78.000	Chrome/Steel	T-0500-0780-G-51210	Bearings - Thrust - Ball - Grooved - Chrome Steel



Stocked or Short Delivery



Usually Available



Long delivery or not in current production

* Large Minimum Quantities

** Available only while stock lasts

d1	D1	T	d2	D2	Bearing/Cage	Part Number	Type
50.000 mm ID (1.969 in.)							
50.000	78.000	23.500	52.000	78.000	Hardened Steel/Steel	T-0500-0780-SB	Bearings - Thrust - Ball - Spherical Back Face
50.000	95.000	31.000	52.000	95.000	Chrome/Steel	T-0500-0950-G-51310	Bearings - Thrust - Ball - Grooved - Chrome Steel
50.000	95.000	34.300	52.000	95.000	Hardened Steel/Steel	T-0500-0950-SB	Bearings - Thrust - Ball - Spherical Back Face
50.000	110.000	43.000	52.000	110.000	Chrome/Steel	T-0500-1100-G-51410	Bearings - Thrust - Ball - Grooved - Chrome Steel
50.000	110.000	45.600	52.000	110.000	Hardened Steel/Steel	T-0500-1100-SB	Bearings - Thrust - Ball - Spherical Back Face
50.800 mm ID (2.000 in.)							
50.800	75.406	19.050	51.594	74.613	Chrome/Steel	T-0508-0754-G	Bearings - Thrust - Ball - Grooved - Chrome Steel
50.876 mm ID (2.003 in.)							
50.876	84.938	20.650	51.587			* T-0509-0849-BND	Bearings - Thrust - Ball - Banded
53.975 mm ID (2.125 in.)							
53.975	81.756	22.225	54.769	80.962	Chrome/Steel	T-0540-0818-G	Bearings - Thrust - Ball - Grooved - Chrome Steel
55.000 mm ID (2.165 in.)							
55.000	78.000	16.000	57.000	78.000	Chrome/Steel	T-0550-0780-G-51111	Bearings - Thrust - Ball - Grooved - Chrome Steel
55.000	78.000	18.000	55.200	78.000	Chrome/Steel	* T-0550-0780-G	Bearings - Thrust - Ball - Grooved - Chrome Steel
55.000	90.000	25.000	57.000	90.000	Chrome/Steel	T-0550-0900-G-51211	Bearings - Thrust - Ball - Grooved - Chrome Steel
55.000	90.000	27.300	57.000	90.000	Hardened Steel/Steel	T-0550-0900-SB	Bearings - Thrust - Ball - Spherical Back Face
55.000	105.000	35.000	57.000	105.000	Chrome/Steel	T-0550-1050-G-51311	Bearings - Thrust - Ball - Grooved - Chrome Steel
55.000	105.000	39.300	57.000	105.000	Hardened Steel/Steel	T-0550-1050-SB	Bearings - Thrust - Ball - Spherical Back Face
55.000	120.000	48.000	57.000	120.000	Chrome/Steel	T-0550-1200-G-51411	Bearings - Thrust - Ball - Grooved - Chrome Steel
55.000	120.000	50.500	57.000	120.000	Hardened Steel/Steel	T-0550-1200-SB	Bearings - Thrust - Ball - Spherical Back Face
57.150 mm ID (2.250 in.)							
57.150	84.931	22.225	57.944	84.138	Chrome/Steel	T-0572-0849-G	Bearings - Thrust - Ball - Grooved - Chrome Steel
60.000 mm ID (2.362 in.)							
60.000	82.000	18.000	60.200	82.000	Chrome/Steel	T-0600-0820-G	Bearings - Thrust - Ball - Grooved - Chrome Steel
60.000	85.000	17.000			Ceramic/Ceramic	CZRT-0600-0850-G-ZR-51112	Bearings - Thrust - Ball - Grooved - ZRO2 Ceramic
60.000	85.000	17.000	62.000	85.000	Chrome/Steel	T-0600-0850-G-51112	Bearings - Thrust - Ball - Grooved - Chrome Steel
60.000	95.000	26.000	62.000	95.000	Chrome/Steel	T-0600-0950-G-51212	Bearings - Thrust - Ball - Grooved - Chrome Steel
60.000	95.000	28.000	62.000	95.000	Hardened Steel/Steel	T-0600-0950-SB	Bearings - Thrust - Ball - Spherical Back Face
60.000	110.000	35.000	62.000	110.000	Chrome/Steel	T-0600-1100-G-51312	Bearings - Thrust - Ball - Grooved - Chrome Steel
60.000	110.000	38.300	62.000	110.000	Hardened Steel/Steel	T-0600-1100-SB	Bearings - Thrust - Ball - Spherical Back Face
60.000	130.000	51.000	62.000	130.000	Chrome/Steel	T-0600-1300-G-51412	Bearings - Thrust - Ball - Grooved - Chrome Steel
60.000	130.000	54.000	62.000	130.000	Hardened Steel/Steel	T-0600-1300-SB	Bearings - Thrust - Ball - Spherical Back Face
60.325 mm ID (2.375 in.)							
60.325	91.281	25.400	61.119	90.488	Chrome/Steel	T-0603-0913-G	Bearings - Thrust - Ball - Grooved - Chrome Steel
63.500 mm ID (2.500 in.)							
63.500	94.456	25.400	64.294	93.662	Chrome/Steel	T-0635-0945-G	Bearings - Thrust - Ball - Grooved - Chrome Steel
65.000 mm ID (2.559 in.)							
65.000	90.000	18.000	67.000	90.000	Chrome/Steel	T-0650-0900-G-51113	Bearings - Thrust - Ball - Grooved - Chrome Steel
65.000	90.000	20.000	65.200	90.000	Chrome/Steel	* T-0650-0900-G	Bearings - Thrust - Ball - Grooved - Chrome Steel
65.000	100.000	27.000	67.000	100.000	Chrome/Steel	T-0650-1000-G-51213	Bearings - Thrust - Ball - Grooved - Chrome Steel
65.000	100.000	28.700	67.000	100.000	Hardened Steel/Steel	T-0650-1000-SB	Bearings - Thrust - Ball - Spherical Back Face
65.000	115.000	36.000	67.000	115.000	Chrome/Steel	T-0650-1150-G-51313	Bearings - Thrust - Ball - Grooved - Chrome Steel
65.000	115.000	39.400	67.000	115.000	Hardened Steel/Steel	T-0650-1150-SB	Bearings - Thrust - Ball - Spherical Back Face
65.000	140.000	56.000	68.000	140.000	Chrome/Steel	T-0650-1400-G-51413	Bearings - Thrust - Ball - Grooved - Chrome Steel
65.000	140.000	60.200	68.000	140.000	Hardened Steel/Steel	T-0650-1400-SB	Bearings - Thrust - Ball - Spherical Back Face
66.675 mm ID (2.625 in.)							
66.675	97.631	25.400	67.469	96.838	Chrome/Steel	T-0667-0976-G	Bearings - Thrust - Ball - Grooved - Chrome Steel
69.850 mm ID (2.750 in.)							
69.850	102.394	25.400	70.644	101.600	Chrome/Steel	T-0699-1024-G	Bearings - Thrust - Ball - Grooved - Chrome Steel



Stocked or Short Delivery



Usually Available



Long delivery or not in current production

* Large Minimum Quantities

** Available only while stock lasts

d1	D1	T	d2	D2	Bearing/Cage	Part Number	Type
70.000 mm ID (2.756 in.)							
70.000	95.000	18.000	72.000	95.000	Chrome/Steel	T-0700-0950-G-51114	Bearings - Thrust - Ball - Grooved - Chrome Steel
70.000	95.000	20.000	70.200	95.000	Chrome/Steel	* T-0700-0950-G	Bearings - Thrust - Ball - Grooved - Chrome Steel
70.000	105.000	27.000	72.000	105.000	Chrome/Steel	T-0700-1050-G-51214	Bearings - Thrust - Ball - Grooved - Chrome Steel
70.000	105.000	28.800	72.000	105.000	Hardened Steel/Steel	T-0700-1050-SB	Bearings - Thrust - Ball - Spherical Back Face
70.000	125.000	40.000	72.000	125.000	Chrome/Steel	T-0700-1250-G-51314	Bearings - Thrust - Ball - Grooved - Chrome Steel
70.000	125.000	44.200	72.000	125.000	Hardened Steel/Steel	T-0700-1250-SB	Bearings - Thrust - Ball - Spherical Back Face
70.000	150.000	60.000	73.000	150.000	Chrome/Steel	T-0700-1500-G-51414	Bearings - Thrust - Ball - Grooved - Chrome Steel
70.000	150.000	63.600	73.000	150.000	Hardened Steel/Steel	T-0700-1500-SB	Bearings - Thrust - Ball - Spherical Back Face
73.025 mm ID (2.875 in.)							
73.025	105.569	25.400	73.819	104.775	Chrome/Steel	T-0730-1056-G	Bearings - Thrust - Ball - Grooved - Chrome Steel
75.000 mm ID (2.953 in.)							
75.000	100.000	19.000	77.000	100.000	Chrome/Steel	T-0750-1000-G-51115	Bearings - Thrust - Ball - Grooved - Chrome Steel
75.000	100.000	20.000	75.200	100.000	Chrome/Steel	* T-0750-1000-G	Bearings - Thrust - Ball - Grooved - Chrome Steel
75.000	110.000	27.000	77.000	110.000	Chrome/Steel	T-0750-1100-G-51215	Bearings - Thrust - Ball - Grooved - Chrome Steel
75.000	110.000	28.300	77.000	110.000	Hardened Steel/Steel	T-0750-1100-SB	Bearings - Thrust - Ball - Spherical Back Face
75.000	135.000	44.000	77.000	135.000	Chrome/Steel	T-0750-1350-G-51315	Bearings - Thrust - Ball - Grooved - Chrome Steel
75.000	135.000	48.100	77.000	135.000	Hardened Steel/Steel	T-0750-1350-SB	Bearings - Thrust - Ball - Spherical Back Face
75.000	160.000	65.000	78.000	160.000	Chrome/Steel	T-0750-1600-G-51415	Bearings - Thrust - Ball - Grooved - Chrome Steel
75.000	160.000	69.000	78.000	160.000	Hardened Steel/Steel	T-0750-1600-SB	Bearings - Thrust - Ball - Spherical Back Face
76.200 mm ID (3.000 in.)							
76.200	111.125	28.575	77.788	109.538	Chrome/Steel	T-0762-1111-G	Bearings - Thrust - Ball - Grooved - Chrome Steel
80.000 mm ID (3.150 in.)							
80.000	105.000	19.000	82.000	105.000	Chrome/Steel	T-0800-1050-G-51116	Bearings - Thrust - Ball - Grooved - Chrome Steel
80.000	110.000	22.000	80.200	110.000	Chrome/Steel	* T-0800-1100-G	Bearings - Thrust - Ball - Grooved - Chrome Steel
80.000	115.000	28.000	82.000	115.000	Chrome/Steel	T-0800-1150-G-51216	Bearings - Thrust - Ball - Grooved - Chrome Steel
80.000	115.000	29.500	82.000	115.000	Hardened Steel/Steel	T-0800-1150-SB	Bearings - Thrust - Ball - Spherical Back Face
80.000	140.000	44.000	82.000	140.000	Chrome/Steel	T-0800-1400-G-51316	Bearings - Thrust - Ball - Grooved - Chrome Steel
80.000	140.000	47.600	82.000	140.000	Hardened Steel/Steel	T-0800-1400-SB	Bearings - Thrust - Ball - Spherical Back Face
80.000	170.000	68.000	83.000	170.000	Chrome/Steel	T-0800-1700-G-51416	Bearings - Thrust - Ball - Grooved - Chrome Steel
80.000	170.000	72.200	83.000	170.000	Hardened Steel/Steel	T-0800-1700-SB	Bearings - Thrust - Ball - Spherical Back Face
82.550 mm ID (3.250 in.)							
82.550	122.238	31.750	84.138	120.650	Chrome/Steel	T-0826-1222-G	Bearings - Thrust - Ball - Grooved - Chrome Steel
85.000 mm ID (3.346 in.)							
85.000	110.000	19.000	87.000	110.000	Chrome/Steel	T-0850-1100-G-51117	Bearings - Thrust - Ball - Grooved - Chrome Steel
85.000	115.000	22.000	85.200	115.000	Chrome/Steel	T-0850-1150-G	Bearings - Thrust - Ball - Grooved - Chrome Steel
85.000	125.000	31.000	88.000	125.000	Chrome/Steel	T-0850-1250-G-51217	Bearings - Thrust - Ball - Grooved - Chrome Steel
85.000	125.000	33.100	88.000	125.000	Hardened Steel/Steel	T-0850-1250-SB	Bearings - Thrust - Ball - Spherical Back Face
85.000	150.000	49.000	88.000	150.000	Chrome/Steel	T-0850-1500-G-51317	Bearings - Thrust - Ball - Grooved - Chrome Steel
85.000	150.000	53.100	88.000	150.000	Hardened Steel/Steel	T-0850-1500-SB	Bearings - Thrust - Ball - Spherical Back Face
85.000	180.000	72.000	88.000	177.000	Chrome/Steel	T-0850-1800-G-51417X	Bearings - Thrust - Ball - Grooved - Chrome Steel
85.000	180.000	77.000	88.000	180.000	Hardened Steel/Steel	* T-0850-1800-SB	Bearings - Thrust - Ball - Spherical Back Face
88.900 mm ID (3.500 in.)							
88.900	128.588	31.750	90.488	127.000	Chrome/Steel	T-0889-1286-G	Bearings - Thrust - Ball - Grooved - Chrome Steel
90.000 mm ID (3.543 in.)							
90.000	120.000	22.000	90.200	120.000	Chrome/Steel	* T-0900-1200-G	Bearings - Thrust - Ball - Grooved - Chrome Steel
90.000	120.000	22.000	92.000	120.000	Chrome/Steel	T-0900-1200-G-51118	Bearings - Thrust - Ball - Grooved - Chrome Steel
90.000	135.000	35.000	93.000	135.000	Chrome/Steel	T-0900-1350-G-51218	Bearings - Thrust - Ball - Grooved - Chrome Steel
90.000	135.000	38.500	93.000	135.000	Hardened Steel/Steel	T-0900-1350-SB	Bearings - Thrust - Ball - Spherical Back Face
90.000	155.000	50.000	93.000	155.000	Chrome/Steel	T-0900-1550-G-51318	Bearings - Thrust - Ball - Grooved - Chrome Steel



Stocked or Short Delivery



Usually Available



Long delivery or not in current production

* Large Minimum Quantities

** Available only while stock lasts

d1	D1	T	d2	D2	Bearing/Cage	Part Number	Type
90.000 mm ID (3.543 in.)							
90.000	155.000	54.600	93.000	155.000	Hardened Steel/Steel	T-0900-1550-SB	Bearings - Thrust - Ball - Spherical Back Face
90.000	190.000	77.000	93.000	187.000	Chrome/Steel	T-0900-1900-G-51418X	Bearings - Thrust - Ball - Grooved - Chrome Steel
90.000	190.000	81.200	93.000	190.000	Hardened Steel/Steel	* T-0900-1900-SB	Bearings - Thrust - Ball - Spherical Back Face
95.000 mm ID (3.740 in.)							
95.000	130.000	25.000	95.200	130.000	Chrome/Steel	* T-0950-1300-G	Bearings - Thrust - Ball - Grooved - Chrome Steel
95.250 mm ID (3.750 in.)							
95.250	134.938	31.750	96.838	133.350	Chrome/Steel	* T-0953-1349-G	Bearings - Thrust - Ball - Grooved - Chrome Steel
100.000 mm ID (3.937 in.)							
100.000	135.000	25.000	100.200	135.000	Chrome/Steel	* T-1000-1350-G	Bearings - Thrust - Ball - Grooved - Chrome Steel
100.000	135.000	25.000	102.000	135.000	Chrome/Steel	T-1000-1350-G-51120	Bearings - Thrust - Ball - Grooved - Chrome Steel
100.000	150.000	38.000	103.000	150.000	Chrome/Steel	T-1000-1500-G-51220	Bearings - Thrust - Ball - Grooved - Chrome Steel
100.000	150.000	40.900	103.000	150.000	Hardened Steel/Steel	T-1000-1500-SB	Bearings - Thrust - Ball - Spherical Back Face
100.000	170.000	55.000	103.000	170.000	Chrome/Steel	T-1000-1700-G-51320	Bearings - Thrust - Ball - Grooved - Chrome Steel
100.000	170.000	59.200	103.000	170.000	Hardened Steel/Steel	T-1000-1700-SB	Bearings - Thrust - Ball - Spherical Back Face
100.000	210.000	85.000	103.000	205.000	Chrome/Steel	T-1000-2100-G-51420X	Bearings - Thrust - Ball - Grooved - Chrome Steel
100.000	210.000	90.000	103.000	210.000	Hardened Steel/Steel	* T-1000-2100-SB	Bearings - Thrust - Ball - Spherical Back Face
101.600 mm ID (4.000 in.)							
101.600	147.638	34.925	103.188	146.050	Chrome/Steel	* T-1016-1476-G	Bearings - Thrust - Ball - Grooved - Chrome Steel
105.000 mm ID (4.134 in.)							
105.000	140.000	25.000	105.200	140.000	Chrome/Steel	* T-1050-1400-G	Bearings - Thrust - Ball - Grooved - Chrome Steel
110.000 mm ID (4.331 in.)							
110.000	145.000	25.000	110.200	145.000	Chrome/Steel	* T-1100-1450-G	Bearings - Thrust - Ball - Grooved - Chrome Steel
110.000	145.000	25.000	112.000	145.000	Chrome/Steel	T-1100-1450-G-51122	Bearings - Thrust - Ball - Grooved - Chrome Steel
110.000	160.000	38.000	113.000	160.000	Chrome/Steel	T-1100-1600-G-51222	Bearings - Thrust - Ball - Grooved - Chrome Steel
110.000	160.000	40.200	113.000	160.000	Hardened Steel/Steel	* T-1100-1600-SB	Bearings - Thrust - Ball - Spherical Back Face
110.000	190.000	63.000	113.000	187.000	Chrome/Steel	* T-1100-1900-G-51322X	Bearings - Thrust - Ball - Grooved - Chrome Steel
110.000	190.000	67.200	113.000	190.000	Hardened Steel/Steel	* T-1100-1900-SB	Bearings - Thrust - Ball - Spherical Back Face
114.300 mm ID (4.500 in.)							
114.300	166.688	44.450	115.888	165.100	Chrome/Steel	* T-1143-1667-G	Bearings - Thrust - Ball - Grooved - Chrome Steel
115.000 mm ID (4.528 in.)							
115.000	150.000	25.000	115.200	150.000	Chrome/Steel	* T-1150-1500-G	Bearings - Thrust - Ball - Grooved - Chrome Steel
120.000 mm ID (4.724 in.)							
120.000	155.000	25.000	122.000	155.000	Chrome/Steel	T-1200-1550-G-51124	Bearings - Thrust - Ball - Grooved - Chrome Steel
120.000	160.000	27.000	120.200	160.000	Chrome/Steel	T-1200-1600-G	Bearings - Thrust - Ball - Grooved - Chrome Steel
120.000	170.000	39.000	123.000	170.000	Chrome/Steel	T-1200-1700-G-51224	Bearings - Thrust - Ball - Grooved - Chrome Steel
120.000	170.000	40.800	123.000	170.000	Hardened Steel/Steel	* T-1200-1700-SB	Bearings - Thrust - Ball - Spherical Back Face
120.000	210.000	70.000	123.000	205.000	Chrome/Steel	* T-1200-2100-G-51324X	Bearings - Thrust - Ball - Grooved - Chrome Steel
120.000	210.000	74.100	123.000	210.000	Hardened Steel/Steel	* T-1200-2100-SB	Bearings - Thrust - Ball - Spherical Back Face
120.000	250.000	102.000	123.000	245.000	Chrome/Steel	* T-1200-2500-G-51424X	Bearings - Thrust - Ball - Grooved - Chrome Steel
120.000	250.000	107.300	123.000	250.000	Hardened Steel/Steel	* T-1200-2500-SB	Bearings - Thrust - Ball - Spherical Back Face
125.000 mm ID (4.921 in.)							
125.000	165.000	27.000	125.200	165.000	Chrome/Steel	* T-1250-1650-G	Bearings - Thrust - Ball - Grooved - Chrome Steel
127.000 mm ID (5.000 in.)							
127.000	185.738	50.800	128.588	184.150	Chrome/Steel	* T-1270-1857-G	Bearings - Thrust - Ball - Grooved - Chrome Steel
130.000 mm ID (5.118 in.)							
130.000	170.000	30.000	132.000	170.000	Chrome/Steel	T-1300-1700-G-51126	Bearings - Thrust - Ball - Grooved - Chrome Steel
130.000	190.000	45.000	133.000	187.000	Chrome/Steel	T-1300-1900-G-51226	Bearings - Thrust - Ball - Grooved - Chrome Steel
130.000	190.000	45.000	133.000	187.000	Chrome/Steel	* T-1300-1900-G-51226X	Bearings - Thrust - Ball - Grooved - Chrome Steel



Stocked or Short Delivery



Usually Available



Long delivery or not in current production

* Large Minimum Quantities

** Available only while stock lasts

d1	D1	T	d2	D2	Bearing/Cage	Part Number	Type
130.000 mm ID (5.118 in.)							
130.000	190.000	47.900	133.000	190.000	Hardened Steel/Steel	* T-1300-1900-SB	Bearings - Thrust - Ball - Spherical Back Face
130.000	225.000	75.000	134.000	220.000	Chrome/Steel	* T-1300-2250-G-51326X	Bearings - Thrust - Ball - Grooved - Chrome Steel
130.000	225.000	80.300	134.000	225.000	Hardened Steel/Steel	* T-1300-2250-SB	Bearings - Thrust - Ball - Spherical Back Face
130.000	270.000	110.000	134.000	265.000	Chrome/Steel	* T-1300-2700-G-51426X	Bearings - Thrust - Ball - Grooved - Chrome Steel
130.000	270.000	115.200	134.000	270.000	Hardened Steel/Steel	* T-1300-2700-SB	Bearings - Thrust - Ball - Spherical Back Face
139.700 mm ID (5.500 in.)							
139.700	204.788	55.562	141.288	203.200	Chrome/Steel	* T-1397-2048-G	Bearings - Thrust - Ball - Grooved - Chrome Steel
140.000 mm ID (5.512 in.)							
140.000	180.000	31.000	142.000	178.000	Chrome/Steel	* T-1400-1800-G-51128X	Bearings - Thrust - Ball - Grooved - Chrome Steel
140.000	185.000	31.000	140.300	185.000	Chrome/Steel	* T-1400-1850-G	Bearings - Thrust - Ball - Grooved - Chrome Steel
140.000	200.000	46.000	143.000	197.000	Chrome/Steel	* T-1400-2000-G-51228X	Bearings - Thrust - Ball - Grooved - Chrome Steel
140.000	200.000	48.600	143.000	200.000	Hardened Steel/Steel	* T-1400-2000-SB	Bearings - Thrust - Ball - Spherical Back Face
140.000	240.000	80.000	144.000	235.000	Chrome/Steel	* T-1400-2400-G-51328X	Bearings - Thrust - Ball - Grooved - Chrome Steel
140.000	240.000	84.900	144.000	240.000	Hardened Steel/Steel	* T-1400-2400-SB	Bearings - Thrust - Ball - Spherical Back Face
140.000	280.000	112.000	144.000	275.000	Chrome/Steel	* T-1400-2800-G-51428X	Bearings - Thrust - Ball - Grooved - Chrome Steel
140.000	280.000	117.000	144.000	280.000	Hardened Steel/Steel	* T-1400-2800-SB	Bearings - Thrust - Ball - Spherical Back Face
150.000 mm ID (5.906 in.)							
150.000	190.000	31.000	152.000	188.000	Chrome/Steel	T-1500-1900-G-51130	Bearings - Thrust - Ball - Grooved - Chrome Steel
150.000	190.000	31.000	152.000	188.000	Chrome/Steel	* T-1500-1900-G-51130X	Bearings - Thrust - Ball - Grooved - Chrome Steel
150.000	215.000	50.000	153.000	212.000	Chrome/Steel	* T-1500-2150-G-51230X	Bearings - Thrust - Ball - Grooved - Chrome Steel
150.000	215.000	53.300	153.000	215.000	Hardened Steel/Steel	* T-1500-2150-SB	Bearings - Thrust - Ball - Spherical Back Face
150.000	250.000	80.000	154.000	245.000	Chrome/Steel	* T-1500-2500-G-51330X	Bearings - Thrust - Ball - Grooved - Chrome Steel
150.000	250.000	83.700	154.000	250.000	Hardened Steel/Steel	* T-1500-2500-SB	Bearings - Thrust - Ball - Spherical Back Face
150.000	300.000	120.000	154.000	295.000	Chrome/Steel	* T-1500-3000-G-51430X	Bearings - Thrust - Ball - Grooved - Chrome Steel
150.000	300.000	125.900	154.000	300.000	Hardened Steel/Steel	* T-1500-3000-SB	Bearings - Thrust - Ball - Spherical Back Face
152.400 mm ID (6.000 in.)							
152.400	220.662	60.325	153.988	219.075	Chrome/Steel	* T-1524-2207-G	Bearings - Thrust - Ball - Grooved - Chrome Steel
160.000 mm ID (6.299 in.)							
160.000	200.000	31.000	162.000	198.000	Chrome/Steel	* T-1600-2000-G-51132X	Bearings - Thrust - Ball - Grooved - Chrome Steel
160.000	225.000	51.000	163.000	222.000	Chrome/Steel	* T-1600-2250-G-51232X	Bearings - Thrust - Ball - Grooved - Chrome Steel
160.000	225.000	54.700	163.000	225.000	Hardened Steel/Steel	* T-1600-2250-SB	Bearings - Thrust - Ball - Spherical Back Face
160.000	270.000	87.000	164.000	265.000	Chrome/Steel	* T-1600-2700-G-51332X	Bearings - Thrust - Ball - Grooved - Chrome Steel
160.000	270.000	91.700	164.000	270.000	Hardened Steel/Steel	* T-1600-2700-SB	Bearings - Thrust - Ball - Spherical Back Face
160.000	320.000	130.000	164.000	315.000	Chrome/Steel	* T-1600-3200-G-51432X	Bearings - Thrust - Ball - Grooved - Chrome Steel
160.000	320.000	135.300	164.000	320.000	Hardened Steel/Steel	* T-1600-3200-SB	Bearings - Thrust - Ball - Spherical Back Face
170.000 mm ID (6.693 in.)							
170.000	215.000	34.000	172.000	213.000	Chrome/Steel	* T-1700-2150-G-51134X	Bearings - Thrust - Ball - Grooved - Chrome Steel
170.000	240.000	55.000	173.000	237.000	Chrome/Steel	* T-1700-2400-G-51234X	Bearings - Thrust - Ball - Grooved - Chrome Steel
170.000	240.000	58.700	173.000	240.000	Hardened Steel/Steel	* T-1700-2400-SB	Bearings - Thrust - Ball - Spherical Back Face
170.000	280.000	87.000	174.000	275.000	Chrome/Steel	* T-1700-2800-G-51334X	Bearings - Thrust - Ball - Grooved - Chrome Steel
170.000	280.000	91.300	174.000	280.000	Hardened Steel/Steel	* T-1700-2800-SB	Bearings - Thrust - Ball - Spherical Back Face
170.000	340.000	135.000	174.000	335.000	Chrome/Steel	* T-1700-3400-G-51434X	Bearings - Thrust - Ball - Grooved - Chrome Steel
170.000	340.000	141.000	174.000	340.000	Hardened Steel/Steel	* T-1700-3400-SB	Bearings - Thrust - Ball - Spherical Back Face
180.000 mm ID (7.087 in.)							
180.000	225.000	34.000	183.000	222.000	Chrome/Steel	* T-1800-2250-G-51136X	Bearings - Thrust - Ball - Grooved - Chrome Steel
180.000	250.000	56.000	183.000	247.000	Chrome/Steel	* T-1800-2500-G-51236X	Bearings - Thrust - Ball - Grooved - Chrome Steel
180.000	250.000	58.200	183.000	250.000	Hardened Steel/Steel	* T-1800-2500-SB	Bearings - Thrust - Ball - Spherical Back Face
180.000	300.000	95.000	184.000	295.000	Chrome/Steel	* T-1800-3000-G-51336X	Bearings - Thrust - Ball - Grooved - Chrome Steel
180.000	300.000	99.300	184.000	300.000	Hardened Steel/Steel	* T-1800-3000-SB	Bearings - Thrust - Ball - Spherical Back Face



Stocked or Short Delivery



Usually Available



Long delivery or not in current production

* Large Minimum Quantities

** Available only while stock lasts

d1	D1	T	d2	D2	Bearing/Cage	Part Number	Type
180.000 mm ID (7.087 in.)							
180.000	360.000	140.000	184.000	355.000	Chrome/Steel	* T-1800-3600-G-51436X	Bearings - Thrust - Ball - Grooved - Chrome Steel
180.000	360.000	148.300	184.000	360.000	Hardened Steel/Steel	* T-1800-3600-SB	Bearings - Thrust - Ball - Spherical Back Face
190.000 mm ID (7.480 in.)							
190.000	240.000	37.000	193.000	237.000	Chrome/Steel	* T-1900-2400-G-51138X	Bearings - Thrust - Ball - Grooved - Chrome Steel
190.000	270.000	62.000	194.000	267.000	Chrome/Steel	* T-1900-2700-G-51238X	Bearings - Thrust - Ball - Grooved - Chrome Steel
190.000	270.000	65.700	194.000	270.000	Hardened Steel/Steel	* T-1900-2700-SB	Bearings - Thrust - Ball - Spherical Back Face
190.000	320.000	105.000	195.000	315.000	Chrome/Steel	* T-1900-3200-G-51338X	Bearings - Thrust - Ball - Grooved - Chrome Steel
190.000	320.000	111.000	195.000	320.000	Hardened Steel/Steel	* T-1900-3200-SB	Bearings - Thrust - Ball - Spherical Back Face
190.000	380.000	150.000	195.000	375.000	Chrome/Steel	* T-1900-3800-G-51438X	Bearings - Thrust - Ball - Grooved - Chrome Steel
200.000 mm ID (7.874 in.)							
200.000	250.000	37.000	203.000	247.000	Chrome/Steel	* T-2000-2500-G-51140X	Bearings - Thrust - Ball - Grooved - Chrome Steel
200.000	280.000	62.000	204.000	277.000	Chrome/Steel	* T-2000-2800-G-51240X	Bearings - Thrust - Ball - Grooved - Chrome Steel
200.000	280.000	65.300	204.000	280.000	Hardened Steel/Steel	* T-2000-2800-SB	Bearings - Thrust - Ball - Spherical Back Face
200.000	340.000	110.000	205.000	335.000	Chrome/Steel	* T-2000-3400-G-51340X	Bearings - Thrust - Ball - Grooved - Chrome Steel
200.000	340.000	118.400	205.000	340.000	Hardened Steel/Steel	* T-2000-3400-SB	Bearings - Thrust - Ball - Spherical Back Face
200.000	400.000	155.000	205.000	395.000	Chrome/Steel	* T-2000-4000-G-51440X	Bearings - Thrust - Ball - Grooved - Chrome Steel



Stocked or Short Delivery



Usually Available



Long delivery or not in current production

* Large Minimum Quantities

** Available only while stock lasts

TIPS

50000 series 3 piece thrust bearings are listed in this catalogue for convenience. These items are not always available through us.

We do offer some thrust bearings in stainless steel or full ceramic. Refer to the material as listed in the size charts.

Banded thrust bearings are a semi-precision type of bearing. You will often find these in jockey wheels and other slow rotating systems.

3 piece thrust bearings often have a clearance bore on one side and a clearance OD on the other. These features allow the bearing to operate in a system without a stepped shaft or housing. If the bearing ID is identical on both sides, then the shaft will need to be stepped. If the bearing OD is identical on both sides, the housing bore will need to be stepped.



Distributed By

Miniature Bearings Australia
<http://www.minibearings.com.au>
sales@minibearings.com.au

Resellers: Please place your contact sticker over our details

Avoid verbal communication

We sell an extensive range of products with varying amounts of technical data. Please assist us to provide you with accurate information by placing your orders and enquiries online or by e-mail.

Thrust Ball Bearing Sizes